

SEWER SERVICE INFORMATION (ID #19816) \*

DISTANCE FROM MH AT KITSON ST. (MH ID #19815)	
1.6 S	SERVICE CONNECTION W
7.3 S	SERVICE CONNECTION W
21.3 S	SERVICE CONNECTION E
22.0 S	SERVICE CONNECTION W
31.8 S	SERVICE CONNECTION W
35.3 S	SERVICE CONNECTION E
36.0 S	SERVICE CONNECTION E
38.4 S	SERVICE CONNECTION W
44.3 S	SERVICE CONNECTION E
45.0 S	SERVICE CONNECTION W
53.2 S	SERVICE CONNECTION W
62.0 S	SERVICE CONNECTION W
65.6 S	SERVICE CONNECTION E
66.6 S	SERVICE CONNECTION E
67.9 S	SERVICE CONNECTION W
82.1 S	SERVICE CONNECTION W
82.7 S	SERVICE CONNECTION E
89.3 S	SERVICE CONNECTION AT 12 O'CLOCK
92.3 S	SERVICE CONNECTION W
96.8 S	SERVICE CONNECTION W

\* - INFORMATION FROM SEWER VIDEO INSPECTION

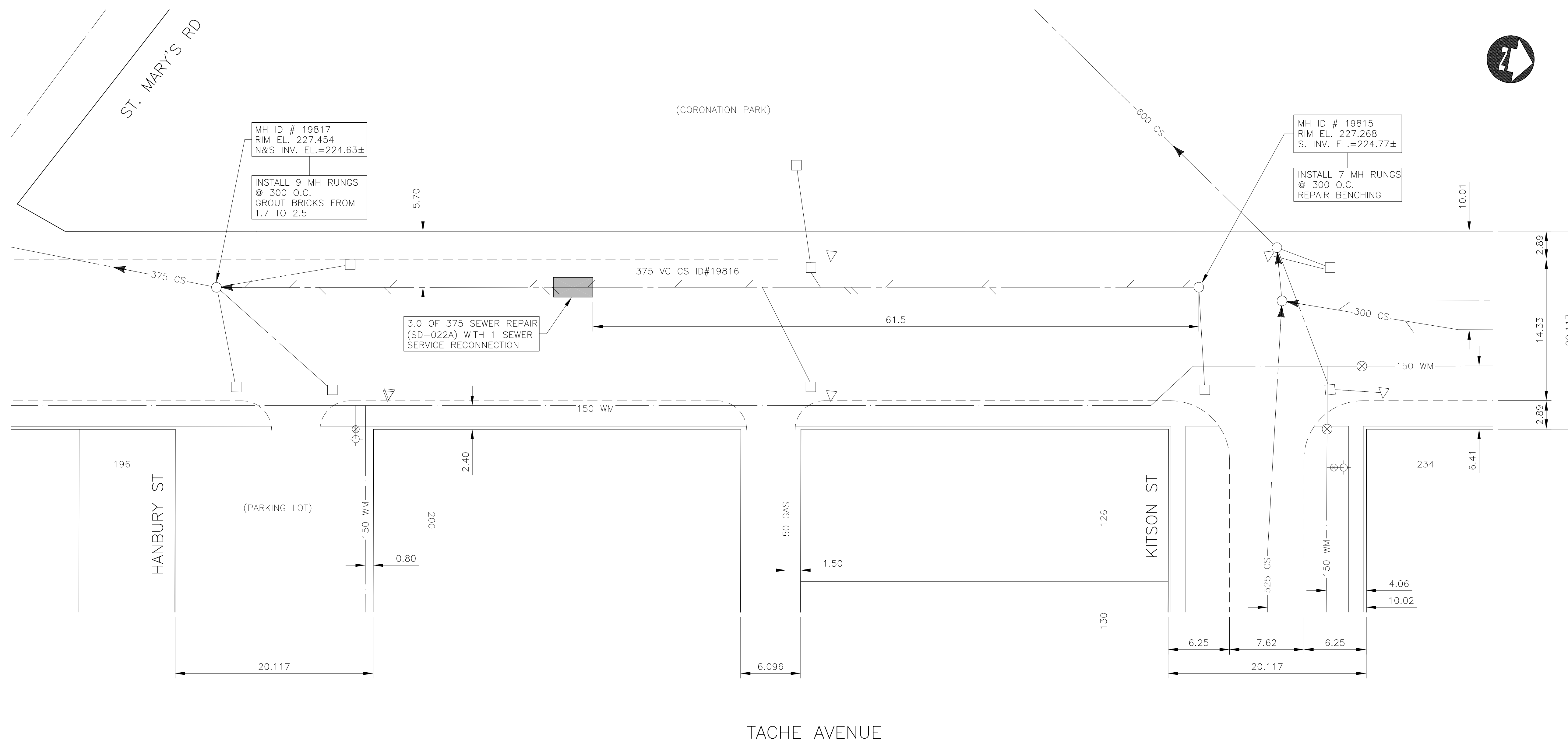

WARNING

IF POWER EQUIPMENT OR EXPLOSIVES ARE TO BE USED FOR EXCAVATION ON THIS PROJECT THE CONTRACTOR MUST:

1. NOTIFY THE GAS COMPANY OF THE PROPOSED LOCATION OF EXCAVATION.
2. TAKE PRECAUTIONS TO AVOID DAMAGE TO GAS COMPANY INSTALLATIONS SEE PROVINCIAL REGULATION 210/72 FOR DETAILS

METRIC

WHOLE NUMBERS INDICATE MILLIMETRES  
DECIMALIZED NUMBERS INDICATE METRES

150 mm W.M.	WATERMAIN	150 mm W.M.	HYDRO	150 mm W.M.	WATERMAIN	150 mm W.M.
	HYDRANT		M.T.S.		HYDRANT	
	VALVE		CONCRETE		VALVE	
	LAND DRAINAGE SEWER		ASPHALT		LAND DRAINAGE SEWER	
	WASTE WATER SEWER		PROPERTY LINE		WASTE WATER SEWER	
	MANHOLE		SURVEY BAR		PROPERTY LINE	
	CATCH BASIN		SERVICE VALVE		I.P.S.	
	CURB INLET		BUILDING		BUILDING	
	JUNCTIONS					
	CULVERT					
	GAS					
	EXISTING		EXISTING		PROPOSED	

300 mm L.D.S.	LAND DRAINAGE SEWER	300 mm L.D.S.
	LAND DRAINAGE SEWER	
	WASTE WATER SEWER	

250 mm W.W.S.	WASTE WATER SEWER	250 mm W.W.S.
	WASTE WATER SEWER	
	NORTH/WEST GUTTER	
	SOUTH/EAST GUTTER	

DESIGNED BY	A.R.P.
DRAWN BY	S.C.C.
CHECKED BY	P.M.K.
APPROVED BY	
HOR. SCALE	1:500
VERTICAL	
DATE	JUNE 2004

**DILLON CONSULTING**

RELEASED FOR CONSTRUCTION (ORIGINAL SIGNED BY) KAS ZUREK  
DATE JULY 22, 2004

ENGINEER'S SEAL  
PROVINCE OF MANITOBA  
ORIGINAL STAMPED BY  
**P. M. KREITZ**  
07/22/04  
REGISTERED PROFESSIONAL ENGINEER

CONSULTANT DRAWING NO.  
**043032-06**

**THE CITY OF WINNIPEG**  
WATER AND WASTE DEPARTMENT

2004 COMBINED SEWER RENEWALS AND REPAIRS - CONTRACT 10  
**TACHE AVENUE**  
MH AT KITSON ST (S. OF CL)  
TO MH AT HANBURY ST

CITY DRAWING NUMBER  
**05498**  
SHEET **6 R1** OF **17**

BID OPPORTUNITY  
NO. 305-2004