

SUB-DRAIN 300 LBS.	SUB-DRAIN 300 LBS.	POLES - TEST HOLE	PROPOSED	EXISTING
LAND DRAINAGE SEWER 250 WWS.	LAND DRAINAGE SEWER 250 WWS.	GUY WIRE	PROPOSED	EXISTING
WASTE WATER SEWER	WASTE WATER SEWER	LIGHT STANDARD	PROPOSED	EXISTING
GAS	GAS	BACK OF CURB	PROPOSED	EXISTING
HYDRO	HYDRO	EARLY CONCRETE	PROPOSED	EXISTING
M.T.S.	M.T.S.	CONCRETE	PROPOSED	EXISTING
WATERMAIN	WATERMAIN	ASPHALT	PROPOSED	EXISTING
HYDRANT	HYDRANT	SIDEWALK	PROPOSED	EXISTING
VALVE	VALVE	PROPERTY LINE	PROPOSED	EXISTING
MANHOLE	MANHOLE	SURVEY BAR	PROPOSED	EXISTING
CATCH BASIN	CATCH BASIN	GEODETIC BENCHMARK	PROPOSED	EXISTING
CURB INLET	CURB INLET	ELEVATION	PROPOSED	EXISTING
LEGEND-PLAN	LEGEND-PLAN	LEGEND-PLAN	PROPOSED	EXISTING

LOCATION APPROVED UNDERGROUND STRUCTURES	DATE
NO.	REVISIONS

DESIGNED BY	B.S.
DRAWN BY	D.W.
CHECKED BY	C.R.
APPROVED BY	R.J.H.

KGS CONSULTING ENGINEERS & PROJECT MANAGERS
 WINNIPEG
 2004 ALLEY RENEWALS
 PUBLIC WORKS DEPARTMENT
 ENGINEERING SERVICES DIVISION

M.C. ROY
 PROFESSIONAL ENGINEER
 REG. NO. 22079

THE CITY OF WINNIPEG
 PUBLIC WORKS DEPARTMENT
 ENGINEERING SERVICES DIVISION
 2004 ALLEY RENEWALS
 CARLTON/HARGRAVE LANE
 BROADWAY AVE. SOUTH LANE
 TO ASSINIBOINE AVE.
 STA. 2+50 TO STA. 3+55.88

SHEET	08	OF	12
COMPUTER FILE NAME	03-107-15		
CITY DRAWING NUMBER	•		

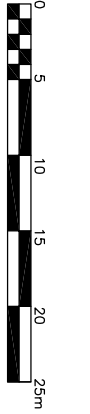

APGIN
 Certificate of Authorization
 KGS Group
 No. 245 Expiry: April 30, 2005

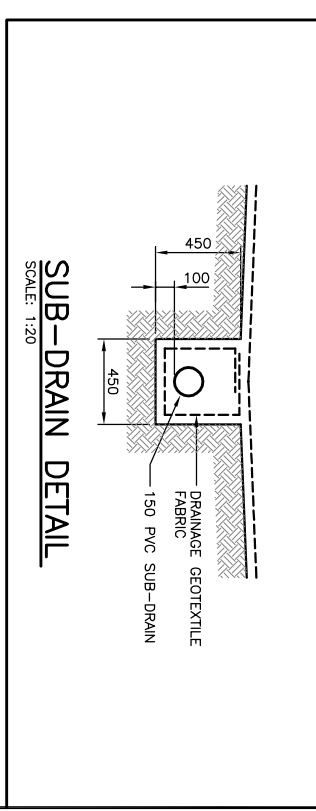
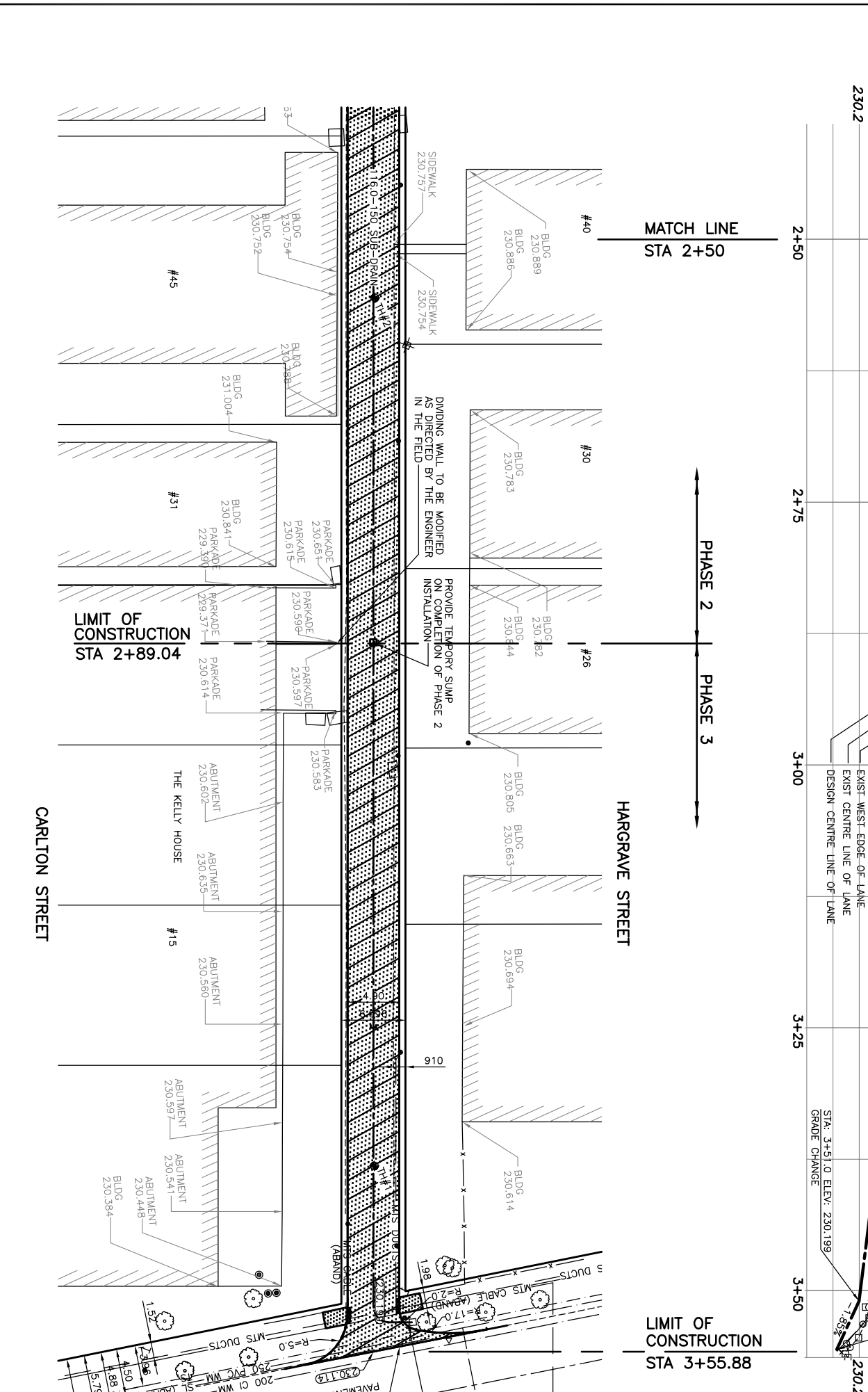

WARNING
 IF POWER EQUIPMENT OR EXPLOSIVES ARE TO BE USED FOR EXCAVATION ON THIS PROJECT THE CONTRACTOR SHALL NOTIFY THE GAS COMPANY OF THE PROPOSED LOCATION OF EXCAVATION.
 2) THE PRECAUTION OF AVOID DAMAGE TO GAS COMPANY SET PROVINCIAL REGULATION 219/72 FOR DETAILS.

METRIC
 WHOLE NUMBERS INDICATE MILLIMETRES
 DECIMALIZED NUMBERS INDICATE METRES