

CONSTRUCTION NOTES

1. EXPOSE EXISTING WATERMAIN & CONFIRM INVERTS PRIOR TO CONSTRUCTION.
2. LOCATION OF ALL SERVICES TO BE CONFIRMED IN THE FIELD.
3. INSTALL WATERMAIN BY TRENCHLESS METHODS.
4. TRENCHES AND EXCAVATIONS WITHIN 1 METRE OF A PAVED AREA INCLUDING SIDEWALKS SHALL BE CLASS 3 BACKFILL.
5. ALL MATERIALS SHALL CONFORM TO THE CITY OF WINNIPEG STANDARD CONSTRUCTION SPECIFICATIONS.
6. MINIMUM COVER TO TOP OF WATERMAIN SHALL BE 2.4 m.
7. REPLACE ALL EXISTING LEAD SERVICES FROM PROPOSED WATERMAIN TO R.
8. NOTIFY ALL AFFECTED RESIDENTS AND BUSINESSES 24 HOURS IN ADVANCE OF ANY WATER SHUTDOWNS OR DISRUPTION OF SERVICE.

GROSVENOR AVENUE

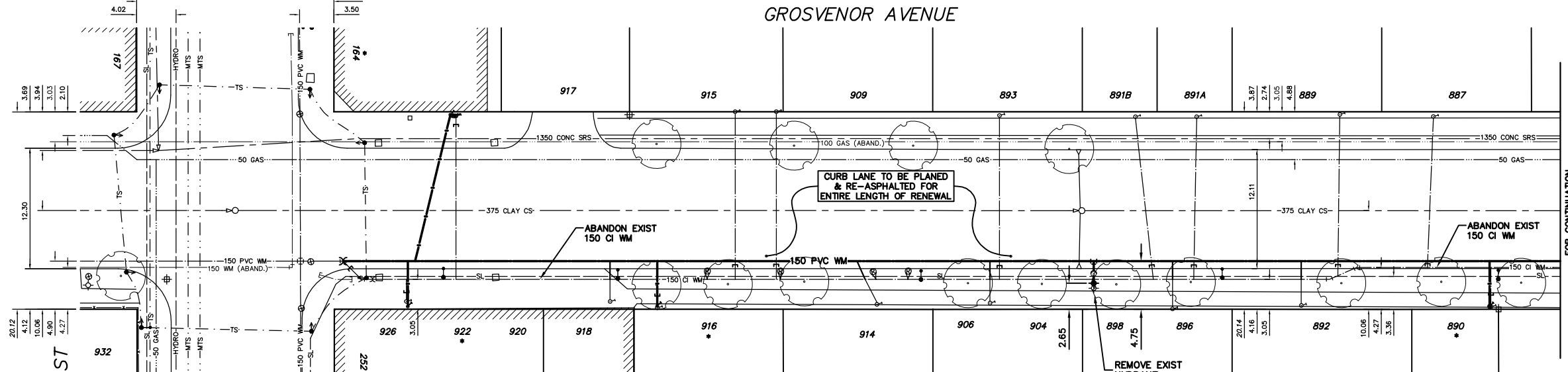

NOTE: CHAINAGES SHOWN ARE ALONG S. R. OF GROSVENOR AVE

WATER SERVICE INFORMATION

ADDRESS	SIZE(mm)	SIZE(mm) & TYPE (PROP)	SHORT & LONG MEASUREMENT	CORP. LOCATION	REMARKS
2.43 887 GROSVENOR AVE RESIDENTIAL	20	13 COPPER LEAD	4.56 E/WHL 40.84 WML WENTWORTH	0.6 W OF S/C	-
10.06 888 GROSVENOR AVE RESIDENTIAL	25	25 COPPER LEAD	5.2 WEL FOUNDATION 25.3 WML WENTWORTH	0.45 E OF S/C	-
3.28 889 GROSVENOR AVE RESIDENTIAL	20	13 COPPER LEAD	1.83 W/EHL 24.7 E/1ST HYD E STAFFORD	0.3 W OF S/C	REV. TAPPED
20.11 890 GROSVENOR AVE RESIDENTIAL	13	13 COPPER LEAD	0.3 E/EHL 34.7 WML WENTWORTH	OPP S/C	RENEW W/ 20 COPPER
891 GROSVENOR AVE RESIDENTIAL	20	20 COPPER LEAD	2.13 W/EHL 88.1 EEL STAFFORD	0.3 W OF S/C	-
891 GROSVENOR AVE RESIDENTIAL	20	20 COPPER LEAD	88.1 EEL STAFFORD	0.3 W OF S/C	-
891 GROSVENOR AVE RESIDENTIAL	20	20 COPPER LEAD	88.1 EEL STAFFORD	1.83 E OF S/C	-
892 GROSVENOR AVE RESIDENTIAL	20	13 COPPER LEAD	1.52 EEL W WINDOW 54.6 WML WENTWORTH	OPP S/C	-
893 GROSVENOR AVE RESIDENTIAL	20	13 COPPER LEAD	2.8 W/EHL 10.0 W/1ST HYD E STAFFORD	OPP S/C	-

WATER SERVICE INFORMATION

ADDRESS	SIZE(mm)	SIZE(mm) & TYPE (PROP)	SHORT & LONG MEASUREMENT	CORP. LOCATION	REMARKS
900 GROSVENOR AVE RESIDENTIAL	20	20 COPPER	4.75 WEL HSE 10.55 OFF BLDG	-	-
904 GROSVENOR AVE COMMERCIAL	20	20 COPPER	66.6 EEL STAFFORD	-	-
908 GROSVENOR AVE COMMERCIAL	20	20 COPPER LEAD	0.3 WEL W WINDOW	OPP S/C	SERV. REPAIR FEB/29/88
909 GROSVENOR AVE RESIDENTIAL	20	20 COPPER LEAD	1.52 W/WHL 45.1 EEL STAFFORD	OPP S/C	DBL SERV. W/915
914 GROSVENOR AVE RESIDENTIAL	25	25 COPPER LEAD	5.8 W/EHL 0.3 OFF R	0.6 W OF S/C	-
914 GROSVENOR AVE RESIDENTIAL	25	25 COPPER LEAD	6.1 W/EHL 0.3 OFF R	1.21 W OF S/C	-
915 GROSVENOR AVE RESIDENTIAL	38	38 COPPER LEAD	4.88 W/EHL	OPP S/C	SERV. REPAIR AUG/06/00
916 GROSVENOR AVE RESIDENTIAL	20	20 COPPER LEAD	1.52 E/WL HSE 32.92 EEL STAFFORD	OPP S/C	RENEW W/ 20 COPPER

WATER SERVICE INFORMATION

ADDRESS	SIZE(mm)	SIZE(mm) & TYPE (PROP)	SHORT & LONG MEASUREMENT	CORP. LOCATION	REMARKS
917 GROSVENOR AVE COMMERCIAL	13	20 LEAD	1.07 S/NHL 35.35>NNL GROSVENOR	0.91 S OF S/C	SERV. OFF STAFFORD
918 GROSVENOR AVE COMMERCIAL	25	25 COPPER LEAD	1.83 W/EHL 28.04 EEL STAFFORD	OPP S/C	SERV. REPAIR AUG/14/87
922 GROSVENOR AVE COMMERCIAL	13	13 LEAD	7.32 W/EHL #826	OPP S/C	RENEW W/ 25 COPPER
925 GROSVENOR AVE COMMERCIAL	16	13 LEAD	7.32 W/EHL #826 14.41 S/NHL	0.6 S OF S/C	DBL SERV. W/252 STAFFORD
929 GROSVENOR AVE COMMERCIAL	25	25 COPPER LEAD	6.4 WML STAFFORD	OPP S/C	-
929 GROSVENOR AVE COMMERCIAL	150	150 SPRINKLER	2.74 S/NHL 14.54 OFF BLDG	-	-
164 STAFFORD ST COMMERCIAL	25	13 LEAD	-	-	SERV. OFF GROSVENOR RENEW W/ 25 COPPER

METRIC

WHOLE NUMBERS INDICATE MILLIMETRES
DECIMALIZED NUMBERS INDICATE METRES

NOTE: ALL VALVES TO BE INSTALLED COUNTERCLOCKWISE TO CLOSE

WARNING

IF POWER EQUIPMENT OR EXPLOSIVES ARE TO BE USED FOR EXCAVATION ON THIS PROJECT THE CONTRACTOR MUST:
1) NOTIFY THE GAS COMPANY OF THE PROPOSED LOCATION OF EXCAVATION.
2) TAKE PRECAUTION TO AVOID DAMAGE TO GAS COMPANY INSTALLATIONS.
SEE PROVINCIAL REGULATION 210/72 FOR DETAILS

*SERVICES TO BE RENEWED TO R. ALL OTHERS TO BE RECONNECTED

*SERVICES TO BE RENEWED TO R. ALL OTHERS TO BE RECONNECTED

*SERVICES TO BE RENEWED TO R. ALL OTHERS TO BE RECONNECTED

200 WM	WATERMAIN	200 WM	SL, HYDRO	150 WM	WATERMAIN	150 WM
⊕	HYDRANT	⊕	MTS	⊕	HYDRANT	⊕
⊙	VALVE	⊙	TRAFFIC SIGNALS	⊙	VALVE	⊙
525 LDS	LAND DRAINAGE SEWER	525 LDS	GAS	50 GAS	LAND DRAINAGE SEWER	300 LDS
375 WWS	WASTEWATER SEWER	375 WWS	SURVEY BAR	250 WWS	WASTEWATER SEWER	250 WWS
○	MANHOLE	●	FENCE	⊕	PROFILE	
□	CATCH BASIN	■	POLE - HYDRO, MTS	⊕	GROUND ABOVE PIPE	
▽	CURB INLET	▽	CURB STOP	▽		
△	REDUCER	△	GUY ANCHOR	△		
X	COUPLING	X	LIGHT STANDARD	X		
⊕	ANODE	⊕	TREE	⊕		
EXISTING	LEGEND-PLAN	PROPOSED	EXISTING	LEGEND-PLAN	PROPOSED	EXISTING

LOCATION APPROVED	UNDERGROUND STRUCTURES	DATE
SUPV. U/G STRUCTURES COMMITTEE		
NOTE:	LOCATION OF UNDERGROUND STRUCTURES AS SHOWN ARE BASED ON THE BEST INFORMATION AVAILABLE BUT NO GUARANTEE IS GIVEN THAT ALL EXISTING UTILITIES ARE EXACT. CONFIRMATION OF EXISTENCE AND EXACT LOCATION OF ALL SERVICES MUST BE OBTAINED FROM THE INDIVIDUAL UTILITIES BEFORE PROCEEDING WITH CONSTRUCTION.	

B.M. ELEV.	FIELD BOOK #:
POSTED TO LBS:	
NO. REVISIONS	DATE BY

CITY OF WINNIPEG
WATER AND WASTE
ENGINEERING DIVISION

DESIGNED BY: NC
CHECKED BY: TW
DRAWN BY: C/JH
APPROVED BY: KZ

HOR. SCALE: 1:250
VERTICAL: 1:50

RELEASED FOR CONSTRUCTION: 2004 06 11

ENGINEER'S SEAL
ORIGINAL SIGNED BY K.R. ZUREK
04/06/14

THE CITY OF WINNIPEG
WATER AND WASTE DEPARTMENT

2004 WATERMAIN RENEWALS

GROSVENOR AVENUE
STAFFORD STREET TO
125 m E OF STAFFORD STREET

SHEET 8 OF 11
CITY DRAWING NUMBER
D-8508

BID OPPORTUNITY: 274-2004
FILENAME: D-8508.D-8509.dwg
PLOT DATE: 2004 06 14