

NOTE: CHANGE ALONG EAST PROPERTY LINE BIRCHDALE AVENUE

SEWER SERVICE INFORMATION (ID #20029) *

DISTANCE FROM 1ST MH N. OF CONISTON ST. (MH ID #20028)	
4.6 N	SERVICE CONNECTION W
11.8 N	SERVICE CONNECTION E
25.8 N	SERVICE CONNECTION E
37.6 N	SERVICE CONNECTION E
51.4 N	SERVICE CONNECTION (12.0' CLOCK)
DISTANCE FROM MH AT HIGHFIELD ST. (MH ID #20030)	
20.4 S	SERVICE CONNECTION W
20.5 S	SERVICE CONNECTION E

* - INFORMATION FROM SEWER VIDEO INSPECTION

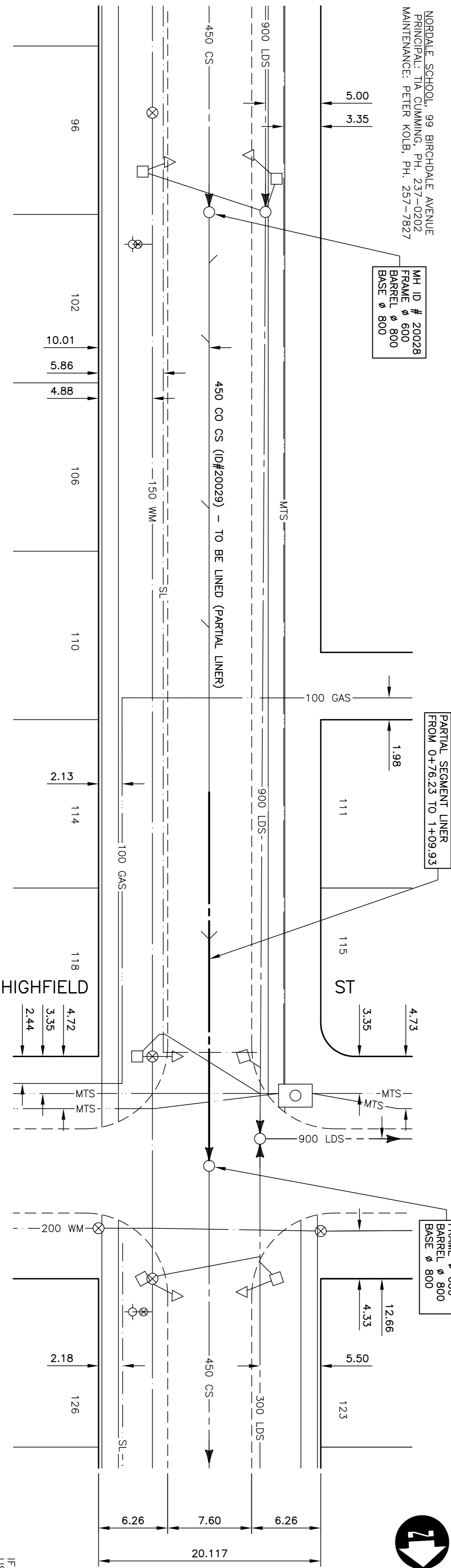

BIRCHDALE AVENUE

WARNING

IF POWER EQUIPMENT OR EXPLOSIVES ARE TO BE USED FOR EXCAVATION ON THIS PROJECT THE CONTRACTOR MUST:

1. NOTIFY THE GAS COMPANY OF THE PROPOSED LOCATION OF EXCAVATION.
2. TAKE PRECAUTION TO AVOID DAMAGE TO GAS COMPANY INSTALLATIONS

SEE PROVINCIAL REGULATION 210/72 FOR DETAILS

METRIC

WHOLE NUMBERS INDICATE MILLIMETRES
DECIMALIZED NUMBERS INDICATE METRES

150 mm W.M.	WATERMAIN	150 mm W.M.	HYDRO	150 mm W.M.	WATERMAIN	150 mm W.M.	UNDERGROUND STRUCTURES	B.M. ELEV.	DESIGNED BY	RELEASED FOR ORIGINAL SIGNED BY
300 mm L.O.S.	LAND DRAINAGE SEWER	300 mm L.O.S.	CONCRETE	300 mm L.O.S.	LAND DRAINAGE SEWER	300 mm L.O.S.	DATE	NO.	BY	DATE
250 mm W.M.S.	WASTE WATER SEWER	250 mm W.M.S.	ASPHALT	250 mm W.M.S.	WASTE WATER SEWER	250 mm W.M.S.	DATE	1	DATE	DATE
○	MANHOLE	●	PROPERTY LINE	○	WASTE WATER SEWER	○	DATE	2	DATE	DATE
▽	CATCH BASIN	⊕	SURVEY BAR	▽	PROPERTY LINE	▽	DATE	1	DATE	DATE
○	CURB INLET	⊕	SURVEY VALVE	○	PROPERTY LINE	○	DATE	2	DATE	DATE
○	JUNCTIONS	⊕	I.P.S.	○	PROPERTY LINE	○	DATE	1	DATE	DATE
○	CULVERT	⊕	BUILDING	○	PROPERTY LINE	○	DATE	2	DATE	DATE
○	GAS	⊕	BUILDING	○	PROPERTY LINE	○	DATE	1	DATE	DATE
○	LEGEND-PLAN	⊕	LEGEND-PLAN	○	PROPERTY LINE	○	DATE	2	DATE	DATE
○	EXISTING	⊕	PROPOSED	○	EXISTING	○	DATE	1	DATE	DATE
○	LEGEND-PROFILE	⊕	PROPOSED	○	LEGEND-PROFILE	○	DATE	2	DATE	DATE
○	EXISTING	⊕	PROPOSED	○	EXISTING	○	DATE	1	DATE	DATE

NOTE: OF UNDERGROUND STRUCTURES AS SHOWN ARE BASED ON THE BEST INFORMATION AVAILABLE. THE EXISTING UTILITIES ARE SHOWN FOR INFORMATION ONLY. THE CONTRACTOR SHALL VERIFY THE LOCATION AND DEPTH OF ALL EXISTING UTILITIES AND REPORT ANY DISCREPANCIES TO THE ENGINEER BEFORE PROCEEDING WITH THE INDIVIDUAL UTILITIES BEFORE PROCEEDING WITH THE INDIVIDUAL UTILITIES.

ENGINEER'S SEAL: PROVINCE OF MANITOBA, REGISTERED PROFESSIONAL ENGINEER, ORIGINAL BY S.D.M., KREITZ, 05/28/04

DESIGNED BY: J.K.M., DRAWN BY: S.C.C., CHECKED BY: P.M.K., APPROVED BY: P.M.K., HOR. SCALE: 1:250, VERTICAL: 1:50, RELEASED FOR ORIGINAL SIGNED BY: GAS ZUREK, DATE: MAY 28, 2004

CONSULTANT DRAWING NO. 043031-01

THE CITY OF WINNIPEG WATER AND WASTE DEPARTMENT

2004 COMBINED SEWER RENEWALS BY CIPP LINING - CONTRACT 9 BIRCHDALE AVENUE 1ST MH NORTH OF CONISTON ST TO MH AT HIGHFIELD ST (CL)

CITY DRAWING NUMBER 05399 SHEET 1 OF 15 BID OPPORTUNITY No. 238-2004