

ADDRESS/NATURE OF SERVICES	SIZE/MATERIAL	DIST. TO PROP.	POSITION OF S.C. (curb stop)	POSITION OF C.C. (corp)	COMMENTS:
102 TEAKWOOD AV RESIDENTIAL	COPPER 19 mm	0.3 m	Long: 10.1 m E of EL DAFFODIL Short: 3.8 m W of EL HOUSE	Long: of Short: of	
101 TEAKWOOD AV RESIDENTIAL	COPPER 19 mm	0.3 m	Long: of Short: 5.3 m E of WL HOUSE	Long: of Short: SAME AS SC	
100 TEAKWOOD AV RESIDENTIAL	COPPER 19 mm	0.2 m	Long: 18.4 m E of EL DAFFODIL Short: 1.5 m E of WL HOUSE	Long: of Short: 0.9 m W of SC	
99 TEAKWOOD AV RESIDENTIAL	COPPER 19 mm	0.2 m	Long: 28.3 m E of EL DAFFODIL Short: 2.8 m E of WL HOUSE	Long: of Short: 0.8 m W of SC	
98 TEAKWOOD AV RESIDENTIAL	COPPER 19 mm	0.2 m	Long: 37.2 m E of EL DAFFODIL Short: 2.3 m W of EL HOUSE	Long: of Short: 0.7 m W of SC	
97 TEAKWOOD AV RESIDENTIAL	COPPER 19 mm	0.3 m	Long: 50.4 m W of 2ND HYD. W SINCLAIR Short: 4.9 m E of WL HOUSE	Long: of Short: of	
96 TEAKWOOD AV RESIDENTIAL	COPPER 19 mm	0.2 m	Long: 51.7 m W of 2ND HYD. W SINCLAIR Short: 5.1 m W of EL HOUSE	Long: of Short: 0.9 m W of SC	
94 TEAKWOOD AV RESIDENTIAL	COPPER 19 mm	0.2 m	Long: 37.0 m W of 2ND HYD. W SINCLAIR Short: 2.1 m W of EL HOUSE	Long: of Short: 0.9 m W of SC	
93 TEAKWOOD AV RESIDENTIAL	COPPER 19 mm	0.3 m	Long: 35.2 m W of 2ND HYD. W SINCLAIR Short: 4.5 m E of WL HOUSE	Long: of Short: 0.5 m E of SC	
92 TEAKWOOD AV RESIDENTIAL	COPPER 19 mm	0.2 m	Long: 24.2 m W of 2ND HYD. W SINCLAIR Short: 3.6 m W of EL HOUSE	Long: of Short: 1.1 m W of SC	
91 TEAKWOOD AV RESIDENTIAL	COPPER 19 mm	0.2 m	Long: 19.8 m W of 2ND HYD. W SINCLAIR Short: 3.7 m E of WL HOUSE	Long: of Short: 0.9 m W of SC	AUG 15/03 IN FOR DIG OUT

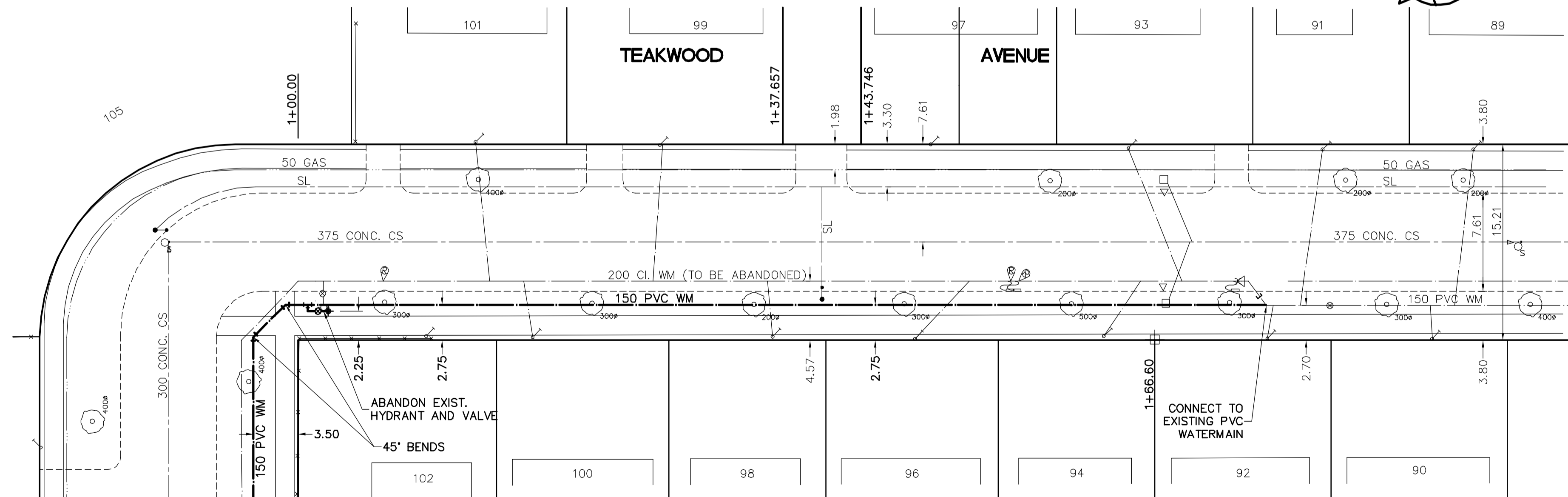

- CONSTRUCTION NOTES**
- EXPOSE WATERMAIN CONNECTIONS AND CONFIRM INVERTS PRIOR TO CONSTRUCTION.
  - INSTALL WATERMAIN BY TRENCHLESS METHODS.
  - ALL MATERIALS SHALL CONFORM TO THE CITY OF WINNIPEG STANDARD CONSTRUCTION SPECIFICATIONS.
  - MINIMUM COVER TO TOP OF PROPOSED WATERMAIN SHALL BE 2.5m FROM STREET CENTERLINE.
  - INSTALL ALL HYDRANTS WITH FLANGE ELEVATION 50mm- 150mm ABOVE FINISHED GRADE.
  - REPLACE ALL EXISTING LEAD SERVICES FROM THE PROPOSED WATERMAIN TO PROPERTY LINE.
  - NOTIFY ALL AFFECTED RESIDENTS AND BUSINESSES 24 HOURS IN ADVANCE OF ANY WATER SHUTDOWN OR DISRUPTION OF SERVICE.
  - LOCATION OF PREVIOUS WATERMAIN BREAKS SHOWN THUS ⊗ IS APPROXIMATE AND FOR INFORMATION ONLY. NO GUARANTEE IS GIVEN TO THE COMPLETENESS OR ACCURACY OF THIS INFORMATION.
  - LOCATION OF WATER SERVICES SHOWN ON DRAWINGS ARE APPROXIMATE. THE CONTRACTOR SHALL FIELD LOCATE ALL WATER SERVICES PRIOR TO CONSTRUCTION.
  - ALL VALVES SHALL BE BLACK TOP (CLOCKWISE TO CLOSE).
  - BACKFILL UNDER OR WITHIN 1.0m OF PAVEMENTS, INCLUDING SIDEWALKS SHALL BE CLASS 3 BACKFILL EXCEPT AS NOTED. BACKFILL IN BOULEVARDS SHALL BE CLASS 5 BACKFILL.

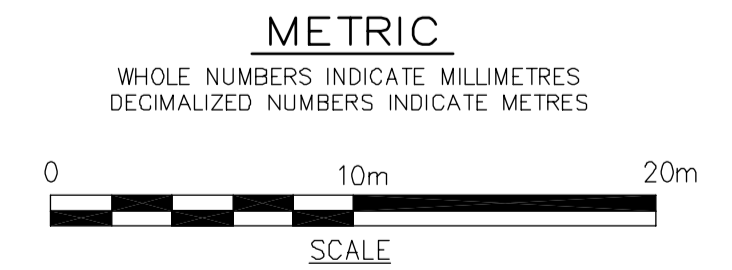

**APEGM**  
Certificate of Authorization  
Earth Tech Canada Inc.  
No. 730 Expiry: April 30, 2004

150 mm W.M.	150 mm W.M.	150 mm W.M.	150 mm W.M.	150 mm W.M.	150 mm W.M.	150 mm W.M.	150 mm W.M.	150 mm W.M.	150 mm W.M.
WATERMAIN	WATERMAIN	WATERMAIN	WATERMAIN	WATERMAIN	WATERMAIN	WATERMAIN	WATERMAIN	WATERMAIN	WATERMAIN
HYDRANT	HYDRANT	HYDRANT	HYDRANT	HYDRANT	HYDRANT	HYDRANT	HYDRANT	HYDRANT	HYDRANT
VALVE	VALVE	VALVE	VALVE	VALVE	VALVE	VALVE	VALVE	VALVE	VALVE
LAND DRAINAGE SEWER	LAND DRAINAGE SEWER	LAND DRAINAGE SEWER	LAND DRAINAGE SEWER	LAND DRAINAGE SEWER	LAND DRAINAGE SEWER	LAND DRAINAGE SEWER	LAND DRAINAGE SEWER	LAND DRAINAGE SEWER	LAND DRAINAGE SEWER
WASTEWATER SEWER	WASTEWATER SEWER	WASTEWATER SEWER	WASTEWATER SEWER	WASTEWATER SEWER	WASTEWATER SEWER	WASTEWATER SEWER	WASTEWATER SEWER	WASTEWATER SEWER	WASTEWATER SEWER
MANHOLE	MANHOLE	MANHOLE	MANHOLE	MANHOLE	MANHOLE	MANHOLE	MANHOLE	MANHOLE	MANHOLE
CATCH BASIN	CATCH BASIN	CATCH BASIN	CATCH BASIN	CATCH BASIN	CATCH BASIN	CATCH BASIN	CATCH BASIN	CATCH BASIN	CATCH BASIN
CURB INLET	CURB INLET	CURB INLET	CURB INLET	CURB INLET	CURB INLET	CURB INLET	CURB INLET	CURB INLET	CURB INLET
JUNCTIONS	JUNCTIONS	JUNCTIONS	JUNCTIONS	JUNCTIONS	JUNCTIONS	JUNCTIONS	JUNCTIONS	JUNCTIONS	JUNCTIONS
CULVERT	CULVERT	CULVERT	CULVERT	CULVERT	CULVERT	CULVERT	CULVERT	CULVERT	CULVERT
GAS	GAS	GAS	GAS	GAS	GAS	GAS	GAS	GAS	GAS
EXISTING	LEGEND - PLAN	PROPOSED	EXISTING	LEGEND - PLAN	PROPOSED	EXISTING	LEGEND - PROFILE	PROPOSED	EXISTING

**LOCATION APPROVED UNDERGROUND STRUCTURES**

SUPV. U/G STRUCTURES DATE COMMITTEE

**NOTE:**  
LOCATION OF UNDERGROUND STRUCTURES AS SHOWN ARE BASED ON THE BEST INFORMATION AVAILABLE. BUT NO GUARANTEE IS GIVEN THAT THE GIVEN LOCATIONS ARE EXACT. CONFIRMATION OF EXISTENCE AND EXACT LOCATION OF ALL SERVICES MUST BE OBTAINED FROM THE INDIVIDUAL UTILITIES BEFORE PROCEEDING WITH CONSTRUCTION.

B.M. 13-015	N.W. COR. POWERS ST & KINSBURY AVE. TBLT. IN W. CONC. FOUNDATION No. 1010 POWERS ST. 0.5m S. & 0.1m BELOW BRICK S.E. CORNER
ELEV. 231.100	
ISSUED FOR TENDER	2004/4/27 GSK
NO. REVISIONS	DATE BY

**EARTH TECH**  
ATYCO INTERNATIONAL LTD. COMPANY  
Earth Tech (Canada) Inc. Winnipeg, Manitoba 204.477.5381

DESIGNED BY GSK CHECKED BY GSK  
DRAWN BY GDL APPROVED BY  
HOR. SCALE: 1:250 RELEASED FOR CONSTRUCTION BY: K.R. ZUREK  
VERTICAL SCALE: 1:50 DATE 2004/03/01 DATE APRIL 27, 2004

ENGINEER'S SEAL  
ORIGINAL SIGNED BY J. E. HUTCHISON 2004/04/27  
CONSULTANT DRAWING NO. 76531-C08

**THE CITY OF WINNIPEG**  
Winnipeg WATER AND WASTE DEPARTMENT

**WATERMAIN RENEWALS**  
CONTRACT No. 5

TEAKWOOD AVENUE  
DAFFODIL STREET TO  
75m EAST OF DAFFODIL STREET

SHEET 8 OF 19  
CITY DRAWING NUMBER D-8533