

NOTE: CHAINAGES SHOWN ARE ALONG E.  $\mathcal{R}$  OF CLIFTON ST.

CLIFTON STREET

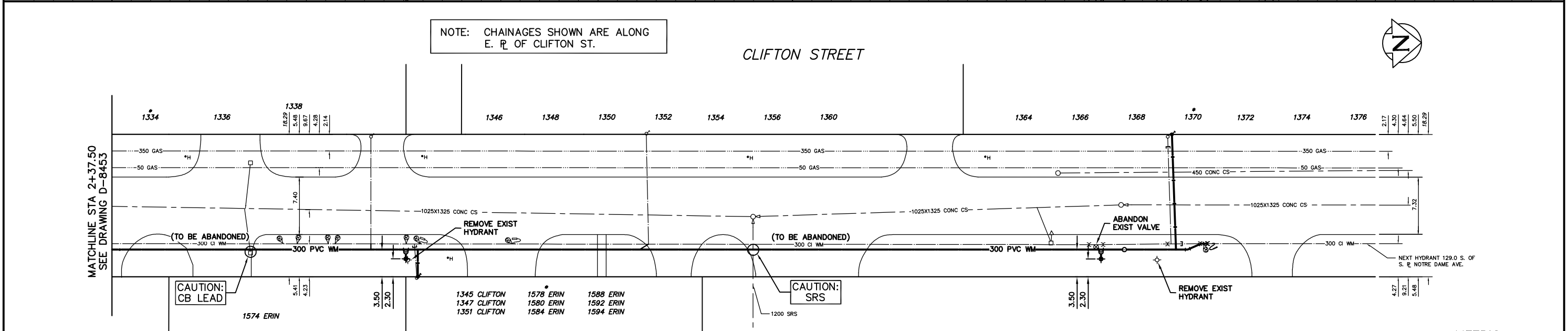

ADDRESS	SIZE(mm) & TYPE (STREET)	SIZE(mm) & TYPE (PROP)	SHORT & LONG MEASUREMENT	CORP LOCATION	REMARKS
1334 CLIFTON ST COMMERCIAL	19 COPPER	19 COPPER	24.1 NSL BLDG	4.11 S OF S/C	DIRECT TAP. W SIDE MAIN RENEW W/ 25 COPPER
1338 CLIFTON ST COMMERCIAL	25 COPPER	25 COPPER	48.0 N 1ST HYD N RICHARD	GPP S/C	
1345 CLIFTON ST COMMERCIAL	19 COPPER	19 COPPER	3.75 SNL BLDG	0.3 S OF S/C	RENEW W/ 25 COPPER
1346 CLIFTON ST COMMERCIAL	25 COPPER	25 COPPER	4.72 S 2ND HYD N RICHARD		
1348 CLIFTON ST COMMERCIAL	25 COPPER	25 COPPER	3.91 N 2ND HYD N RICHARD		
1348 CLIFTON ST COMMERCIAL	19 COPPER	19 COPPER	8.38 SNL BLDG	0.3 N OF S/C	REV. TAPPED
1370 CLIFTON ST COMMERCIAL	19 COPPER	19 COPPER	23.77 NSL BLDG		
1574 ERIN ST COMMERCIAL	19 COPPER	19 COPPER	30.9 N 1ST HYD N RICHARD	0.3 S OF S/C	REV. TAP. MULTIPLE METERING RENEW W/ 25 COPPER
			1.52 N 2ND HYD S NOTRE DAME		
			9.91 NSL BLDG		SERV. OFF ERIN
			12.95 SNL BLDG		

\* SERVICES TO BE RENEWED TO  $\mathcal{R}$  ALL OTHERS TO BE RECONNECTED

- CONSTRUCTION NOTES
1. EXPOSE EXISTING WATERMAIN & CONFIRM INVERTS PRIOR TO CONSTRUCTION.
  2. LOCATION OF ALL SERVICES TO BE CONFIRMED IN THE FIELD.
  3. INSTALL WATERMAIN BY TRENCHLESS METHODS.
  4. TRENCHES AND EXCAVATIONS WITHIN 1 METRE OF A PAVED AREA INCLUDING SIDEWALKS SHALL BE CLASS 3 BACKFILL.
  5. ALL MATERIALS SHALL CONFORM TO THE CITY OF WINNIPEG STANDARD CONSTRUCTION SPECIFICATIONS.
  6. MINIMUM COVER TO TOP OF WATERMAIN SHALL BE 2.4 m.
  7. REPLACE ALL EXISTING LEAD SERVICES FROM PROPOSED WATERMAIN TO  $\mathcal{R}$ .
  8. NOTIFY ALL AFFECTED RESIDENTS AND BUSINESSES 24 HOURS IN ADVANCE OF ANY WATER SHUTDOWNS OR DISRUPTION OF SERVICE.

**METRIC**  
WHOLE NUMBERS INDICATE MILLIMETRES  
DECIMALIZED NUMBERS INDICATE METRES

NOTE: ALL VALVES TO BE INSTALLED COUNTERCLOCKWISE TO CLOSE

**WARNING**

IF POWER EQUIPMENT OR EXPLOSIVES ARE TO BE USED FOR EXCAVATION ON THIS PROJECT THE CONTRACTOR MUST:

- 1) NOTIFY THE GAS COMPANY OF THE PROPOSED LOCATION OF EXCAVATION.
- 2) TAKE PRECAUTION TO AVOID DAMAGE TO GAS COMPANY INSTALLATIONS.

SEE PROVINCIAL REGULATION 210/72 FOR DETAILS

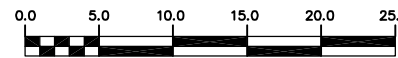

200 WM	WATERMAIN	200 WM	SL, HYDRO	150 WM	WATERMAIN	150 WM
$\oplus$	HYDRANT	$\oplus$	MTS	$\oplus$	HYDRANT	$\oplus$
$\circ$	VALVE	$\circ$	TRAFFIC SIGNALS	$\oplus$	VALVE	$\oplus$
$\ominus$	525 LDS LAND DRAINAGE SEWER	$\ominus$	GAS	$\oplus$	525 LDS LAND DRAINAGE SEWER	$\oplus$
$\oplus$	375 WWS WASTEWATER SEWER	$\oplus$	SURVEY BAR	$\oplus$	375 WWS WASTEWATER SEWER	$\oplus$
$\circ$	MANHOLE	$\circ$	FENCE	$\oplus$	$\oplus$	PROFILE
$\square$	CATCH BASIN	$\square$	POLE - HYDRO, MTS	$\oplus$	$\oplus$	GROUND ABOVE PIPE
$\nabla$	CURB INLET	$\nabla$	CURB STOP	$\oplus$	$\oplus$	
$\triangleleft$	REDUCER	$\triangleleft$	GUY ANCHOR	$\oplus$	$\oplus$	
$\times$	COUPLING	$\times$	LIGHT STANDARD	$\oplus$	$\oplus$	
$\oplus$	ANODE	$\oplus$	TREE	$\oplus$	$\oplus$	
EXISTING	LEGEND-PLAN	PROPOSED	EXISTING	LEGEND-PLAN	PROPOSED	EXISTING

LOCATION APPROVED UNDERGROUND STRUCTURES	B.M. ELEV.	FIELD BOOK #:
SUPV. U/O STRUCTURES COMMITTEE		
DATE		
NOTE:		
LOCATION OF UNDERGROUND STRUCTURES AS SHOWN ARE BASED ON THE BEST INFORMATION AVAILABLE BUT NO GUARANTEE IS GIVEN THAT THE GIVEN LOCATIONS ARE EXACT. CONFIRMATION OF EXISTENCE AND EXACT LOCATION OF ALL SERVICES MUST BE OBTAINED FROM THE INDIVIDUAL UTILITIES BEFORE PROCEEDING WITH CONSTRUCTION.		

NO.	REVISIONS	DATE	BY

**CITY OF WINNIPEG WATER AND WASTE ENGINEERING DIVISION**

DESIGNED BY DS/CJH  
CHECKED BY TW

DRAWN BY CJH  
APPROVED BY KZ

HOR. SCALE 1:250  
VERTICAL 1:50

RELEASED FOR CONSTRUCTION  
DATE 2004 04 07

ENGINEER'S SEAL

ORIGINAL SIGNED BY K.R. ZUREK  
04/04/19

BID OPPORTUNITY: 151-2004  
FILENAME: D-8453 to D-8453A.dwg  
PLOT DATE: 2004 04 20

**THE CITY OF WINNIPEG WATER AND WASTE DEPARTMENT**

2004 WATERMAIN RENEWALS

**CLIFTON STREET**  
140 m N OF RICHARD AVENUE TO  
302 m N OF RICHARD AVENUE

SHEET 4 OF 10  
CITY DRAWING NUMBER  
D-8453A