

FOUNDATION and MAIN FLOOR FRAMING PLAN
SCALE 1:25

PRECAST PILE SCHEDULE	
MARK	PILE DIAMETER
P1	300 DIA. HEX.
P2	350 DIA. HEX.
P3	400 DIA. HEX.

CONCRETE BEAM SCHEDULE					
MARK	BEAM SIZE (W x D)	TOP RFG. CONT.	BOTTOM RFG. CONT.	STIRRUPS FROM NO. EA. SUPPORT	REMARKS
B1	250 x 100	2 - 3M	2 - 3M	10M # 450 O/C	1-10M HOR. # 1/3 FTS EA. FACE
B2	250 x 100	2 - 3M	2 - 3M	10M # 450 O/C	1-10M HOR. # 1/3 FTS EA. FACE
B3	200x400 x 100/300	4 - 3M	4 - 3M	10M # 250 O/C	2-10M CONT. PLUS 10M TIES # 250 O/C - UPSTAND
B4	200x300 x 100/100	2-3M, 1-3M	2-3M, 1-3M	10M # 250 O/C	2-10M CONT. PLUS 10M TIES # 250 O/C - UPSTAND

DESIGN LOADS
 MAIN FLOOR OFFICE, CORRIDOR
 LIVE LOAD = 4.8 KPa
 DEAD LOAD = 2.8 KPa
 TOTAL LOAD = 7.6 KPa
 FILE STORAGE AREAS (SHOWN HATCHED)
 LIVE LOAD = 7.2 KPa
 DEAD LOAD = 2.8 KPa
 TOTAL LOAD = 10.0 KPa
 HIGH DENSITY SHELVING
 LIVE LOAD = 9.6 KPa
 DEAD LOAD = 3.2 KPa
 TOTAL LOAD = 12.8 KPa

WELD PLATE SCHEDULE
 WP-1
 200x40x6 WELD PLATE
 200x40x6 DIA. N6 x 150 LG.
CONC. PILASTER SCHEDULE
 PL-1
 600x600x1000 DEEP CONC. PILASTER
 RW 6-20M VERTICALS PLUS 10M TIES # 250 O/C
 PL-2
 450x450 MIN. X1000 DEEP CONC. PILASTER
 RW 6-20M VERTICALS PLUS 10M TIES # 250 O/C

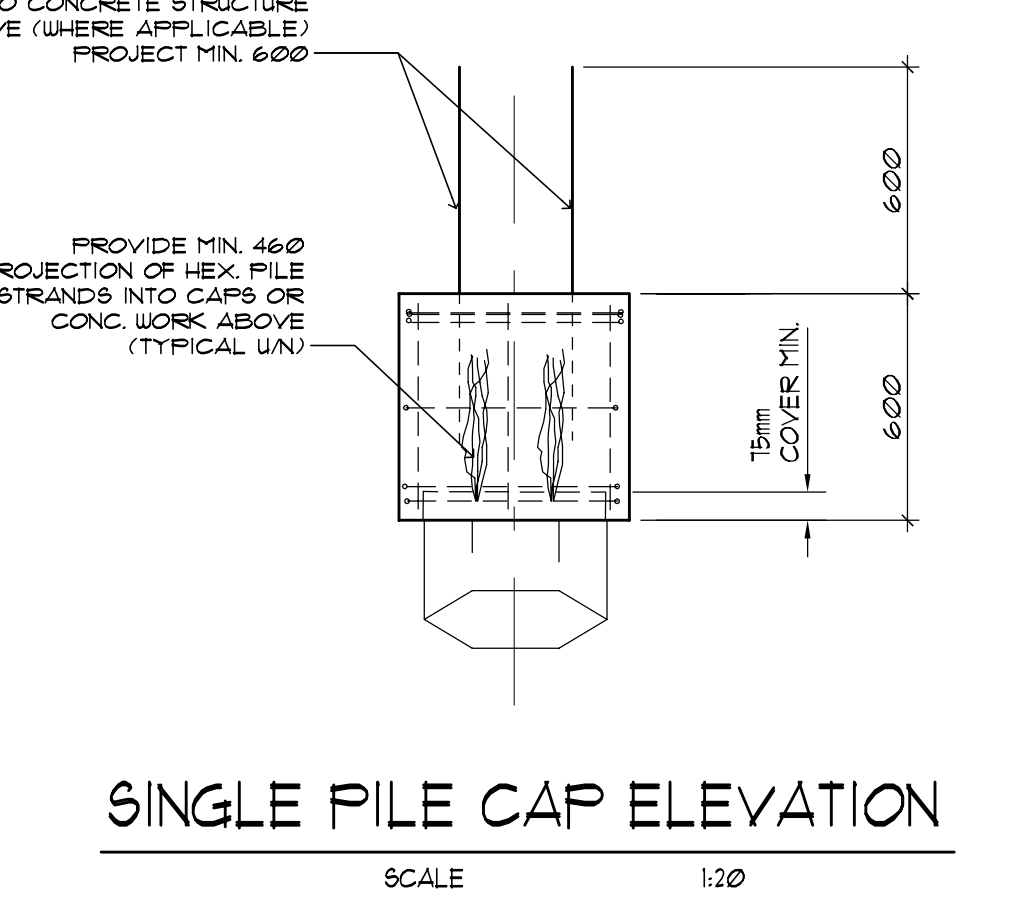
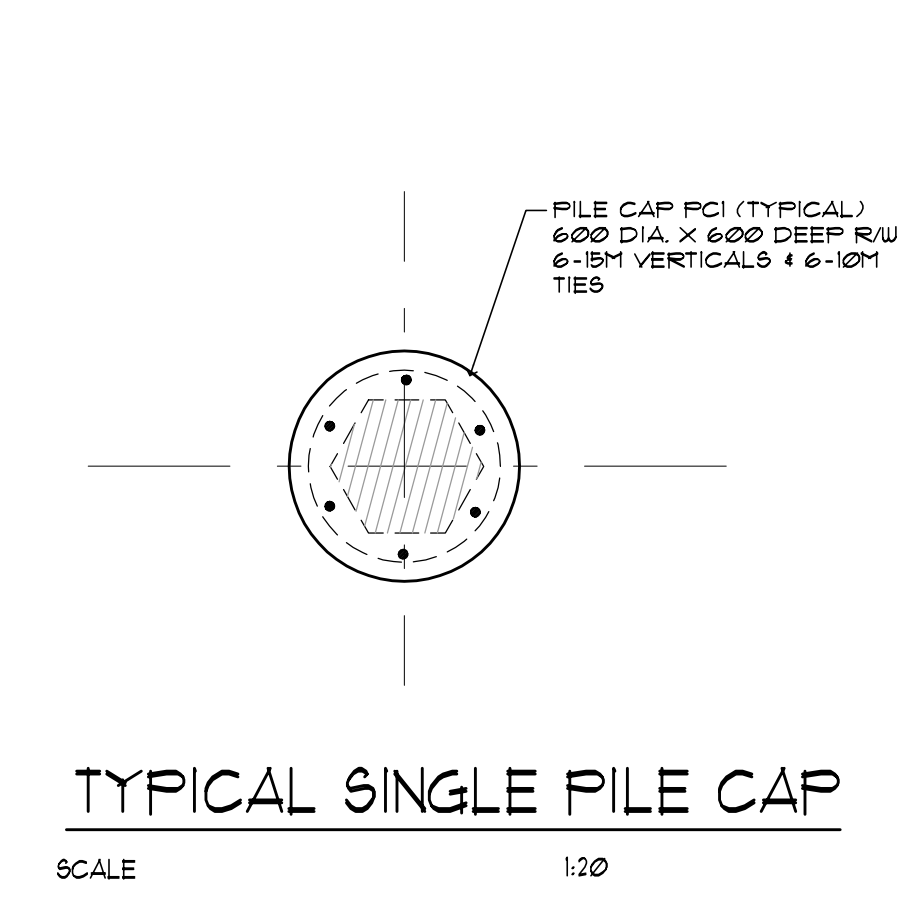

- NOTES:**
- 1- PROVIDE 100 THICK CONC. HOUSEKEEPING PADS AS REQUIRED BY MECH. RW 100 x 300 O/C EA. WAY - COORDINATE EXACT SIZE & LOCATIONS WITH MECHANICAL.
 - 2- SIDEWALK SLABS TO BE 100 CONC. SLABS ON MIN. 150 WELLS COMPACTED GRANULAR FILL, RW 100 x 300 O/C EA. WAY.
 - 3- SEE DETAILS "B" & "C" ON DRAWING S4.1 FOR TYPICAL NON LOAD BEARING MASONRY BLOCK WALL TOP SUPPORT.
 - 4- JOISTS TO BE DESIGNED FOR ADDITIONAL POINT & LINE LOADS FROM MASONRY BLOCK WALLS AS FOLLOWS:
 PARALLEL TO JOISTS - 10.3 kN/m SERVICE PERPENDICULAR TO JOISTS - 15.3 kN SERVICE
 - 5- PROVIDE 60x60x60 UNDER ALL MASONRY BLOCK WALLS RUNNING PERPENDICULAR TO JOISTS - TYPICAL.
 - 6- JOISTS TO BE DESIGNED FOR 16.8 kN SERVICE POINT LOADS IMPOSED BY H.D. RAIL SYSTEM.



OFFICE ADDITION AND RENOVATION
1155 PACIFIC AVENUE
WINNIPEG, MANITOBA

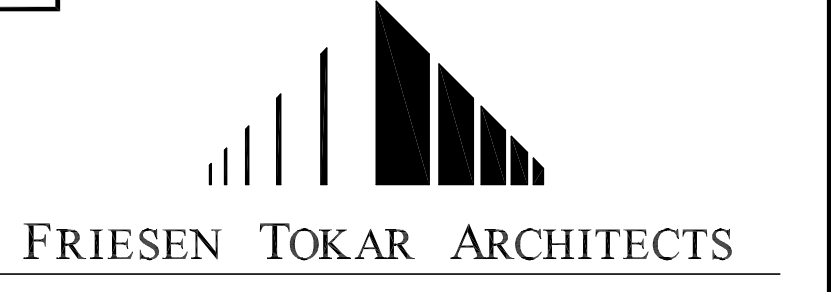

FOUNDATION AND MAIN FLOOR FRAMING PLANS

S1.1

Friesen Tokar Architects
200 - 3333 Portage Avenue
Winnipeg, Canada R3J 0K8
Tel. 204.855.9323
Fax. 204.837.7324

Drawn by: CAML
 Checked by: DP
 Date: 01/20/04
 Project No.: 03135
 File Path:
 Status:
 Issued for Tender
 May 14, 2004

Kowalchuk
Consulting Engineers Ltd.

Drawings and specifications, as instruments of service are the property of the architect. The copyright in the same being reserved to him. No reproduction may be made without the permission of the architect and when made must bear his name. All prints to be returned to the architect. The contractor shall verify dimensions and data noted herein with conditions on the site and is held responsible for reporting any discrepancies to the architect for adjustment. This drawing shall not be used for building purposes until counterchecked by:

THE CITY OF WINNIPEG

PROJECT TITLE

DATE

SCALE