

- NOTES:
- REFER TO DETAIL SHEETS ED-2 AND ED-3.
  - FENCE MOUNTED PARKING OUTLETS. REFER TO ARCHITECTURAL DETAILS. REFER TO ELECTRICAL DETAIL.
  - PROVIDE ADDITIONAL BREAKERS TO MATCH EXISTING FOR NEW DEVICES/CIRCUITS.
  - U/G WIRING FOR ALL LIGHTING TO BE 2/G#10 CU TECK.
  - NEW OUTLETS TO BE W/RED TO EXISTING PANEL. SEE NOTE 3.

Friesen Tokar Architects  
 200 - 2033 Portage Avenue  
 Winnipeg, Canada R2J 0K2  
 Tel. 204.885.9325  
 Fax. 204.837.7255

DESIGN BY: AAI/RC  
 CHECKED BY: CB  
 DATE: APRIL 2004  
 PROJECT NO.:

- REVISIONS:
- ISSUED FOR 50% REVIEW  
FEBRUARY 6, 2004
  - ISSUED FOR 75% REVIEW  
MARCH 5, 2004
  - ISSUED FOR PRETENDER REVIEW  
APRIL 2004
  - ISSUED FOR TENDER  
MAY 14, 2004
  - ISSUED FOR ADDENDUM 1  
JUNE 14, 2004

REVISION TO PARKING LAYOUT

**SMS ENGINEERING**

SMS Engineering Ltd. Consulting Engineers  
 775 Bedford Street Winnipeg MB Canada R2H 0Y0  
 Telephone: (204) 775-0201 Fax: (204) 775-2338  
 smseng.com

ORIGINAL CONTRACT DRAWING  
 SIGNED AND SEALED BY  
 ANDY LOSHE, P.ENG.  
 MAY 12, 2004

**APECN**  
 Certificate of Authorization  
 SMS Engineering Ltd.  
 No. 166 Expiry April 30, 2005

Drawings and specifications, as  
 instruments of service on the  
 property of the architect, the  
 property of the architect and  
 shall remain his. No reproduction  
 may be made without the  
 permission of the architect and  
 when made, shall bear his name.  
 All prints to be returned to the  
 architect.  
 The contractor shall verify  
 dimensions and site conditions  
 with conditions on the site and is  
 held responsible for reporting any  
 discrepancy to the architect for  
 adjustment.  
 This drawing shall not be used for  
 building purposes until  
 countersigned by:

THE  
 CITY OF  
 WINNIPEG

OFFICE ADDITION AND RENOVATION  
 1155 PACIFIC AVENUE  
 WINNIPEG, MANITOBA

**FRIESEN TOKAR ARCHITECTS**

CONTRACT NO. E1.1-R1

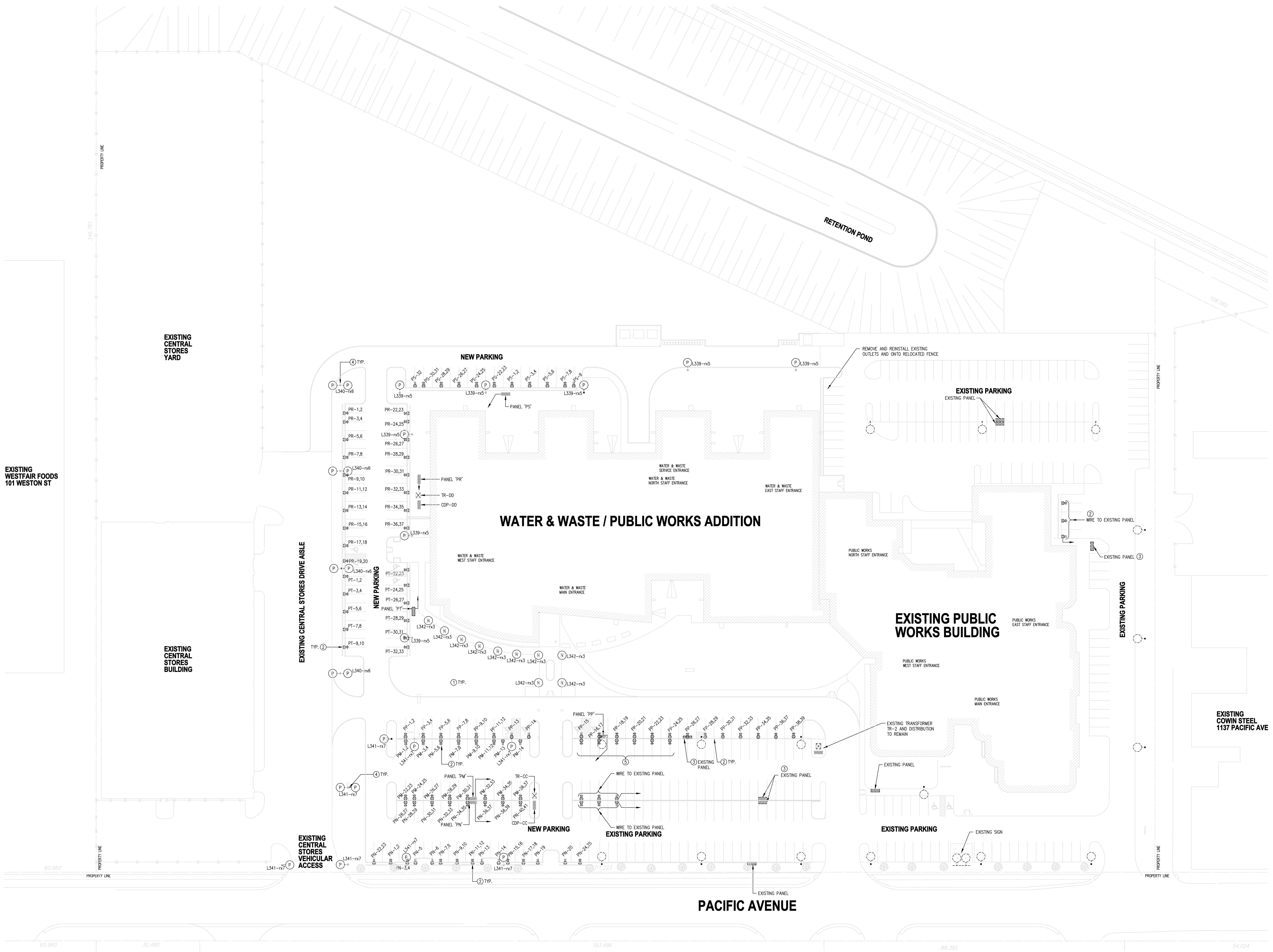

**SITE PLAN**  
 SCALE 1:400

2018e1r1.dwg 6-14-04 8:33:27 am CST