

D. SIZE 22" x 34" (558mm x 863mm)  
 PLOT SCALE: 1:0.25  
 UMA FILE NAME: FID01PR-R-DWG 2004-04-19 3:21pm ADL

EXISTING FEATURES

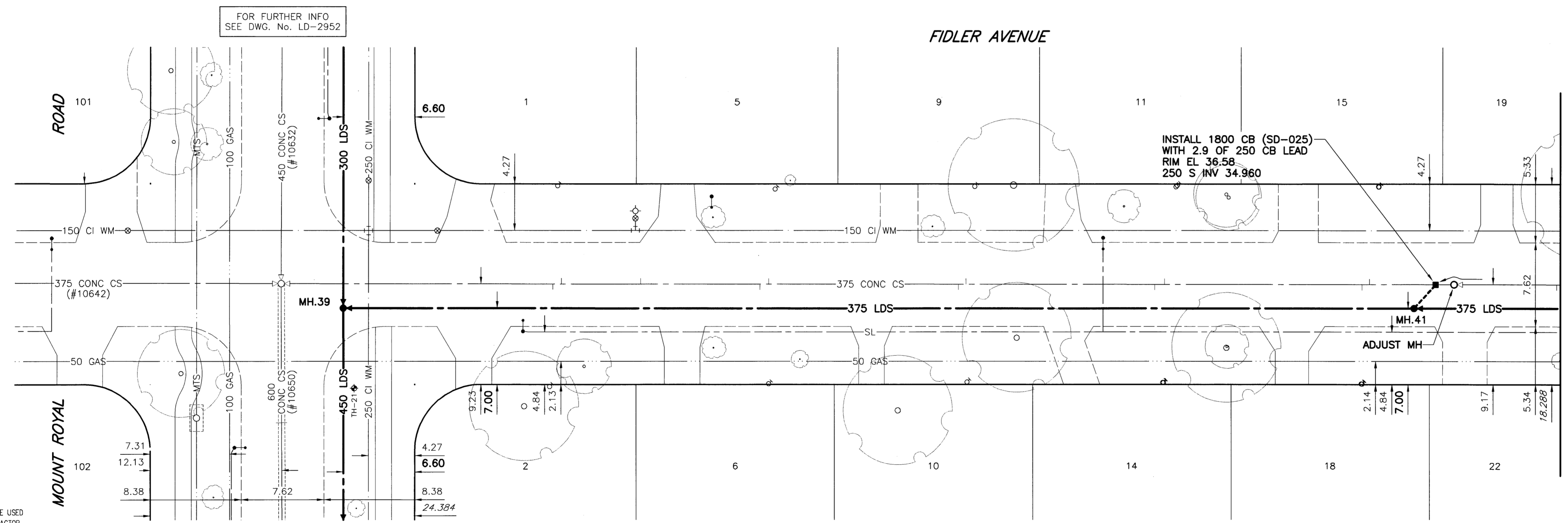
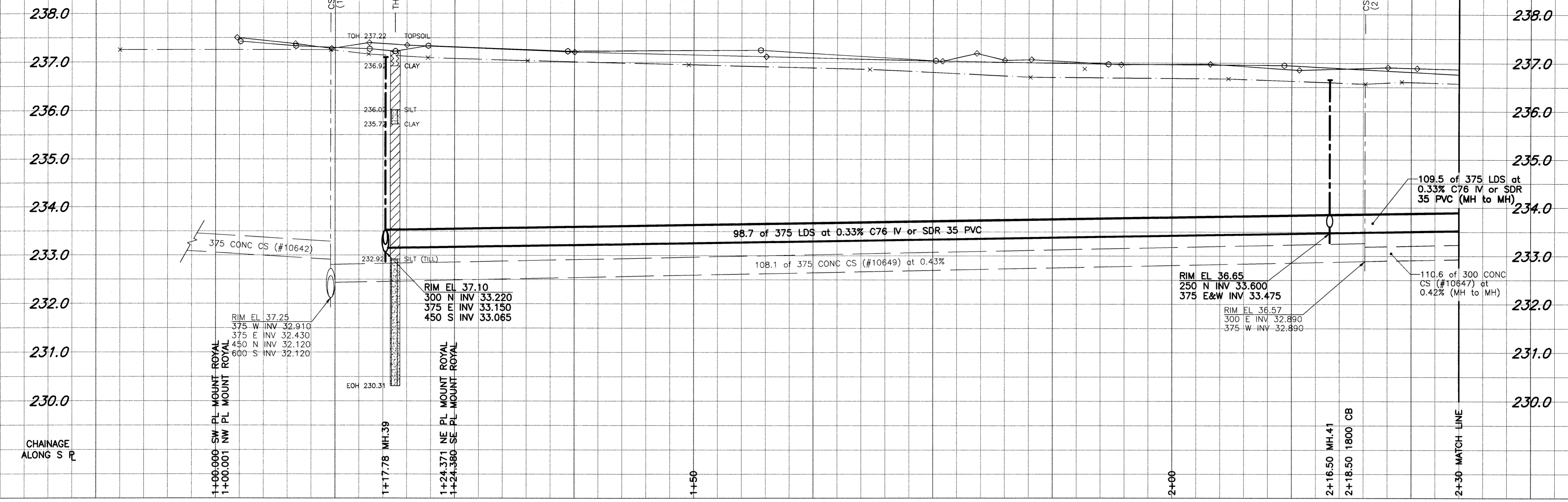

FOR FURTHER INFO SEE DWG. No. LD-2952

FOR FURTHER INFO SEE DWG. No. LD-2952

**WARNING**  
 IF POWER EQUIPMENT OR EXPLOSIVES ARE TO BE USED FOR EXCAVATION ON THIS PROJECT, THE CONTRACTOR MUST:  
 1) NOTIFY THE GAS COMPANY OF THE PROPOSED LOCATION OF EXCAVATION.  
 2) TAKE PRECAUTION TO AVOID DAMAGE TO GAS COMPANY INSTALLATIONS.  
 SEE PROVINCIAL REGULATION 140/92 FOR DETAILS

- CONSTRUCTION NOTES:**
- For detailed test hole information, see specifications.
  - The location of all services is to be confirmed in the field.
  - Install new sewers and catchbasin leads by trenchless methods wherever possible.
  - Renew/Rehabilitate catchbasins & renew catchbasin leads where noted.

150 mm WM	WATERMAIN	150 mm WM	HYDRO	150 mm WM	WATERMAIN
	HYDRANT		MTS		HYDRANT
	VALVE		GAS		VALVE
	LAND DRAINAGE SEWER		CONCRETE		LAND DRAINAGE SEWER
	WASTE WATER SEWER		ASPHALT		WASTE WATER SEWER
	MANHOLE		CURB STOP		MANHOLE
	CATCH BASIN		REDUCER		CATCH BASIN
	CURB INLET		COUPLING		CURB INLET
	CULVERT		ANODE		CULVERT
	SURVEY BAR		WM MONITORING STATION		SURVEY BAR
	PIPE ABANDONMENTS				PIPE ABANDONMENTS
	EXISTING		EXISTING		PROPOSED

**LOCATION APPROVED UNDERGROUND STRUCTURES**

DATE: \_\_\_\_\_

NOTE: LOCATION OF UNDERGROUND STRUCTURES AS SHOWN ARE BASED ON THE BEST INFORMATION AVAILABLE. BUT NO GUARANTEE IS GIVEN THAT ALL EXISTING UTILITIES ARE SHOWN OR THAT THE GIVEN LOCATIONS ARE EXACT. CONFIRMATION OF EXISTENCE AND EXACT LOCATION OF ALL SERVICES MUST BE OBTAINED FROM THE INDIVIDUAL UTILITIES BEFORE PROCEEDING WITH CONSTRUCTION.

**UMA Engineering Ltd.**  
 Consulting • Engineering • Construction • Management Services

DESIGNED BY: FMI  
 CHECKED BY: CCA

DRAWN BY: ADL  
 APPROVED BY: [Signature]

HOR. SCALE: 1:250  
 VERTICAL: 1:50

DATE: 02/02/04

**APECM**  
 Certificate of Authorization  
 UMA Engineering Ltd.  
 No. 256 Expiry: April 30, 2004

ENGINEER'S SEAL  
 PROVINCE OF MANITOBA  
 20 APR 04  
 C.C. MACEY  
 REGISTERED ENGINEER

CONSULTANT DRAWING NO. 08  
 D265-096-03

**THE CITY OF WINNIPEG**  
 WATER AND WASTE DEPARTMENT

STRATHMILLAN/MOORGATE  
 COMBINED SEWER RELIEF  
 CONTRACT 6

FIDLER AVENUE (S. LEG)  
 MOUNT ROYAL RD.  
 to 103m E of FIDLER AVE. (E. LEG)

SHEET 08 OF 15  
 CITY DRAWING NUMBER LD-2953  
 REV

Bid Opportunity No. 141-2004