

BARNES STREET
RIGHT OF WAY CROSS SECTION
HOR. 1 : 200, VER. 1 : 100

NOTE:
CHAINAGE IS ALONG WEST PROPERTY LINE
OF BARNES STREET.

SEE DRAWING C0012

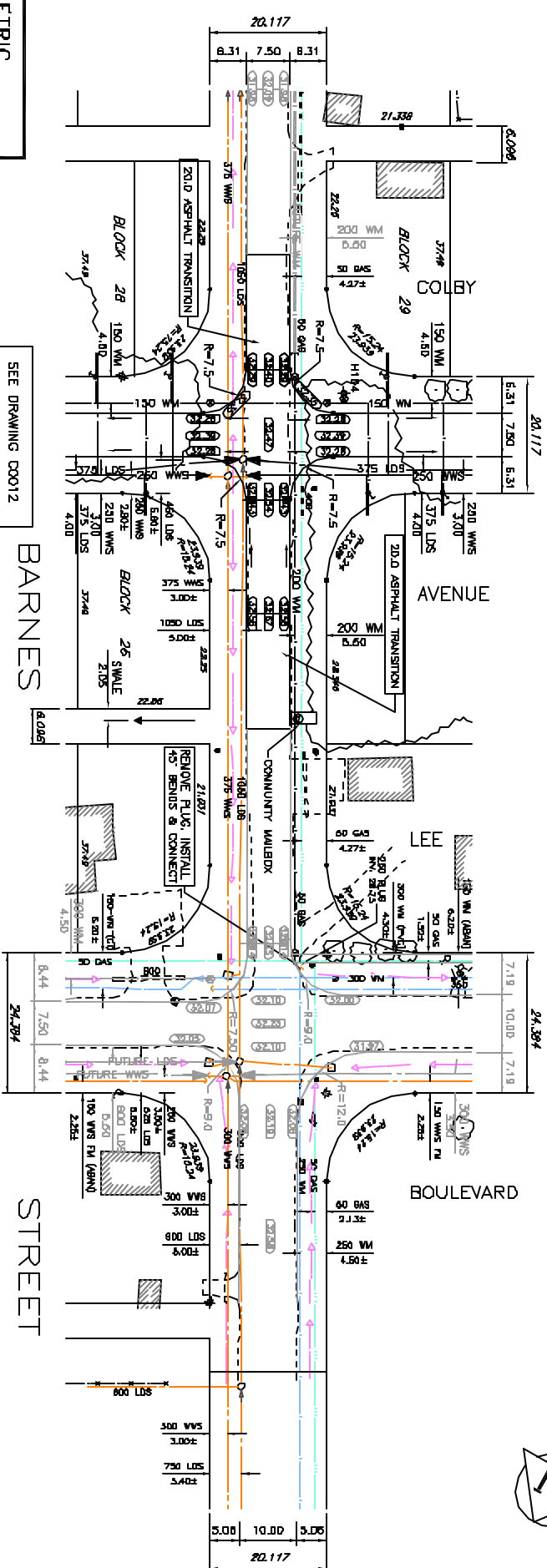

METRIC
WHOLE NUMBERS ARE IN MILLIMETERS
DECIMALS NUMBERS ARE IN METERS

SEE DRAWING C0012

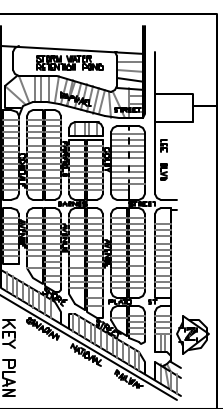

- CONSTRUCTION NOTES:
1. WATERMAIN TO HAVE MINIMUM 2.0M COVER TO FROM CENTERLINE OF PAVEMENT.
 2. ALL C/SB TO BE 75MM LP C/SB UNLESS OTHERWISE NOTED.
 3. ALL CONDUITING TO BE 40 PER 60-224 UNLESS OTHERWISE NOTED.
 4. ALL TRENCHES TO BE AS PER 60-1008 AND 50M FROM PROPERTY LINE.
 5. ALL CONDUIT TO BE 200MM AT NOTES.
 6. WORKED BARNES QUAD AT ALL INTERSECTION MARK - 50M THICKNESS.
 7. ALL BENTONITE UNILINES USED FOR CONDUITING TO BE 100MM PERIOD REFER TO CONSTRUCTION.
 8. ALL GRANULAR SANDSTONE ARE TO SHOWN ON DRAWING.
 9. ALL PRE-BIDGET LUMBER BOLLEWED TO BE CLASS 4 UNLESS OTHERWISE NOTED.
 10. ALL PRE-LAMER POSING ON FLOOR PAVEMENT TO BE CORED OR 140 CLASS 2 BUCKLE.
 11. ALL LAND DRAINAGE SLOPE PER TO BE 0.1% C. II UNLESS OTHERWISE NOTED.
 12. ALL WATERMAIN PER TO BE PER 18-18.
 13. ALL ASPHALT TO BE 100MM THICK.

EXISTING	PROPOSED	LEGEND-PLAN	PROPOSED	LEGEND-PLAN	PROPOSED	LEGEND-PLAN
WATERMAIN	QMS	DITCH/SWALE	PROPOSED	LEGEND-PLAN	PROPOSED	LEGEND-PLAN
HYDRANT	M.T.S.	HYDRANT POLE	PROPOSED	LEGEND-PLAN	PROPOSED	LEGEND-PLAN
VALVE	CONCRETE	ANCHOR	PROPOSED	LEGEND-PLAN	PROPOSED	LEGEND-PLAN
LAND DRAINAGE SEWER	300 LBS	RAINING STONE	PROPOSED	LEGEND-PLAN	PROPOSED	LEGEND-PLAN
200 WMS	200 WMS	CONCRETE CURB	PROPOSED	LEGEND-PLAN	PROPOSED	LEGEND-PLAN
MANHOLE	CONCRETE CURB	BLUSHLINE	PROPOSED	LEGEND-PLAN	PROPOSED	LEGEND-PLAN
CATCH-BASIN	CONCRETE CURB	SURVEY BAR	PROPOSED	LEGEND-PLAN	PROPOSED	LEGEND-PLAN
CLUB NILET	GRAVEL	LEGAL UNIT	PROPOSED	LEGEND-PLAN	PROPOSED	LEGEND-PLAN
JUNCTIONS	PROPERTY LINE	BUILDING	PROPOSED	LEGEND-PLAN	PROPOSED	LEGEND-PLAN
GULLBERT	LOT LINE	TEST HOLE	PROPOSED	LEGEND-PLAN	PROPOSED	LEGEND-PLAN
LEGEND-PLAN	PROPOSED	LEGEND-PLAN	PROPOSED	LEGEND-PLAN	PROPOSED	LEGEND-PLAN

LOCATION APPROVED UNDERGROUND STRUCTURES	DATE	NO. REVISIONS

DATE	BY	DATE	BY

WINTRUP Engineering Inc.
 ORIGINAL DRAWING
 REVISION: 0, SEALED BY
 SEE HANDSH
 04.00.28

THE CITY OF WINNIPEG
 PROPERTY, PLANNING & DEVELOPMENT DEPARTMENT
 FAIRFIELD PARK LOCAL IMPROVEMENT DISTRICT
 STAGE 1, 2004 SEWER, WATER, AND ROAD CONSTRUCTION,
 AND ASSOCIATED WORKS.

BARNES STREET
 30M NORTH OF FAIRFIELD AVENUE
 TO 40M NORTH OF LEE BOULEVARD

SHEET 5 OF 6
 C0014