

- CONSTRUCTION NOTES:**
1. WATERMAIN TO HAVE MINIMUM 50% COVER TO FROM BOTTOM OF MANHOLE OR RIMLINE UNLESS OTHERWISE NOTED
 2. ALL CATCH BASINS TO BE 750mm LP D&B UNLESS OTHERWISE NOTED
 3. ALL CATCH-BASINS TO BE AS PER 50-224 UNLESS OTHERWISE NOTED
 4. ALL HIGHWAYS TO BE AS PER 50-008 AND 24m FROM PROPERTY LINE
 5. ALL CATCH-BASIN LIDS TO BE 250mm AT MINIMUM 1.5% UNLESS OTHERWISE NOTED
 6. ACCEPTED BARRED CURB AT ALL INTERSECTIONS FROM 30m TRANSECTION
 7. ALL EXISTING UTILITIES LINED FROM FROM 10' TO 15' DEPTH
 8. ALL EXISTING UTILITIES ARE TO BE BACK FILL TO ORIGINAL GRADE
 9. ALL GRIE BARRIERS UNDER ROADWAY TO BE CLASS 1 UNLESS OTHERWISE NOTED
 10. ALL GRIE UNDER CONCRETE OR ASPHALT PAVEMENT TO BE CLASS 2 UNLESS OTHERWISE NOTED
 11. ALL LAND DRAINAGE STOPS PRE TO BE CLASS 2 UNLESS OTHERWISE NOTED
 12. ALL WATERMAIN PRE TO BE PVC DN-18
 13. ALL ASPHALT TO BE 100mm THICK

METRIC
WHOLE NUMBERS ARE IN MILLIMETRES
DECIMALIZED NUMBERS ARE IN METRES

COLBY AVENUE
NOTE:
CHAINAGE IS ALONG CENTRELINE OF COLBY AVENUE RIGHT OF WAY.

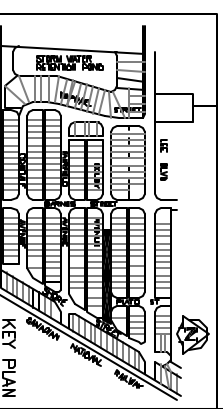

EXISTING	PROPOSED	EXISTING	PROPOSED	EXISTING	PROPOSED
WATERMAIN	QMS	DITCH/SWALE	QMS	LOCATION APPROVED UNDERGROUND STRUCTURES	DATE
HYDRANT	M.T.S.	HYDRO POLE	HYDRO POLE	BLD. SHT. OR FINISHED NO. 82-028	CA. No. 2078
VALVE	CONCRETE	ANCHOR	ANCHOR		
300 LBS LAND DRAINAGE SEWER	300 LBS	SOBBANK	SOBBANK		
250 WWS	250 WWS	PAVING STONE	PAVING STONE		
MANHOLE	CONCRETE CURB	BUSHLINE	BUSHLINE		
CATCH-BASIN	SIDEWALK RAMP	SURVEY BAR	SURVEY BAR		
CLUB NILET	GRAVEL	LEGAL UNIT	LEGAL UNIT		
JUNCTIONS	PROPERTY LINE	BUILDING	BUILDING		
CULVERT	LOT LINE	TEST HOLE	TEST HOLE		
LEGEND-PLAN	PROPOSED	LEGEND-PLAN	PROPOSED		

NO.	REVISION	DATE	BY
0	ISSUED FOR TENDER	04.05.23	BT
1	ISSUED FOR APPROVAL	04.05.23	BT

DATE	BY	DATE	BY
04.03.12	BT	04.03.12	BT

DATE	BY	DATE	BY
04.03.12	BT	04.03.12	BT

DATE	BY	DATE	BY
04.03.12	BT	04.03.12	BT

DATE	BY	DATE	BY
04.03.12	BT	04.03.12	BT

DATE	BY	DATE	BY
04.03.12	BT	04.03.12	BT

DATE	BY	DATE	BY
04.03.12	BT	04.03.12	BT

WINIPEG Engineering Inc.

ORIGINAL DRAWING
REVISION 0, SEALED BY
S.E. HANWISH
04.05.23

THE CITY OF WINIPEG
PROPERTY, PLANNING & DEVELOPMENT DEPARTMENT
FAIRFIELD PARK LOCAL IMPROVEMENT DISTRICT
STAGE 1, 2004 SEWER, WATER, AND ROAD CONSTRUCTION,
AND ASSOCIATED WORKS.

DT DRAWING NUMBER
D-8486
SHEET 4 OF 6

COLBY AVENUE
FROM EAST OF BARNES STREET
TO SHORE STREET

C0013