

DWG NORTH

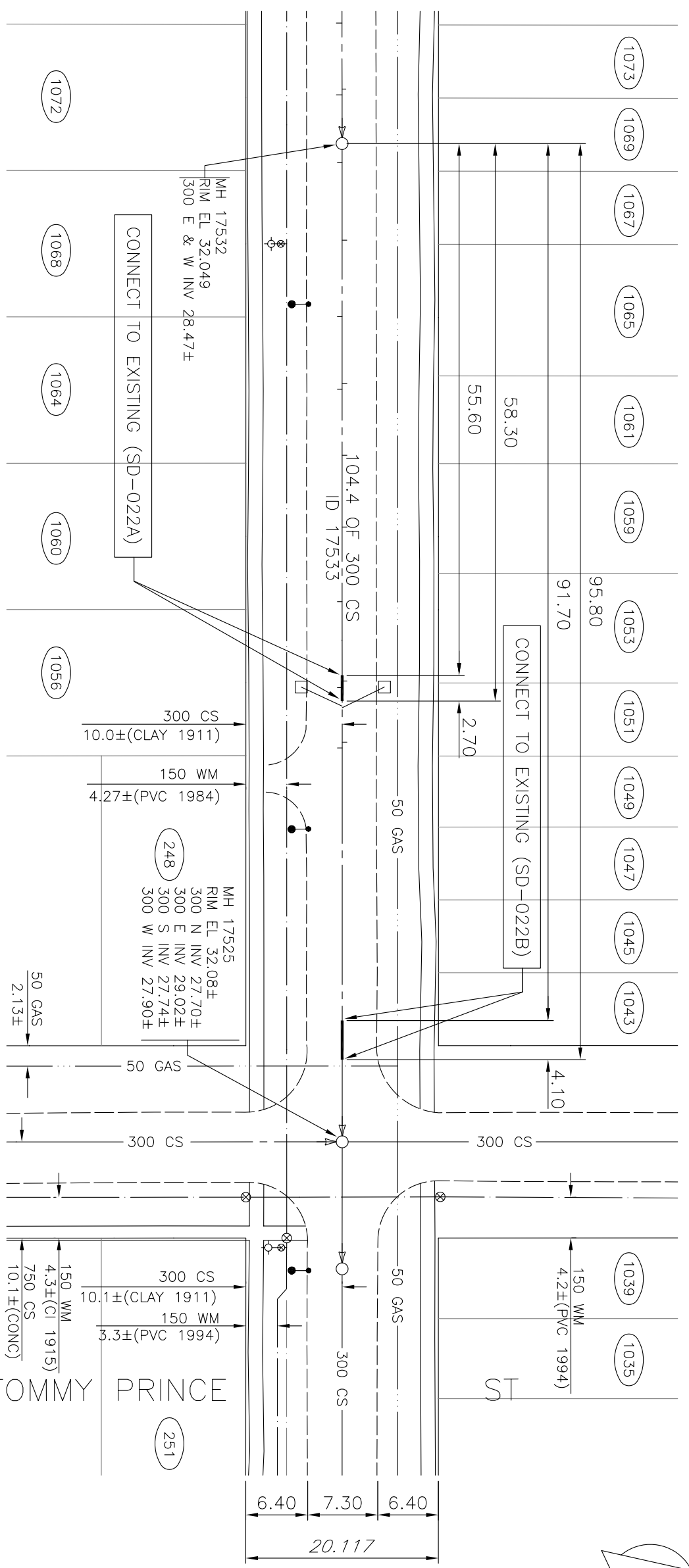

ALFRED AVENUE
SGT TOMMY PRINCE

NOTE:
LOCATION OF UNDERGROUND STRUCTURES AS SHOWN ARE BASED ON THE BEST INFORMATION AVAILABLE. BUT NO GUARANTEE IS GIVEN THAT ALL EXISTING UTILITIES ARE SHOWN OR THAT THE GIVEN LOCATIONS ARE EXACT. CONFIRMATION OF EXISTENCE AND EXACT LOCATION OF ALL SERVICES MUST BE OBTAINED FROM THE INDIVIDUAL UTILITIES BEFORE PROCEEDING WITH CONSTRUCTION.

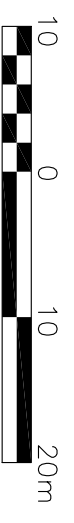

SEWER	MANHOLE	REPAIR AREA	
WATERMAIN	HYDRO POLE		
GAS	HYDRANT		
HYDRO	VALVE		
MTS	CATCHBASIN		
CONCRETE CURB	CURB INLET		
SIDEWALK	LIGHT STANDARD		
PROPERTY LINE	ADDRESS		
LEGEND - EXISTING	LEGEND - EXISTING	LEGEND - PROPOSED	LEGEND - PROPOSED

THE CITY OF WINNIPEG
 WATER AND WASTE DEPARTMENT
WARDROP Engineering Inc.

2004 COMBINED SEWER RENEWALS	DESIGNED BY: TY	DRAWN BY: GEL	CITY DWG NUMBER
EXTERNAL POINT REPAIRS	CHECKED BY: HAK	DATE: 04.04.15	05374
ALFRED AVENUE			
1st MANHOLE WEST OF SGT TOMMY PRINCE			
TO MANHOLE AT SGT TOMMY PRINCE			

AP EGM
 Certificate of Authorization
 Wardrop Engineering Inc.
 No. 195 Expiry: April 30, 2004