

TYPICAL CROSS SECTION

DESCRIPTION	RIM	INVERT			
		NORTH	SOUTH	EAST	WEST
CB 9	31.745		30.145		
CB 10	31.745	30.145			
CB 11	31.755		30.155		
CB 12	31.755	30.155			

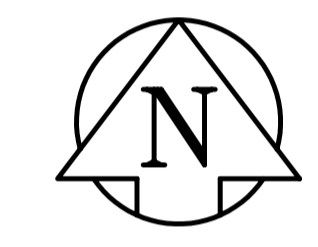

REFERENCE NOTES

- A. BASELINE IS CENTRE OF RIGHT-OF-WAY.
- B. LEGAL PLAN - L.B.I.S.
- C. ADD 200.000 TO OBTAIN GEODETIC DATUM (PLAN ONLY).
- D. PAVEMENT DIMENSIONS ARE TO BACK OF CURB.
- E. EARTH TECH FIELD BOOK NOS. 4111, 4281.

CONSTRUCTION NOTES

1. REMOVE EXISTING PAVEMENT AND CONSTRUCT NEW 230mm PLAIN DOWELLED CONCRETE PAVEMENT.
2. CONSTRUCT NEW 200mm PLAIN DOWELLED CONCRETE PAVEMENT.
3. CONSTRUCT NEW 200mm REINFORCED CONCRETE PAVEMENT.
4. CONSTRUCT NEW 200mm ASPHALTIC CONCRETE OVERLAY.
5. INSTALL NEW CURB & GUTTER INLET c/w CATCHBASIN (SD024) AND CONNECT NEW 250 LEAD TO EXISTING 750 COMBINED SEWER.
6. INSTALL NEW CURB & GUTTER INLET c/w CATCHBASIN (SD024) AND CONNECT NEW 250 LEAD TO EXISTING 738 COMBINED SEWER.
7. ABANDON EXISTING DRAINAGE INLET.
8. ABANDON EXISTING CATCHBASIN.
9. ADJUST EXISTING CATCHBASIN/MANHOLE FRAME AND COVER.
10. ADJUST EXISTING WATERMAIN VALVE BOX TO GRADE.
11. INSTALL NEW 50mm CAST IRON RISER RING.
12. INSTALL 150mm SUBDRAIN.
13. ADJUST EXISTING CURB STOP BOX TO GRADE.
14. RELOCATE EXISTING TRAFFIC SIGNALS POLE (BY OTHERS).
15. REMOVE EXISTING MTS POLE (BY OTHERS).
16. RELOCATE EXISTING HYDRO POLE (BY OTHERS).
17. ADJUST EXISTING HYDRO MANHOLE (BY OTHERS).
18. INSTALL NEW CATCHBASIN (SD025) AND CONNECT NEW 250 LEAD TO EXISTING 750 COMBINED SEWER.
19. PROPOSED WATERMAIN (BY OTHERS).

**APEGM**  
 Certificate of Authorization  
 Earth Tech Canada Inc.  
 No. 730 Expiry: April 30, 2004

METRIC  
 WHOLE NUMBERS INDICATE MILLIMETRES  
 DECIMALIZED NUMBERS INDICATE METRES

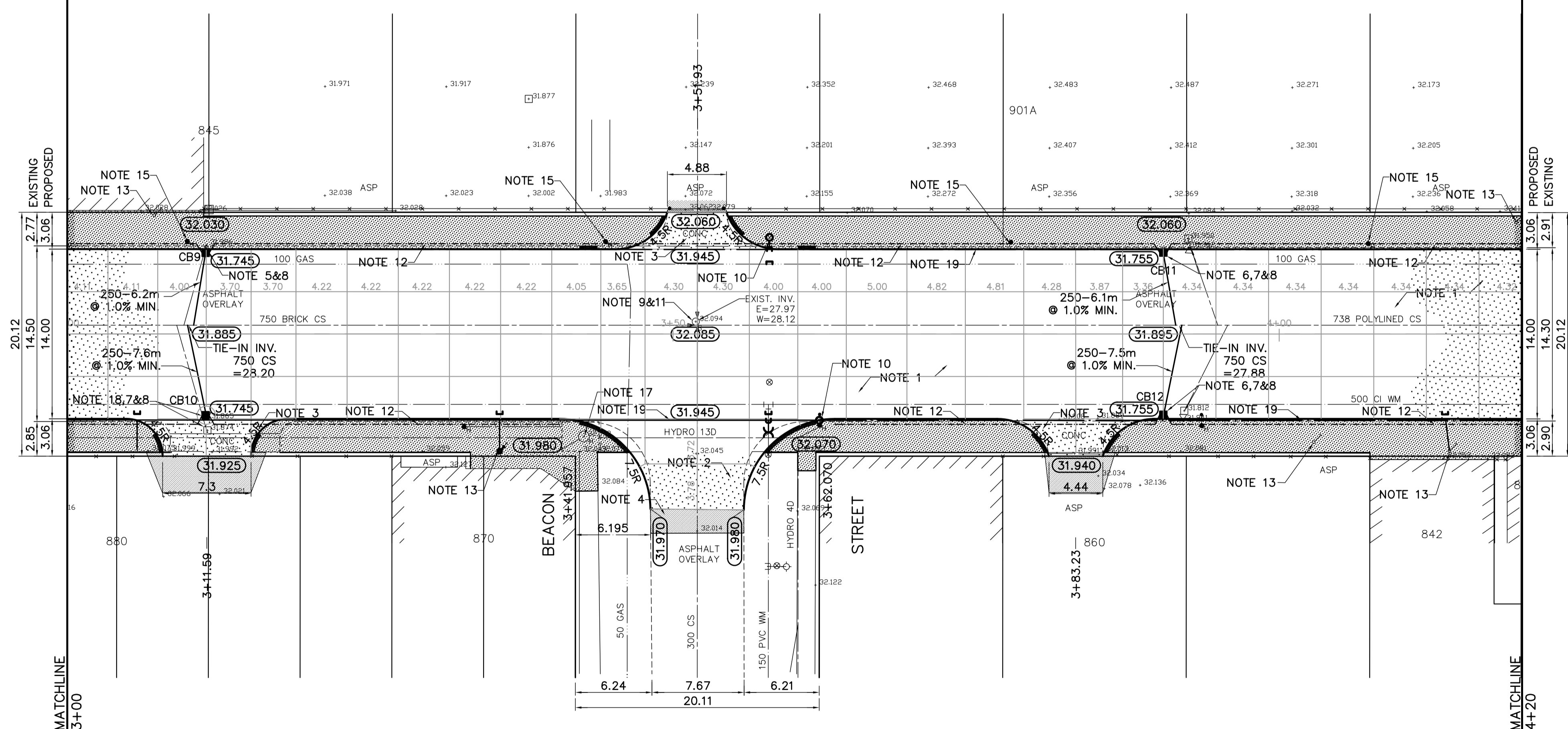
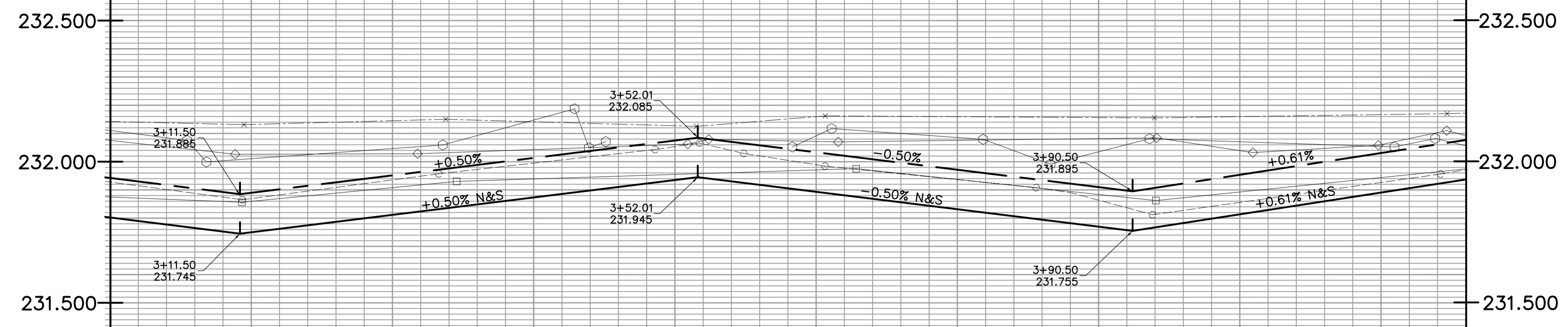

EXISTING	LEGEND - PLAN	PROPOSED	EXISTING	LEGEND - PLAN	PROPOSED	EXISTING	LEGEND - PROFILE	PROPOSED
150 mm W.M.	WATERMAIN	150 mm W.M.	---	HYDRO	---	○	PROFILE	---
300mm L.D.S.	LAND DRAINAGE SEWER	300mm L.D.S.	---	M.T.S.	---	□	NORTH GUTTER	---
250mm W.W.S.	WASTEWATER SEWER	250mm W.W.S.	---	CONCRETE	---	○	SOUTH GUTTER	---
○	MANHOLE	○	---	ASPHALT	---	◇	NORTH PROPERTY LINE	---
□	CATCH BASIN	□	---	PROPERTY LINE	---	○	SOUTH PROPERTY LINE	---
▽	CURB INLET	▽	---	SURVEY BAR	---			
+	VALVE	+	---	ELEVATION	(32.750)			
+	HYDRANT	+	---	TREE	---			
+	HYDRANT	+	---	SIDEWALK RAMP	---			
+	HYDRANT	+	---	CONCRETE SIDEWALK	---			
+	HYDRANT	+	---	FENCE	---			

**LOCATION APPROVED UNDERGROUND STRUCTURES**  
 ORIGINAL SIGNED AND DATED 04/29/04  
 SUPPLY U/G STRUCTURES DATE COMMITTEE

**NOTE:**  
 LOCATION OF UNDERGROUND STRUCTURES AS SHOWN ARE BASED ON THE BEST INFORMATION AVAILABLE, BUT NO GUARANTEE IS GIVEN THAT ALL EXISTING UTILITIES ARE SHOWN OR THAT THE GIVEN LOCATIONS ARE EXACT. CONFIRMATION OF EXISTENCE AND EXACT LOCATION OF ALL SERVICES MUST BE OBTAINED FROM THE INDIVIDUAL UTILITIES BEFORE PROCEEDING WITH CONSTRUCTION.

**EARTH TECH**  
 Earth Tech (Canada) Inc. Winnipeg, Manitoba 204.477.5381

DESIGNED BY BK,BC,KWR  
 CHECKED BY KWR,BC  
 DRAWN BY BC,BK  
 APPROVED BY ORIGINAL SIGNED

HOR. SCALE: 1:250  
 VERTICAL: 1:10

RELEASED FOR CONSTRUCTION BY:  
 ORIGINAL SIGNED AND DATED 04/29/04

ENGINEER'S SEAL  
 PROVINCE OF MANITOBA  
 ORIGINAL SIGNED  
**K.W. RAE**  
 Apr. 29, 2004  
 REGISTERED PROFESSIONAL ENGINEER

**THE CITY OF WINNIPEG**  
 PUBLIC WORKS DEPARTMENT  
 ENGINEERING DIVISION

LOGAN AVENUE  
 TRINITY STREET(RAILWAY) TO REITTA STREET  
 STREET RECONSTRUCTION

PLAN/PROFILE  
 STATION 3+00 TO STATION 4+20

CITY DRAWING NUMBER  
 P-3249-05  
 SHEET 5 OF 7