

TYPICAL CROSS SECTION

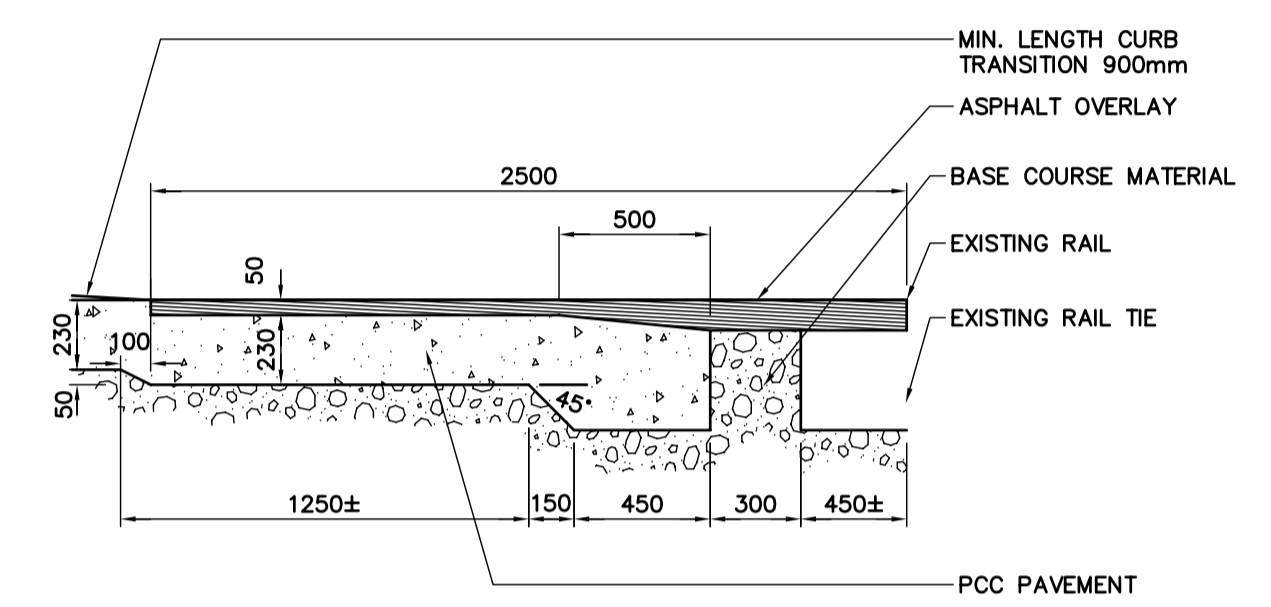

MODIFIED RAIL CROSSING DETAIL

DESCRIPTION	RIM	INVERT			
		NORTH	SOUTH	EAST	WEST
CB 1	31.920		30.320		
CB 2	31.920	30.320			
CB 3	31.740		30.140		
CB 4	31.740	30.140			

- REFERENCE NOTES**
- BASELINE IS CENTRE OF RIGHT-OF-WAY.
 - LEGAL PLAN - L.B.I.S.
 - ADD 200.000 TO OBTAIN GEODETIC DATUM (PLAN ONLY).
 - PAVEMENT DIMENSIONS ARE TO BACK OF CURB.
 - EARTH TECH FIELD BOOK NOS. 4111, 4281.

- CONSTRUCTION NOTES**
- REMOVE EXISTING PAVEMENT AND CONSTRUCT NEW 230mm PLAIN DOWELLED CONCRETE PAVEMENT.
 - CONSTRUCT NEW 200mm PLAIN DOWELLED CONCRETE PAVEMENT.
 - CONSTRUCT NEW 200mm REINFORCED CONCRETE PAVEMENT.
 - CONSTRUCT NEW 50mm ASPHALTIC CONCRETE OVERLAY.
 - INSTALL NEW CURB & GUTTER INLET c/w CATCHBASIN (SD024) AND CONNECT NEW 250 LEAD TO EXISTING 450 COMBINED SEWER.
 - INSTALL NEW CURB & GUTTER INLET c/w CATCHBASIN (SD024) AND CONNECT NEW 250 LEAD TO EXISTING 600 COMBINED SEWER.
 - ABANDON EXISTING DRAINAGE INLET.
 - ABANDON EXISTING CATCHBASIN.
 - ADJUST EXISTING CATCHBASIN/MANHOLE FRAME AND COVER.
 - ADJUST EXISTING WATERMAIN VALVE BOX TO GRADE.
 - INSTALL NEW 50mm CAST IRON RISER RING.
 - INSTALL 150mm SUBDRAIN.
 - ADJUST EXISTING CURB STOP BOX TO GRADE.
 - RELOCATE EXISTING TRAFFIC SIGNALS POLE (BY OTHERS).
 - REMOVE EXISTING MTS POLE (BY OTHERS).
 - REMOVE EXISTING HYDRO POLE (BY OTHERS).
 - ADJUST EXISTING MTS MANHOLE (BY OTHERS).
 - THICKEN SLAB EDGE AS PER DETAIL.
 - ADJUST EXISTING HYDRO MANHOLE (BY OTHERS).
 - PROPOSED WATERMAIN (BY OTHERS).
 - PROPOSED WATERMAIN CASING PIPE (BY OTHERS).

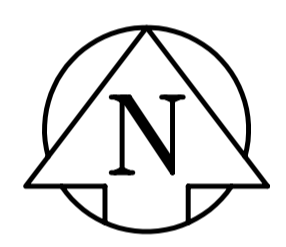
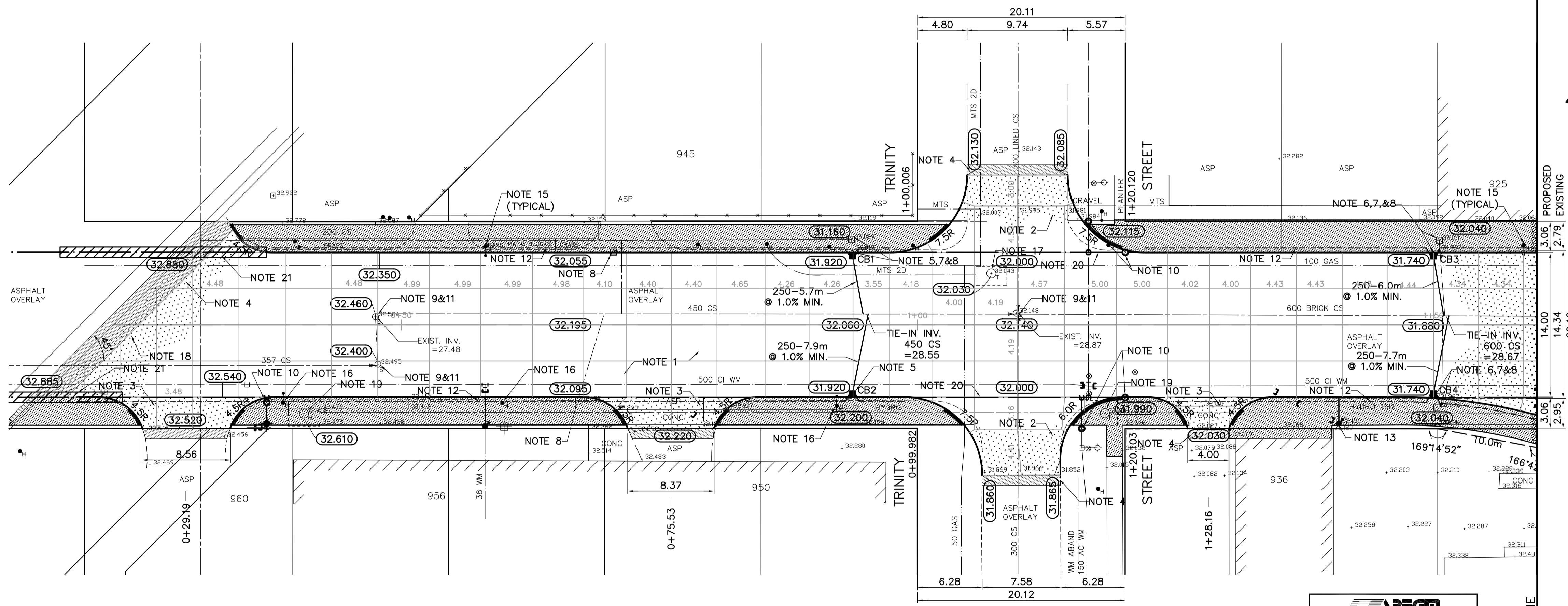

METRIC
WHOLE NUMBERS INDICATE MILLIMETRES
DECIMALIZED NUMBERS INDICATE METRES

APEGM
Certificate of Authorization
Earth Tech Canada Inc.
No. 730 Expiry: April 30, 2004

EXISTING	LEGEND - PLAN	PROPOSED	EXISTING	LEGEND - PLAN	PROPOSED	EXISTING	LEGEND - PROFILE	PROPOSED
150 mm W.M.	WATERMAIN	150 mm W.M.	---	HYDRO	---	---	⊙ PROFILE	---
Hydrant	HYDRANT	Hydrant	---	M.T.S.	---	---	⊙ NORTH GUTTER	---
Valve	VALVE	Valve	---	CONCRETE	---	---	⊙ SOUTH GUTTER	---
300mm L.D.S.	LAND DRAINAGE SEWER	300mm L.D.S.	---	ASPHALT	---	---	⊙ NORTH PROPERTY LINE	---
250mm W.W.S.	WASTEWATER SEWER	250mm W.W.S.	---	PROPERTY LINE	---	---	⊙ SOUTH PROPERTY LINE	---
Manhole	MANHOLE	Manhole	---	SURVEY BAR	---	---		
Catch Basin	CATCH BASIN	Catch Basin	---	ELEVATION	(32.750)	---		
Curb Inlet	CURB INLET	Curb Inlet	---	TREE	---	---		
Junctions	JUNCTIONS	Junctions	---	SIDEWALK RAMP	---	---		
Culvert	CULVERT	Culvert	---	CONCRETE SIDEWALK	---	---		
Gas	GAS	Gas	---	FENCE	---	---		

LOCATION APPROVED UNDERGROUND STRUCTURES
ORIGINAL SIGNED AND DATED 04/29/04
SUPPLY U/G STRUCTURES DATE COMMITTEE

NOTE:
LOCATION OF UNDERGROUND STRUCTURES AS SHOWN ARE BASED ON THE BEST INFORMATION AVAILABLE, BUT NO GUARANTEE IS GIVEN THAT ALL EXISTING UTILITIES ARE SHOWN OR THAT THE GIVEN LOCATIONS ARE EXACT. CONFIRMATION OF EXISTENCE AND EXACT LOCATION OF ALL SERVICES MUST BE OBTAINED FROM THE INDIVIDUAL UTILITIES BEFORE PROCEEDING WITH CONSTRUCTION.

NO.	ISSUED FOR CONSTRUCTION	DATE	BY
0	ISSUED FOR CONSTRUCTION	04/04	KWR
A	ISSUED FOR REVIEW	03/04	KWR
	REVISIONS		

EARTH TECH
Earth Tech (Canada) Inc. Winnipeg, Manitoba 204.477.5381

DESIGNED BY BK,BC,KWR
CHECKED BY KWR,BC
DRAWN BY BC,BK
APPROVED BY ORIGINAL SIGNED
RELEASED FOR CONSTRUCTION BY:
ORIGINAL SIGNED AND DATED 04/29/04

THE CITY OF WINNIPEG
PUBLIC WORKS DEPARTMENT
ENGINEERING DIVISION

LOGAN AVENUE
TRINITY STREET(RAILWAY) TO REITTA STREET
STREET RECONSTRUCTION

PLAN/PROFILE
TRINITY STREET (RAILWAY) TO 1+60

CITY DRAWING NUMBER P-3249-03
SHEET 3 OF 7