

SHEET: 306-11-1 (1/2003)

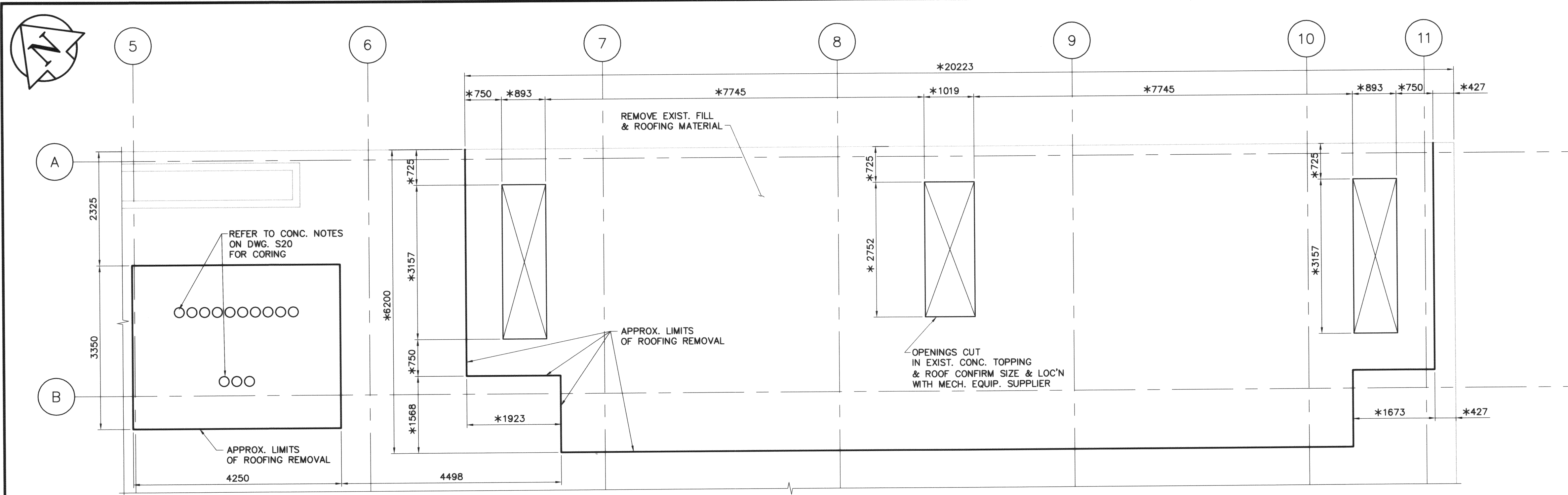

**DEMOLITION PLAN ABOVE ELEVATION 236.460**

SCALE : 1:50  
 \* - CONFIRM ROOF OPENING DIMENSIONS WITH MECHANICAL AND ELECTRICAL EQUIPMENT SUPPLIERS AND WITH NEW CONCRETE CURB, PILASTER AND PEDESTAL WORK TO BE DONE (REFER TO DRAWING S20).  
 CONFIRM THE SOUNDNESS OF THE EXISTING LIGHTWEIGHT CONCRETE TOPPING. REVIEW THE CONDITION OF THE EXISTING LIGHTWEIGHT CONCRETE TOPPING WITH THE CONTRACT ADMINISTRATOR PRIOR TO STARTING NEW WORK ON CONCRETE CURBS, PILASTERS AND PEDESTALS.

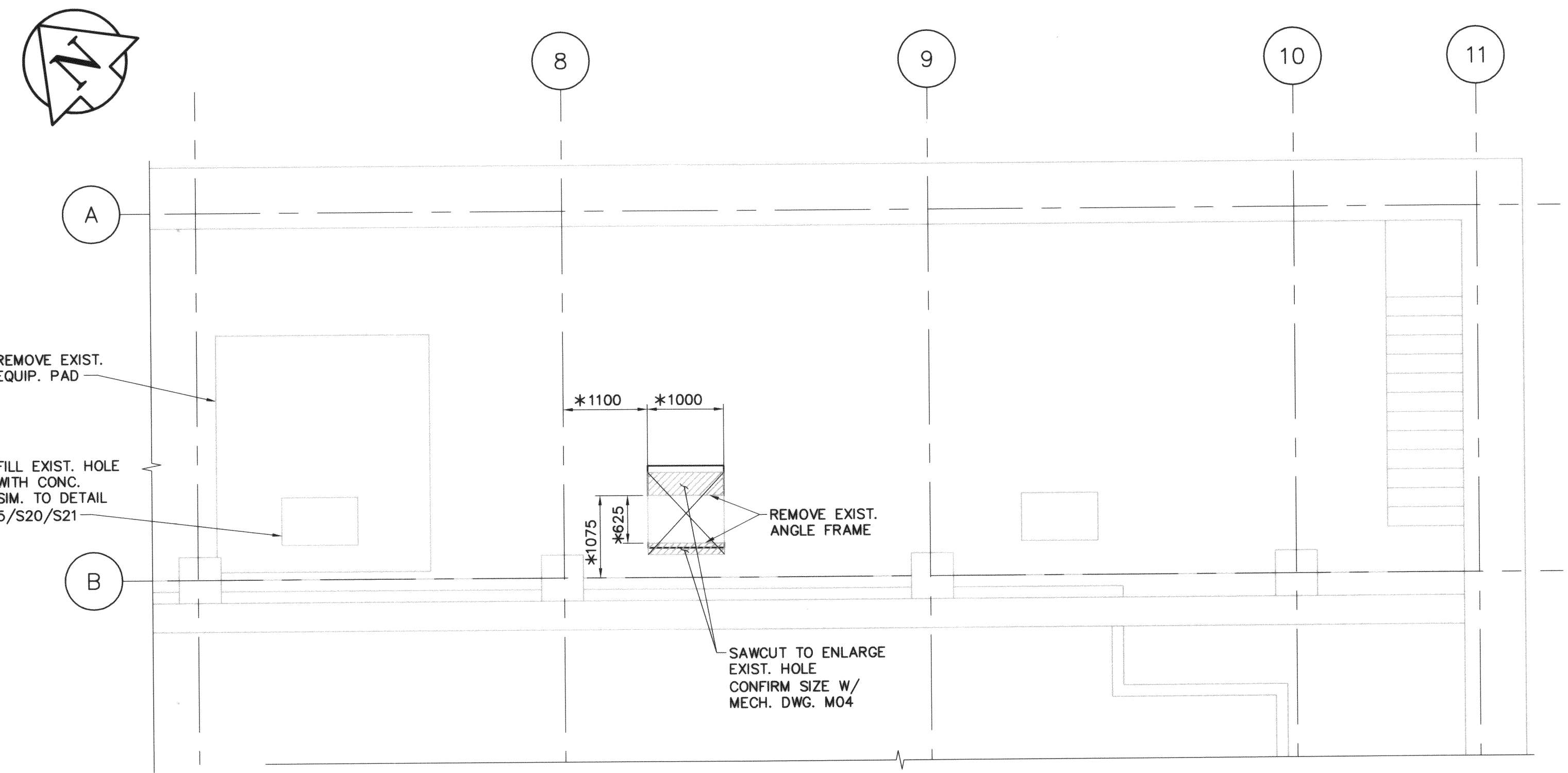

**DEMOLITION PLAN ABOVE ELEVATION 230.800**

SCALE : 1:50  
 \* - CONTRACTOR TO CONFIRM ON SITE ALL EXISTING DIMENSIONS AND CONFIRM FLOOR OPENING DIMENSIONS WITH MECHANICAL EQUIPMENT SUPPLIER.



B.M. ELEV.	EARTH TECH		CH2MHILL	
	DESIGNED BY: MK	CHECKED BY:	APPROVED BY: D.T.	
	DRAWN BY: C.T.	HOR. SCALE: AS SHOWN		RELEASED FOR CONSTRUCTION BY:
0 ISSUED FOR TENDER	03/12/12	C.T.	DATE	2003/11/13
NO. REVISIONS	DATE	BY	DATE	2003/11/13

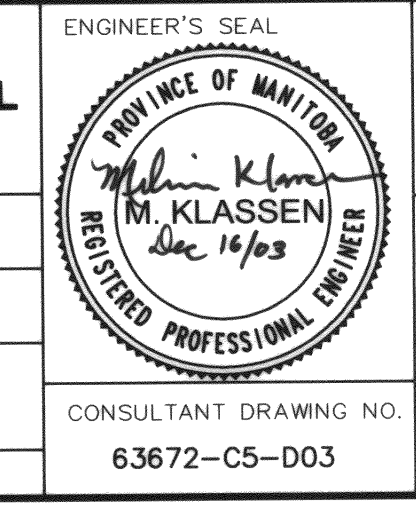

**THE CITY OF WINNIPEG**  
 Winnipeg WATER AND WASTE DEPARTMENT

**DEACON ULTRAVIOLET (UV) LIGHT DISINFECTION PROJECT**

STRUCTURAL - HVAC UPGRADE DEMOLITION PLANS

CITY FILE NUMBER  
 SHEET 3 OF 3  
 CITY DRAWING NUMBER  
**D-8387**

CONSULTANT DRAWING NO.  
 63672-C5-D03