

1 WATCH DESK FRONT ELEVATION
SCALE: 3/4"=1'-0"

2 WATCH DESK REAR ELEVATION
SCALE: 3/4"=1'-0"

3 WATCH DESK SIDE ELEVATION
SCALE: 3/4"=1'-0"

4 GENERAL OFFICE DESK ELEVATION
SCALE: 3/4"=1'-0"

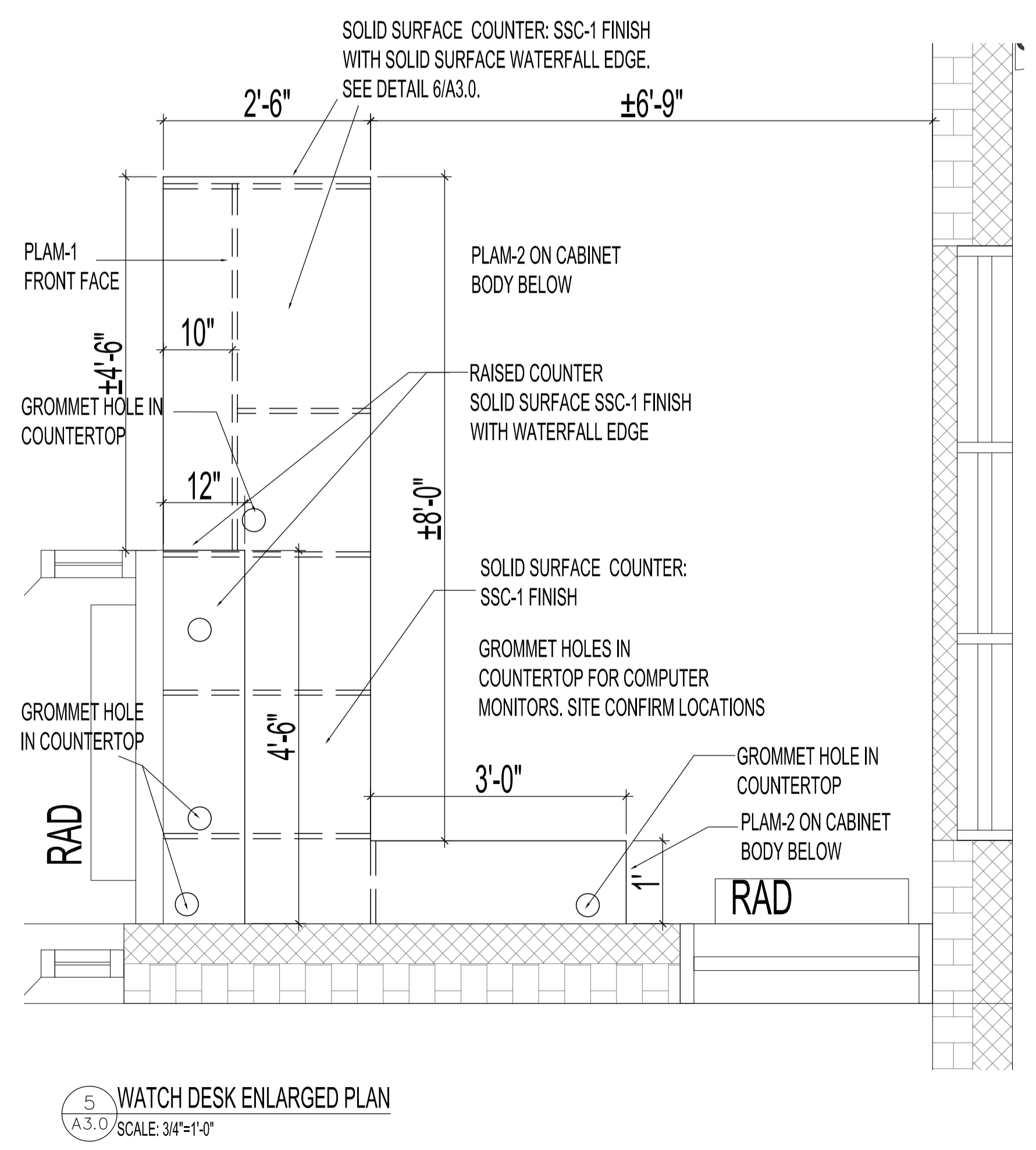

5 WATCH DESK ENLARGED PLAN
SCALE: 3/4"=1'-0"

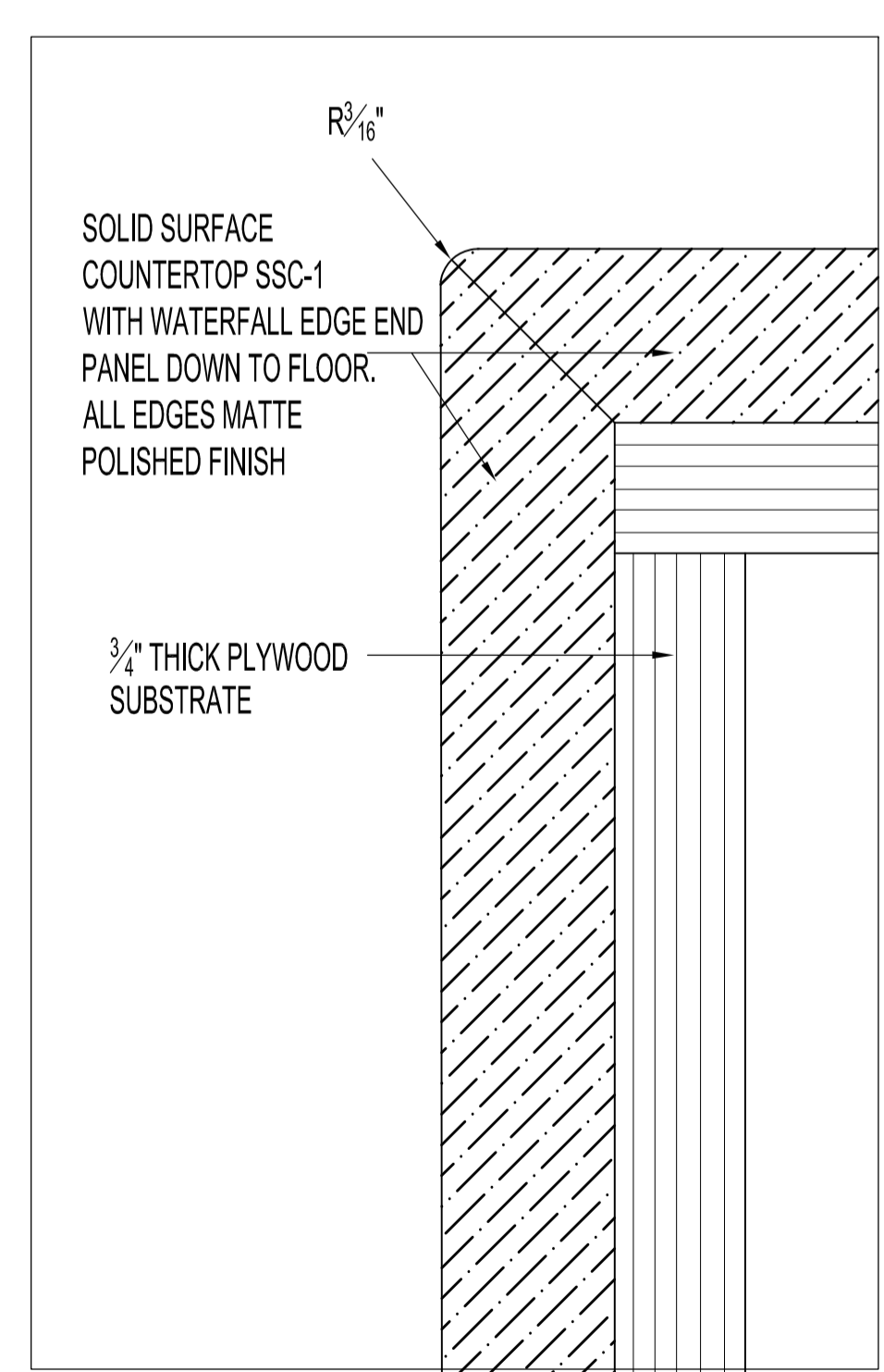

6 TYPICAL SOLID SURFACE WATERFALL EDGE DETAIL
SCALE: N.T.S.

MILLWORK HARDWARE SPECIFICATIONS:

- DRAWER SLIDES:** MODEL: BLUM # 56H TANDEM FULL EXTENSION SLIDE WITH BLUM MOTION DEPTH TO MATCH CABINET SIZE; INSTALL TYPE: SIDE MOUNT FINISH: CHROME
- DRAWER/ DOOR HANDLES:** MODEL: HAFELE # 117.05.630 VERANDA COLLECTION SIZE: 224 mm (8 INCHES) FINISH: STAINLESS STEEL #304
- DOOR HINGES:** MODEL: HETTICK CONCEALED HINGE PRODUCT # 790 FINISH: NICKEL FINISH 110 DEGREE SWING.
- DRAWER/ DOOR LOCKS: (AS REQUIRED)** HAFELE CYLINDER MODULE MODEL: 235.08.358

1 SHELF SUPPORTS: (TO SUIT CABINET)
HAFELE 255 SERIES PILASTER STANDARDS; KV; 5/8" X 3/16" 23 GA MODEL: 255 AL 18

REFER TO N.M.S SECTION 06 02 00 ROUGH CARPENTRY AND 06 04 00 ARCHITECTURAL WOODWORK IN TENDER DOCUMENT FOR STANDARD OF CONSTRUCTION FOR ALL MILLWORK.

SHOP DRAWINGS TO BE SUBMITTED TO CONTRACT ADMINISTRATOR FOR APPROVAL PRIOR TO CONSTRUCTION.

SITE MEASUREMENTS REQUIRED PRIOR TO CONSTRUCTION.

1 CONFIRM ALL GROMMET LOCATIONS PRIOR TO CUTTING. GROMMET COLOR-WHITE.

NOTES:

THESE DRAWINGS SHALL NOT BE SCALED. CONSULT WITH CONTRACT ADMINISTRATOR AND DESIGNER ON ANY CONCERNS.

SUBMISSION OF SITE MARK-UPS, AS-BUILTS, OPERATING & MAINTENANCE MANUALS AND OTHER SUPPORTING DOCUMENTS TO CLIENT ARE MANDATORY AT THE COMPLETION OF THIS PROJECT.

THE CONTRACTOR SHALL VISIT THE SITE AND SATISFY ONESELF ALL DIMENSIONS, DATUM, AND DETAILED INFORMATION SHOWN ARE CORRECT.

THE CONTRACTOR IS TO REVIEW AND COORDINATE ALL ARCHITECTURAL, STRUCTURAL, MECHANICAL AND ELECTRICAL DRAWINGS FOR ADDITIONAL OPENINGS THROUGH FLOORS, WALLS, AND CEILINGS FOR DUCTS, PIPES & ELECTRICAL RISERS AND ALL OPENINGS NOT SHOWN ON DRAWINGS.

ALL OPENINGS THROUGH FIRE ASSEMBLIES INCLUDING FLOORS AND CEILINGS ARE TO BE FIRE STOPPED AND SEALED WITH ULC APPROVED FIRE STOPPING TO MAINTAIN THE INTEGRITY OF THE FIRE SEPARATION, AND PROVIDE A SMOKE-TIGHT BARRIER.

ALL PRODUCTS AND MATERIALS TO BE USED AND INSTALLED SHALL CONFORM WITH MANUFACTURER'S SPECIFICATIONS, APPLICABLE CODES AND AUTHORITY HAVING JURISDICTION.

THE CONTRACTOR SHALL BE RESPONSIBLE TO PATCH AND MAKE GOOD ALL EXISTING CONSTRUCTION AFFECTED BY THE REMOVAL OF ALL ITEMS FORMING PART OF THE RENOVATION WORK.

WHERE NEW FLOORING AND BASE IS TO BE INSTALLED IN EXISTING AREAS (REFER TO FLOOR PLAN AND ROOM SCHEDULE) THE EXISTING FLOORING SURFACE AND BASE MUST BE REMOVED, UNLESS OTHERWISE NOTED. ALL FLOOR SURFACES SHALL BE PREPARED IN ACCORDANCE TO MANUFACTURER'S RECOMMENDATIONS FOR INSTALLATION OF NEW FLOORING.

WHERE PAINTING OF EXISTING WALLS IS INDICATED ON THE ROOM SCHEDULE, THESE WALLS MUST BE CLEANED OF ANY EXISTING WALL COVERING, PATCHED & PREPARED TO ACCEPT NEW MATERIAL, UNLESS OTHERWISE NOTED.

ALL NEW LIGHTING FIXTURES & NEW RECEPTACLES TO BE CONNECTED TO APPROPRIATE PANELS.

GENERAL DUTY RECEPTACLES SHALL BE WHITE & CSA APPROVED, C/W STAINLESS STEEL TRIM PLATES MOUNTED 18" ABOVE FINISHED FLOOR OR OTHERWISE NOTED.

THERMOSTATS, FIRE ALARM PULL STATIONS & OCCUPANCY LIGHT SWITCHES SHALL BE MOUNTED 47" ABOVE FINISHED FLOOR OR OTHERWISE NOTED.

ALL ABANDONED ELECTRICAL FIXTURES, COMPONENTS, RECEPTACLE & DATA WIRING SHALL BE REMOVED BACK TO SOURCE & TERMINATED AS PER APPLICABLE CODES. IF APPLICABLE, THIS INCLUDES WIRING CONTAINED IN HEADER DUCTS IN FLOOR.

REFER TO CITY OF WINNIPEG, MATERIALS MANAGEMENT GENERAL TERMS & CONDITIONS FOR PROJECT: [HTTP://WINNIPEG.CA/MATMGMT/GCNDTSTM](http://winipeg.ca/matmgmt/gcndtstm)

WARNING:
ASBESTOS KNOWN TO BE PRESENT IN SOME EXISTING DRYWALL AS INDICATED ON SITE. ABATEMENT BY CITY OF WINNIPEG CONTRACTOR TO PRECEDE START OF CONSTRUCTION. ASBESTOS MAY BE PRESENT IN OTHER AREAS. IF ASBESTOS OR ANY HAZARDOUS MATERIAL IS FOUND, STOP WORK IMMEDIATELY & CONTACT CITY OF WINNIPEG, CENTRAL CONTROL, PH: 204-986-2351.

No.	REVISION/DESCRIPTION	BY	DATE
1	ADDENDUM #1		JULY 15 / 2020
0	ISSUED FOR CONSTRUCTION		JUNE 22 / 2020
00	ISSUED FOR CLIENT REVIEW		MAY 22 / 2020
000	ISSUED FOR CLIENT REVIEW		APRIL 17 / 2020

DRAWN	CHECKED	DESIGNED	APPROVED
KJN	KJN	KJN	
DATE	2020.06.22	USER	APPROVAL

THE CITY OF WINNIPEG
PLANNING, PROPERTY AND DEVELOPMENT DEPARTMENT
MUNICIPAL ACCOMMODATIONS DIVISION
3-65 GARRY STREET, R3C 4K4

PROJECT
WINNIPEG FIRE PARAMEDIC SERVICES
FIRE STATION # 23
RENOVATIONS TO WASHROOMS AND SECOND FLOOR
880 DALHOUSIE DRIVE TENDER NO. 349-2020

SCALE	PROJECT No.	SHEET No.
AS SHOWN	2019-147	A3.0R1