

PROFILE
Scale H=1:250 V=1:10

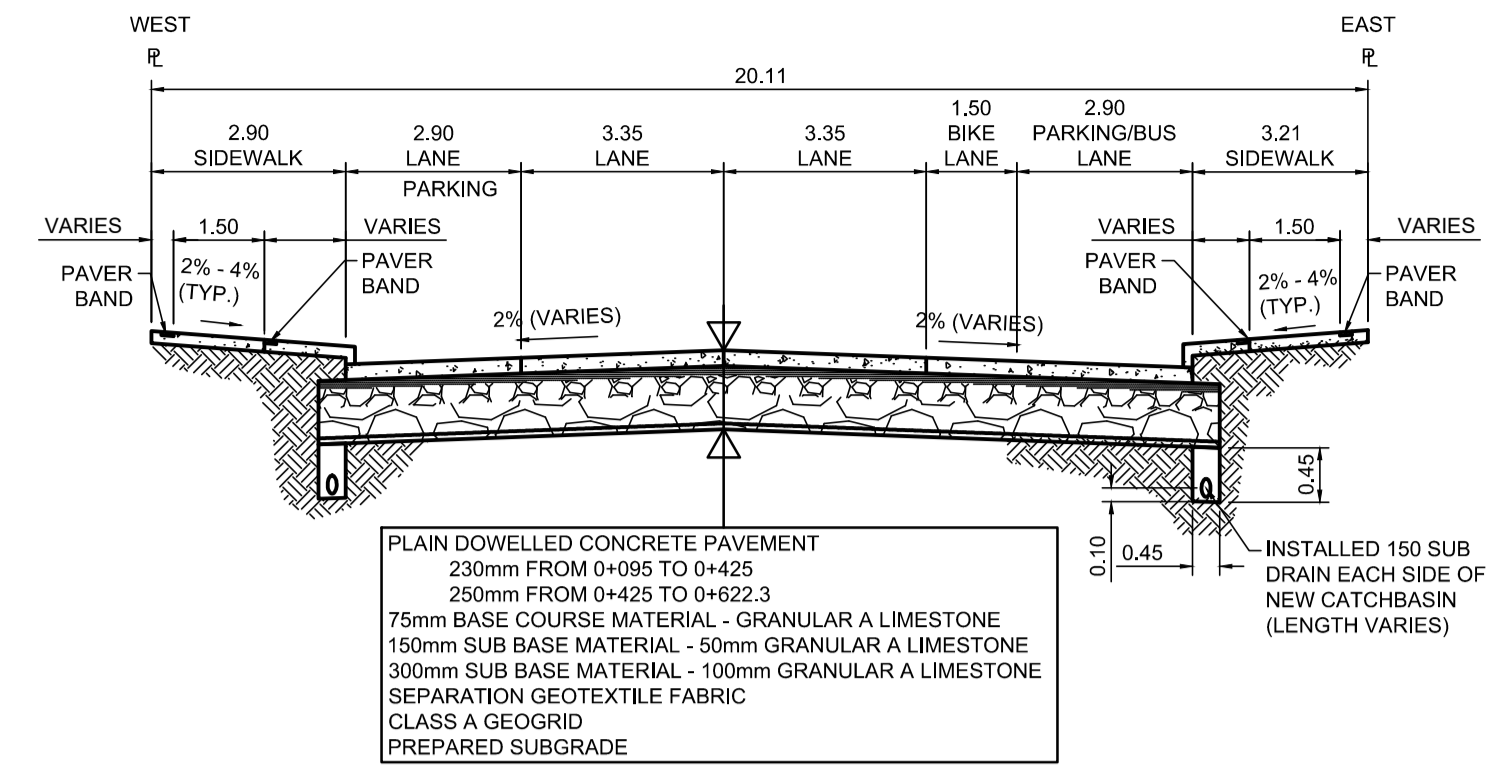

TYPICAL SECTION
Scale NTS

ITEM	RIM ELEV.	Sta	INVERT					CONNECTION	LEAD	FLOW RESTRICTOR
			EAST	WEST	NORTH	SOUTH	SEWER			
CB08	231.630	0+390	230.030				228.90±	300 CLAY CS	7.0m-250Ø @ 2% Min	150mm
CB09	231.630	0+390		230.030			228.93±	300 CLAY CS	7.0m-200Ø @ 2% Min	150mm
CB10	231.460	0+424	229.860				228.69±	300 CLAY CS	7.0m-250Ø @ 2% Min	150mm
CB11	231.420	0+424		229.820			228.70±	300 CLAY CS	7.0m-250Ø @ 2% Min	150mm
CP01	231.410	0+429						NEW CP		
CB13	231.510	0+448	229.910				228.72±	300 CLAY CS	7.0m-250Ø @ 2% Min	150mm
CB14	231.440	0+448		229.840			228.73±	300 CLAY CS	7.0m-250Ø @ 2% Min	150mm
CB15	231.500	0+468	229.900				228.87±	300 CLAY CS	7.0m-250Ø @ 2% Min	150mm
CB16	231.500	0+468		229.900			228.88±	300 CLAY CS	7.0m-250Ø @ 2% Min	150mm

REFERENCE NOTES

- PAVEMENT DIMENSIONS ARE TO BACK OF CURB
- BASELINE IS CENTRELINE OF RIGHT-OF-WAY
- PROPERTY LINES OBTAINED FROM THE CITY OF WINNIPEG L.B.I.S., AND SCALE FACTOR WAS NOT APPLIED
- REFER TO AECOM FIELD BOOK NO. 4998
- CATCH BASIN CONNECTIONS TO SEWER DESIGNED TO MAINTAIN PRE-CONSTRUCTION CAPACITY BY CATCH BASIN LEAD RESTRICTION AS INDICATED ON THE DRAWINGS. ADDITIONAL OR MODIFIED CONNECTIONS TO THE SEWER SYSTEM BEYOND THOSE INDICATED ON THE DRAWINGS REQUIRE REVIEW AND WRITTEN APPROVAL BY THE CONTRACT ADMINISTRATOR.

CONSTRUCTION NOTES

- REMOVE EXISTING PAVEMENT AND CONSTRUCT NEW 230mm PLAIN DOWELLED CONCRETE PAVEMENT
- CONSTRUCT NEW 200mm REINFORCED CONCRETE PAVEMENT
- REMOVE EXISTING CONCRETE SIDEWALK AND CONSTRUCT NEW 100mm SIDEWALK WITH BLOCKOUTS c/w PAVING STONES FOR INDICATOR SURFACE (REFER TO TYPICAL SECTION ON THIS SHEET AND CT-19 DETAILS FOR ADDITIONAL INFORMATION). CONTRACTOR TO SAW CUT AT PROPERTY LINE FULL LENGTH OF PROJECT
- INSULATE WATER MAIN AND WATER SERVICES UNDER ROADWAY EXCAVATION AS PER (SD-18)
- INSTALL NEW DETECTABLE SURFACE WARNING TILES
- CONSTRUCT NEW BARRIER CURB (180mm HT. SEPARATE)
- CONSTRUCT NEW MONOLITHIC CURB RAMP (180mm HT. INTEGRAL)
- CONSTRUCT NEW MODIFIED BARRIER CURB (180mm HT. INTEGRAL) AS PER SD-203B AT ALL STREET/LANE INTERSECTION RADII
- INSTALL NEW CURBS AND GUTTER INLET c/w CATCHBASIN (SD024) CONNECT NEW 250mm LEAD TO EXISTING COMBINED SEWER OR EXISTING LEAD
- INSTALL FLOW RESTRICTOR PIPE AS INDICATED IN CB & CP TABLE (SD-122)
- INSULATE WATERMAIN AND/OR WATER SERVICE UNDER CATCHPIT OR CATCHBASIN
- INSTALL 150mm SUBDRAIN 12m ON EACH SIDE OF CATCHBASIN UNLESS OTHERWISE NOTED
- REMOVE EXISTING CURB INLET / CATCH PIT / CATCHBASIN AND ABANDON EXISTING LEAD
- REMOVE EXISTING FRAME AND COVER AND INSTALL NEW FRAME AND SOLID COVER (AP-006 & AP-007)
- ADJUST EXISTING CATCHBASIN / MANHOLE FRAME AND COVER
- ADJUST EXISTING WATERMAIN VALVE BOX TO GRADE
- INSTALL NEW 50mm CAST IRON RISER RING
- ADJUST EXISTING CURB STOP TO GRADE
- EXISTING TRAFFIC SIGNALS POLE TO BE RELOCATED (REFER TO SIGNALS DRAWINGS FOR ADDITIONAL DETAILS)
- EXISTING STREET LIGHT POLE TO BE RELOCATED (REFER TO STREET LIGHTING DRAWINGS FOR ADDITIONAL DETAILS)
- ADJUST MANITOBA HYDRO/ MTS MANHOLES (BY OTHERS)
- REMOVE EXISTING PARKING PAY STATIONS (BY OTHERS)
- INSTALL BIKE RACK
- PROTECT EXISTING TREE DURING CONSTRUCTION

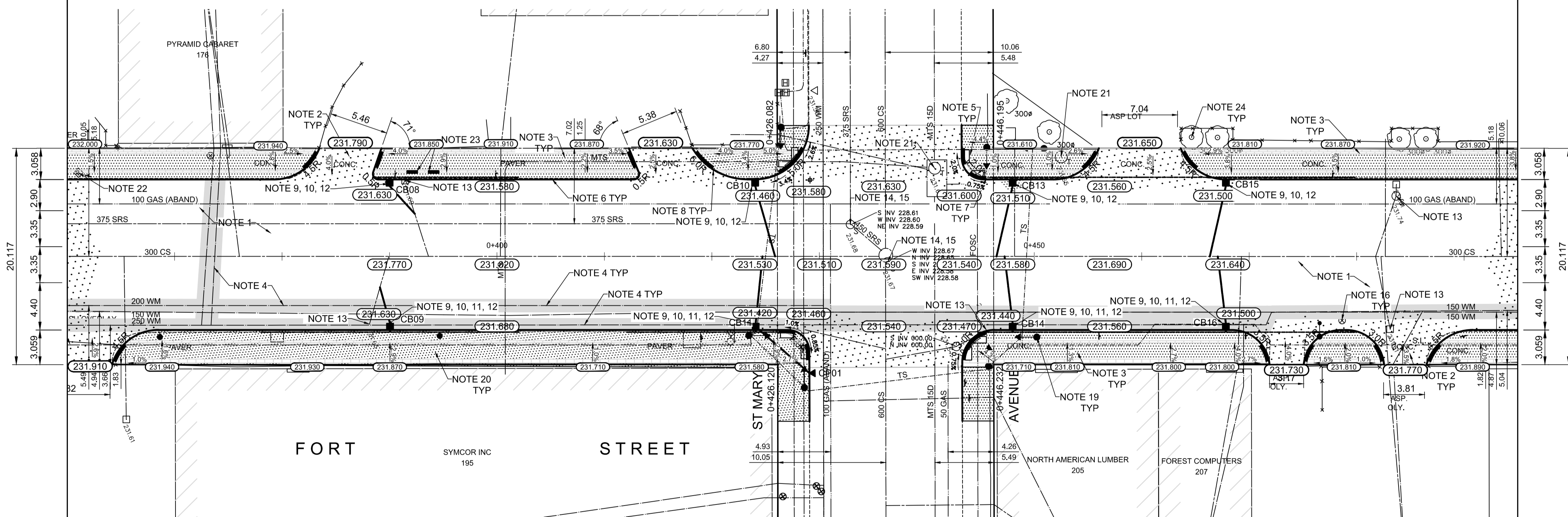

PLAN
Scale 1:250

ENGINEERS GEOSCIENTISTS MANITOBA
Certificate of Authorization
AECOM Canada Ltd.
No. 4671 Date: _____

METRIC

WHOLE NUMBERS INDICATE MILLIMETRES
DECIMALIZED NUMBERS INDICATE METRES

EXISTING	LEGEND - PLAN	PROPOSED	EXISTING	LEGEND - PLAN	PROPOSED	EXISTING	LEGEND - PROFILE	PROPOSED
150 mm W.M.	WATERMAIN	150 mm W.M.	HYDRO	M.T.S.	CONCRETE	ASPHALT	PROPERTY LINE	SURVEY BAR
300mm L.D.S.	LAND DRAINAGE SEWER	300mm L.D.S.	235.750	ELEVATION	(35.750)	TREE	SIDEWALK RAMP	CONCRETE SIDEWALK
250mm W.W.S.	WASTEWATER SEWER	250mm W.W.S.	MANHOLE	CATCH BASIN	CATCH PIT	TRAFFIC SIGNAL POLE	STREET LIGHT	GAS

LOCATION APPROVED UNDERGROUND STRUCTURES

SUPV. U/G STRUCTURES COMMITTEE DATE

NOTE:
LOCATION OF UNDERGROUND STRUCTURES AS SHOWN ARE BASED ON THE BEST INFORMATION AVAILABLE, BUT NO GUARANTEE IS GIVEN THAT ALL EXISTING UTILITIES ARE SHOWN OR THAT THE GIVEN LOCATIONS ARE EXACT. CONFIRMATION OF EXISTENCE AND EXACT LOCATION OF ALL SERVICES MUST BE OBTAINED FROM THE INDIVIDUAL UTILITIES BEFORE PROCEEDING WITH CONSTRUCTION.

B.M.	tbm	South East Corner of Smith Avenue & Broadway, property line, top of 1" x 1" iron bar
ELEV.	231.968	

DESIGNED BY	BC	CHECKED BY	TLF
DRAWN BY	PAAP	APPROVED BY	TLF
HOR. SCALE:	AS SHOWN	RELEASED FOR CONSTRUCTION BY:	
VERTICAL:			
ISSUED FOR TENDER	2020/01/24	TLF	
ISSUED FOR REVIEW	2020/02/10	KWR	
NO. REVISIONS		DATE	BY
		2019/08/27	

ENGINEER'S SEAL
PROVINCE OF MANITOBA
REGISTERED PROFESSIONAL ENGINEER
T.L. FINDLAY
Member 23820

THE CITY OF WINNIPEG
PUBLIC WORKS DEPARTMENT
ENGINEERING DIVISION

2020 DOWNTOWN STREET
PAVEMENT RENEWALS

PLAN/PROFILE GRADING PLAN
FORT STREET
STA. 3+60 TO STA. 4+95

CITY DRAWING NUMBER P-3527-15
SHEET 15 OF 19

CONSULTANT DRAWING NO. CT-15