

WILDWOOD J  
(W-LEG)

SOUTH DRIVE

WILDWOOD J  
(E-LEG)

81.2 OF 200 WWS TO BE LINED  
S-MA6001384

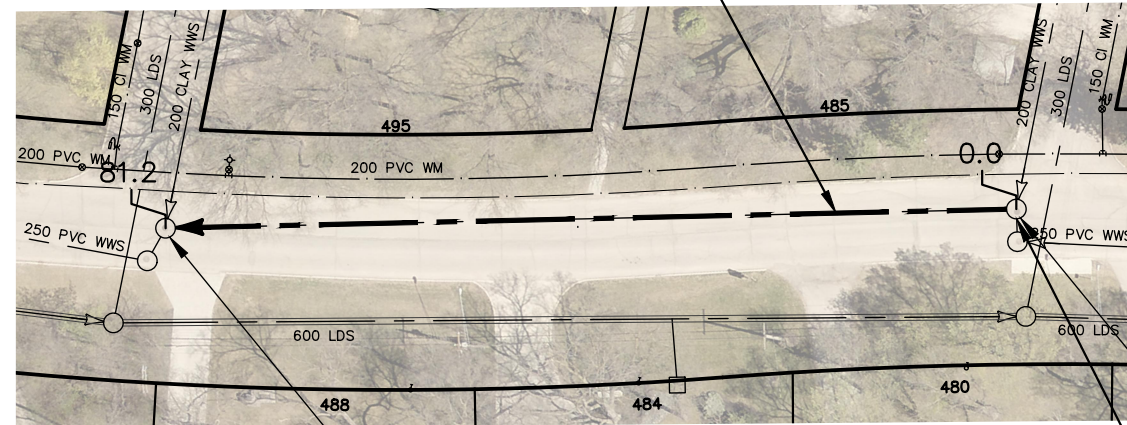

S-MH60011496  
RIM 231.10  
INV N 227.56  
INV E 230.06  
INV W 227.59

S-MH60015381  
RIM 231.30  
INV N 227.70  
INV S 230.25  
INV W 230.17  
**GROUT RISER  
0.3 TO 2.0**

SEWER JUNCTION INFORMATION FROM SEWER VIDEO INSPECTION		
SEWER ID S-MA6001384		
DISTANCE FROM MH ID S-MH60015381		
DISTANCE	DIAMETER	CLOCK
6.3	150	10
38.9	150	10
41.9	150	10
60.2	150	10

**WARNING**

IF POWER EQUIPMENT OR EXPLOSIVES ARE TO BE USED FOR EXCAVATION ON THIS PROJECT THE CONTRACTOR MUST:

- 1) NOTIFY THE GAS COMPANY OF THE PROPOSED LOCATION OF EXCAVATION.
- 2) TAKE PRECAUTION TO AVOID DAMAGE TO GAS COMPANY INSTALLATIONS.

SEE PROVINCIAL REGULATION 210/72 FOR DETAILS

FOR INDEX SEE  
12444

**METRIC**

WHOLE NUMBERS INDICATE MILLIMETRES  
DECIMALIZED NUMBERS INDICATE METRES

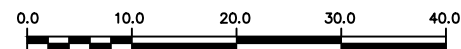

LOCATION APPROVED  
UNDERGROUND STRUCTURES

B.M.  
ELEV.

SUPV. U/G STRUCTURES COMMITTEE DATE

NOTE:

LOCATION OF UNDERGROUND STRUCTURES AS SHOWN ARE BASED ON THE BEST INFORMATION AVAILABLE BUT NO GUARANTEE IS GIVEN THAT ALL EXISTING UTILITIES ARE SHOWN OR THAT THE GIVEN LOCATIONS ARE EXACT. CONFIRMATION OF EXISTENCE AND EXACT LOCATION OF ALL SERVICES MUST BE OBTAINED FROM THE INDIVIDUAL UTILITIES BEFORE PROCEEDING WITH CONSTRUCTION.

NO.	REVISIONS	DATE	BY

DESIGNED BY	SC	CHECKED BY	SC
DRAWN BY	RS	APPROVED BY	KZ
SCALE:		RELEASED FOR CONSTRUCTION	
HORIZONTAL	1:750		
VERTICAL			
		<b>K. ZUREK</b>	
DATE	2020 04 23	DATE	2020-04-22

PLOT DATE: 2020 04 23

ENGINEER'S SEAL

ORIGINAL  
SIGNED BY  
**S.R.J.  
COURNOYER**  
2020/04/17

CONSULTANT DRAWING NUMBER

BID OPPORTUNITY: 197-2020  
CONTRACT NUMBER: 6



**THE CITY OF WINNIPEG**  
WATER AND WASTE DEPARTMENT  
ENGINEERING DIVISION

2020 SEWER MAIN RENEWALS  
BY CIPP LINING  
**SOUTH DRIVE**  
MH AT WILDWOOD J (E-LEG) TO  
MH AT WILDWOOD J (W-LEG)

SHEET 48 OF 60

CITY DRAWING NUMBER

12489