

ISO A1 - 594mm x 841mm

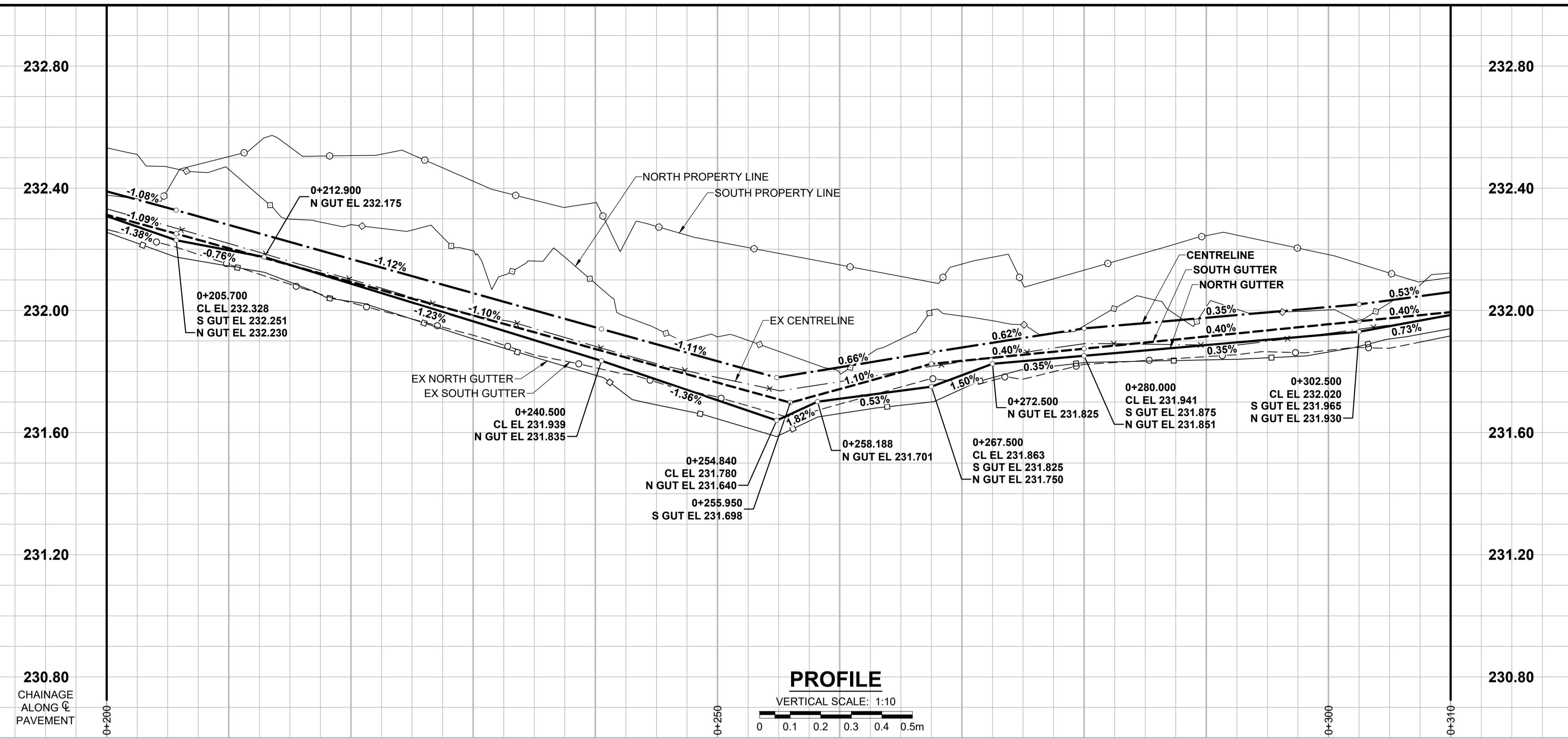

PROFILE
VERTICAL SCALE: 1:10
CHAINAGE ALONG ϕ PAVEMENT

- NOTES**
- ADJUST MH AND CB RIMS TO NEW GRADES.
 - LAMP STANDARDS, HYDRO POLES, AND ANCHORS THAT REQUIRE TEMPORARY SUPPORT, REMOVAL OR REPLACEMENT, TO BE DONE SO AT THE EXPENSE OF THE CONTRACTOR AS NECESSARY.
 - CONTRACTOR TO REGRADE/RENEW EXISTING PRIVATE SIDEWALKS TO LIMITS AS SHOWN. SIDEWALKS TO BE RENEWED WITH CONCRETE UNLESS NOTED OTHERWISE.
 - CONTRACTOR TO TAKE PRECAUTIONARY STEPS TO PROTECT EXISTING TREES WITHIN THE LIMITS OF CONSTRUCTION FROM DAMAGE FROM CONSTRUCTION ACTIVITIES AS OUTLINED IN THE SPECIFICATIONS.
 - CONTRACTOR TO CONFIRM THE LOCATION OF ALL UTILITIES/SERVICES IN THE FIELD PRIOR TO CONSTRUCTION.
 - MODIFIED BARRIER CURB TO BE USED AT ALL INTERSECTION RADII, BACK LANE RADII AND BULLNOSES.
 - CONTRACTOR TO OVERLAY DRIVEWAYS TO ENSURE POSITIVE DRAINAGE TO NEW STREET GRADES. FINAL LIMITS TO BE DETERMINED IN THE FIELD BY CONTRACT ADMINISTRATOR.
 - CB SD-023 & SD-024 OFFSETS ARE DIMENSIONED TO BOC. CB SD-025 OFFSETS ARE DIMENSIONED O/C.
 - REFER TO TENDER FOR DETAILS REGARDING TRAFFIC MANAGEMENT.
 - ADD 200.000 m TO ABBREVIATED ELEVATIONS TO OBTAIN GEODETIC ELEVATIONS.

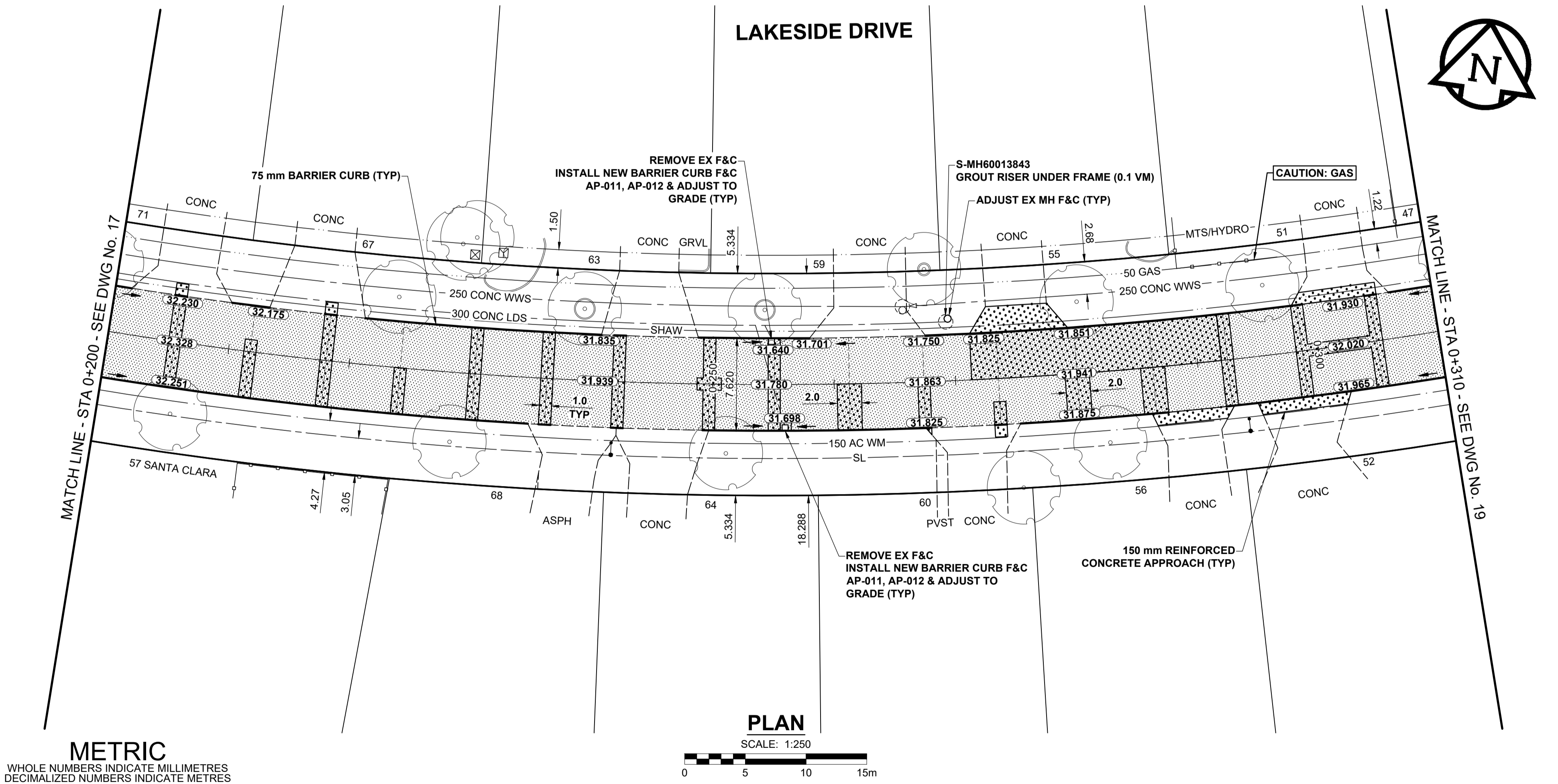

METRIC
WHOLE NUMBERS INDICATE MILLIMETRES
DECIMALIZED NUMBERS INDICATE METRES

EXISTING		NEW		EXISTING		NEW		EXISTING		NEW	
---	GAS	○	MANHOLE	●	CONCRETE PAVEMENT	●	LOCATION APPROVED	BM 76-021	N.E. Cor. Markham & Chancellor. Tbt. in W. Conc. Ind. Arthur A. Leach School, 12 m N. of prod. of the most Sky. wall & 0.4 m below top of Conc. Ind. of S/W. Cor. of Bldg.		
⊠	MTS HANDWELL/PEDESTAL	□	CATCH BASIN/CATCH PIT	■	CONC SIDEWALK/MEDIAN	▲	UNDERGROUND STRUCTURES	ELEV 232.526 m			
⊠	HYDRO HANDWELL/CABINET	△	CURB INLET WITH BOX	▲	ASPHALT PAVEMENT	▲	DATE				
---	CATV/FIBRE OPTIC	○	TREE	▲	PAVING STONE	▲					
---	TRAFFIC SIGNALS/PIT	⊕	TEST HOLE	▲	GRAVEL	▲					
---	LAND DRAINAGE SEWER	⊕	PROPERTY LINE	▲	RAMP CURB	▲					
---	SANITARY/COMBINED SEWER	⊕	SURVEY BAR	▲	PLANING/REMOVAL	▲					
---	CB LEAD/SSP/DCP	⊕	FENCE	▲		▲					
---	WATERMAIN	⊕	BOC/EDGE OF PAVEMENT	▲		▲					
---	SUBDRAIN	33.000	ELEVATION	(33.333)		▲					
---	DITCH	---	TRAFFIC SIGN	(33.333)		▲					
---	LEGEND - PLAN	---	LEGEND - PLAN	---	LEGEND - PLAN	---					

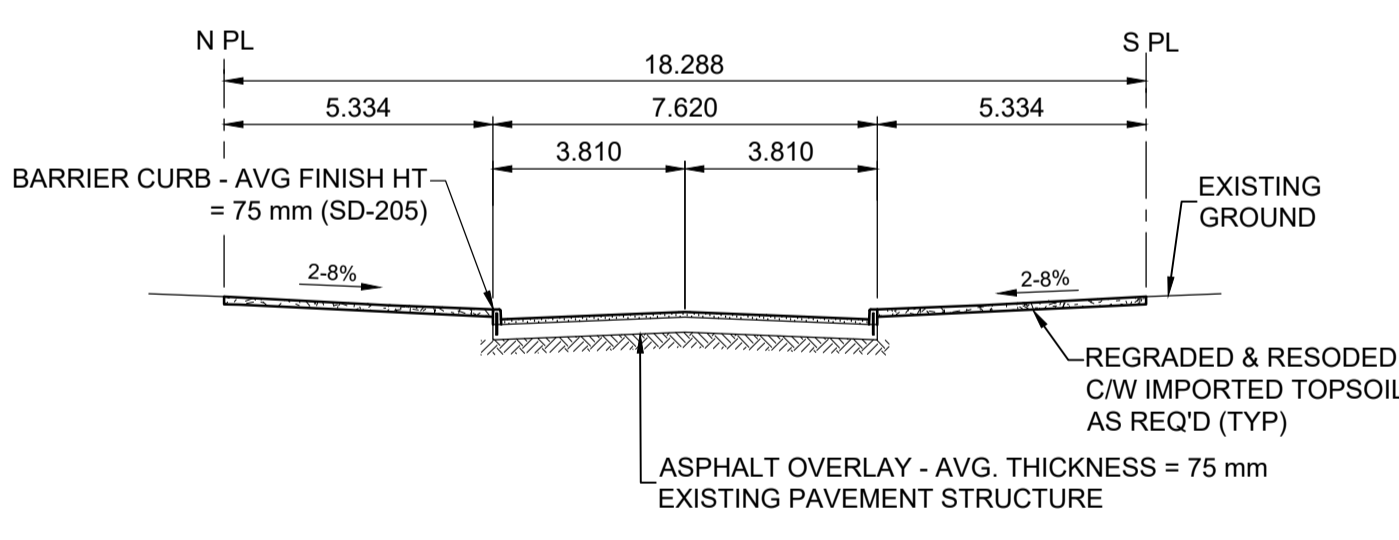

TYPICAL PAVEMENT SECTION
ASPHALT REHABILITATION
SCALE: NTS

ENGINEERS GEOSCIENTISTS MANITOBA
Certificate of Authorization
MORRISON HERSHFIELD
No. 1736
TENDER No. 19-2020

<p>DESIGNED BY: RPB</p> <p>CHECKED BY: GFC</p>		<p>PROFESSIONAL'S SEAL</p> <p>PRELIMINARY DRAWING</p> <p>NOT TO BE USED FOR CONSTRUCTION</p>	<p>THE CITY OF WINNIPEG PUBLIC WORKS DEPARTMENT ENGINEERING DIVISION</p> <p>2020 LOCAL STREET RENEWAL PROGRAM LAKESIDE DRIVE CHANCELLOR DR TO AUGUSTA DR REHABILITATION PAVING AND GRADING STA 0+200 TO STA 0+310</p>	<p>CITY DRAWING NUMBER: N/A</p> <p>SHEET: 18 OF 20</p> <p>DRAWING NUMBER: 18</p>	
<p>DRAWN BY: DML</p> <p>APPROVED BY: BWB</p>					
<p>ISSUED FOR TENDER: 20/04/20 RPB</p> <p>ISSUED FOR REVIEW: 20/03/13 RPB</p>		<p>HOR SCALE: 1:250</p> <p>VERT SCALE: 1:10</p> <p>RELEASED FOR CONSTRUCTION: 20/03/13</p>		<p>CONSULTANT FILE NAME: 1905658-Lakeside-PP-02.dwg</p>	