

CONSTRUCTION NOTES:

PROJECT SCOPE

1. INSTALL CONDUIT, BASES AND PITS AS SHOWN.
2. REBUILD SERVICE AND INSTALL GROUND ROD AS SHOWN. TOTAL LENGTH OF SERVICE CABLE: 20m.
3. INSTALL EQUIPMENT AS SHOWN. REMOVE PUSHBUTTONS AS SHOWN.
4. TIMINGS REQUIRED.

PROJECT COORDINATION

1. COORDINATE WORK WITH (CA'S NAME), (204) XXX-XXXX.
2. COORDINATE HYDRO SERVICE REBUILD WITH (HYDRO DESIGNER), (204) XXX-XXXX, RE: JUTA PERMIT No. BXXXXX

| DETECTION CONNECTION DETAILS | | | |
|------------------------------|----------|--------------------|-------|
| SENSOR NO. | POLE NO. | DETECTION LOCATION | NOTES |
| MATRIX 1 | 8 | EBL LANE | |

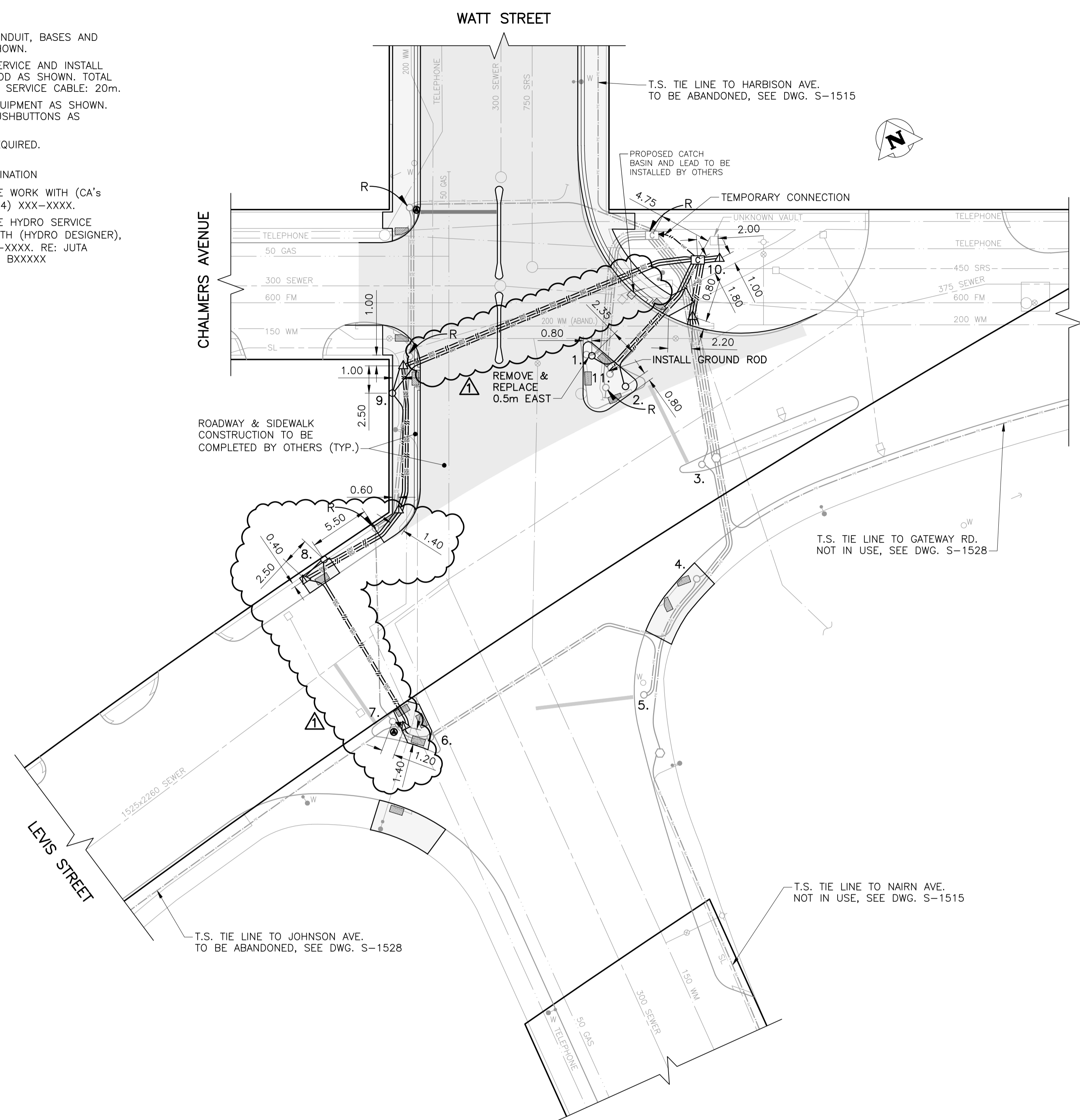
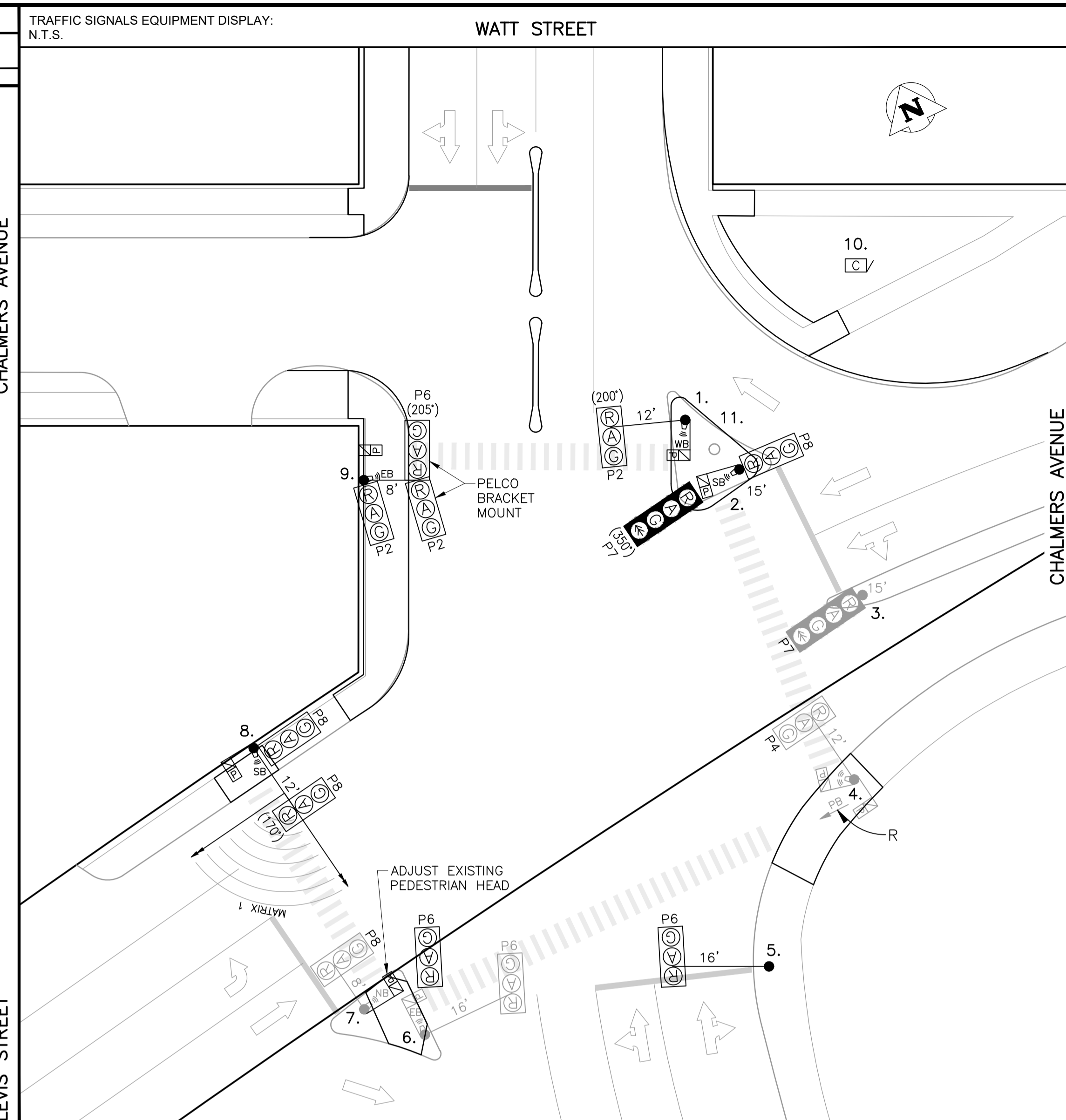

PLAN VIEW: UNDERGROUND CONSTRUCTION
1:250

| EQUIPMENT DISPLAY LEGEND | | | | EQUIPMENT LIST | | | | | | | |
|--------------------------|--|-----|---------------------------------|----------------|------|------|-----|---------------------|-----|------|------|
| EXISTING | PROPOSED (AS SHOWN BELOW) | NO. | EQUIPMENT LIST | ARM | BASE | B.B. | NO. | EQUIPMENT LIST | ARM | BASE | B.B. |
| | PEDESTRIAN HEAD | | 1. CANTILEVER | 12' | G | GC | 11. | HYDRO WOOD SERVICE: | | | |
| | PEDESTRIAN HEAD WITH PCS | | 2. 15' SIGNAL | | A | A | | | | | |
| | PEDESTRIAN CORRIDOR BOX | | 3. 15' SIGNAL | | A | A | | | | | |
| | VEHICLE DETECTION AREA | | 4. DAVIT | 12' | A | A | | | | | |
| | PUSH BUTTON & DIRECTION | | 5. DAVIT | 16' | A | AD | | | | | |
| | APS SINGLE DIRECTION | | 6. DAVIT | 16' | A | AD | | | | | |
| | APS DUAL DIRECTION (2 SEPARATE SPEAKERS) | | 7. DAVIT | 8' | A | A | | | | | |
| | TRAFFIC SIGNAL HEAD | | 8. CANTILEVER | 12' | G | GC | | | | | |
| | TRAFFIC SIGNAL POLE | | 9. CANTILEVER | 8' | OD | DC | | | | | |
| | RED FLASHER | | 10. 332 CABINET/2070 CONTROLLER | | | | | | | | |

| TRAFFIC SIGNALS UNDERGROUND LEGEND | | | | SIGNAL BASE BOLT SQUARE TYPES | | | |
|------------------------------------|-----------|---------------------------|---------------------------|--|---|--|---|
| EXISTING | ABANDONED | PROPOSED (AS SHOWN BELOW) | DISCONNECTED (LOOPS ONLY) | BOLT SQUARE (B.S.) DIA. | | | |
| 1 1/2" PE CONDUIT | --- | --- | --- | TYPE "A" - 8 1/8" | TYPE "B" - 6 3/4" | TYPE "C" - 8 1/8" SCREW TYPE | TYPE "D" - 12 3/4", 1 1/4" DIA. BOLTS, 24" DIA. |
| 2" PE CONDUIT | --- | --- | --- | TYPE "OD" - 12 3/4", 1 1/4" DIA. BOLTS, 28" DIA. | TYPE "PD" - 12 3/4", PRECAST, 1 1/4" DIA. BOLTS | TYPE "E" - 9 9/16" SCREW TYPE | TYPE "F" - 9 9/16" |
| AERIAL / BURIED CABLE | --- | --- | --- | TYPE "G" - 8 1/8", 1 1/4" DIA. BOLTS, 89mm PROJ. | TYPE "GS" - 8 1/8", 1 1/4" DIA. BOLTS, 76mm PROJ. | TYPE "PG" - 8 1/8", PRECAST, 1 1/4" DIA. BOLTS | TYPE "H" - 9 7/8" SCREW TYPE |
| CONDUIT STUB | --- | --- | --- | TYPE "I" - 7 3/4" | TYPE "J" - 10 5/8", 1 1/4" DIA. BOLTS | TYPE "K" - 10 5/8", PRECAST, 1 1/4" DIA. BOLTS | TYPE "L" - 6", 5/8" DIA. BOLTS |
| BREAK-IN | --- | --- | --- | TYPE "PM" - 8 1/8", PRECAST, 5/8" DIA. BOLTS | | | |
| SPICE | --- | --- | --- | | | | |
| SAW-CUT LOOPS | 1 2 | 1 2 | 1 2 | | | | |
| PERFORMED LOOPS | 1 2 | 1 2 | 1 2 | | | | |

| EXISTING | LEGEND | PROPOSED | EXISTING | LEGEND | PROPOSED | EXISTING | LEGEND | PROPOSED |
|-------------|-------------|------------------|------------------|---------------|---------------|---------------|---------------|---------------|
| 150 WM | WATERMAIN | 150 WM | PROPERTY LINE | TELEPHONE | TELEPHONE | TELEPHONE | TELEPHONE | TELEPHONE |
| HYDRANT | HYDRANT | ROADWAY | ROADWAY | COMMUNICATION | COMMUNICATION | COMMUNICATION | COMMUNICATION | COMMUNICATION |
| VALVE | VALVE | SIDEWALK | SIDEWALK | WOOD POLE | WOOD POLE | WOOD POLE | WOOD POLE | WOOD POLE |
| 300 SEWER | SEWER | CURB & CURB RAMP | CURB & CURB RAMP | STREET LIGHT | STREET LIGHT | STREET LIGHT | STREET LIGHT | STREET LIGHT |
| MANHOLE | MANHOLE | WARNING TILE | WARNING TILE | BANNER POLE | BANNER POLE | BANNER POLE | BANNER POLE | BANNER POLE |
| CATCH BASIN | CATCH BASIN | SLOPE | SLOPE | RAILWAY POLE | RAILWAY POLE | RAILWAY POLE | RAILWAY POLE | RAILWAY POLE |
| CURB INLET | CURB INLET | CULVERT | CULVERT | GUY-WIRE | GUY-WIRE | GUY-WIRE | GUY-WIRE | GUY-WIRE |
| HYDRO | HYDRO | BUILDING | BUILDING | FENCE | FENCE | FENCE | FENCE | FENCE |
| 100 GAS | GAS | TREE | TREE | GUARDRAIL | GUARDRAIL | GUARDRAIL | GUARDRAIL | GUARDRAIL |

| UNDERGROUND STRUCTURES | |
|---------------------------|-----------------|
| UNDERGROUND STRUCTURES ID | DATE (YYYYMMDD) |
| | |
| | |
| | |

| CONSTRUCTION REVISIONS | | | |
|------------------------|----------------------------|-----------------|------|
| NO. | REVISION | DATE (YYYYMMDD) | BY |
| 1 | RE-ISSUED FOR UGS APPROVAL | 2020/02/28 | R.S. |
| 0 | ISSUED FOR UGS APPROVAL | 2020/02/04 | R.S. |

| | |
|-------------|------|
| DESIGNED BY | R.S. |
| DRAWN BY | R.S. |
| CHECKED BY | C.H. |
| APPROVED BY | |

WT PENDING

PRELIMINARY

NOT FOR CONSTRUCTION

THE CITY OF WINNIPEG
PUBLIC WORKS DEPARTMENT
TRANSPORTATION DIVISION

TRAFFIC SIGNALS
CHALMERS AVE./ LEVIS ST. & WATT ST.

UNITS: ALL DIMENSIONS ARE IN METERS UNLESS OTHERWISE NOTED

DRAWING NUMBER: S-1521

U:\Staff\Projects\Chalmers, Levis & Watt\GIS\Drawings\Chalmers, Levis & Watt\S-1521.dwg
 U:\Staff\Projects\Chalmers, Levis & Watt\GIS\Drawings\Chalmers, Levis & Watt\S-1521.dwg