

NOTE: CHAINAGES SHOWN ARE ALONG N. P. OF POINT DOUGLAS AVE

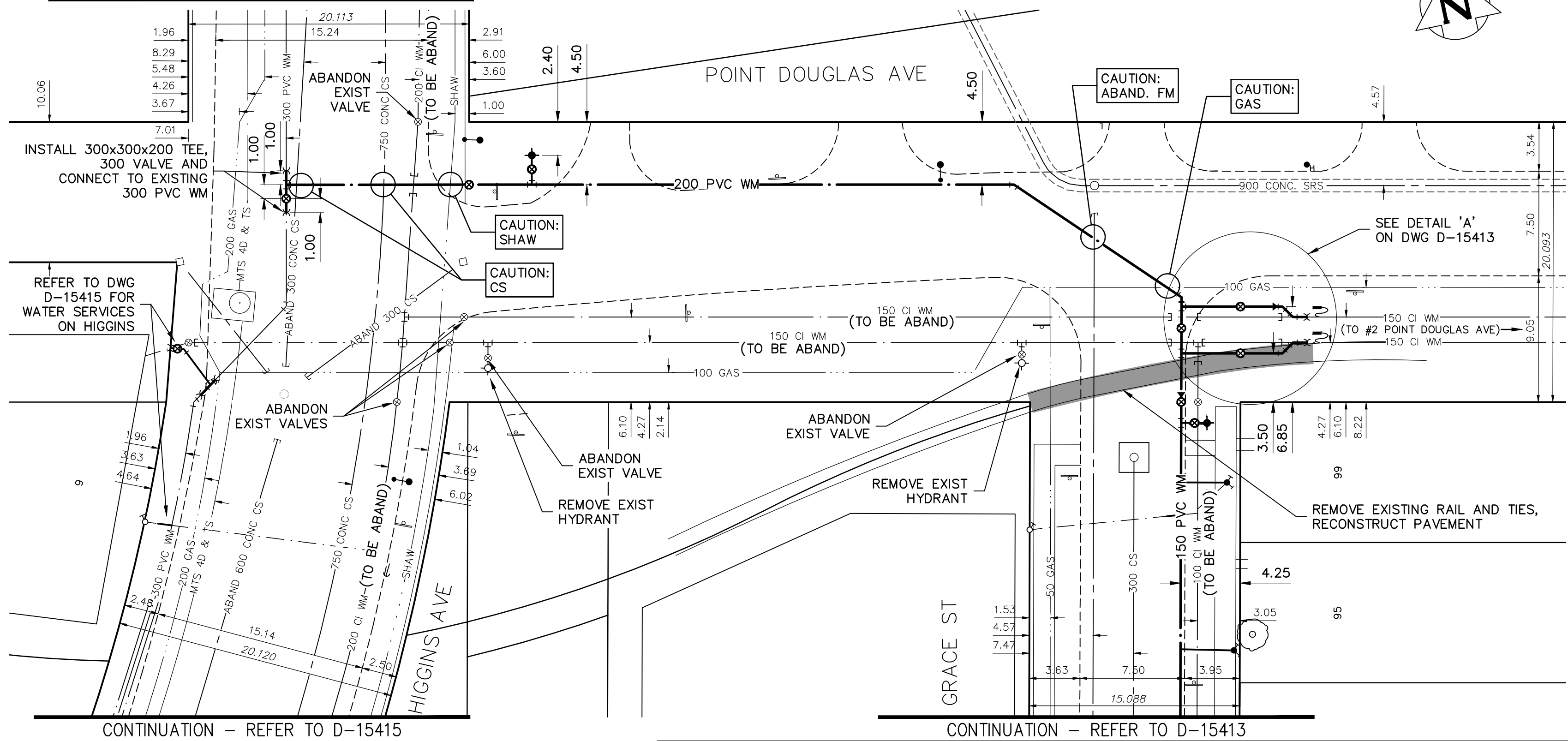

CONTINUATION - REFER TO D-15415

CONTINUATION - REFER TO D-15413

ALL VALVES TO BE COUNTER-CLOCKWISE TO CLOSE (RED OPERATING NUT)

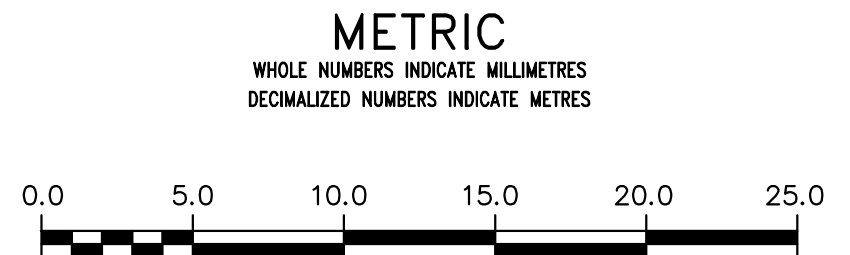

ENGINEERS
GEOSCIENTISTS
MANITOBA
Certificate of Authorization
AECOM Canada Ltd.
No. 4671 Date: April 19

REFER TO DRAWING D-15408 FOR CONSTRUCTION NOTES

WARNING
IF POWER EQUIPMENT OR EXPLOSIVES ARE TO BE USED FOR EXCAVATION ON THIS PROJECT THE CONTRACTOR MUST:
1) NOTIFY THE GAS COMPANY OF THE PROPOSED LOCATION OF EXCAVATION.
2) TAKE PRECAUTION TO AVOID DAMAGE TO GAS COMPANY INSTALLATIONS.
SEE PROVINCIAL REGULATION 210/72 FOR DETAILS

LOCATION APPROVED
UNDERGROUND STRUCTURES
SUPV. U/G STRUCTURES COMMITTEE DATE
NOTE:
LOCATION OF UNDERGROUND STRUCTURES AS SHOWN ARE BASED ON THE BEST INFORMATION AVAILABLE BUT NO GUARANTEE IS GIVEN THAT ALL EXISTING UTILITIES ARE SHOWN OR THAT THE GIVEN LOCATIONS ARE EXACT. CONFIRMATION OF EXISTENCE AND EXACT LOCATION OF ALL SERVICES MUST BE OBTAINED FROM THE INDIVIDUAL UTILITIES BEFORE PROCEEDING WITH CONSTRUCTION.

B.M. 35-017 ELEV. 230.730m	N.W. Cor. Higgins Ave. & Gomez St., Tbt. in S. Conc. Foundation No. 109 Higgins Ave., 1.5 m W. & 1 m below brick of S.E. Cor. of Bldg.
DESIGNED BY	JP
CHECKED BY	GSK
DRAWN BY	JP
SCALE:	HORIZONTAL 1:250 VERTICAL 1:50
DATE	2019/04/04
REVISIONS	NO. DATE BY
1	ISSUED FOR ADDENDUM 1 19/04/04 GSK
0	ISSUED FOR TENDER 19/03/29 GSK
A	ISSUED FOR REVIEW 19/03/15 GSK

AECOM

DESIGNED BY JP CHECKED BY GSK
DRAWN BY JP APPROVED BY
SCALE: HORIZONTAL 1:250 VERTICAL 1:50
DATE 2019/04/04

ENGINEER'S SEAL
PROVINCE OF MANITOBA
K.W. FITCHETT
REGISTERED PROFESSIONAL ENGINEER
CONSULTANT DRAWING NUMBER
C-0006

THE CITY OF WINNIPEG
WATER AND WASTE DEPARTMENT
ENGINEERING DIVISION
2019 WATER MAIN RENEWALS
CONTRACT 7
POINT DOUGLAS AVENUE
HIGGINS AVENUE TO
GRACE STREET
SHEET 8 OF 19
CITY DRAWING NUMBER
D-15414