

**SPECIFICATIONS**

Work under this contract covers all material and labour for:

- A. Demolition and Removal**
- 1) Removal of complete concrete pool deck, including upper portion of pool walls and pipe chase walls. The concrete walls shall be demolished 10 inches below the deck top on the north and east sides and 16 inches below the deck top on the south and west sides. Leave existing wall reinforcing projecting approximately 10 inches.
  - 2) Existing trees around deck shall be cut above grade by the city, however the contractor shall remove the stumps to a depth of 3 feet and backfill with compacted granular material. There are 10 tree stumps that are to be removed.
  - 3) Remove a section of the concrete pool bottom for installation of weeping pipe and coarse drainage stone. The size of this trench shall be a minimum 20 feet long, 3 feet wide and 2 feet 6 inches deep.
  - 4) Install 6" x 6" timbers or equivalent on 6 foot centres at top of pipe chase wall to prevent collapse of walls.
  - 5) Remove all piping and pool fittings in pipe chase except for 2" # water service. The water service is located at the bottom of the pipe chase at the northwest side of the pool. Removal of the 8" # main pool valve embedded in the concrete is also included in this work along with sealing of the pipe and patching of the hole.
  - 6) Remove all stumps, concrete, piping and surplus material from site. Leave ground level on completion of work.
  - 7) Sweep pool tank on completion of work.
- B. Service Manhole and Piping**
- 1) Install 36" # x 14' deep precast manhole. All backfilling around manhole and piping shall be granular material and compacted to 100% Modified Proctor in 6 inch lifts with plate vibrators.
  - 2) Install 8" # P.V.C. service to combined sewer on Marion Street (approx. 60'). (ASTM D 3034)
  - 3) Install 4" # P.V.C. weeping pipe to manhole from below pool bottom. Backfill around pipe and trench with coarse washed stone.
  - 4) Install new 6" # P.V.C. pool drain from centre of pool to manhole and back to pump building. All pipes and fittings shall be Rehau P.V.C. Series 125 pressure pipe or equal and comply to ASTM D1784. Drain inlet and concrete patch in pool shall be done by others.
  - 5) Install new 6" # P.V.C. drain from pipe chase to manhole complete with Zurn 2N-400R strainer or equal.
  - 6) Install 3 - 8" # P.V.C. sewer pipe (ASTM D3034) from pipe chase to pump building to act as piping sleeves. Pipes shall be laid in a common trench 4 feet below the deck. All backfill around these pipes shall be with granular material and compacted in 6 inch lifts. Patch holes in concrete on completion.
- C. Cooperation with Others on Site**
- 1) All work shall be completed within 14 days of award of work in order to have the reconstruction completed by June 15, 1983.
  - 2) Contractor shall cooperate with the concrete and plumbing contractors working on the site preparing the reconstruction of the pool.
  - 3) Contractor shall pay for all permits (mainly demolition and sewer connection) and provide city with \$250,000.00 comprehensive liability insurance to the satisfaction of the city prior to starting of any work.

- LEGEND:**
- ⊗ TREE STUMPS TO BE REMOVED
  - EXIST CONG TO BE REMOVED
  - EXIST ASPH TO BE REMOVED
  - EXIST TREE

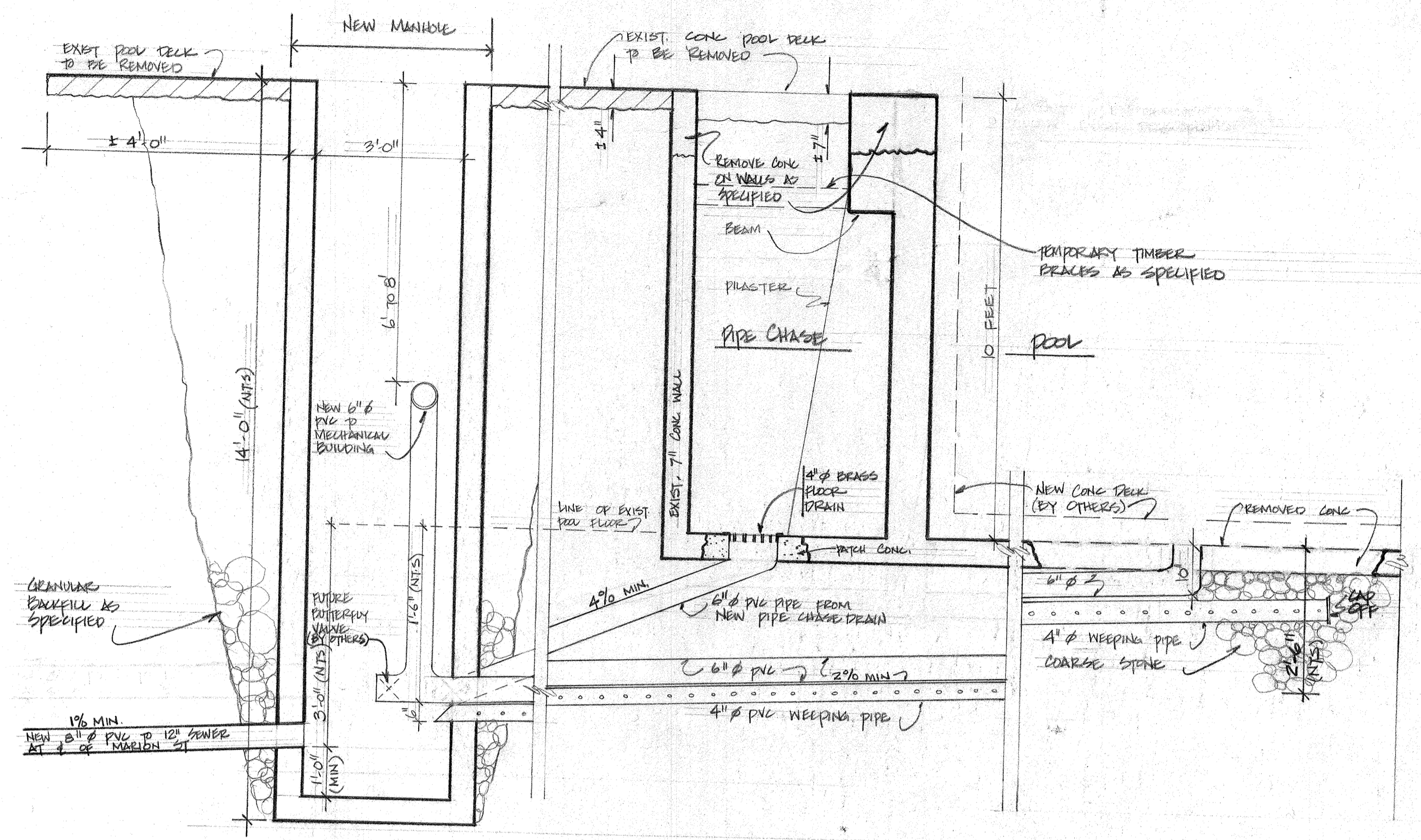

SECTION THRU NEW MANHOLE & PIPE CHASE  
SCALE: 1" = 2'-0"

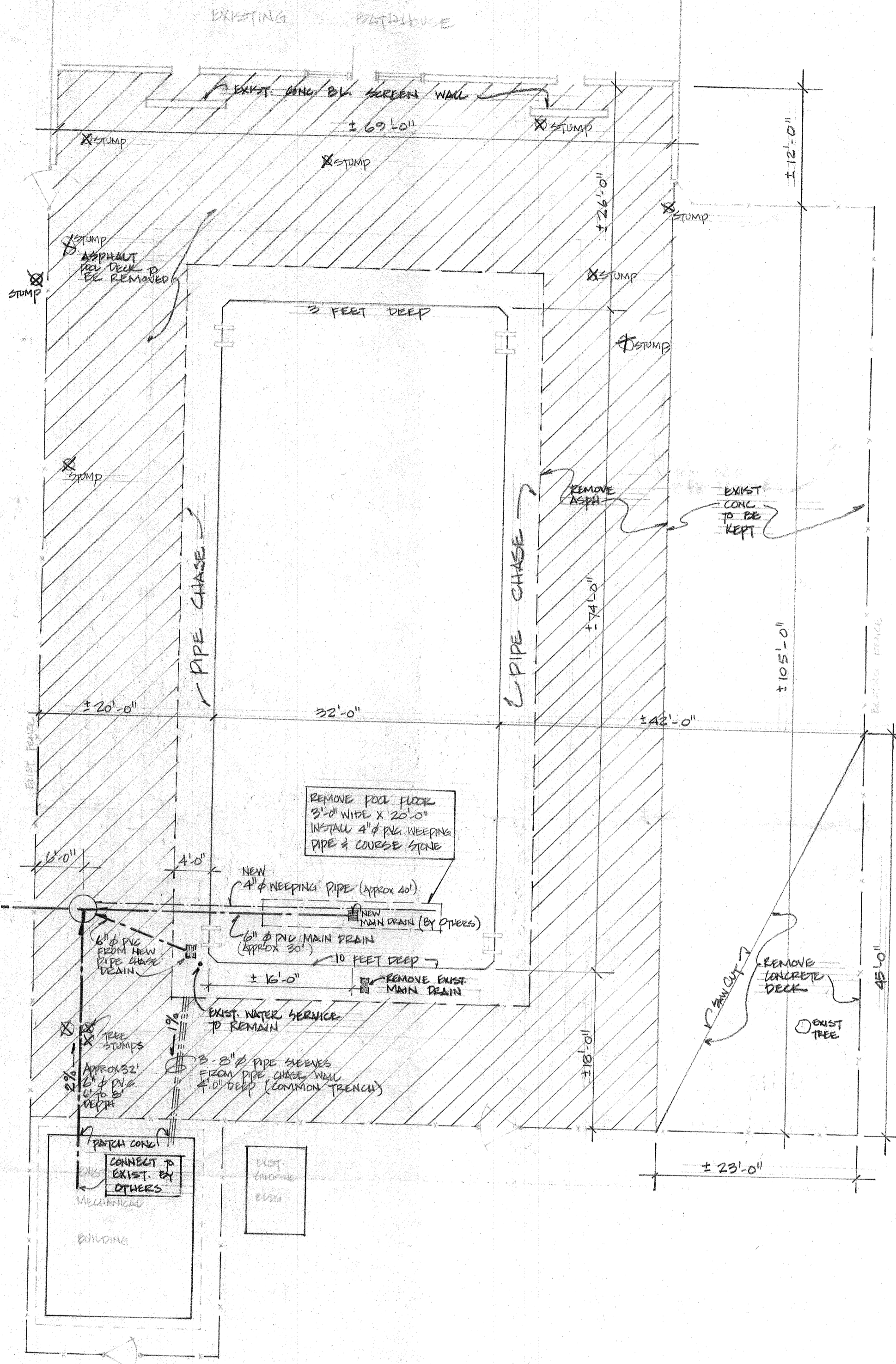

SITE PLAN  
SCALE: 1" = 10'-0"

| NO | REVISION/DESCRIPTION | DATE |
|----|----------------------|------|
|    |                      |      |

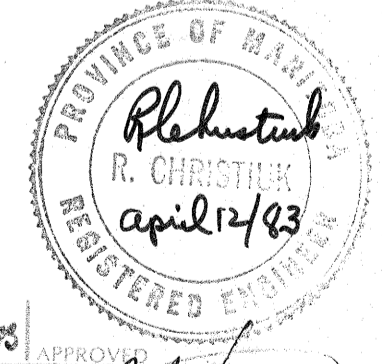

DRAWN BY: AED  
DATE: 05-87  
CHECKED BY: MMMS  
DATE: 05-87  
APPROVED BY: W.R. Sullivan

THE CITY OF WINNIPEG  
CIVIC PROPERTIES DEPARTMENT  
6 - 510 Main St. R3B 1B9

PROJECT: 470 MARION STREET  
HAPPYLAND PARK POOL

SHEET TITLE: DEMOLITION of POOL DECK & FLOOR  
INSTALLATION of SEWERAGE