

PEMBINA HIGHWAY SOUTHBOUND PROFILE

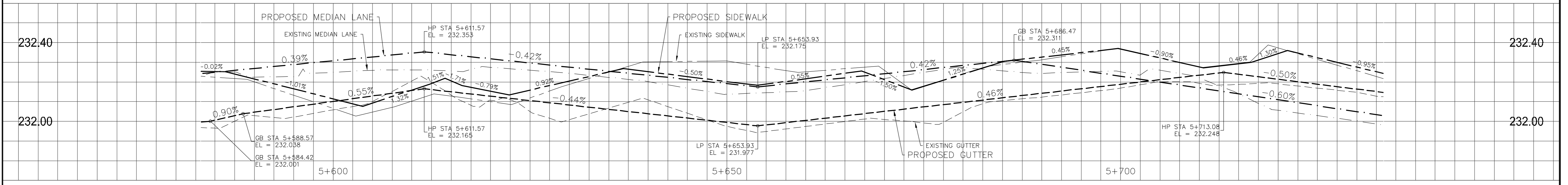

PEMBINA HIGHWAY NORTHBOUND PROFILE

Curve Table	
Curve #	Length
C31	Δ RT L 914'56" 20.000 1.62 3.23
	BC 5525710.839 633268.133
	EC 5525708.023 633266.561
C32	Δ RT L 12'34'44" 20.000 2.20 4.39
	BC 5525710.956 633270.540
	EC 5525707.891 633273.671
C33	Δ RT L 14'32'17" 21.000 2.68 5.33
	BC 5525804.132 633312.159
	EC 5525805.161 633317.373
C34	Δ RT L 50'27'58" 15.000 7.07 13.21
	BC 5525810.801 633315.315
	EC 5525819.526 633324.865

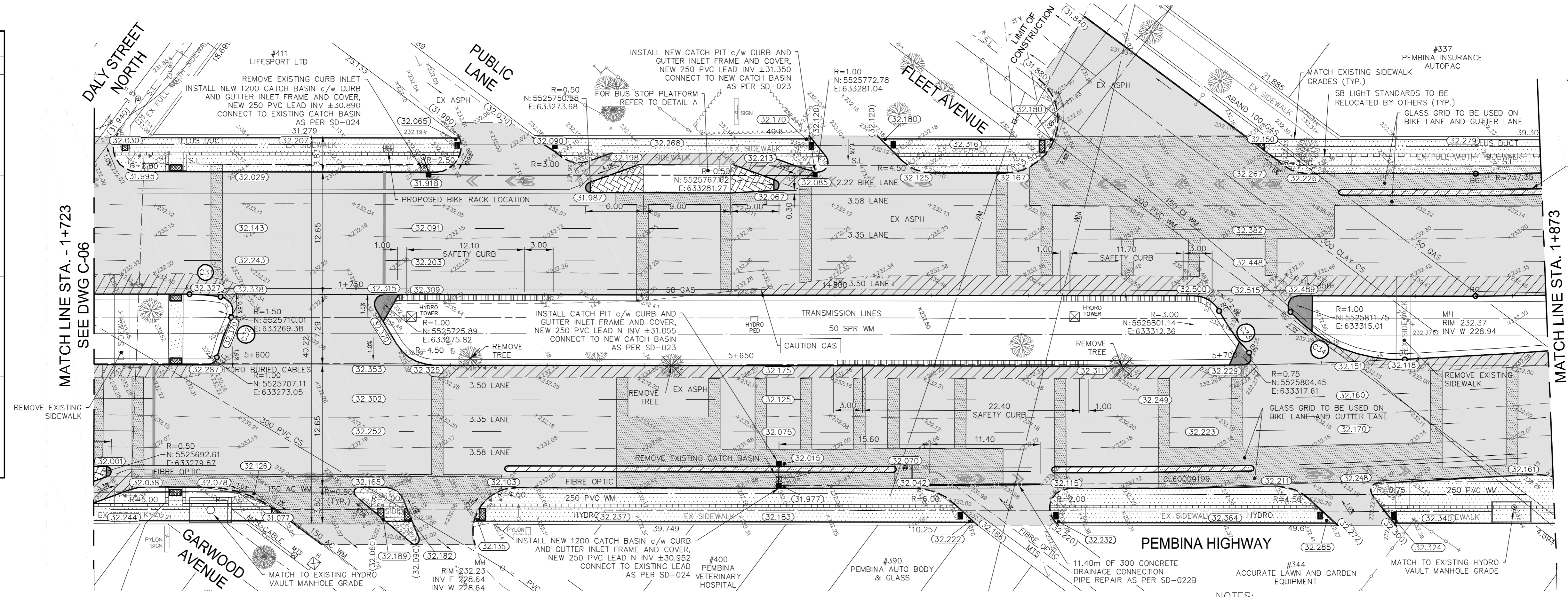

SYMBOL	DESCRIPTION	SYMBOL	DESCRIPTION
—	WATER MAIN	—	#111 CIVIC ADDRESS
---	LAND DRAINAGE SEWER	—	HYDRO POLE & LIGHT STANDARD
---	WASTE WATER SEWER	—	LIGHT STANDARD
---	HYDRO	—	HYDRO POLE
---	M.T.S.	—	CURB RAMP
---	GAS	—	DETECTABLE WARNING SURFACE TILE c/w RAMP
---	SIGNALS	—	EDGE OF SIDEWALK
○	MANHOLE	—	PROPERTY LINE
□	CATCH BASIN	—	EDGE OF ASPHALT
△	CURB INLET	—	MODIFIED BARRIER CURB
△	UTILITIES ADJUSTED	—	BARRIER CURB
⌋	PLUG	—	BARRIER CURB WITH SPLASH STRIP
⊕	HYDRANT	—	TRAFFIC SIGNAL
⊙	VALVE	—	SIDEWALK
⊕	CURB STOP	—	CONCRETE SLAB REPAIR
○	GROUND GRADE	—	ASPHALT
—	PAVEMENT GRADE	—	CONCRETE
—	LOT GRADE	—	INTERLOCKING PAVING STONES
—	ANCHOR	—	BULLNOSE
—	EXISTING	—	PROPOSED

FOR SECTIONS AND DETAILS REFER TO C-20

NOTE: These design documents are prepared solely for the use by the party with whom the design professional has entered into a contract and there are no representations of any kind made by the design professional to any party with whom the design professional has not entered into a contract.

NO.	REVISIONS	DATE	BY
4	ADDENDUM 1	28.MAY.16	VM
3	ISSUED FOR TENDER	16.MAY.16	VM
2	ISSUED TO UNDERGROUND STRUCTURES	16.MAY.16	VM
1	ISSUED FOR CLIENT REVIEW	28.APR.16	VM

NO.	REVISIONS	DATE	BY
4	ADDENDUM 1	28.MAY.16	VM
3	ISSUED FOR TENDER	16.MAY.16	VM
2	ISSUED TO UNDERGROUND STRUCTURES	16.MAY.16	VM
1	ISSUED FOR CLIENT REVIEW	28.APR.16	VM

MMM GROUP

DESIGNED BY: SQ/JP
 CHECKED BY: VM/TP
 DRAWN BY: HK/LT
 APPROVED BY: VM
 HORIZ. SCALE: 1:250
 VERTICAL SCALE: 1:10
 DATE: MARCH 2016

THE CITY OF WINNIPEG
 PUBLIC WORKS DEPARTMENT
 ENGINEERING DIVISION

PEMBINA HIGHWAY
 FROM CARTER AVENUE TO OSBORNE STREET

PAVEMENT REHABILITATION
 SOUTHBOUND STA. 1+723 - STA. 1+873

CITY DRAWING NUMBER: 07 OF 27
 BID NO.: 386-2016

METRIC
 WHOLE NUMBERS INDICATE MILLIMETRES
 DECIMALIZED NUMBERS INDICATE METRES

APEGM
 Certificate of Authorization
 MMM Group Limited
 No. 4531

May 25, 2016 - 4:07pm P:\5516001-5516009\5516006 - Pembina Hwy Pavement Rehab. & Bike Lane\MMW Drawings\Construction Drawings\5516006 CD1-C12 Rehabilitation Addendum 1 20160526.dwg - tab:STA. 1+750.00 - STA. 1+900.00