

**GENERAL NOTES**

- ALL DIMENSIONS SHOWN IN METRIC UNITS. NUMBERS WITH DECIMALS INDICATE METERS. WHOLE NUMBERS INDICATE MILLIMETERS.
- CONTRACTOR TO CONFIRM ALL DIMENSIONS AND REPORT ANY DISCREPANCIES TO CONTRACT ADMINISTRATOR AND CITY OF WINNIPEG PRIOR TO CONSTRUCTION.
- LAYOUT TO BE APPROVED BY CONTRACT ADMINISTRATOR AND CITY OF WINNIPEG PRIOR TO ANY CONSTRUCTION OR REMOVALS.
- THE CONTRACTOR IS RESPONSIBLE FOR ALL EXCAVATIONS, REMOVALS, DISPOSALS, AND ROUGH GRADING AS REQUIRED TO CONSTRUCT ALL WORKS AS SHOWN ON ALL PLANS, DETAILS AND SPECIFICATIONS. ALL ITEMS TO BE REMOVED MUST BE DISPOSED OF LEGALLY OFF SITE. ALL REUSABLE PAVING STONE TO BE STOCKPILED FOR REINSTALLATION. DISPOSE OF EXCESS AND UNSUITABLE MATERIAL. SAWCUT EXISTING PAVEMENT TO ENSURE CLEAN EDGE ON PAVEMENT TO REMAIN (NO BROKEN EDGES) REFER TO SURVEY FOR EXTENT OF REMOVALS.
- THE CONTRACTOR SHALL PROVIDE A QUALIFIED CREW TO LAYOUT SITE WORKS. THE CREW SHALL BE EQUIPPED WITH ALL THE NECESSARY EQUIPMENT TO PROVIDE HORIZONTAL AND VERTICAL LAYOUT IN ACCORDANCE WITH THE PLANS AND SPECIFICATIONS.
- REFER ALSO TO WRITTEN SPECIFICATIONS.
- EXISTING BENCHES, GARBAGE RECEPTACLES, NEWSPAPER BOXES, AND MAIL BOXES TO BE TEMPORARILY RELOCATED BY CONTRACTOR. CONTRACTOR TO COORDINATE WITH RESPECTIVE PARTIES AS REQUIRED.

- LOCATION OF ALL UTILITIES SHOWN FOR ILLUSTRATION ONLY. CONTRACTOR MUST CONTACT ALL UTILITIES REGARDING RULES FOR WORKING IN THE AREA OF THE UTILITIES PRIOR TO COMMENCEMENT OF ANY WORK. CONTRACTOR MUST CONFIRM LOCATION OF ALL UTILITIES PRIOR TO CONSTRUCTION.
- CONTRACTOR TO ADJUST GRADES OF ALL SERVICES AS REQUIRED TO BRING FLUSH TO NEW FINISH GRADE. REFER TO ENGINEER'S DRAWINGS AND SPECIFICATIONS FOR ALL MANHOLE CATCH BASINS, FIRE HYDRANT, CURB STOPS, ETC. REMOVALS, RELOCATIONS AND ADJUSTMENTS.
- CONTRACTOR TO SUPPLY AND INSTALL SQUARE CONCRETE COLLARS FOR ALL SURFACE UTILITIES IN SIDEWALK. WHERE COLLAR EXTENDS INTO PAVING BANDS CONTRACTOR TO ENSURE CONCRETE EXTENDS TO NEAREST LINE OF PAVEMENT.
- DURING CONSTRUCTION, CONTRACTOR TO PROTECT TO CITY OF WINNIPEG STANDARDS ALL EXISTING TREES, SIDEWALKS, CURBS, SOD, UTILITIES, AND PAVING TO REMAIN. CONTRACTOR TO REPAIR ALL ON AND OFF SITE SODDED AREAS, SHRUB BEDS, TREES, CONCRETE, ROAD PAVING AND CURBS ETC., DAMAGED DURING CONSTRUCTION TO ENGINEER'S SATISFACTION AND TO THE CITY OF WINNIPEG STANDARDS AT THEIR OWN COST.
- ALL WORK TO BE DONE IN ACCORDANCE WITH CITY OF WINNIPEG STANDARD CONSTRUCTION SPECIFICATIONS UNLESS OTHERWISE NOTED.
- REFER TO ELECTRICAL DRAWINGS FOR LOCATION AND DETAILS FOR ALL SITE LIGHTING, POWER OUTLETS, ETC.

**LEGEND**

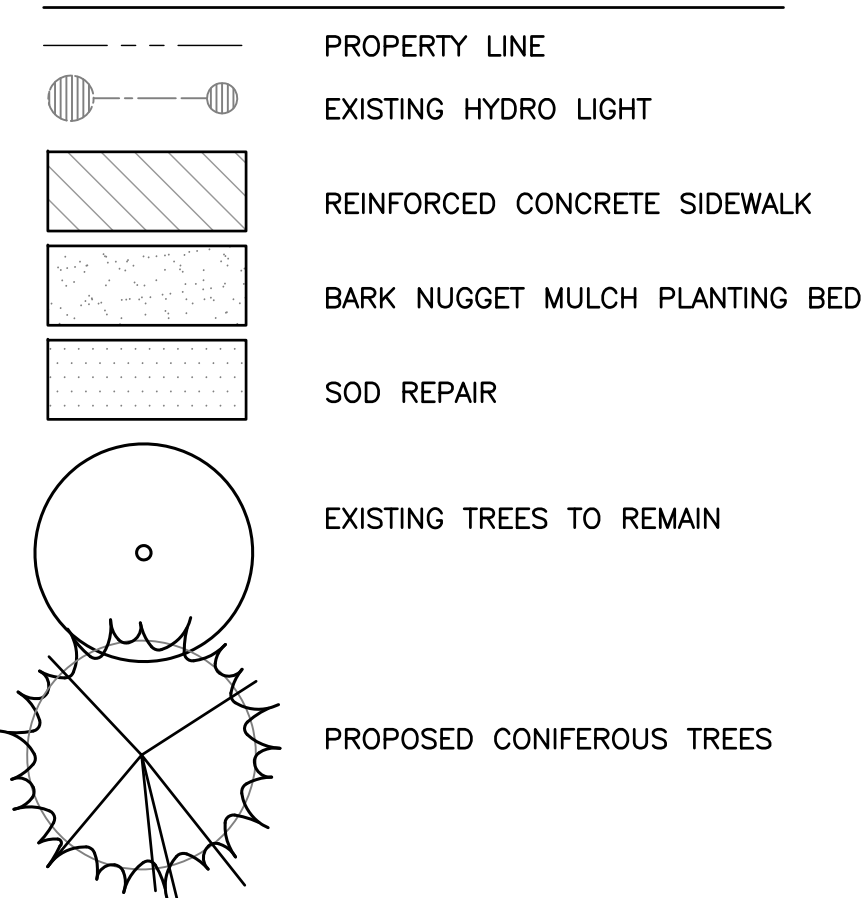

**PLANT LIST**

KEY	QTY.	COMMON NAME/BOTANICAL NAME	SIZE	REMARKS
<b>CONIFEROUS TREES</b>				
B	5	BLACK HILLS SPRUCE / PICEA GLAUCA 'BLACK HILLS'	2.1m ht.	SPECIMEN, W.B. MACHINE DUG WITH SINGLE UPRIGHT LEADER. STRAIGHT TRUNK, WELL BRANCHED, FULL FORM

1	ADDENDUM 1	23/05/14	AH
2	ISSUED FOR TENDER	13/05/14	AH
Date:		Scale:	
28-03-14		1:100	
Designed By:	Drawn By:	Checked By:	
JW	MD	SR	



**PROVENCHER PARK UPGRADES**

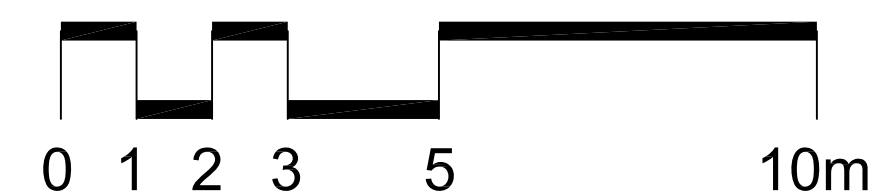
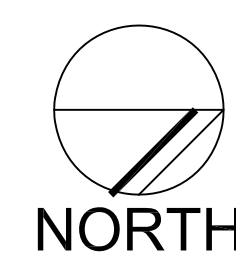

Sheet Title:	<b>SPRAY PAD LAYOUT</b>
Project No:	13-031
Drawing No:	L1.2