

Item 1 – Room 179 – Standard Workstation – 2D Drawing

Room Depth – 159"

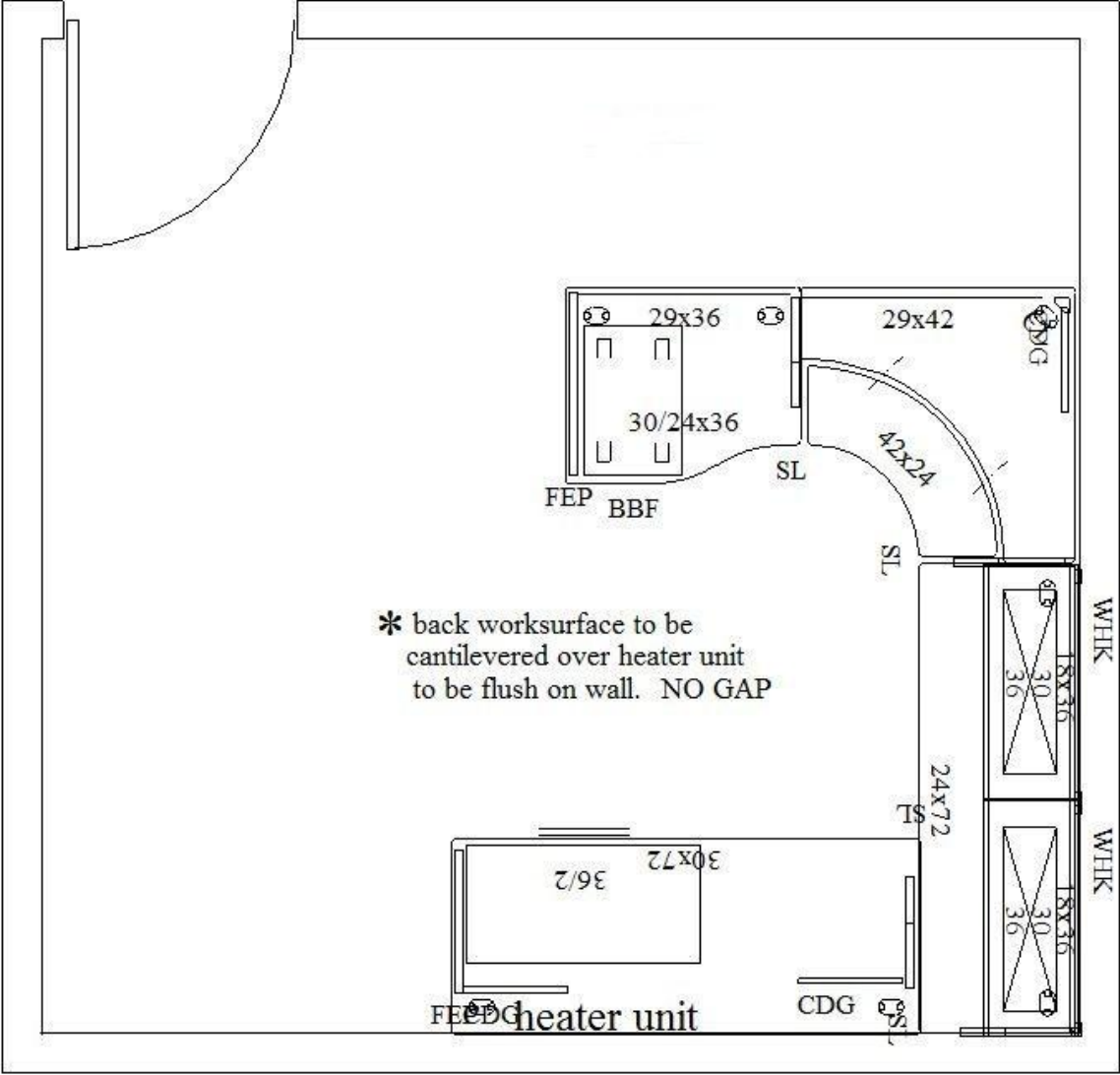

Room Width – 152"

**Item 1 – Room 179 – Standard Workstation – 3D Drawing**



## Item 1 – Room 179 – Standard Workstation – Parts List

Item	Part Description	Qty
1	Altitude Corner 24Dx42W T-Mold Eg Dual Surface	1
	7-11/16" from either crner Edg	
	Plastic Grommet	
	L1 Woodgrain Lam Opts	
	Lam: Natural Maple-Former D	
	Edg: Warm Beige	
	CLR: Warm Beige	
2	Primary 30Dx72W T-Mold Eg Lam w/Grommets	1
	L1 Woodgrain Lam Opts	
	Lam: Natural Maple-Former D	
	Edg: Warm Beige	
	Plastic Grommet	
3	Wave W/S 36Wx30L/24R T-Mold Eg Lam w/Grom	1
	L1 Woodgrain Lam Opts	
	Lam: Natural Maple-Former D	
	Edg: Warm Beige	
	Plastic Grommet	
4	Freestanding 30DX29-1/2H End Panel Support	1
	Core Clr Opts	
	CLR: Driftwood de-emph 4/12/09	
5	Freestanding 24Dx29-1/2H Support Leg	2
	Core Clr Opts	
	CLR: Driftwood de-emph 4/12/09	
6	Gussets (1 Pr)	3
	Core Clr Opts	
	CLR: Driftwood de-emph 4/12/09	
7	Panel Mount 24Dx29-1/2H Support Leg	2
	Core Clr Opts	
	CLR: Driftwood de-emph 4/12/09	
8	Full-Height 29-1/2Hx36W Modesty Panel	1
	Core Clr Opts	
	CLR: Driftwood de-emph 4/12/09	
9	Full-Height 29-1/2Hx42W Modesty Panel	1
	Core Clr Opts	
	CLR: Driftwood de-emph 4/12/09	
10	Corner Desk Leg 29-1/2H	1
	Core Clr Opts	
	CLR: Driftwood de-emph 4/12/09	

	Freestanding 24DX29-1/2H End Panel Support	1
11	Core Clr Opts	
	CLR: Driftwood de-emph 4/12/09	
	Ess OH Stg Cab 36W/Sq Pntd Flip Door No Pull	2
12	Core Clr Opts	
	CLR: Driftwood de-emph 4/12/09	
	Standard Random key	
	Tackboard 36W 18H	2
13	GRD 1 FAB	
	FAB: Etch	
	CLR: Lithograph	
	Primary 24Dx72W T-Mold Eg Lam w/Grommets	1
14	L1 Woodgrain Lam Opts	
	Lam: Natural Maple-Former D	
	Edg: Warm Beige	
	Plastic Grommet	
	Permanent-Wall Hanger Kit 65H - Pair	2
15	Core Clr Opts	
	CLR: Driftwood de-emph 4/12/09	
	Tasklight w/electronic Ballast for 30W	2
16	CLR: No Color Choice	
	Ess Mobile Ped BBF 26-7/8H 22-7/8D Int Pull	1
17	Core Clr Opts	
	CLR: Driftwood de-emph 4/12/09	
	Standard Random key	
	Ess Lat 36W 28H 2-12" Drws Int Pull	1
18	Core Clr Opts	
	CLR: Driftwood de-emph 4/12/09	