

FURNITURE LEGEND

- ITEM 1 IST TYPICAL WORKSTATION
- ITEM 2 TYPICAL PRIVATE OFFICE PLAN
- ITEM 3 SWS MANAGER'S DESK (#3)
- ITEM 4 IST MANAGER'S DESKS (#1&8)
- ITEM 5 SWS "CLOSED" WORKSTATION
- ITEM 6 SWS CLERKS' WORKSTATION
- ITEM 7 SWS "OPEN" WORKSTATIONS
- ITEM 8 SWS FIELD STAFF "HOTELLING" DESKS
- ITEM 9 SWS STUDENT DESKS
- ITEM 10 IST WORKROOM DESKS
- ITEM 11 IST CONSULTANT DESKS
- ITEM 12 MANUAL STORAGE SHELVES
- ITEM 13 TALL STORAGE CABINET - (PART OF IST WORKROOM DESK COMPONENTS)
- ITEM 14 DRAWER LATERAL FILES
- ITEM 15 SUPPLY CABINETS
- ITEM 16 END TAB FILING SHELVING
- ITEM 17 OPEN STORAGE SHELVING
- ITEM 18 FILE BOX STORAGE SHELVES
- ITEM 19 CUSTOM MAP STORAGE UNIT
- ITEM 20 MEETING ROOM TABLE - n.i.c
- ITEM 21 IST MEETING ROOM TABLE
- ITEM 22 BOARDROOM TABLES
- ITEM 23 MEDIASCAPE STOOL HEIGHT TABLE
- ITEM 24 LUNCH ROOM TABLES
- ITEM 25 COFFEE TABLE
- ITEM 26 STOOL HEIGHT COUNTERS OVER FILE CABINETS
- ITEM 27 PRIVATE OFFICE ROUND MEETING TABLES
- ITEM 28 CABINETS
- ITEM 29 LUNGEON SEATING
- ITEM 30 OTTOMAN
- ITEM 31 ARMLESS TABLET CHAIRS
- ITEM 32 NOT USED
- ITEM 33 IST TASK CHAIRS
- ITEM 34 SWS CONSULTANT / MEETING ROOM CHAIRS
- ITEM 35 MEETING TABLE STOOL TASK CHAIRS
- ITEM 36 PRIVATE OFFICE GUEST CHAIRS
- ITEM 37 IST MANAGER WHITEBOARD 48"x76"
- ITEM 38 IST OFFICE WHITEBOARDS 48"x60"
- ITEM 39 MOBILE WHITEBOARD
- ITEM 40 FULL-HEIGHT WALL MOUNTED WHITEBOARDS
- ITEM 41 TACKBOARD
- ITEM 42 PODIUM / LECTURN
- ITEM 43 MEETING ROOM CONSOLE
- ITEM 44 RECEPTION DESK WORKSTATION
- ITEM 45 COUNTERTOP OVER FILE CABINETS

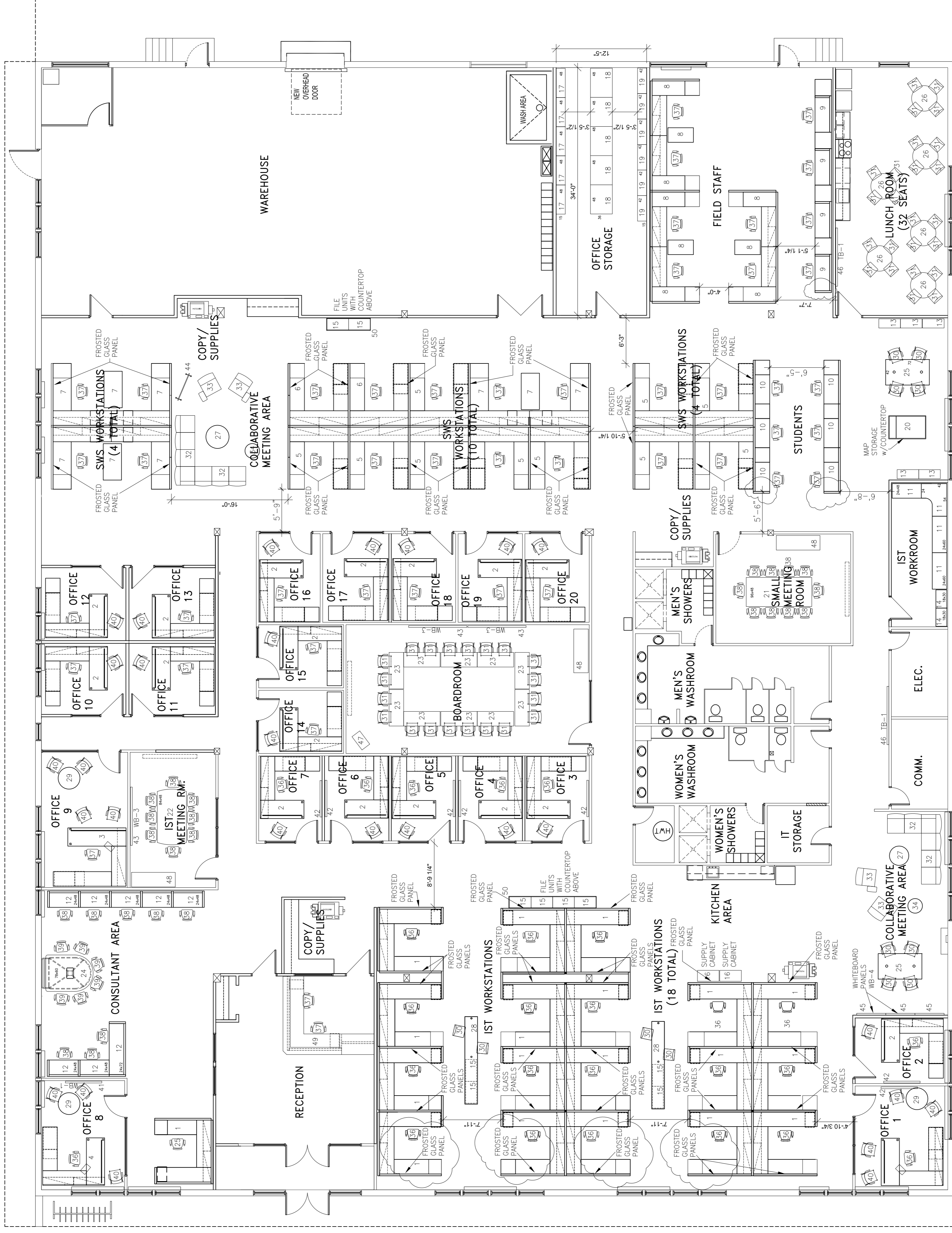

MAIN FLOOR PLAN - FURNITURE PLAN
SCALE: 1/8"=1'-0"

NOTES:

- 1. THESE DRAWINGS SHALL NOT BE SCALED.
- 2. THE CONTRACTOR SHALL VISIT THE SITE AND SATISFY HIMSELF ALL DIMENSIONS, DATA, AND DETAILED INFORMATION SHOWN ARE CORRECT.
- 3. THE CONTRACTOR SHALL DESIGN AND COORDINATE ALL ARCHITECTURAL, MECHANICAL, ELECTRICAL AND STRUCTURAL DRAWINGS FOR ADDITIONAL OPENINGS THROUGH FLOORS, WALLS, AND CEILINGS FOR DUCT, PIPE, ELECTRICAL RISERS AND ALL OPENINGS NOT SHOWN ON DRAWINGS.
- 4. ALL OPENINGS THROUGH FIRE ASSEMBLIES ARE TO BE FIRE STOPPED AND SEALED WITH ILC APPROVED FIRE STOPPING TO MAINTAIN THE INTEGRITY OF THE FIRE SEPARATION, AND PROVIDE A SMOKE-TIGHT BARRIER.
- 5. ALL PRODUCTS AND MATERIALS TO BE USED AND INSTALLED SHALL CONFORM WITH MANUFACTURER'S SPECIFICATIONS & APPLICABLE CODES.
- 6. THE CONTRACTOR SHALL BE RESPONSIBLE TO PATCH AND MAKE GOOD ALL EXISTING CONSTRUCTION AFFECTED BY THE REMOVAL OF ALL ITEMS FORMING THE PART OF THE RENOVATION WORK.
- 7. WHERE NEW FLOORING AND BASES TO BE INSTALLED IN EXISTING AREAS REFER TO COLOR AND FINISH SCHEDULE FOR THE NEW FLOORING AND FINISHES TO BE INSTALLED IN ACCORDANCE TO MANUFACTURER'S RECOMMENDATIONS FOR INSTALLATION OF NEW FLOOR.
- 8. WHERE PAINTING OF EXISTING WALLS IS INDICATED ON THE ROOM SCHEDULE, THESE WALLS MUST BE CLEANED OF ANY EXISTING WALL COVERING, PATCHED & PREPARED TO ACCEPT NEW MATERIAL, UNLESS OTHERWISE NOTED.



No.	REVISION/DESCRIPTION	BY	DATE
1	USER APPROVAL		2012.04.05
2	DESIGNED		
3	CHECKED		
4	APPROVED		

THE CITY OF WINNIPEG
PLANNING, PROPERTY, AND
DEVELOPMENT DEPARTMENT
Winnipeg
MUNICIPAL ACCOMMODATIONS DIVISION
3-65 GARRY STREET, R3C 4K4

PROJECT
1120 WAVERLY STREET
SOLID WASTE/IST RELOCATION
1120 WAVERLY STREET
SHEET TITLE

OVERALL FURNITURE PLAN

SCALE: 1/8"=1'-0"
PROJECT No: 2012-035
SHEET No: A1-R1

DRAWING SHEET SIZE: A1 (841mm x 594mm) PLOT 1:1