

- NOTES:**
1. ALL 120V AND 208V LOADS ARE FED FROM LP-C11.
 2. EMERGENCY LIGHTING EM-X-1, -2 ETC ARE FED FROM BATTERY PACK EM-X.

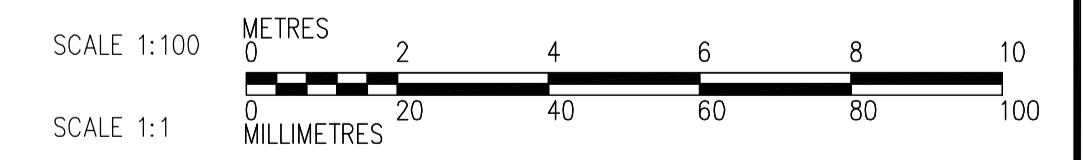
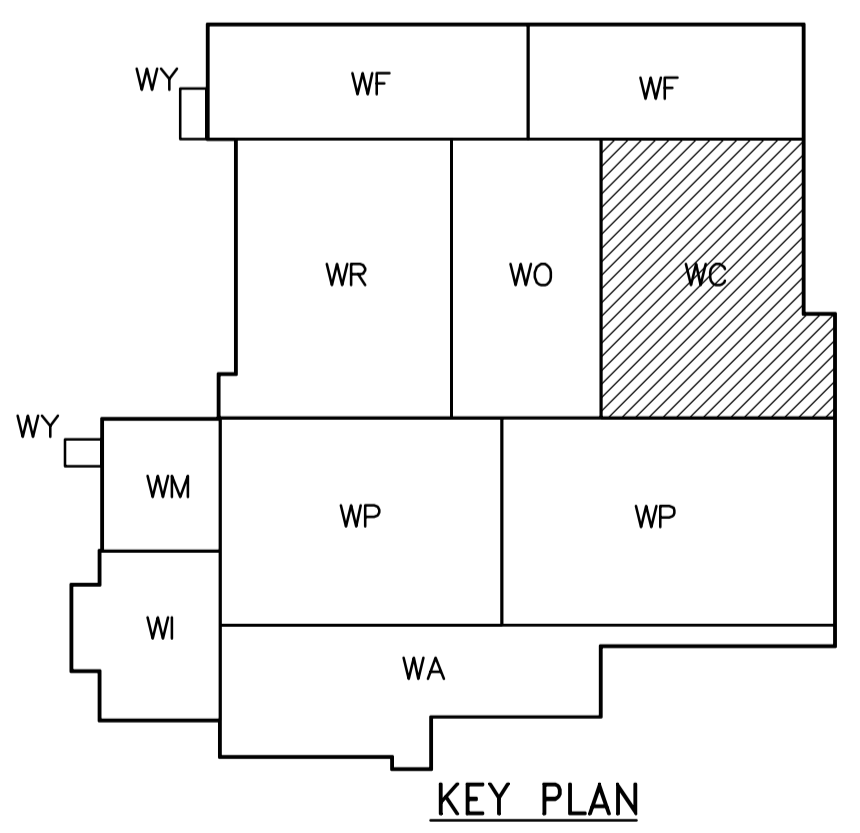

FIRST FLOOR POWER AND LIGHTING PLAN
1:100

APECA
Certificate of Authorization
CH2M HILL Canada Ltd.
No. 1441 Expiry: April 30, 2007

NO.	REVISIONS	DATE	BY
02	742-2005 ADDENDUM 5	06/05/19	LL
01	742-2005 ADDENDUM 3	06/05/05	LL
00	ISSUED FOR TENDER	06/03/29	LL

CH2MHILL Frederickson Cooper ARCHITECTS		EarthTech A Tyco International Ltd. Company	
DESIGNED BY	KJ	CHECKED BY	ND
DRAWN BY	JT	APPROVED BY	AHL
SCALE:	1:100	RELEASED FOR CONSTRUCTION BY:	R. SOROKOWSKI
DATE	2005/07/08	DATE	2006/03/29

ENGINEER'S SEAL
ORIGINAL
SIGNED BY
L.D. LLEWELLYN
2006/03/29
CONSULTANT DRAWING NO.
WC-E0113

THE CITY OF WINNIPEG
WATER AND WASTE DEPARTMENT
ENGINEERING DIVISION

WATER TREATMENT PLANT
CHEMICAL FEED SYSTEMS
MECHANICAL AND ELECTRICAL

ELECTRICAL
CHEMICAL AREA
FIRST FLOOR POWER AND LIGHTING PLAN

CITY FILE NUMBER
SHEET OF
CITY DRAWING NUMBER
1-0601C-A-E0113-001-020