

NOTES
1. SEE MCC #2A & #2B SINGLE LINE DIAGRAM AND DP-C11 & DP-C12 POWER DISTRIBUTION FOR 600V POWER DISTRIBUTION.
2. ALL 120 AND 208V LOADS ARE FED FROM LP-C11

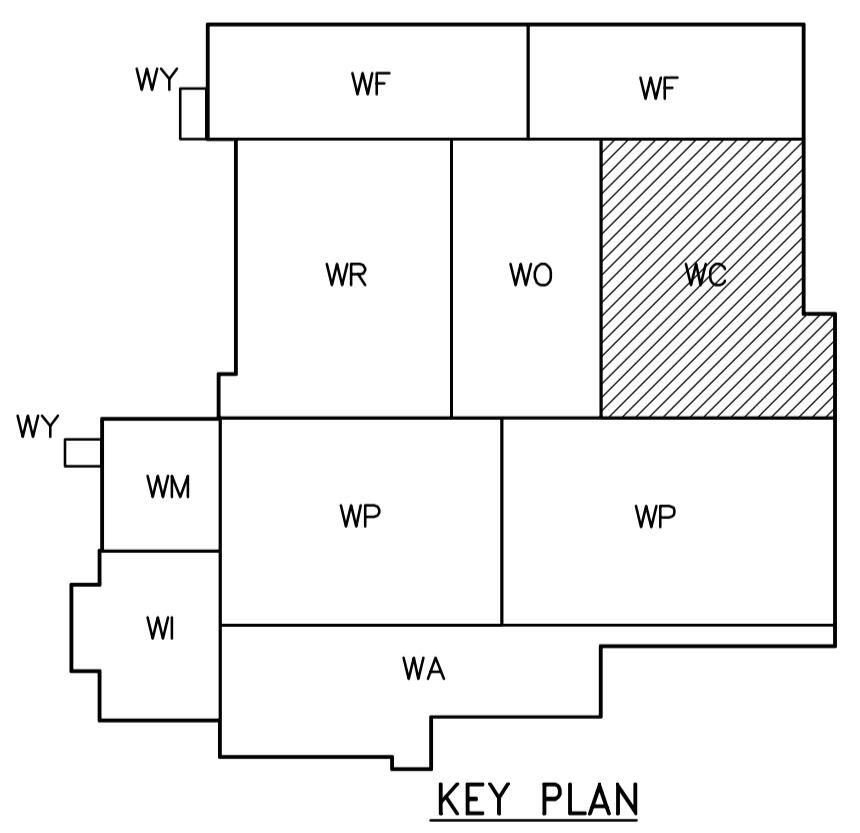

FIRST FLOOR PROCESS PLAN
1:100

APECN
Certificate of Authorization
CH2M HILL Canada Ltd.
No. 1441 Expiry: April 30, 2007

| NO. | REVISIONS | DATE | BY |
|-----|---------------------|----------|----|
| 02 | 742-2005 ADDENDUM 4 | 06/05/12 | LL |
| 01 | 742-2005 ADDENDUM 3 | 06/05/05 | LL |
| 00 | ISSUED FOR TENDER | 06/03/29 | LL |

CH2MHILL
Frederickson Cooper
ARCHITECTS

EarthTech
A Yoo International Ltd. Company

| | | | |
|-------------|------------|-------------------------------|---------------|
| DESIGNED BY | JT | CHECKED BY | ND |
| DRAWN BY | KJ | APPROVED BY | AHL |
| SCALE: | 1:100 | RELEASED FOR CONSTRUCTION BY: | R. SOROKOWSKI |
| DATE | 2005/07/08 | DATE | 2006/03/29 |

ENGINEER'S SEAL
ORIGINAL SIGNED BY
L.D. LLEWELLYN
2006/03/29
CONSULTANT DRAWING NO.
WC-E0112

THE CITY OF WINNIPEG
WATER AND WASTE DEPARTMENT
ENGINEERING DIVISION

WATER TREATMENT PLANT
CHEMICAL FEED SYSTEMS
MECHANICAL AND ELECTRICAL

ELECTRICAL
CHEMICAL AREA
FIRST FLOOR PROCESS PLAN

CITY FILE NUMBER
SHEET OF
CITY DRAWING NUMBER
1-0601C-A-E0112-001-02D