

SECOND FLOOR PLAN
1:100

NOTES:

1. BM1= HSS 406x203x13
BM2= HSS 254x152x8
BM3= W 200x36
2. COORDINATE BM1 AND BM2 LOCATIONS AND TOP OF STEEL ELEVATIONS WITH DRAWINGS WI-M0131, WI-M0201 AND WI-M0202.
3. ATTACH HANGERS FOR BM2 TO CONCRETE BM1 SHOWN ON DRAWING WI-S0131 UNDER CONTRACT B0650-2005.
4. BM3 LOCATIONS AND ELEVATIONS ARE APPROXIMATE. COORDINATE LOCATION AND TOP OF STEEL WITH PIPING SUPPORTS. COORDINATE BEAM INSTALLATION WITH STAIRWAY INSTALLATION (SEPARATE CONTRACT), AS DIRECTED BY THE CONTRACT ADMINISTRATOR.

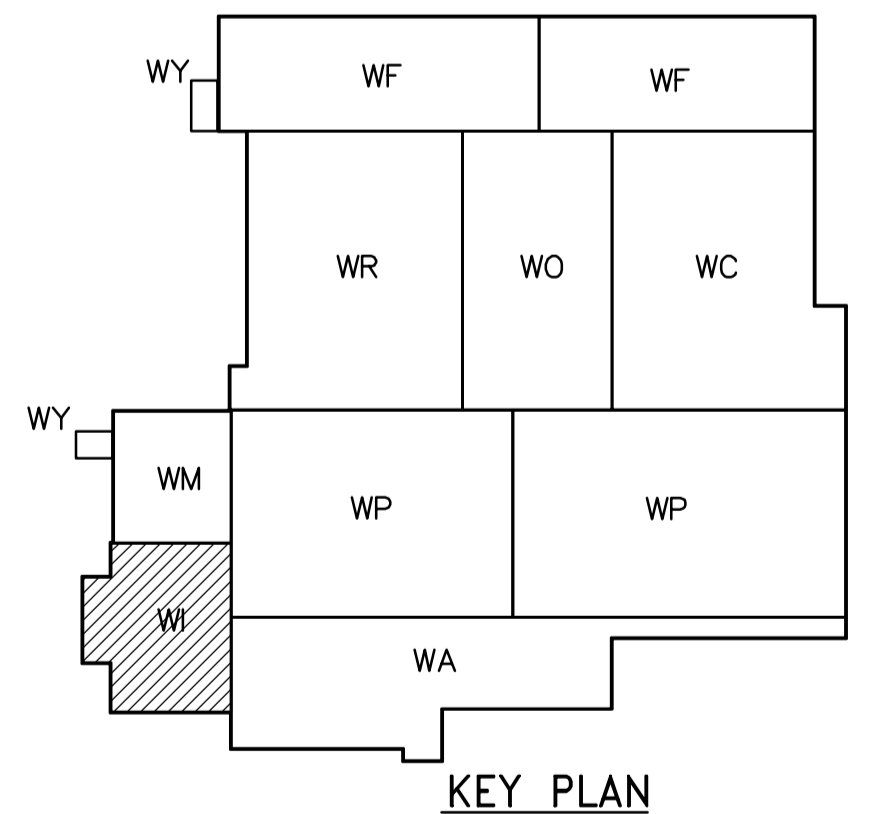

KEY PLAN

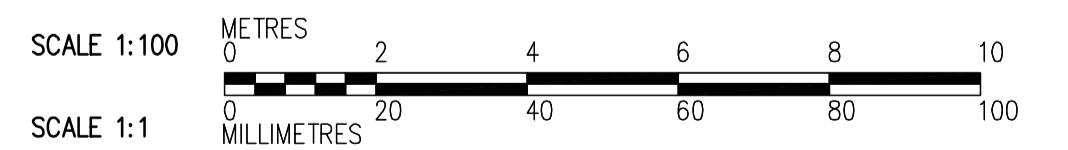

 APEGN Certificate of Authorization CH2M HILL Canada Ltd. No. 1441 Expiry: April 30, 2007	B.M. ELEV.	 Frederickson Cooper ARCHITECTS	 A Terra International Ltd. Company	ENGINEER'S SEAL	 THE CITY OF WINNIPEG WATER AND WASTE DEPARTMENT ENGINEERING DIVISION WATER TREATMENT PLANT INLET WORKS AND RAW WATER PUMPING MECHANICAL AND ELECTRICAL STRUCTURAL RAW WATER PUMP STATION AREA SECOND FLOOR PLAN	CITY FILE NUMBER
		DESIGNED BY EL	CHECKED BY AP	ORIGINAL SIGNED BY D. KRUGER		SHEET OF
	01 742-2005 ADDENDUM 3 06/05/05 EL 00 742-2005 ADDENDUM 1 06/04/21 EL NO. REVISIONS DATE BY	DRAWN BY RL/CA SCALE: 1:100	APPROVED BY AHL RELEASED FOR CONSTRUCTION BY: R. SOROKOWSKI	2006/04/21		CITY DRAWING NUMBER
	DATE 2005/12/13	DATE 2006/04/21	CONSULTANT DRAWING NO. WI-S7121	1-06011-A-S7121-001-010		