

NOTES

- SEE MCC #2A & #2B SINGLE LINE DIAGRAM AND DP-C11 & DP-C12 POWER DISTRIBUTION FOR 600V POWER DISTRIBUTION.
- ALL 120 AND 208V LOADS ARE FED FROM LP-C11

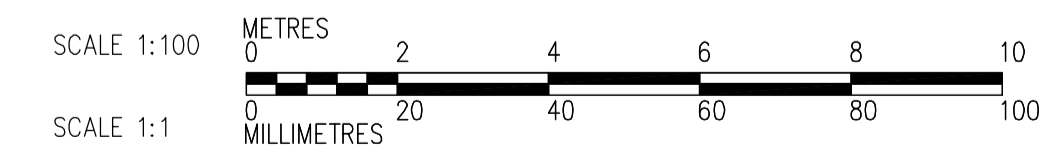
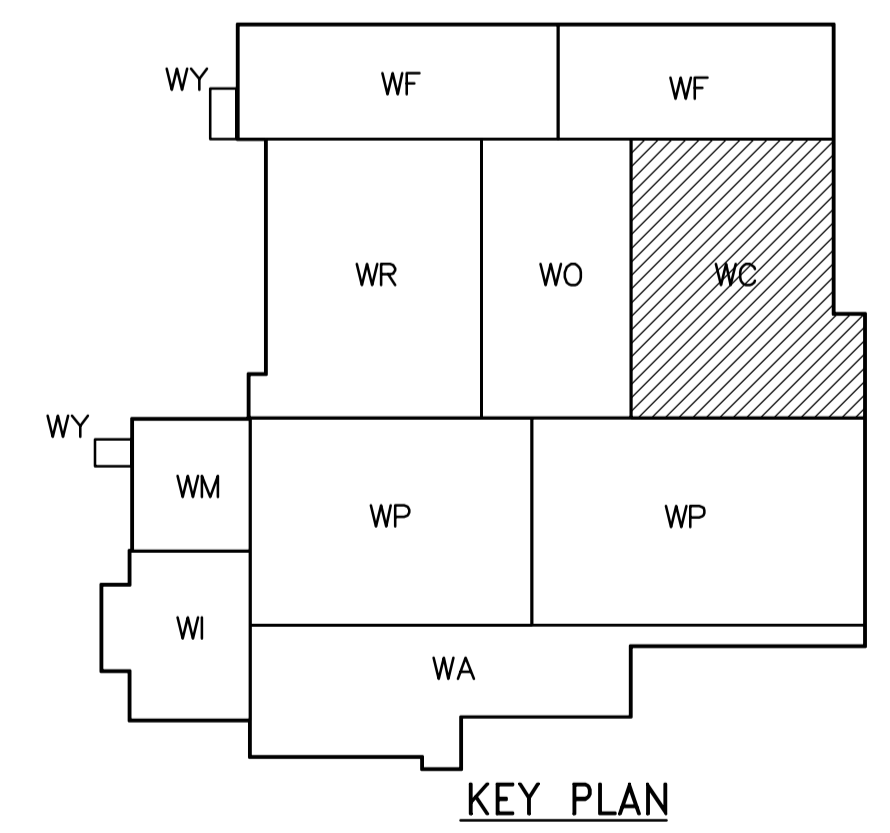

FIRST FLOOR PROCESS PLAN
1:100

<p>APEGN Certificate of Authorization CH2M HILL Canada Ltd. No. 1441 Expiry: April 30, 2007</p>	B.M. ELEV.	<p>Frederickson Cooper ARCHITECTS</p>	<p>A Terra International Ltd. Company</p>	ENGINEER'S SEAL	<p>THE CITY OF WINNIPEG WATER AND WASTE DEPARTMENT ENGINEERING DIVISION</p>		
	DESIGNED BY JT			CHECKED BY ND		ORIGINAL SIGNED BY L.D. LLEWELLYN	
	DRAWN BY KJ	APPROVED BY AHL	2006/03/29				
	SCALE: 1:100	RELEASED FOR CONSTRUCTION BY: R. SOROKOWSKI	CONSULTANT DRAWING NO. WC-E0112				
NO. REVISIONS	DATE BY	DATE	DATE	2005/07/08	2006/03/29	<p>WATER TREATMENT PLANT CHEMICAL FEED SYSTEMS MECHANICAL AND ELECTRICAL</p> <p>ELECTRICAL CHEMICAL AREA FIRST FLOOR PROCESS PLAN</p>	<p>CITY FILE NUMBER</p> <p>SHEET OF</p> <p>CITY DRAWING NUMBER 1-0601C-A-E0112-001-01D</p>