

NOTES:
 1. SEE MCC #1A, #1B SINGLE LINE DIAGRAM AND DP-A11 & DP-A12 POWER DISTRIBUTION FOR 600V POWER REQUIREMENT.
 2. ALL 120V AND 208V LOADS ARE FED FROM LP-A11.

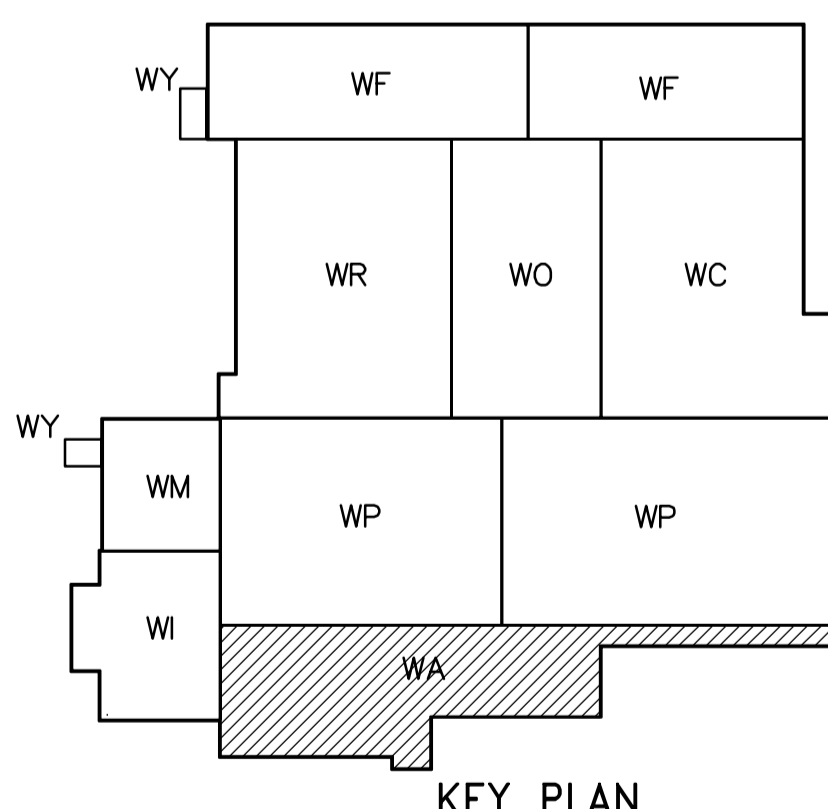

LOWER LEVEL PROCESS PLAN
1:100

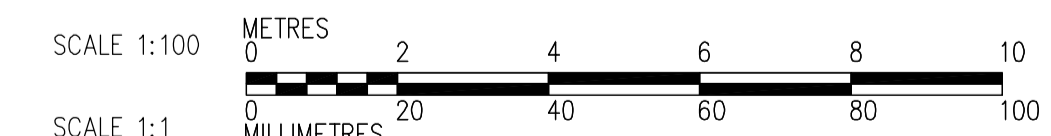

 Certificate of Authorization CH2M HILL Canada Ltd. No. 1441 Expiry: April 30, 2007	B.M. ELEV. <table border="1"> <tr><td> </td><td> </td><td> </td></tr> <tr><td> </td><td> </td><td> </td></tr> <tr><td> </td><td> </td><td> </td></tr> <tr><td> </td><td> </td><td> </td></tr> </table>													 Frederickson Cooper ARCHITECTS	 A You International Ltd. Company	ENGINEER'S SEAL	 THE CITY OF WINNIPEG WATER AND WASTE DEPARTMENT ENGINEERING DIVISION WATER TREATMENT PLANT ADMINISTRATION AREA MECHANICAL AND ELECTRICAL ELECTRICAL ADMINISTRATION AREA LOWER LEVEL PROCESS PLAN	CITY FILE NUMBER
DESIGNED BY JT	CHECKED BY ND	ORIGINAL SIGNED BY L.D. LLEWELLYN	SHEET OF															
DRAWN BY KJ	APPROVED BY AHL	2006/03/29	CITY DRAWING NUMBER															
SCALE: 1:100	RELEASED FOR CONSTRUCTION BY: R. SOROKOWSKI	CONSULTANT DRAWING NO. WA-E0102	1-0601A-A-E0102-001-01D															
01 742-2005 ADDENDUM 3 06/05/05 LL	DATE 2005/08/18	DATE 2006/03/29																
00 ISSUED FOR TENDER 06/03/29 LL																		
NO. REVISIONS																		