

- NOTES**
- SEE MCC #2A & #2B SINGLE LINE DIAGRAM AND DP-C11 & DP-C12 POWER DISTRIBUTION FOR 600V POWER DISTRIBUTION.
  - ALL 120 AND 208V LOADS ARE FED FROM LP-C11

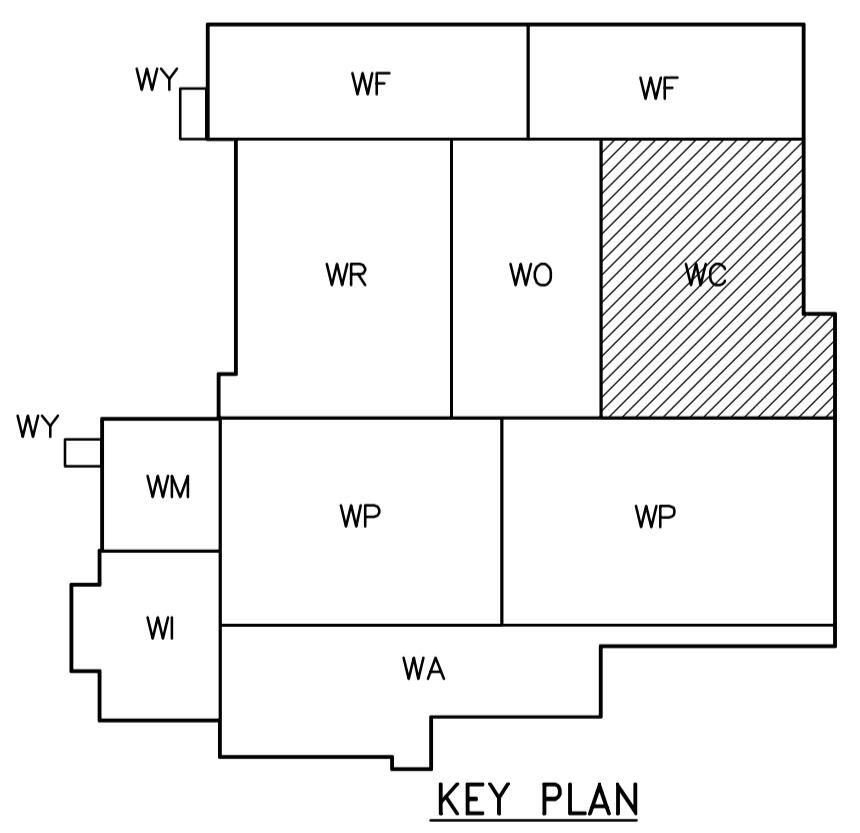

**FIRST FLOOR PROCESS PLAN**  
1:100

**APEG**  
Certificate of Authorization  
CH2M HILL Canada Ltd.  
No. 1441 Expiry: April 30, 2007

NO.	REVISIONS	DATE	BY
03	742-2005 ADDENDUM 12	06/06/23	PF
02	742-2005 ADDENDUM 4	06/05/12	LL
01	742-2005 ADDENDUM 3	06/05/05	LL
00	ISSUED FOR TENDER	06/03/29	LL

<b>CH2MHILL</b> Frederickson Cooper ARCHITECTS		<b>EarthTech</b> A Tyco International Ltd. Company	
DESIGNED BY	JT	CHECKED BY	ND
DRAWN BY	KJ	APPROVED BY	AHL
SCALE:	1:100	RELEASED FOR CONSTRUCTION BY:	R. SOROKOWSKI
DATE	2005/07/08	DATE	2006/03/29

ENGINEER'S SEAL  
ORIGINAL SIGNED BY  
L.D. LLEWELLYN  
2006/03/29  
CONSULTANT DRAWING NO.  
WC-E0112

**THE CITY OF WINNIPEG**  
WATER AND WASTE DEPARTMENT  
ENGINEERING DIVISION

WATER TREATMENT PLANT  
CHEMICAL FEED SYSTEMS  
MECHANICAL AND ELECTRICAL

ELECTRICAL  
CHEMICAL AREA  
FIRST FLOOR PROCESS PLAN

CITY FILE NUMBER  
SHEET OF  
CITY DRAWING NUMBER  
1-0601C-A-E0112-001-03D