

- NOTES:**
1. GALVANIZE STEEL FRAMING AFTER FABRICATION.
  2. DESIGN LIVE LOAD ON PLATFORMS IS 14.4kPa UNLESS NOTED OTHERWISE.
  3. PROVIDE PROTECTION BETWEEN DISSIMILAR METALS AS PER SPECIFICATIONS.
  4. SPLICE RUNWAY BEAMS AT SUPPORT LOCATIONS ONLY, SEE 3 WC-S7401.
  5. SITE VERIFY ALL DIMENSIONS PRIOR TO FABRICATION.

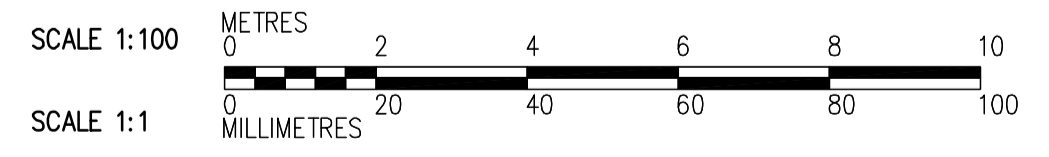
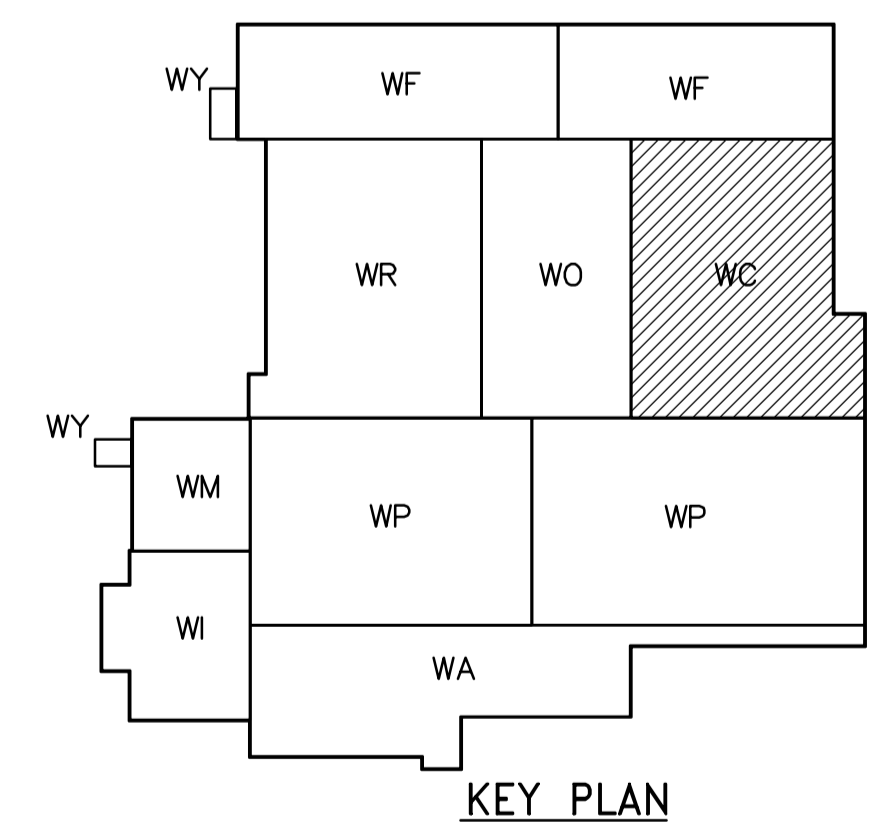

UPPER PLAN  
1:100

<p><b>APEGN</b> Certificate of Authorization CH2M HILL Canada Ltd. No. 1441 Expiry: April 30, 2006</p>	<p>Frederickson Cooper ARCHITECTS</p>		<p>EarthTech A Tyco International Ltd. Company</p>		ENGINEER'S SEAL  ORIGINAL SIGNED BY D. KRUGER  2006/04/21	<p><b>THE CITY OF WINNIPEG</b> WATER AND WASTE DEPARTMENT ENGINEERING DIVISION</p>	WATER TREATMENT PLANT CHEMICAL FEED SYSTEMS MECHANICAL AND ELECTRICAL	CITY FILE NUMBER SHEET OF
	DESIGNED BY EL CHECKED BY AP		DRAWN BY RL APPROVED BY AHL		CONSULTANT DRAWING NO. WC-S7121		CITY DRAWING NUMBER 1-0601C-A-S7121-001-000	
	SCALE: 1:100		RELEASED FOR CONSTRUCTION BY: R. SOROKOWSKI					
	00 742-2005 ADDENDUM 1 06/04/21 EL	INO. REVISIONS DATE BY DATE 2005/12/13 DATE 2006/04/21						