

**MATERIAL LIST**

ITEM	MANUFACTURER	MATERIAL SPECIFICATION	SPECIAL FEATURES
WATERMAIN 150, 200mm PIPE	IPEX INC.	AVVA C900 CSA B137.3	"BLUE WHITE" PVC PIPE CLASS 150
150mm - 45 BENDS	IPEX INC.	AVVA C907 CSA B137.2	"BLUE WHITE" CLASS 150 PVC FITTINGS
PVC FITTINGS	TERMINAL CITY	AVVA C110	TYTON JOINT (FOR C900 PVC)
200x150mm TEE	AVVA C509	AVVA C509	LOW RESILIENT SEAT G.V. CV TO OPEN (RED TOP) CONFORMS TO SD-100A
GATE VALVES	V.D. VALVE BOXES LTD.	VF-6112	
VALVE BOX UPPER	IPEX INC.	D.I. UPPER (V012) INCL. HINGE CYR(V029)	
VALVE BOX BOTTOM	IPEX INC.	AVVA C90C	
COUPLINGS	ROBAR INDUSTRIES LTD.	ROBAR STYLE "1597"	PVC DR 18 CONFORMS TO SD-100A EPoxy COATED 3.1. SLEEVE & END RINGS, STEEL NUTS & BOLTS WITH ZINC END CAPS.
ANODES	THE CANADA METAL CO. LTD.	TYPE II (ASTM B418-88)	16.9 kg GALVANIC ZINC ANODE
ANODE BOLT CAPS	THE FORD METER BOX CO. INC.	TYPE II (ASTM B418-88)	ZINC ANODE BOLT CAP FOR EPoxy COATED COUPLINGS
SEWER PIPE 250mm CB LEAD	IPEX INC.	ASTM D3034 CSA B188.2	RING-TITE PVC SDR 35
1350mm COMBINED SEWER PIPE	SUPERCRETE INC.	ASTM C76 (CLASSES AS NOTED)	MONOLITHIC NON-REINFORCED & REINFORCED CONCRETE
600, 750mm COMBINED SEWER PIPE	SUPERCRETE INC.	ASTM C77 (CLASSES AS NOTED)	REINFORCED CONCRETE
MANHOLES, HANDLES & CATCHBASIN ADAPTERS	SUPERCRETE INC.	ASTM C-478 ASTM C-478	PRECAST CONCRETE 750mm I.S.X. (50mm TO 125mm) CONCRETE ADJUSTING RINGS

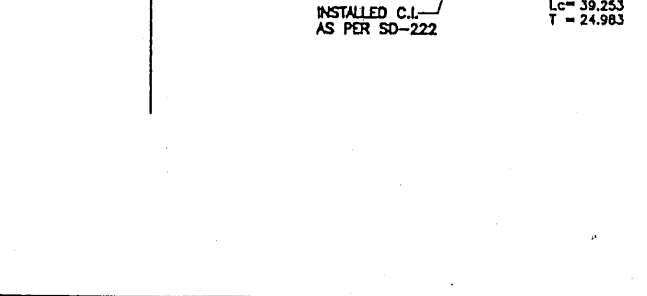
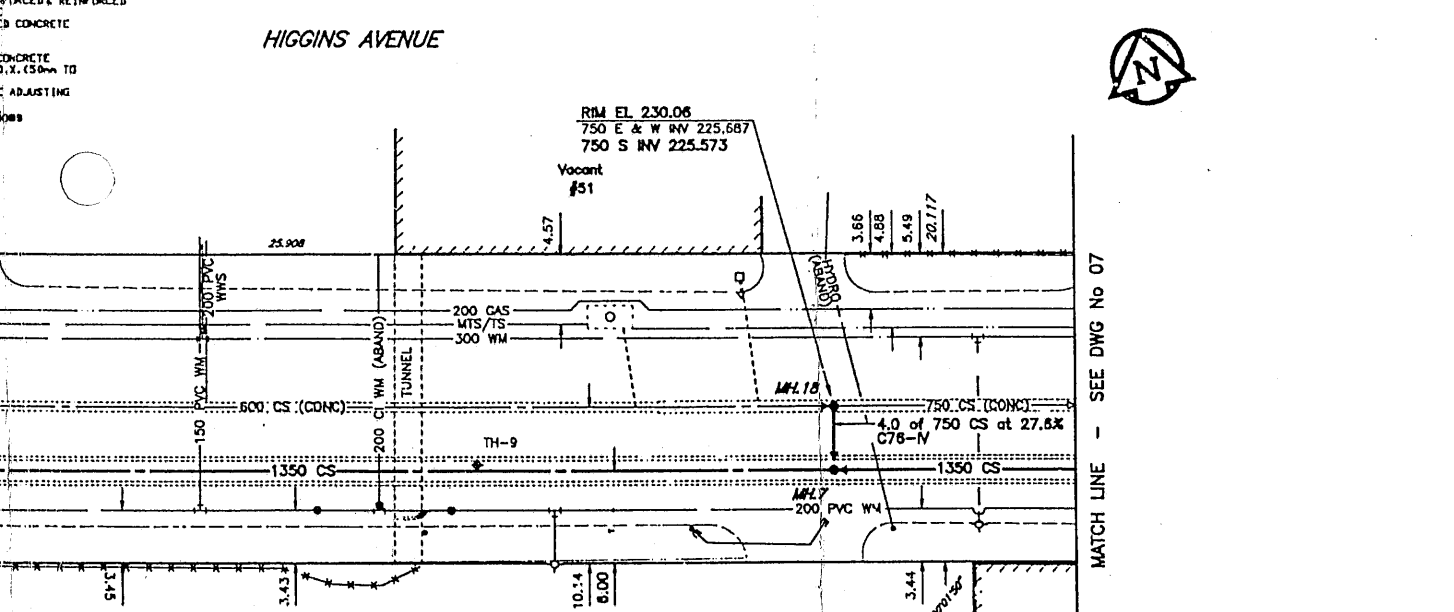
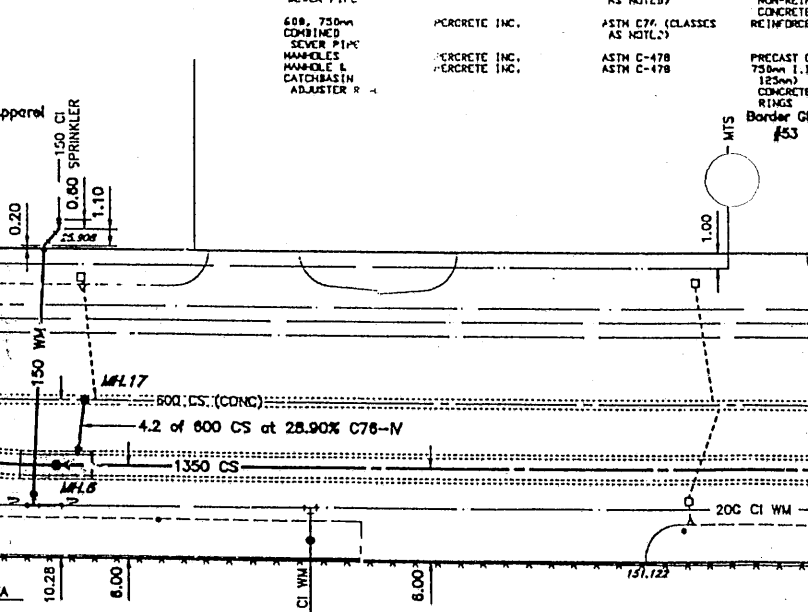
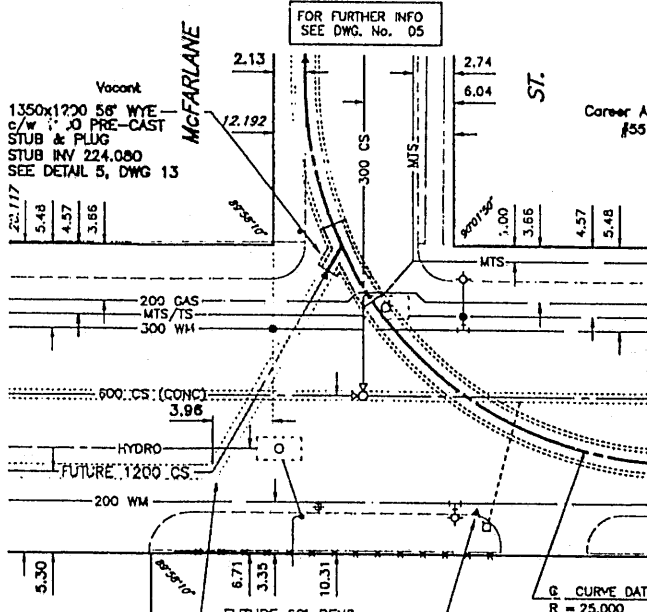

**MATERIAL LIST**

ITEM	MANUFACTURER	MATERIAL SPECIFICATION	SPECIAL FEATURES
MANHOLE/CATCHBASIN JOINT GASKETS	SUPERCRETE INC.	RAMMECK	JOINT SEALANT
MANHOLE FRAMES & COVERS	TITAN FOUNDRY	ASTM A-48 CLASS 30B	TITAN, 1M FRAME AND SOLID COVER
MANHOLE FRAME LIFTER RINGS	TITAN FOUNDRY LTD.	ASTM A48, CLASS 30B	"TITANER" 30mm, 31mm, 6mm AND 75mm SIZES
MANHOLE RINGS	SUPERCRETE INC.		SUPERCRETE MANHOLE STOPS CONFORMS TO SD-114
BLVD INLET BOX	V.D. VALVE BOXES LTD.	BLVD INLET BOX	
SOLID COVER	SUPERCRETE INC.		
CONCRETE REINFORCING STEEL	SUPERCRETE INC.		
ASPHALT	CONCRETE CONSTRUCTION LTD.		
CONTRACTOR	ROBLAND CONSTRUCTION LTD.		
CONSTRUCTION PERIOD			SEPT. 1993 - JULY, 1994
TITLE BOX NO.			94984

150 mm WM	150 mm WM	HYDRO	150 mm WM	WATERMAIN
+	+	MTS	+	+
+	+	GAS	+	+
+	+	CONCRETE	+	+
+	+	ASPHALT	+	+
+	+	CURB STOP	+	+
+	+	REDUCER	+	+
+	+	COUPLING	+	+
+	+	ANODE	+	+

300 mm WM	300 mm WM	HYDRO	300 mm WM	WATERMAIN
+	+	MTS	+	+
+	+	GAS	+	+
+	+	CONCRETE	+	+
+	+	ASPHALT	+	+
+	+	CURB STOP	+	+
+	+	REDUCER	+	+
+	+	COUPLING	+	+
+	+	ANODE	+	+

300 mm WM	300 mm WM	HYDRO	300 mm WM	WATERMAIN
+	+	MTS	+	+
+	+	GAS	+	+
+	+	CONCRETE	+	+
+	+	ASPHALT	+	+
+	+	CURB STOP	+	+
+	+	REDUCER	+	+
+	+	COUPLING	+	+
+	+	ANODE	+	+

**LOCATION APPROVED UNDERGROUND STRUCTURES**

DATE: 17-04-95

NOTE: LOCATION OF UNDERGROUND STRUCTURES AS SHOWN ARE BASED ON THE BEST INFORMATION AVAILABLE, BUT NO GUARANTEE IS GIVEN THAT ALL EXISTING UTILITIES ARE SHOWN OR THAT THE GIVEN LOCATIONS ARE EXACT. CONFIRMATION OF EXISTENCE AND EXACT LOCATION OF ALL SERVICES MUST BE OBTAINED FROM THE INDIVIDUAL UTILITIES BEFORE PROCEEDING WITH CONSTRUCTION.

**WATER SERVICE INFORMATION**

ADDRESS	DIST TO PROPERTY	SIZE (mm) & TYPE	SHORT & LONG MEASUREMENT	CORP. LOCATION	CATHODIC PROTECTION	REMARKS
35 HIGGINS AVE (SPRINKLER)	16.17	150 PVC	15.10 EEL. OF McFARLANE ST	15.10 EEL. OF McFARLANE OPP. S.C.	N/A	REFER SERVICE TO EX MAIN CONN. TO EX SERVICE 16.8 EEL. McFARLANE 1.99 MM. HIGGINS

**METRIC**  
WHOLE NUMBERS INDICATE MILLIMETERS  
DECIMALIZED NUMBERS INDICATE METERS

**RECORD DRAWING** P.D. No. 95-120

UMA Engineering Ltd.  
1479 Buff. to Place, Winnipeg, Manitoba, Canada R2T 1L7

DESIGNED BY: MCM/CCM  
CHECKED BY: B. H. H. H.  
DRAWN BY: MCM/MAG  
APPROVED BY: K. H. H. H.  
HOR. SCALE: 1:200  
VERTICAL: 1:50  
DATE: 14/13/95

PROVINCE OF MANITOBA  
13 MAR 95  
G.C. MACEY  
REGISTERED ENGINEER

THE CITY OF WINNIPEG  
WORKS AND OPERATIONS DIVISION  
WATER AND WASTE DEPARTMENT

INTEGRATION OF THE BOYLE & SYNDICATE COMBINED SEWER DISTRICTS

HIGGINS AVENUE  
McFARLANE ST.  
TO 83m W OF MORDAUNT ST.

SHEET 6 OF 20  
CITY DRAWING NUMBER  
4202  
REV A