

SEWER SERVICE INFORMATION (ID #20024) \*

DISTANCE FROM 2ND MH N. OF LYNDALE DR. (MH ID #20023)	
818 N	SERVICE CONNECTION E
24.5 N	SERVICE CONNECTION E
39.3 N	SERVICE CONNECTION E
94.1 N	SERVICE CONNECTION E
69.7 N	SERVICE CONNECTION E
95.2 N	SERVICE CONNECTION W
96.2 N	SERVICE CONNECTION E

\* - INFORMATION FROM SEWER VIDEO INSPECTION

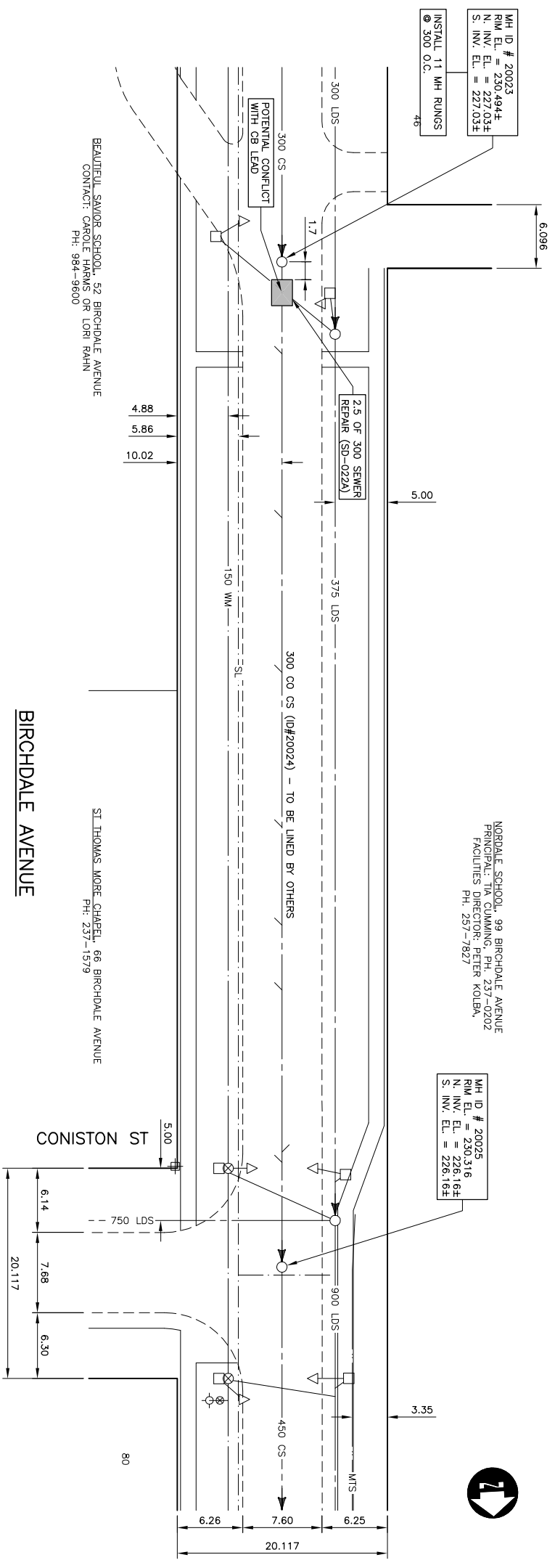

150 mm W.M.	WATERMAIN	150 mm W.M.	WATERMAIN	150 mm W.M.	WATERMAIN
300 mm L.O.S.	LAND DRAINAGE SEWER	300 mm L.O.S.	LAND DRAINAGE SEWER	300 mm L.O.S.	LAND DRAINAGE SEWER
250 mm W.M.S.	WASTE WATER SEWER	250 mm W.M.S.	WASTE WATER SEWER	250 mm W.M.S.	WASTE WATER SEWER
○	MANHOLE	○	MANHOLE	○	MANHOLE
□	CATCH BASIN	□	CATCH BASIN	□	CATCH BASIN
▽	CURB INLET	▽	CURB INLET	▽	CURB INLET
+	JUNCTIONS	+	JUNCTIONS	+	JUNCTIONS
—	CULVERT	—	CULVERT	—	CULVERT
—	GAS	—	GAS	—	GAS

150 mm W.M.	WATERMAIN	150 mm W.M.	WATERMAIN
300 mm L.O.S.	LAND DRAINAGE SEWER	300 mm L.O.S.	LAND DRAINAGE SEWER
250 mm W.M.S.	WASTE WATER SEWER	250 mm W.M.S.	WASTE WATER SEWER
○	MANHOLE	○	MANHOLE
□	CATCH BASIN	□	CATCH BASIN
▽	CURB INLET	▽	CURB INLET
+	JUNCTIONS	+	JUNCTIONS
—	CULVERT	—	CULVERT
—	GAS	—	GAS

NO.	REVISIONS	DATE	BY
1	ISSUED FOR TENDER	07/23/04 P.M.K.	
2	SUBMITTED TO WAW FOR REVIEW	04/20/04 P.M.K.	
3	ADDITIONAL 1	04/20/04 P.M.K.	

**THE CITY OF WINNIPEG**  
**WATER AND WASTE DEPARTMENT**

2004 COMBINED SEWER RENEWALS  
 AND REPAIRS - CONTRACT 10  
 BIRCHDALE AVENUE  
 2ND MH NORTH OF LYNDALE DR  
 TO MH AT CONISTON ST (CL)

ENGINEER'S SEAL  
 ORIGINAL BY P.M.K.  
 P.M.K.  
 07/22/04

CONSULTANT DRAWING NO. 043032-09

CITY DRAWING NUMBER 05501  
 SHEET 9 R1 OF 17  
 BID OPPORTUNITY NO. 305-2004

**WARNING**

IF POWER EQUIPMENT OR EXPLOSIVES ARE TO BE USED FOR EXCAVATION ON THIS PROJECT THE CONTRACTOR MUST:

1. NOTIFY THE GAS COMPANY OF THE PROPOSED LOCATION OF EXCAVATION.
2. TAKE PRECAUTION TO AVOID DAMAGE TO GAS COMPANY INSTALLATIONS.

SEE PROVINCIAL REGULATION 210/72 FOR DETAILS

**METRIC**

WHOLE NUMBERS INDICATE MILLIMETRES  
 DECIMALIZED NUMBERS INDICATE METRES