



# THE CITY OF WINNIPEG

## WATER AND WASTE DEPARTMENT

### 2004 COMBINED SEWER RENEWALS BY CIPP LINING

#### CONTRACT NO. 9

#### BID OPPORTUNITY NO. 238-2004

#### DRAWING LIST

SHEET No.	TITLE	CITY OF WINNIPEG DWG. NO.	CONSULTANT DWG. NO.
-	COVER SHEET	-	-
1 OF 15	BIRCHDALE AVENUE - 1ST MH NORTH OF CONISTON STREET TO MH AT HIGHFIELD STREET (CL)	05399	043031-01
2 OF 15	AIKINS STREET - MH AT BANNERMAN AVENUE TO MH AT CATHEDRAL AVENUE	05400	043031-02
3 OF 15	WALL STREET - 3RD MH SOUTH OF NOTRE DAME AVENUE TO 2ND MH SOUTH OF NOTRE DAME AVENUE	05401	043031-03
4 OF 15	LUXTON AVENUE (R.O.W.) - 4TH MH EAST OF MAIN STREET TO MH AT ST. CROSS STREET	05402	043031-04
5 OF 15	BIRCHDALE AVENUE - MH AT LYNDALE DRIVE TO 1ST MH NORTH OF LYNDALE DRIVE	05403	043031-05
6 OF 15	MONTAGUE AVENUE - 1ST MH WEST OF NASSAU STREET SOUTH TO MH AT CHURCHILL DRIVE	05404	043031-06
7 OF 15	BIRCHDALE AVENUE - 2ND MH NORTH OF LYNDALE DRIVE TO MH AT CONISTON STREET (CL)	05405	043031-07
8 OF 15	ST. JAMES STREET - 2ND MH NORTH OF WELLINGTON AVENUE TO 1ST MH NORTH OF WELLINGTON AVENUE	05406	043031-08
9 OF 15	LYNDALE DRIVE (CL) - MH AT LANE BETWEEN BALSAM AND BEECHWOOD TO MH AT HIGHFIELD (CL)	05407	043031-09
10 OF 15	TACHE AVENUE - MH AT KITSON STREET (SOUTH OF CL) TO MH AT HANBURY STREET	05408	043031-10
11 OF 15	MAGNUS AVENUE - MH AT McNICHOL STREET TO 1ST MH EAST OF McNICHOL STREET	05409	043031-11
12 OF 15	ARLINGTON STREET - 1ST MH NORTH OF COLLEGE AVENUE TO MH AT MOUNTAIN AVENUE (SOUTH PL)	05410	043031-12
13 OF 15	DUBUC STREET - MH AT HILL STREET TO MH AT BRAEMAR STREET (EAST OF CL)	05411	043031-13
14 OF 15	LYNDALE DRIVE - 1ST MH SOUTH OF MARION PLACE TO MH AT MARION PLACE	05412	043031-14
15 OF 15	MARION STREET - MH AT DES MEURONS STREET TO NODE AT ENFIELD CRESCENT	05413	043031-15

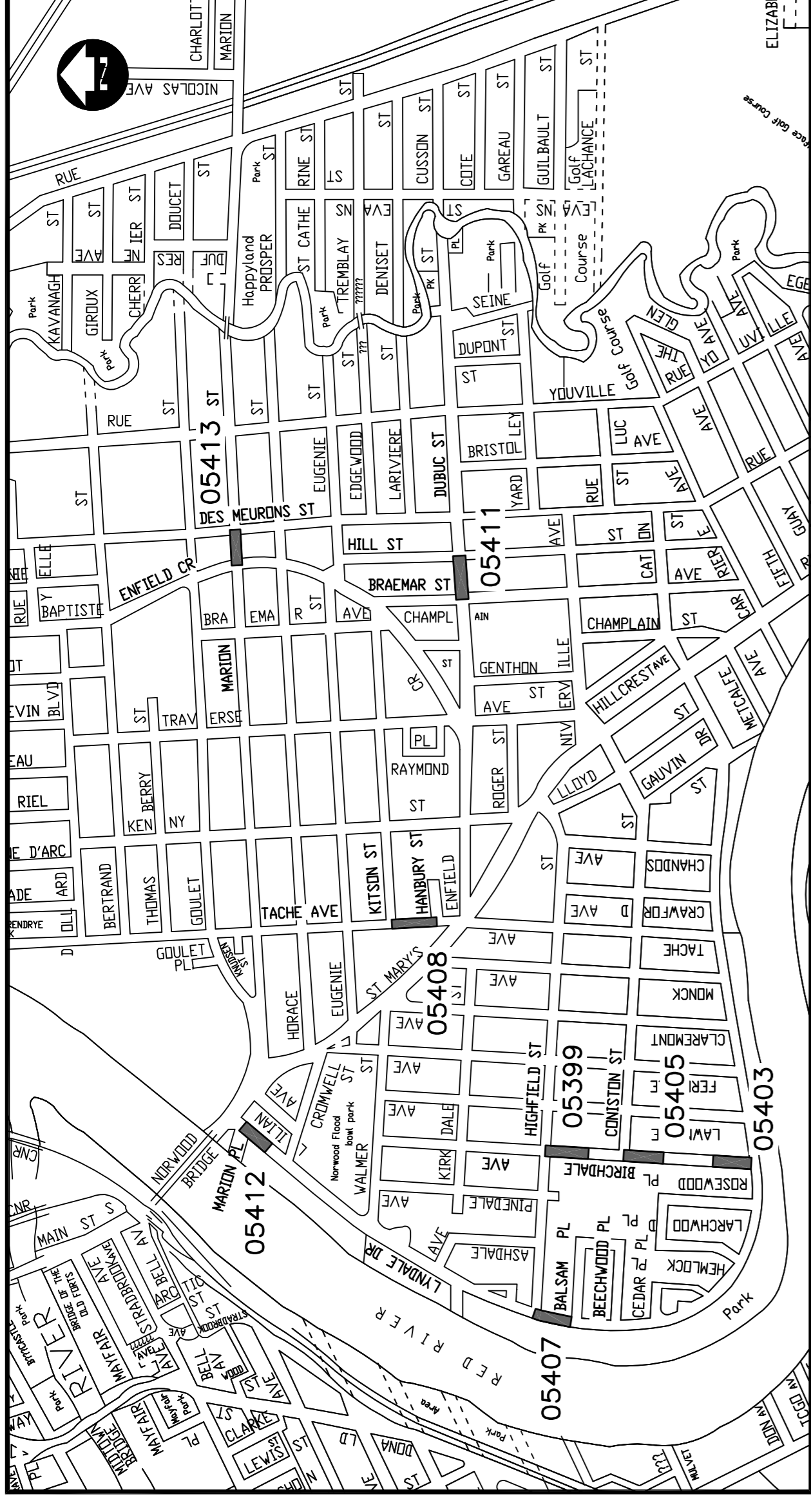

LOCATION PLAN

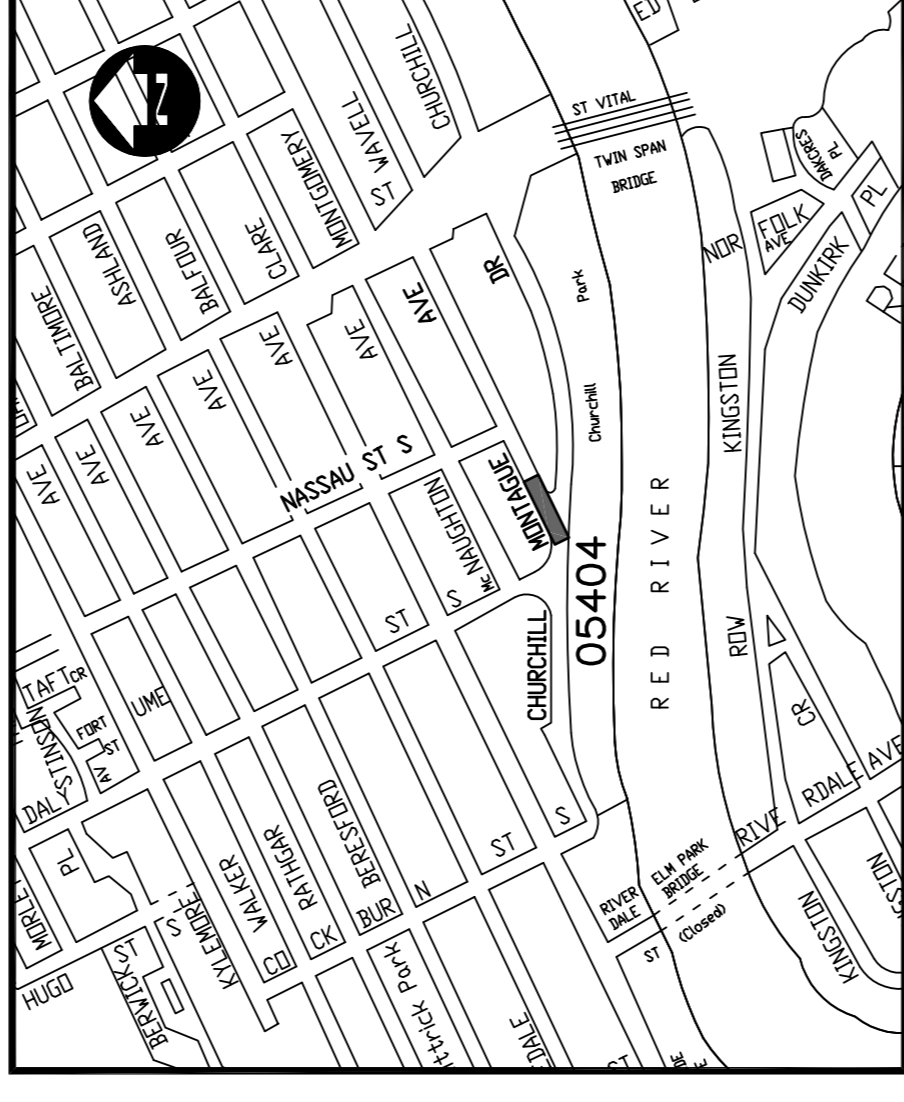

LOCATION PLAN

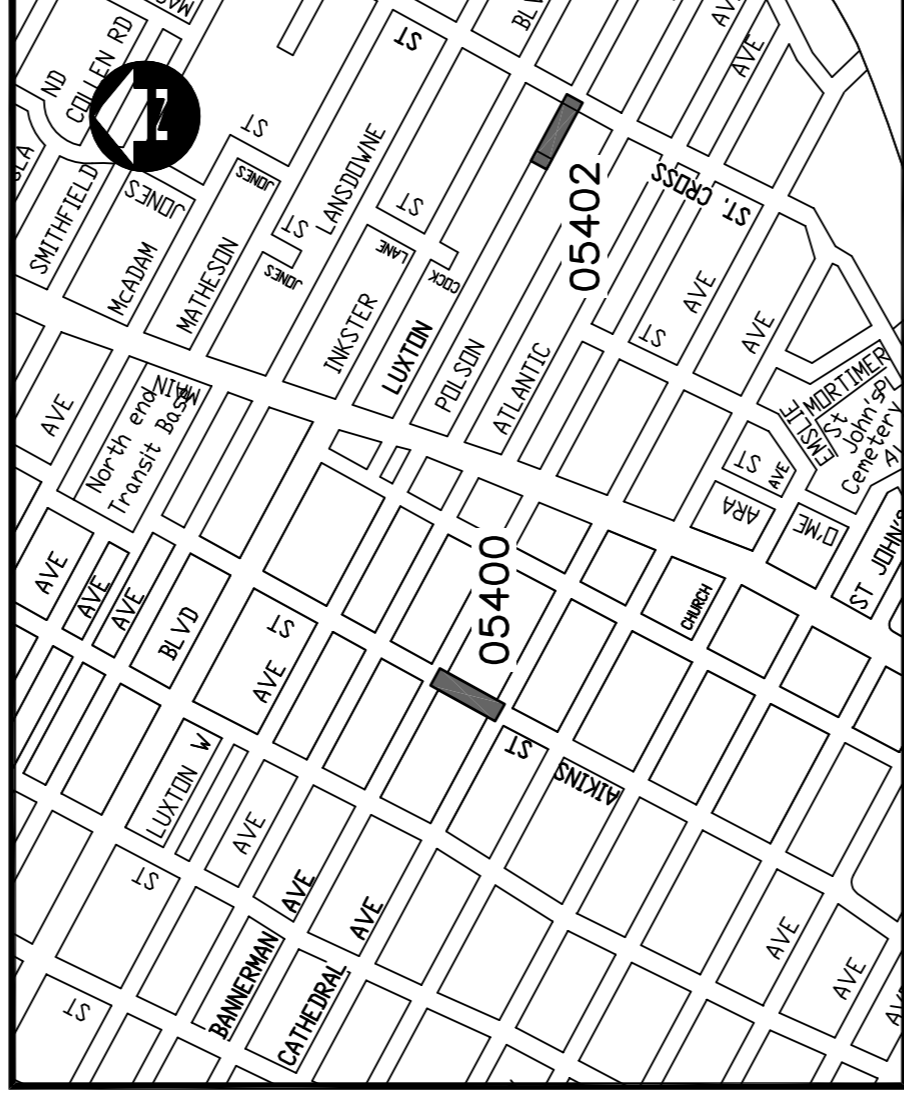

LOCATION PLAN

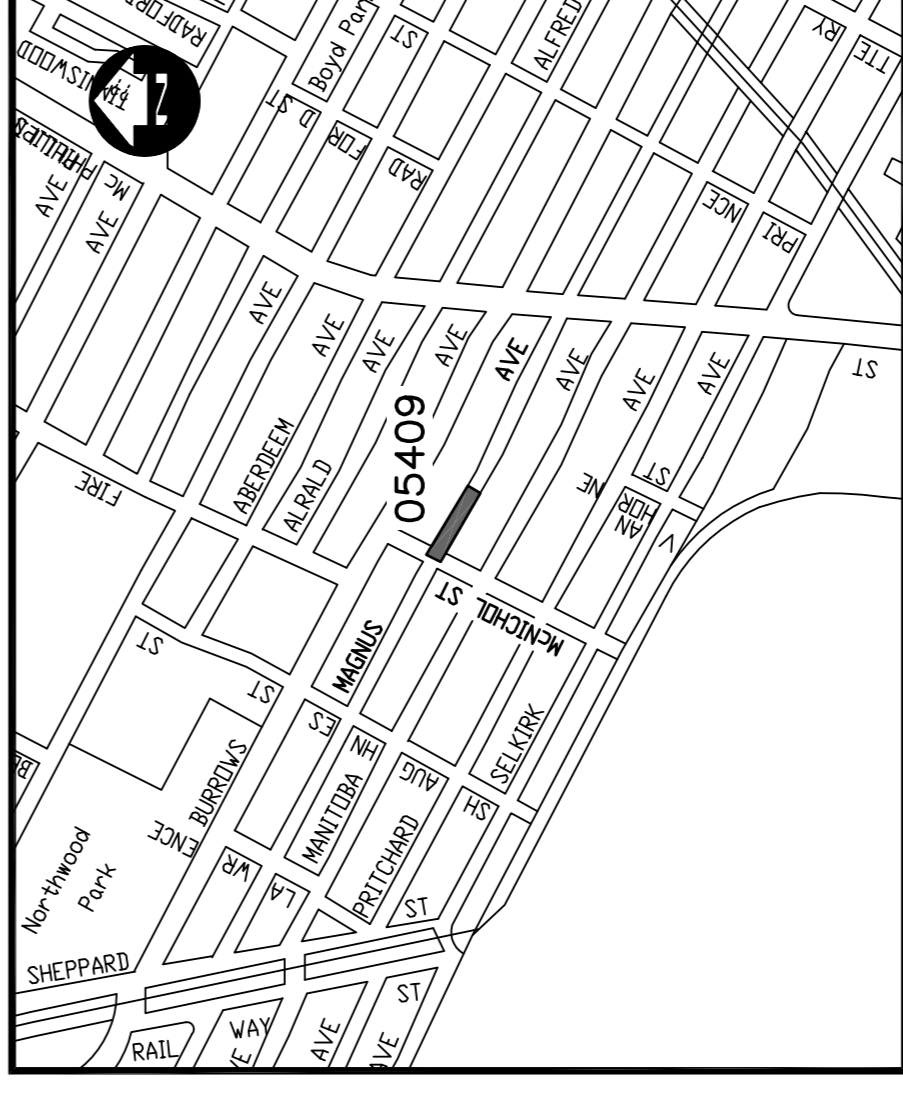

LOCATION PLAN

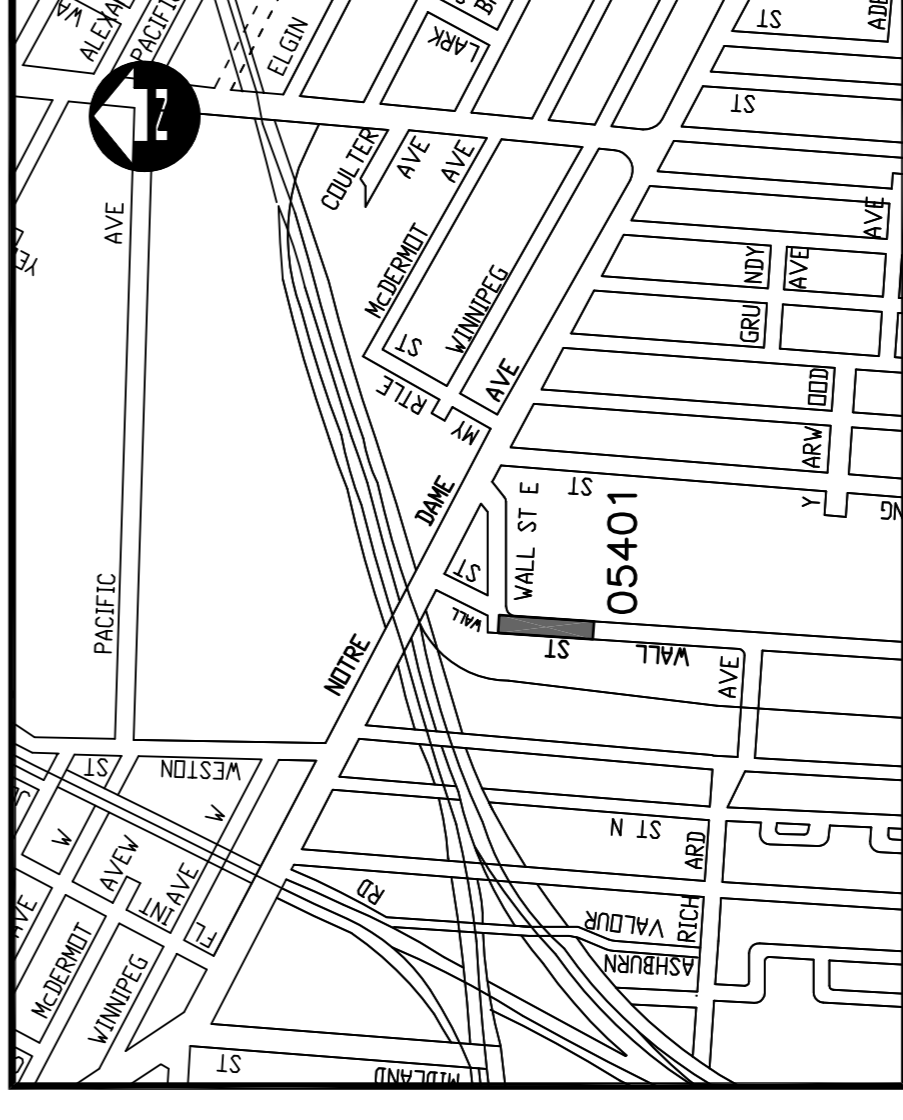

LOCATION PLAN

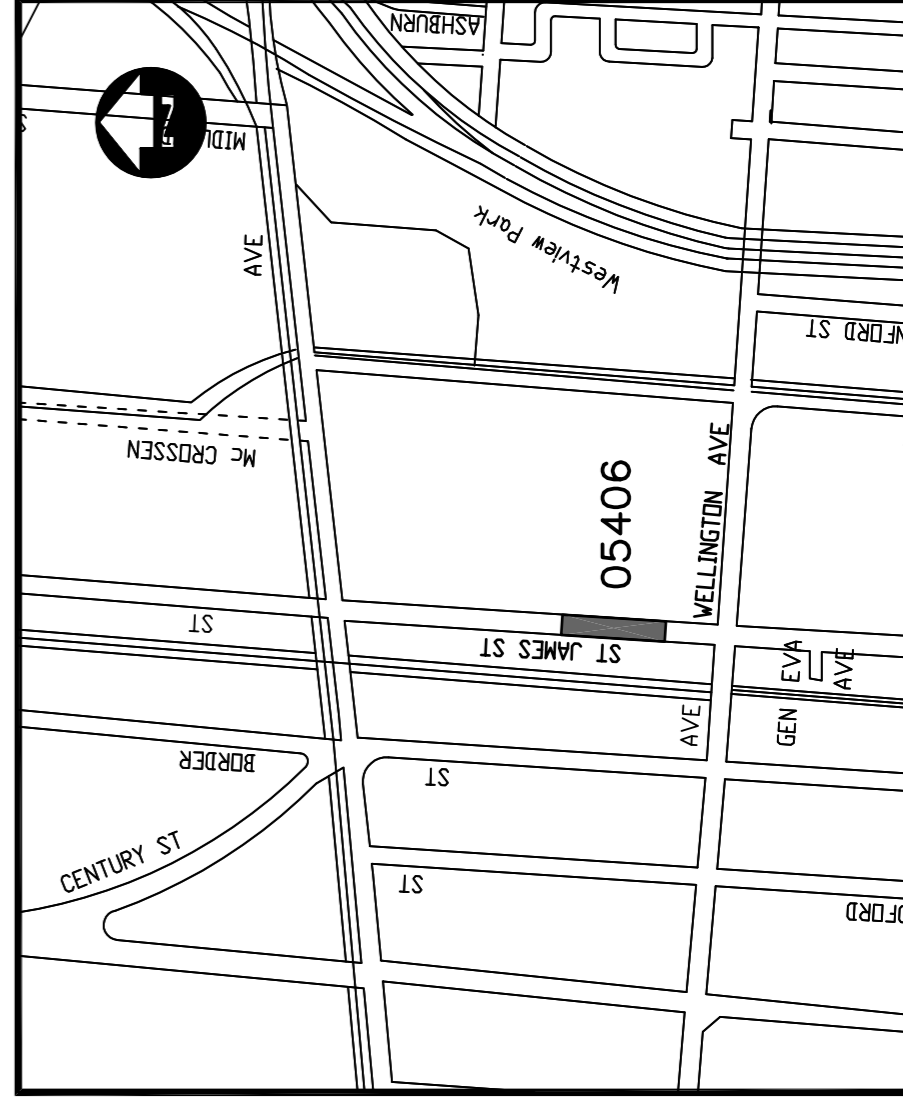

LOCATION PLAN



LOCATION PLAN

(ORIGINAL SIGNED BY)  
KAS ZUREK  
RELEASED FOR CONSTRUCTION

MAY 26, 2004  
DATE

