

SEWER SERVICE INFORMATION (ID #17256) \*

DISTANCE FROM 4TH MH E. OF MAIN ST. (MH ID #17255)	
6.5 E	SERVICE CONNECTION N
7.7 E	SERVICE CONNECTION S
7.8 E	SERVICE CONNECTION N
DISTANCE FROM MH AT ST. CROSS ST. (MH ID #17257)	
2.4 W	SERVICE CONNECTION N
3.2 W	SERVICE CONNECTION S
10.8 W	SERVICE CONNECTION S
11.9 W	SERVICE CONNECTION S
22.4 W	SERVICE CONNECTION S
23.1 W	SERVICE CONNECTION N
32.7 W	SERVICE CONNECTION S
33.5 W	SERVICE CONNECTION S
42.6 W	SERVICE CONNECTION S
43.1 W	SERVICE CONNECTION S
52.3 W	SERVICE CONNECTION S
53.0 W	SERVICE CONNECTION N
53.6 W	SERVICE CONNECTION N
53.7 W	SERVICE CONNECTION S
54.4 W	SERVICE CONNECTION N
62.8 W	SERVICE CONNECTION S
63.7 W	SERVICE CONNECTION N
65.9 W	SERVICE CONNECTION N
72.8 W	SERVICE CONNECTION S
73.5 W	SERVICE CONNECTION N
82.6 W	SERVICE CONNECTION S
83.6 W	SERVICE CONNECTION N
92.7 W	SERVICE CONNECTION S
93.4 W	SERVICE CONNECTION N
103.2 W	SERVICE CONNECTION S
103.5 W	SERVICE CONNECTION S

\* - INFORMATION FROM SEWER VIDEO INSPECTION

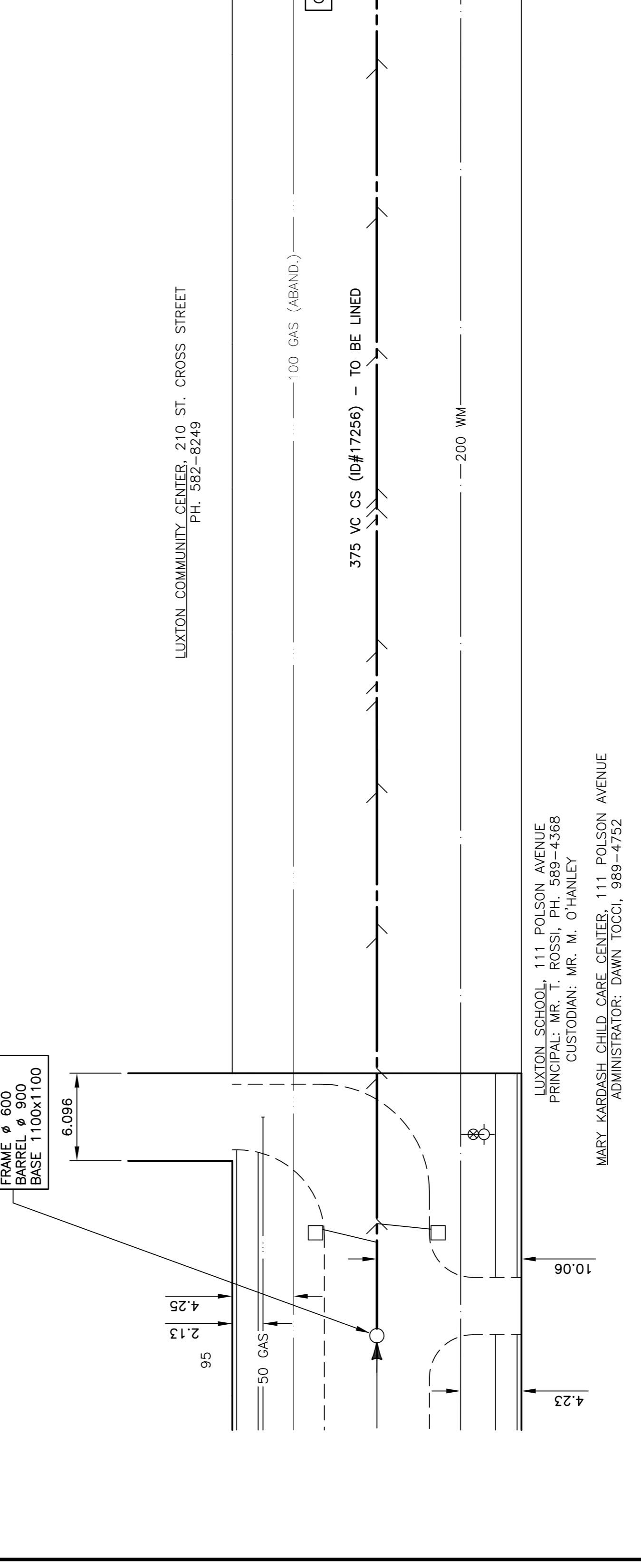

**LUXTON AVENUE (R.O.W.)**

IF POWER EQUIPMENT OR EXPLOSIVES ARE TO BE USED FOR EXCAVATION ON THIS PROJECT THE CONTRACTOR MUST:

1. NOTIFY THE GAS COMPANY OF THE PROPOSED LOCATION OF EXCAVATION.
2. TAKE PRECAUTION TO AVOID DAMAGE TO GAS COMPANY INSTALLATIONS SEE PROVINCIAL REGULATION 210/72 FOR DETAILS

**WARNING**

METRIC  
WHOLE NUMBERS INDICATE MILLIMETRES  
DECIMALIZED NUMBERS INDICATE METRES

<p>WATERMAIN HYDRANT VALVE</p> <p>300 mm I.D.S. LAND DRAINAGE SEWER</p> <p>250 mm W.W.S. WASTE WATER SEWER</p> <p>150 mm W.M. HYDRANT VALVE</p>		<p>HYDRO M.T.S. CONCRETE ASPHALT</p> <p>PROPERTY LINE</p> <p>SURVEY BAR SERVICE VALVE</p> <p>I.P.S. BUILDING</p>		<p>150 mm W.M. WATERMAIN</p> <p>300 mm I.D.S. LAND DRAINAGE SEWER</p> <p>250 mm W.W.S. WASTE WATER SEWER</p>		<p>WATERMAIN HYDRANT VALVE</p> <p>300 mm I.D.S. LAND DRAINAGE SEWER</p> <p>250 mm W.W.S. WASTE WATER SEWER</p>		<p>LEGEND-PLAN</p> <p>LEGEND-PROFILE</p>		<p>PROPOSED EXISTING</p> <p>PROPOSED EXISTING</p>
<p>UNDERGROUND STRUCTURES</p> <p>SUPV. U/G STRUCTURES COMMITTEE</p> <p>DATE</p> <p>NOTE: INFORMATION BASED ON THE BEST INFORMATION AVAILABLE AT THE TIME OF THE DRAWING. THE DRAWING IS NOT A GUARANTEE OF ACCURACY AND THE CONTRACTOR SHALL BE RESPONSIBLE FOR VERIFYING THE EXISTENCE AND EXACT LOCATION OF ALL UTILITIES AND STRUCTURES BEFORE PROCEEDING WITH CONSTRUCTION.</p>										
DESIGNED BY: J.K.M.		DRAWN BY: S.C.C.		CHECKED BY: P.M.K.		APPROVED BY: [Signature]		B.M. ELEV.		
DATE: APRIL 2004		DATE: APRIL 2004		DATE: APRIL 2004		DATE: APRIL 2004		REVISIONS		
1:250		1:50		1:50		1:50		NO.		
02/28/04 P.M.K.		05/10/04 P.M.K.		05/10/04 P.M.K.		05/10/04 P.M.K.		DATE		
ISSUED FOR TENDER		SUBMITTED TO W&M FOR REVIEW		SUBMITTED TO W&M FOR REVIEW		SUBMITTED TO W&M FOR REVIEW		DATE		
1		1		1		1		NO.		
APRIL 2004		APRIL 2004		APRIL 2004		APRIL 2004		DATE		
1:50		1:50		1:50		1:50		SCALE		
1:250		1:50		1:50		1:50		HOR. SCALE		
P.M.K.		P.M.K.		P.M.K.		P.M.K.		DESIGNED BY		
S.C.C.		S.C.C.		S.C.C.		S.C.C.		DRAWN BY		
J.K.M.		J.K.M.		J.K.M.		J.K.M.		DESIGNED BY		
<p>DILLON CONSULTING</p> <p>RELEASED FOR CONSTRUCTION (SIGNED BY) KAS ZUREK</p> <p>DATE: MAY 26, 2004</p>										
APRIL 2004		APRIL 2004		APRIL 2004		APRIL 2004		DATE		
1:50		1:50		1:50		1:50		SCALE		
1:250		1:50		1:50		1:50		HOR. SCALE		
P.M.K.		P.M.K.		P.M.K.		P.M.K.		DESIGNED BY		
S.C.C.		S.C.C.		S.C.C.		S.C.C.		DRAWN BY		
J.K.M.		J.K.M.		J.K.M.		J.K.M.		DESIGNED BY		
S.C.C.		S.C.C.		S.C.C.		S.C.C.		DRAWN BY		
P.M.K.		P.M.K.		P.M.K.		P.M.K.		CHECKED BY		
S.C.C.		S.C.C.		S.C.C.		S.C.C.		DRAWN BY		
J.K.M.		J.K.M.		J.K.M.		J.K.M.		DESIGNED BY		
S.C.C.		S.C.C.		S.C.C.		S.C.C.		DRAWN BY		
P.M.K.		P.M.K.		P.M.K.		P.M.K.		CHECKED BY		
S.C.C.		S.C.C.		S.C.C.		S.C.C.		DRAWN BY		
J.K.M.		J.K.M.		J.K.M.		J.K.M.		DESIGNED BY		

**THE CITY OF WINNIPEG WATER AND WASTE DEPARTMENT**

2004 COMBINED SEWER RENEWALS BY CIPP LINING, CONTRACT 9 LUXTON AVENUE (R.O.W.) 4TH MH EAST OF MAIN ST TO MH AT ST. CROSS ST (CL)

CITY DRAWING NUMBER 05402 SHEET 4 OF 15 BID OPPORTUNITY 238-2004

ENGINEER'S SEAL  
PROF. OF MONT. ORIGINAL  
P.M. KREITZ  
REGISTERED PROFESSIONAL ENGINEER  
05/26/04

CONSULTANT DRAWING NO. 043031-04

REG. FOR CONSTRUCTION  
KAS ZUREK  
DATE: MAY 26, 2004