

PLAN

Scale 1:500

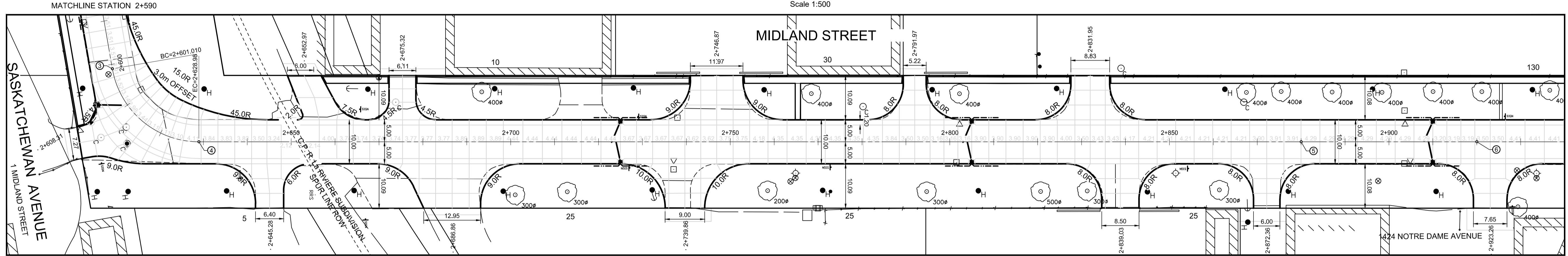

PLAN

Scale 1:500

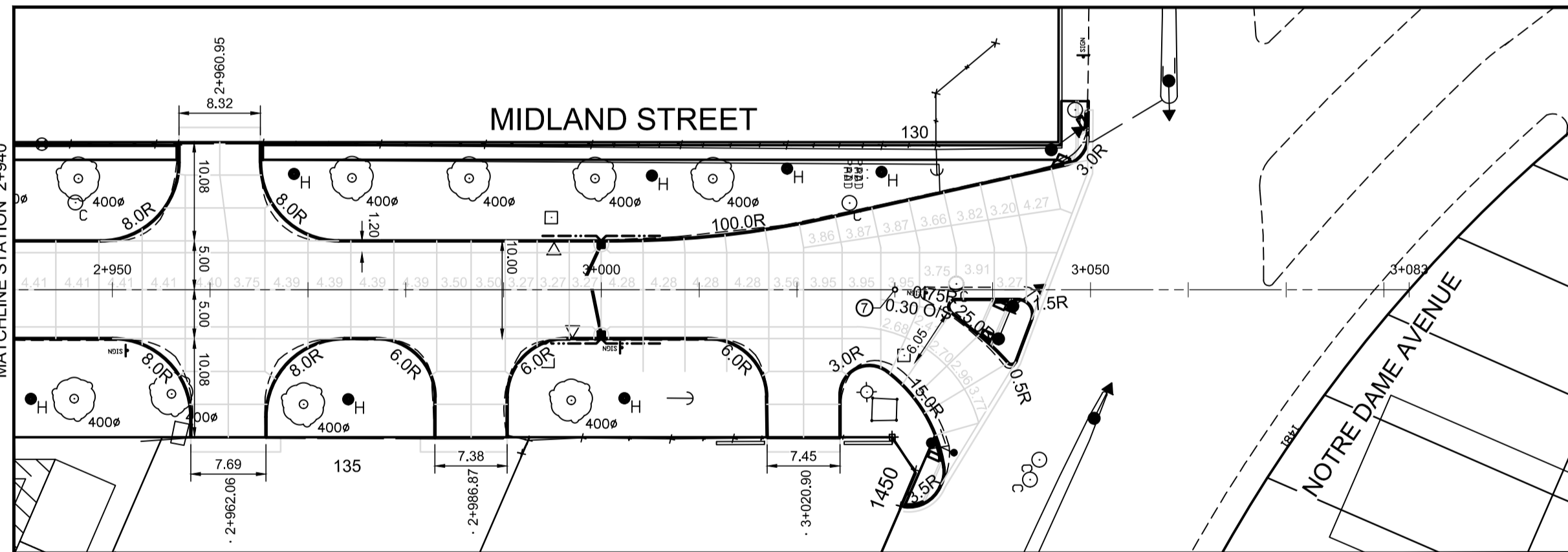

PLAN

Scale 1:500

BASELINE TABLE			
POINT I.D.	DESCRIPTION	NORTHING	EASTING
1	PT	5529829.340	629656.012
2	PT	5529870.418	629938.442
3	BC	5529872.666	629953.888
4	EC	5529891.910	629971.000
5	PT	5530142.828	629977.876
6	PT	5530182.813	629978.971
7	PT	5530292.772	629981.984

**METRIC**  
 WHOLE NUMBERS INDICATE MILLIMETRES  
 DECIMALIZED NUMBERS INDICATE METRES

DRAWING NOTES

- ALL COORDINATES ARE NAD 83 UTM ZONE 14
- ALL PAVEMENT DIMENSIONS ARE TO BACK OF CURB

**ENGINEERS  
 GEOSCIENTISTS  
 MANITOBA**  
 Certificate of Authorization  
 AECOM Canada Ltd.  
 No. 4671 Date: 02/26/24

B.M. ELEV.	<b>AECOM</b>		ENGINEER'S SEAL		<b>THE CITY OF WINNIPEG</b> PUBLIC WORKS DEPARTMENT ENGINEERING DIVISION	CITY DRAWING NUMBER	
			DESIGNED BY: SS	CHECKED BY: BC		2024 INDUSTRIAL STREET RENEWAL PROGRAM	
	DRAWN BY: SS	APPROVED BY: RC	CONSULTANT DRAWING NO. CT-04		MIDLAND STREET AND SASKATCHEWAN AVENUE - EMPRESS STREET TO NOTRE DAME AVENUE CONCRETE PAVEMENT RECONSTRUCTION GEOMETRIC AND CONCRETE JOINT PLAN		
0 ISSUED FOR TENDER	02/26/24	RC	HOR. SCALE: AS SHOWN	RELEASED FOR CONSTRUCTION BY:			
NO. REVISIONS	DATE	BY	DATE	DATE			