

CONSTRUCTION NOTES:

PROJECT SCOPE

1. INSTALL CONDUIT AND BASE AS SHOWN.
2. REBUILD SERVICE AND INSTALL GROUND ROD ON WOOD POLE #9 AS SHOWN. INSTALL MAST AND DISCONNECT ON XX QUADRANT. INSTALL WEATHER HEAD 150mm LOWER THAN THE LOWEST HYDRO WIRE. TOTAL LENGTH OF SERVICE CABLE: 5m.
3. INSTALL EQUIPMENT AS SHOWN.
4. TIMINGS REQUIRED.

PROJECT COORDINATION

1. COORDINATE HYDRO SERVICE REBUILD WITH (HYDRO DESIGNER), (204) XXX-XXXX. RE: JUTA PERMIT No. BXXXXX

DETECTION CONNECTION DETAILS				
SENSOR NO.	POLE NO.	DETECTION LOCATION	NOTES	
MATRIX 1	6	NB LEFT LANE	J1 UPPER	13

TRAFFIC SIGNALS EQUIPMENT DISPLAY:
N.T.S.

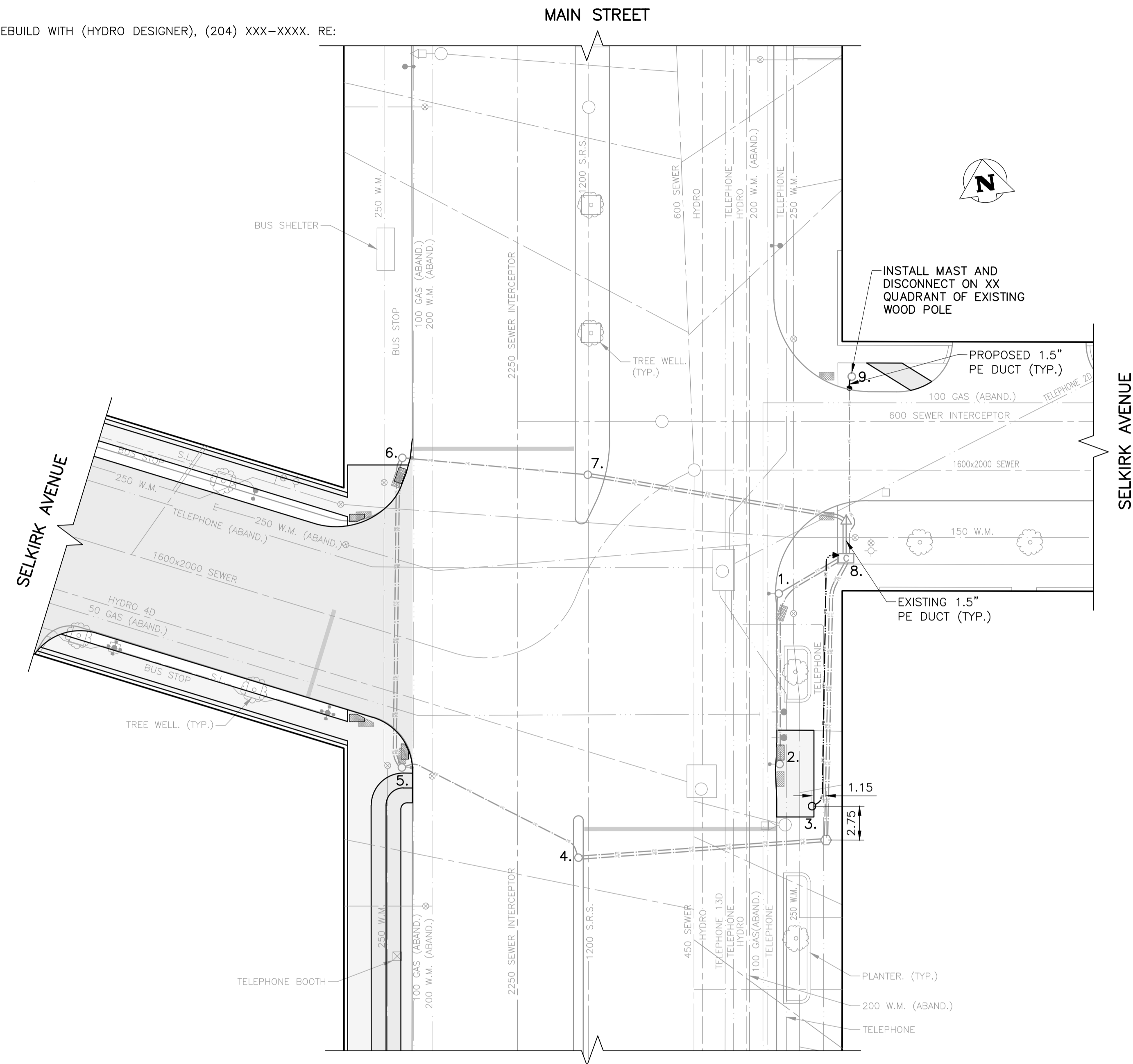
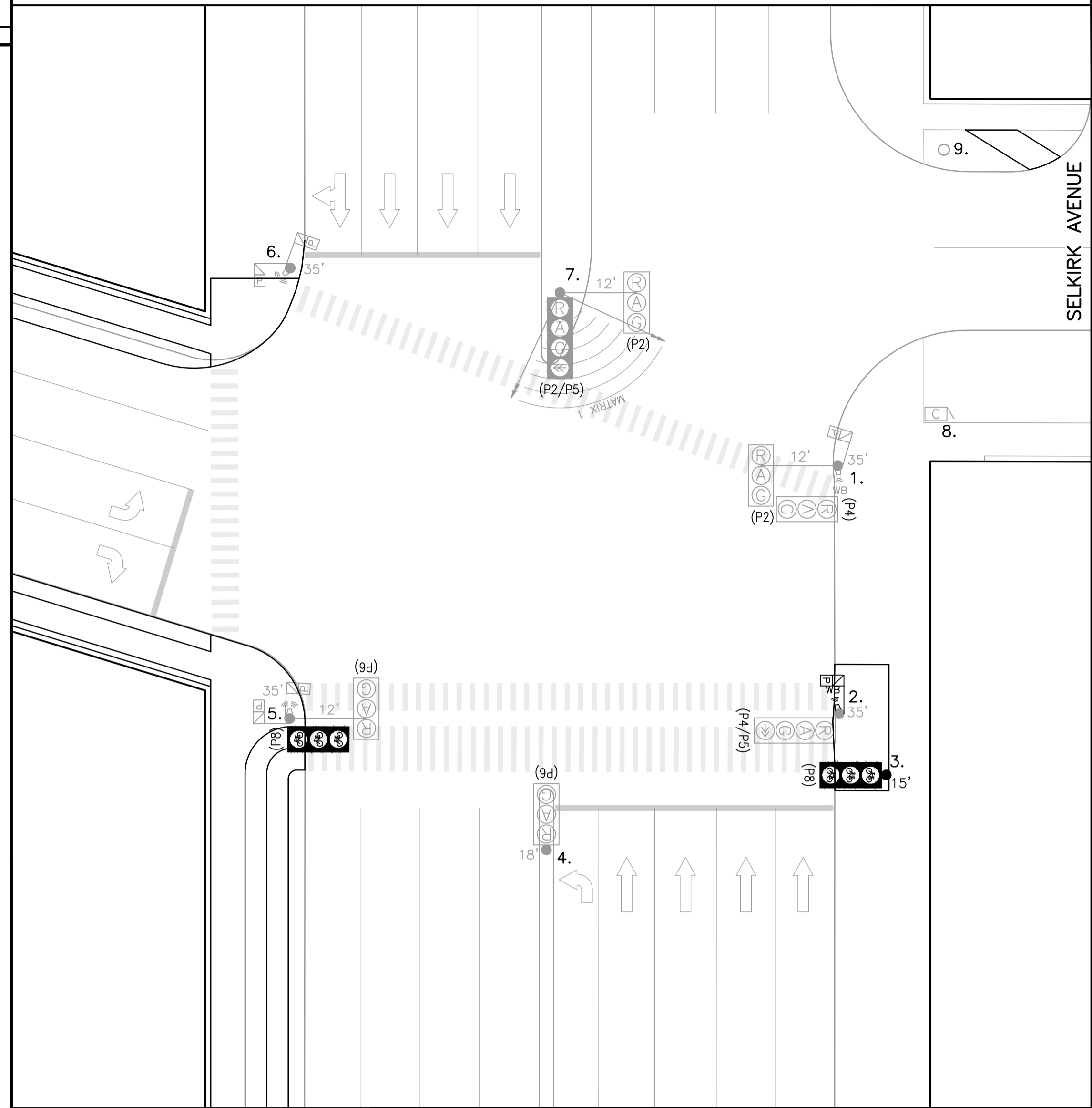

PLAN VIEW: UNDERGROUND CONSTRUCTION

1:250

EQUIPMENT DISPLAY LEGEND	NO.	EQUIPMENT LIST	ARM	BASE	B.B.	NO.	EQUIPMENT LIST	ARM	BASE	B.B.
EXISTING (AS SHOWN BELOW)	1.	TROLLEY TYPE S.L.		12'						
PROPOSED (AS SHOWN BELOW)	2.	TROLLEY TYPE S.L.								
	3.	15" SIGNAL		G	G					
	4.	18" SIGNAL TRAFFIC DETECTOR CAMERA		A	A					
	5.	TROLLEY TYPE S.L.		12'						
	6.	TROLLEY TYPE S.L.								
	7.	DAVIT		12'	A	AD				
	8.	336 CABINET/170 CONTROLLER								
	9.	HYDRO WOOD SERVICE								

TRAFFIC SIGNALS UNDERGROUND LEGEND				SIGNAL BASE BOLT SQUARE TYPES				
EXISTING (AS SHOWN BELOW)	PROPOSED (AS SHOWN BELOW)	DISCONNECTED (LOOPS ONLY)		BOLT SQUARE (B.S.) DIA.				
1 1/2" PE CONDUIT	—	—	POLE BASE	TYPE "A" - 8 1/8"	TYPE "B" - 6 3/4"			
2" PE CONDUIT	—	—	WOOD POST	TYPE "C" - 8 1/8" SCREW TYPE	TYPE "D" - 12 3/4", 1 1/4" DIA. BOLTS, 24" DIA.			
4" PVC CONDUIT	—	—	CONTROLLER BASE	TYPE "OD" - 12 3/4", 1 1/4" DIA. BOLTS, 28" DIA.	TYPE "POD" - 12 3/4", 1 1/4" DIA. BOLTS, 28" DIA.			
AERIAL / BURIED CABLE	—	—	PEDESTAL BASE	TYPE "E" - 9 9/16" SCREW TYPE	TYPE "F" - 9 9/16"			
CONDUIT STUB	—	—	TERMINAL BASE	TYPE "G" - 8 1/8", 1 1/4" DIA. BOLTS, 89mm PROJ.	TYPE "GS" - 8 1/8", 1 1/4" DIA. BOLTS, 76mm PROJ.			
BREAK-IN	—	—	SERVICE BOX (PIT)	TYPE "H" - 9 7/8" SCREW TYPE	TYPE "I" - 7 3/4"			
SPICE	—	—	24" PRECAST PIT	TYPE "J" - 10 5/8", 1 1/4" DIA. BOLTS	TYPE "K" - 10 5/8", PRECAST, 1 1/4" DIA. BOLTS			
SAW-CUT LOOPS	① ②	① ②	30" PRECAST PIT	TYPE "L" - 6", 5/8" DIA. BOLTS	TYPE "PM" - 8 1/8", PRECAST, 5/8" DIA. BOLTS			
PERFORMED LOOPS	① ②	① ②	36" PRECAST PIT					
			REMOVAL					

INTERNAL REVIEW		
OPERATIONS:	DATE	INITIALS
LAB:	DATE	INITIALS
TIMINGS (INITIAL):	DATE	INITIALS
TIMINGS (PRE-FC):	DATE	INITIALS
TMC:	DATE	INITIALS
UNDERGROUND CONSTRUCTABILITY:	DATE	INITIALS
STREET LIGHTING:	DATE	INITIALS
TRAFFIC MANAGEMENT:	DATE	INITIALS

U:\Staff\Projects\2023\12400 - Transportation\Main St & Selkirk Ave\Drawings\12400-01-01-01.dwg

EXISTING	LEGEND	PROPOSED	EXISTING	LEGEND	PROPOSED	EXISTING	LEGEND	PROPOSED
150 W.M.	WATERMAIN	150 W.M.	PROPERTY LINE	TELEPHONE	TELEPHONE	TELEPHONE	TELEPHONE	TELEPHONE
Hydrant	HYDRANT	Valve	ROADWAY	COMMUNICATION	COMMUNICATION	COMMUNICATION	COMMUNICATION	COMMUNICATION
Shutoff Valve	SHUTOFF VALVE	Sewer	SIDEWALK	WOOD POLE	WOOD POLE	WOOD POLE	WOOD POLE	WOOD POLE
300 Sewer	SEWER	Manhole	CURB & CURB RAMP	STREET LIGHT	STREET LIGHT	STREET LIGHT	STREET LIGHT	STREET LIGHT
Manhole	MANHOLE	Catch Basin	WARNING TILE	BANNER POLE	BANNER POLE	BANNER POLE	BANNER POLE	BANNER POLE
Catch Basin	CATCH BASIN	Curb Inlet	CULVERT	RAILWAY POLE	RAILWAY POLE	RAILWAY POLE	RAILWAY POLE	RAILWAY POLE
Curb Inlet	CURB INLET	Hydro	BUILDING	GUY-WIRE	GUY-WIRE	GUY-WIRE	GUY-WIRE	GUY-WIRE
Hydro	HYDRO	100 Gas	TREE	FENCE	FENCE	FENCE	FENCE	FENCE
100 Gas	GAS	100 Gas	GUARDRAIL	GUARDRAIL	GUARDRAIL	GUARDRAIL	GUARDRAIL	GUARDRAIL

UNDERGROUND STRUCTURES	
UNDERGROUND STRUCTURES ID	DATE (YYYY/MM/DD)
WATER & WASTE REVIEW ID	

CONSTRUCTION REVISIONS			
NO.	REVISION	DATE (YYYY/MM/DD)	BY
A	ISSUED FOR INTERNAL REVIEW	2023/01/25	A.B.

DESIGNED BY	A.B.
DRAWN BY	A.B.
CHECKED BY	C.H.
APPROVED BY	

ACCOUNTS: PENDING

ENGINEER'S SEAL: PRELIMINARY

NOT FOR CONSTRUCTION

THE CITY OF WINNIPEG
 PUBLIC WORKS DEPARTMENT
 TRANSPORTATION DIVISION

TRAFFIC SIGNALS
 MAIN ST. & SELKIRK AVE.

UNITS: ALL DIMENSIONS ARE IN METERS UNLESS OTHERWISE NOTED
 DRAWING NUMBER: **S-1240**