

CONSTRUCTION NOTES:

PROJECT SCOPE

1. INSTALL CONDUIT, BASES AND PITS AS SHOWN.
2. REBUILD SERVICE AND INSTALL GROUND ROD ON WOOD POLE #3 AS SHOWN. INSTALL MAST AND DISCONNECT ON XX QUADRANT. INSTALL WEATHER HEAD 150mm LOWER THAN THE LOWEST HYDRO WIRE. REMOVE EXISTING SERVICE FROM WOOD POLE #3. TOTAL LENGTH OF SERVICE CABLE: 12m.
3. INSTALL EQUIPMENT AS SHOWN. REMOVE SIGNALS EQUIPMENT FROM JOINT USE POLE #E2.
3. INSTALL LOW FLASHERS AT HEIGHT OF 2.6m (8'-6") ABOVE THE BASE. PEDESTRIAN SIGNS TO BE 4" BELOW LOW FLASHERS.
4. CROSSING TIME FOR CROSSWALK: 17 SECONDS.

PROJECT COORDINATION

1. COORDINATE HYDRO SERVICE REBUILD WITH (HYDRO DESIGNER), (204) XXX-XXXX. RE: JUTA PERMIT No. BXXXXX
2. TWO WEEKS PRIOR TO CONSTRUCTION, COORDINATE REMOVAL OF JOINT USE POLE #E2 AND REMOVAL OF SIGNALS EQUIPMENT FROM JOINT USE POLE #E2 WITH SM-WINNIPEG LIGHTING GROUP WITH MANITOBA HYDRO, (204) 360-7062 OR (204) 360-7519 AT WinnipegStreetlighting@hydro.mb.ca.

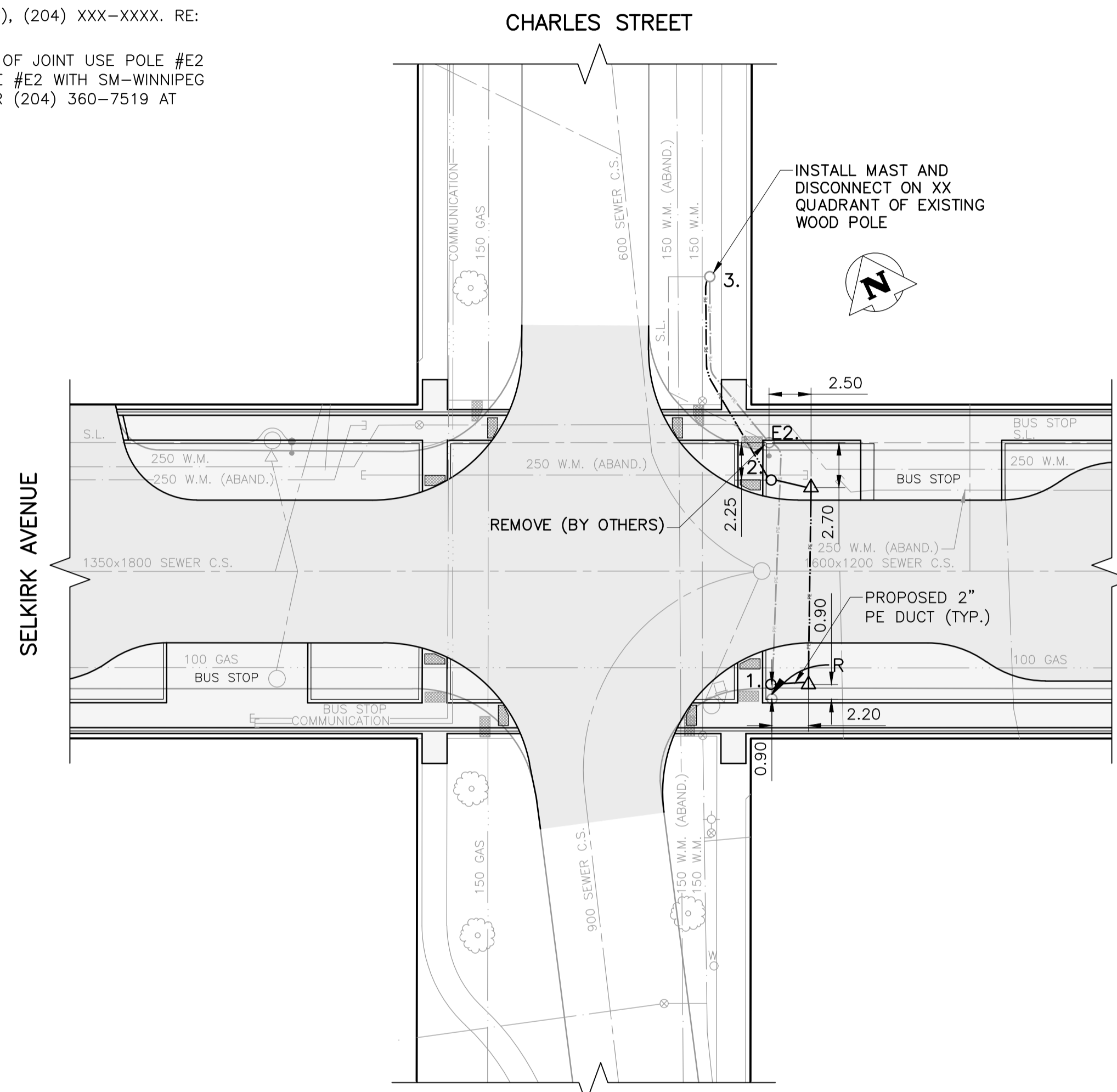

PLAN VIEW: UNDERGROUND CONSTRUCTION

1:250

INTERNAL REVIEW			
OPERATIONS:	_____	DATE	INITIALS
LAB:	_____	DATE	INITIALS
TIMINGS (INITIAL):	_____	DATE	INITIALS
TIMINGS (PRE-IFC):	_____	DATE	INITIALS
TMC:	_____	DATE	INITIALS
UNDERGROUND CONSTRUCTABILITY:	_____	DATE	INITIALS
STREET LIGHTING:	_____	DATE	INITIALS
TRAFFIC MANAGEMENT:	_____	DATE	INITIALS

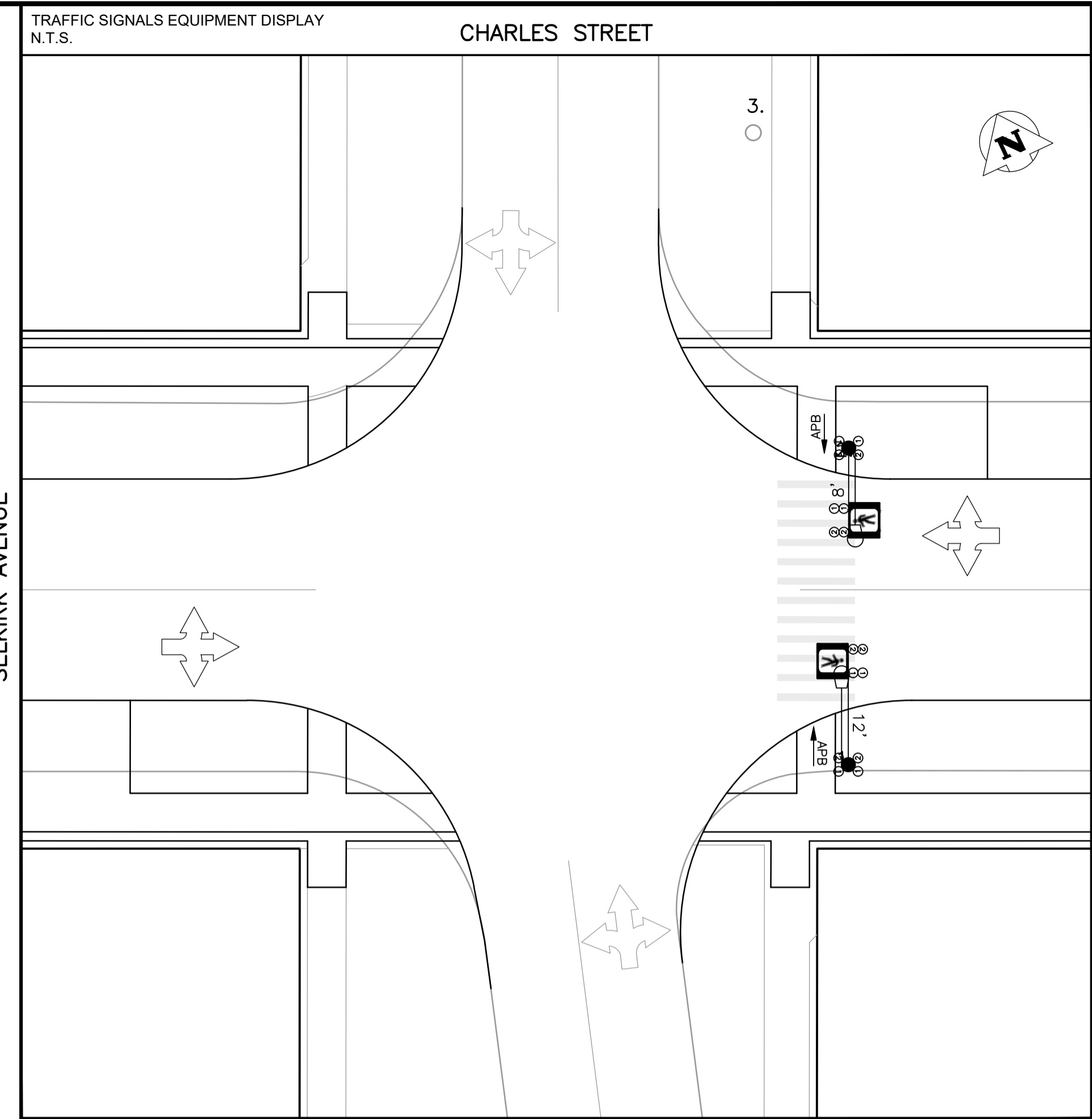

EXISTING		PROPOSED (AS SHOWN BELOW)	
	PEDESTRIAN HEAD WITH PCS		TRAFFIC SIGNAL POLE
	PEDESTRIAN CORRIDOR BOX (CIRCUIT 10234)		WOOD POST
	RRFB (PHASE 'A' OR 'B')		TRAFFIC SIGNAL POLE
	VEHICLE DETECTION AREA		TRAFFIC SIGNAL POLE
	TRAFFIC SIGNAL POLE		APS SINGLE DIRECTION
	TRAFFIC SIGNAL POLE		APS DUAL DIRECTION (2 SEPARATE DISPLAYS)
	TRAFFIC SIGNAL POLE		PUSH BUTTON & DIRECTION (APB = ADJUSTABLE PB)
	TRAFFIC SIGNAL POLE		RED FLASHER
	TRAFFIC SIGNAL POLE		LUMINAIRE
	TRAFFIC SIGNAL POLE		AMBER FLASHER
	TRAFFIC SIGNAL POLE		CAMERA
	TRAFFIC SIGNAL POLE		TRAFFIC SIGNAL HEAD
	TRAFFIC SIGNAL POLE		TRAFFIC SIGNAL HEAD
	TRAFFIC SIGNAL POLE		TRAFFIC SIGNAL HEAD

NO.	EQUIPMENT LIST	ARM	BASE	B.B.	NO.	EQUIPMENT LIST	ARM	BASE	B.B.
1.	35' SIGNAL FOR 90 WATT (9000 LUMEN) LUMINAIRE	12'	G	GD	E2.	35' S.L.		A	A
2.	35' SIGNAL FOR 90 WATT (9000 LUMEN) LUMINAIRE	8'	G	GD					
3.	HYDRO WOOD #XXXXXX SERVICE:								

EXISTING / ABANDONED		PROPOSED (AS SHOWN BELOW) / DISCONNECTED (LOOPS ONLY)		BOLT SQUARE (B.S.) DIA.	
	1 1/2" PE CONDUIT		POLE BASE		TYPE "A" - 8 1/8"
	2" PE CONDUIT		WOOD POST		TYPE "B" - 6 3/4"
	4" PVC CONDUIT		CONTROLLER BASE		TYPE "C" - 8 1/8" SCREW TYPE
	AERIAL / BURIED CABLE		PEDESTAL BASE		TYPE "D" - 12 3/4", 1 1/4" DIA. BOLTS, 24" DIA.
	CONDUIT STUB		TERMINAL BASE		TYPE "OD" - 12 3/4", 1 1/4" DIA. BOLTS, 28" DIA.
	BREAK-IN		SERVICE BOX (PIT)		TYPE "POD" - 12 3/4", PRECAST, 1 1/4" DIA. BOLTS, 28" DIA.
	SPLICE		24" PRECAST PIT		TYPE "E" - 9 9/16" SCREW TYPE
	SAW-CUT LOOPS		30" PRECAST PIT		TYPE "F" - 9 9/16"
	PERFORMED LOOPS		36" PRECAST PIT		TYPE "G" - 8 1/8", 1 1/4" DIA. BOLTS, 89mm PROJ.
			REMOVAL		TYPE "H" - 9 7/8" SCREW TYPE
					TYPE "I" - 7 3/4"
					TYPE "J" - 10 5/8", 1 1/4" DIA. BOLTS
					TYPE "K" - 10 5/8", PRECAST, 1 1/4" DIA. BOLTS
					TYPE "L" - 6", 5/8" DIA. BOLTS
					TYPE "PM" - 8 1/8", PRECAST, 5/8" DIA. BOLTS

150 MM	WATERMAIN	150 MM	PROPERTY LINE	TELEPHONE	TELEPHONE	TELEPHONE	UNDERGROUND STRUCTURES			CONSTRUCTION REVISIONS			ACCOUNTS:			ENGINEER'S SEAL:										
	HYDRANT		ROADWAY		COMMUNICATION		PENDING						PENDING			THE CITY OF WINNIPEG PUBLIC WORKS DEPARTMENT TRANSPORTATION DIVISION										
	SHUTOFF VALVE		SIDEWALK		WOOD POLE		PENDING						PRELIMINARY NOT FOR CONSTRUCTION													
	SEWER		CURB & CURB RAMP		STREET LIGHT		UNDERGROUND STRUCTURES ID			DATE (YYYYMMDD)						DESIGNED BY			LIABILITY DISCLAIMER NOTICE:							
	CATCH BASIN		CULVERT		BANNER POLE		PENDING						DRAWN BY			THE INFORMATION PROVIDED FOR YOUR CONVENIENCE HEREIN IS FOR USE AT YOUR OWN RISK. THE CITY OF WINNIPEG, PUBLIC WORKS DEPARTMENT, SHALL ASSUME NO RESPONSIBILITY FOR THE INFORMATION AND IT SHOULD NOT BE CONSTRUED AS ASSULT INFORMATION. THE INFORMATION SHOULD BE USED FOR PLANNING PURPOSES ONLY AND SHOULD BE VERIFIED BY SURVEY. THE DEPARTMENT SHALL NOT IN ANY WAY SUFFER ANY LIABILITY WHATSOEVER TO ANY PARTY FOR INJURY, LOSS OR DAMAGES SUFFERED BY SUCH PARTY ARISING FROM THEIR USE OF, OR RELIANCE UPON, THIS INFORMATION.										
	CURB INLET		BUILDING		GUY-WIRE		WATER & WASTE REVIEW ID						CHECKED BY			PEDESTRIAN CORRIDOR CHARLES ST. & SELKIRK										
	HYDRO		TREE		FENCE		NOTE:			A ISSUED FOR INTERNAL REVIEW			DATE (YYYYMMDD)						BY							
	100 GAS		GAS		GUARDRAIL		LOCATIONS OF UNDERGROUND STRUCTURES AS SHOWN ARE BASED ON THE BEST INFORMATION AVAILABLE. BUT NO GUARANTEE IS GIVEN THAT ALL EXISTING UTILITIES ARE SHOWN OR THAT THE GIVEN LOCATIONS ARE EXACT. CONFIRMATION OF EXISTENCE AND EXACT LOCATION OF ALL SERVICES MUST BE OBTAINED FROM THE INDIVIDUAL UTILITIES BEFORE PROCEEDING WITH CONSTRUCTION.			A			2023/01/20			A.B.										
	EXISTING		PROPOSED		EXISTING		NO.			REVISION			DATE (YYYYMMDD)			APPROVED BY			UNITS: ALL DIMENSIONS ARE IN METERS UNLESS OTHERWISE NOTED							
																								DRAWING NUMBER: S-1067		