

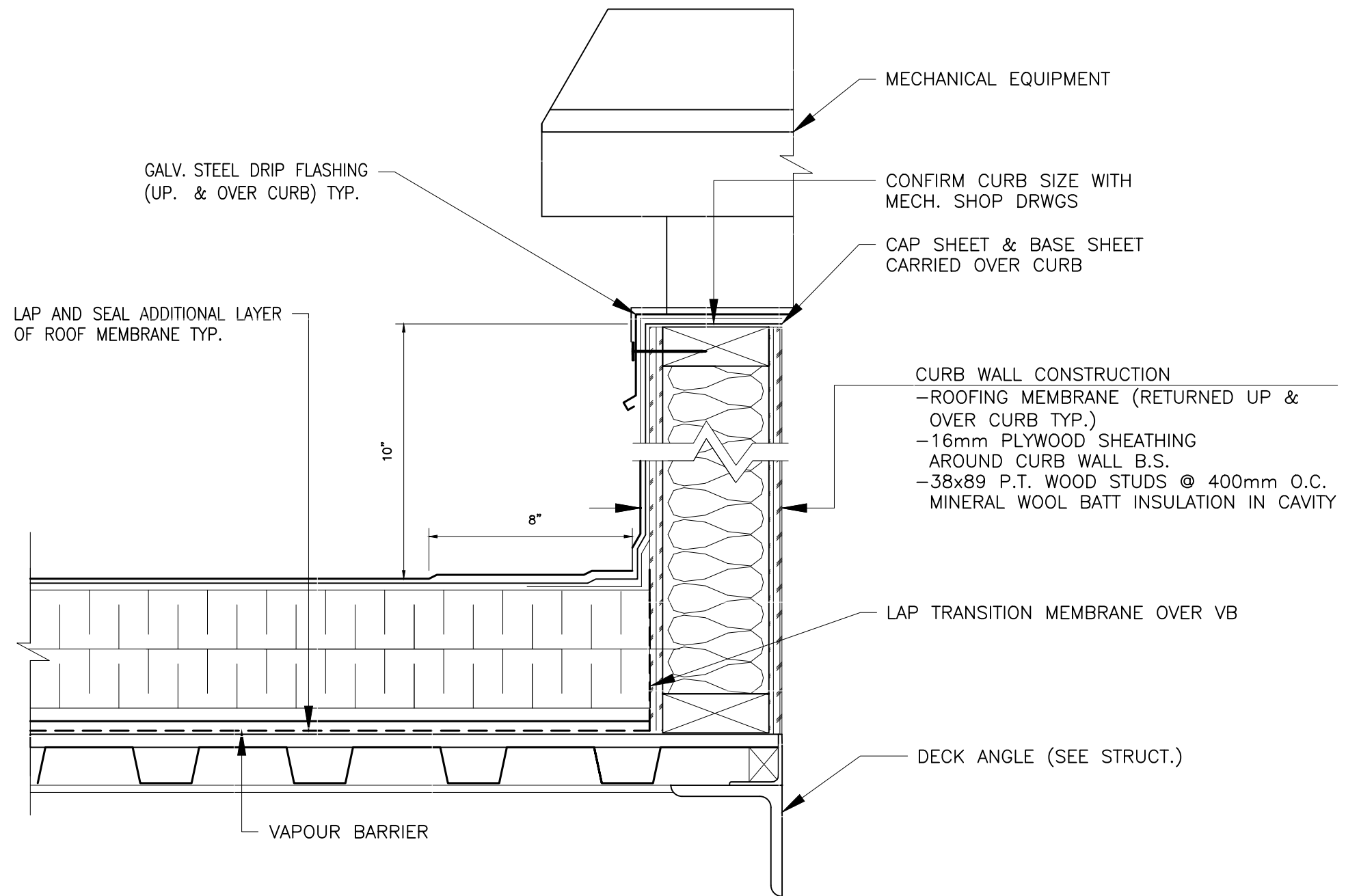

CONSTRUCTION NOTES:



GALV. STEEL DRIP FLASHING (UP. & OVER CURB) TYP.

LAP AND SEAL ADDITIONAL LAYER OF ROOF MEMBRANE TYP.

MECHANICAL EQUIPMENT

CONFIRM CURB SIZE WITH MECH. SHOP DRWGS

CAP SHEET & BASE SHEET CARRIED OVER CURB

CURB WALL CONSTRUCTION

- ROOFING MEMBRANE (RETURNED UP & OVER CURB TYP.)
- 16mm PLYWOOD SHEATHING AROUND CURB WALL B.S.
- 38x89 P.T. WOOD STUDS @ 400mm O.C.
- MINERAL WOOL BATT INSULATION IN CAVITY

LAP TRANSITION MEMBRANE OVER VB

DECK ANGLE (SEE STRUCT.)

VAPOUR BARRIER

1 TYP. CURB
A6 SCALE: NTS

THIS DRAWING MUST NOT BE SCALED. THE CONTRACTOR SHALL VERIFY ALL DIMENSIONS AND OTHER SITE CONDITIONS ON SITE PRIOR TO THE COMMENCEMENT OF WORK. DISCREPANCIES, ERRORS, OR OMISSIONS ARE TO BE REPORTED

PROJECT NAME: Robert Steen Community Centre Partial Roof Replacement	
ADDRESS: 980 PALMERSTON AVENUE, WINNIPEG, MB	
DRAWING: 877-2022_DRAWING_CURB-A6-R0	
DATE: NOV 2022	DRAWN BY: BH
PROJECT NUMBER: 877-2022	REVISION: R0
SCALE: AS NOTED	SHEET NO: A6