

ALLEY PAVEMENT PROFILE
SCALE: 1:250 HOR
1:10 VER

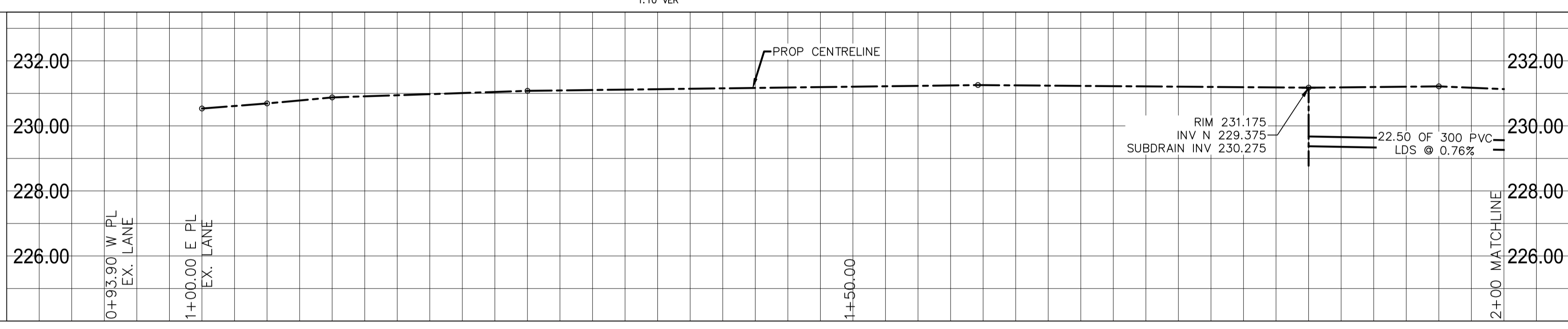

LAND DRAINAGE SEWER PROFILE
SCALE: 1:250 HOR
1:100 VER

- NOTES:
- ALL WORK AND MATERIALS TO BE IN ACCORDANCE WITH THE LATEST REVISION OF THE CITY OF WINNIPEG STANDARD CONSTRUCTIONS.
 - CONTRACTOR TO CONFIRM THE LOCATION OF ALL UTILITIES/SERVICES IN THE FIELD PRIOR TO CONSTRUCTION.
 - ALL ROADWAY DIMENSIONS SHOWN ARE TO BACK OF CURB.
 - EXISTING ASPHALT TO BE PLANED AS SHOWN OR AS DIRECTED BY CONTRACT ADMINISTRATOR.
 - 150mm CONCRETE APRON, TEE AND MAIN APPROACHES AS DIRECTED BY CONTRACT ADMINISTRATOR.
 - EXISTING SIDEWALK TO BE RENEWED AS PER SD-228A AND AS DIRECTED BY CONTRACT ADMINISTRATOR.
 - PLANE/REMOVE EXISTING CURB AS DIRECTED BY CONTRACT ADMINISTRATOR.
 - ALL PRIVATE WALKWAYS TO BE ADJUSTED TO NEW SIDEWALK OR TOP OF CURB ELEVATION, AS DIRECTED BY THE CONTRACT ADMINISTRATOR.
 - PAVEMENT REPAIR FABRIC TO BE INSTALLED AS DIRECTED BY CONTRACT ADMINISTRATOR.
 - ALL EXISTING PRIVATE APPROACHES TO BE RENEWED AS DIRECTED BY CONTRACT ADMINISTRATOR.
 - INSTALLATION OF MOUNTABLE LIP CURBS AND THEIR LIMITS THROUGH PRIVATE APPROACHES TO BE DETERMINED BY CONTRACT ADMINISTRATOR.
 - MODIFIED BARRIER CURB TO BE CONSTRUCTED AT ALL INTERSECTION RADI AND ALLEY RADI.
 - CONTRACTORS TO TAKE PRECAUTIONARY STEPS TO PROTECT EXISTING TREES WITHIN THE LIMITS OF CONSTRUCTION FROM DAMAGE FROM CONSTRUCTION ACTIVITIES AS OUTLINED IN THE SPECIFICATIONS.
 - LAMP STANDARDS, HYDRO POLES, AND ANCHORS THAT REQUIRE TEMPORARY SUPPORT, REMOVAL OR REPLACEMENT, TO BE DONE SO AT THE EXPENSE OF THE CONTRACTOR AS NECESSARY.
 - WHERE UNSTABLE SUB GRADE ARE ENCOUNTERED, ADDITIONAL EXCAVATION AND PLACEMENT OF SUBBASE AS DIRECTED BY CONTRACT ADMINISTRATOR.
 - ADJUSTMENTS TO PROPOSED GROSSFALL, WHERE REQUIRED, ARE TO BE DETERMINED BY CONTRACT ADMINISTRATOR TO SUIT EXISTING DRIVEWAYS, APPROACHES, GARAGE PADS AND YARDS.
 - ALL BOULEVARDS TO BE SODDED UNLESS OTHERWISE NOTED.
 - ADJUST ALL WATER VALVES, HYDRANTS, MANHOLES, AND CATCH BASINS IN WORK AREA TO GRADE.
 - REMOVE, ADJUST AND SUPPLY PRECAST SIDEWALK BLOCKS AS DIRECTED BY CONTRACT ADMINISTRATOR.

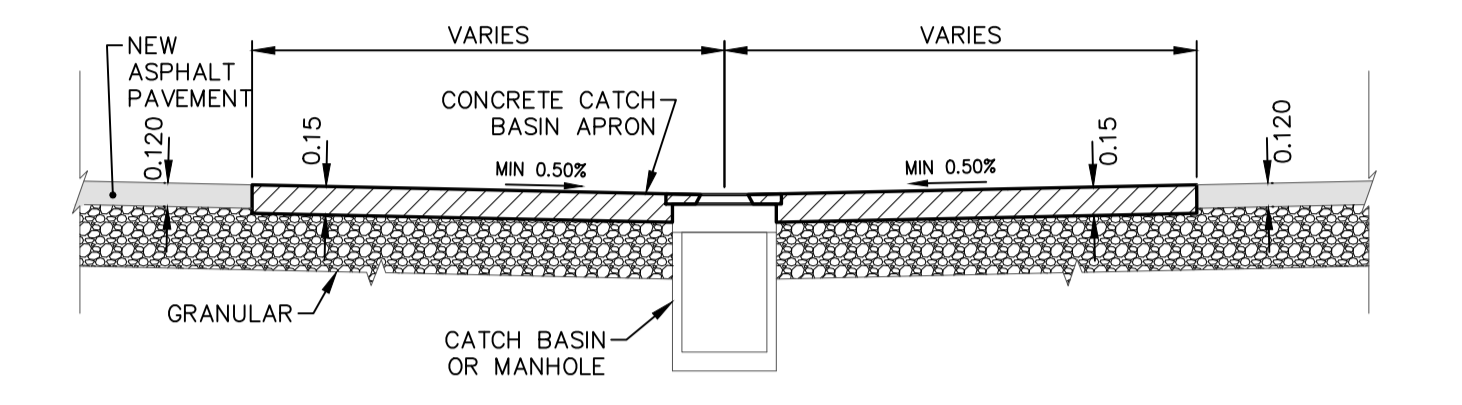

TYPICAL TEE CATCHBASIN APRON DETAIL
NTS

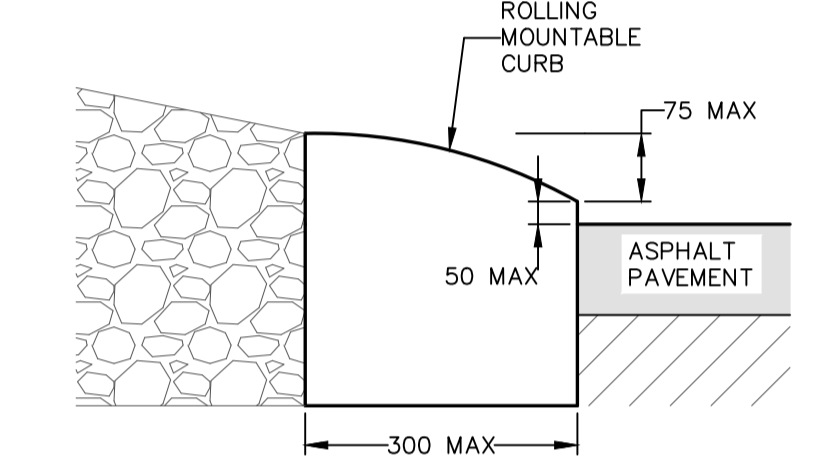

TYPICAL MOUNTABLE LIP CURB DETAIL
NTS

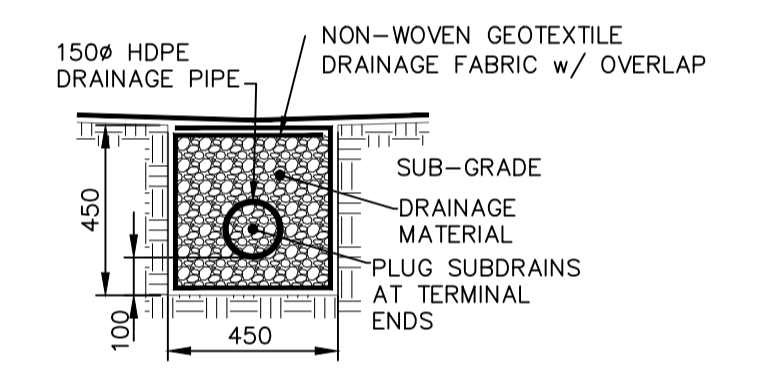

TYPICAL ALLEY SUBDRAIN DETAIL
NTS

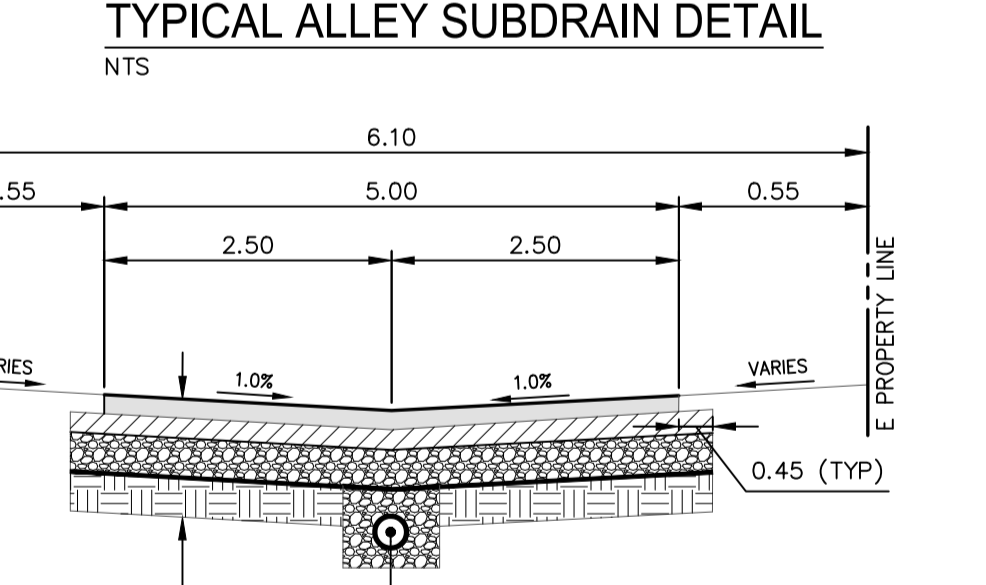

TYPICAL CROSS-SECTION
NTS

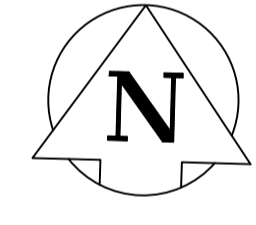
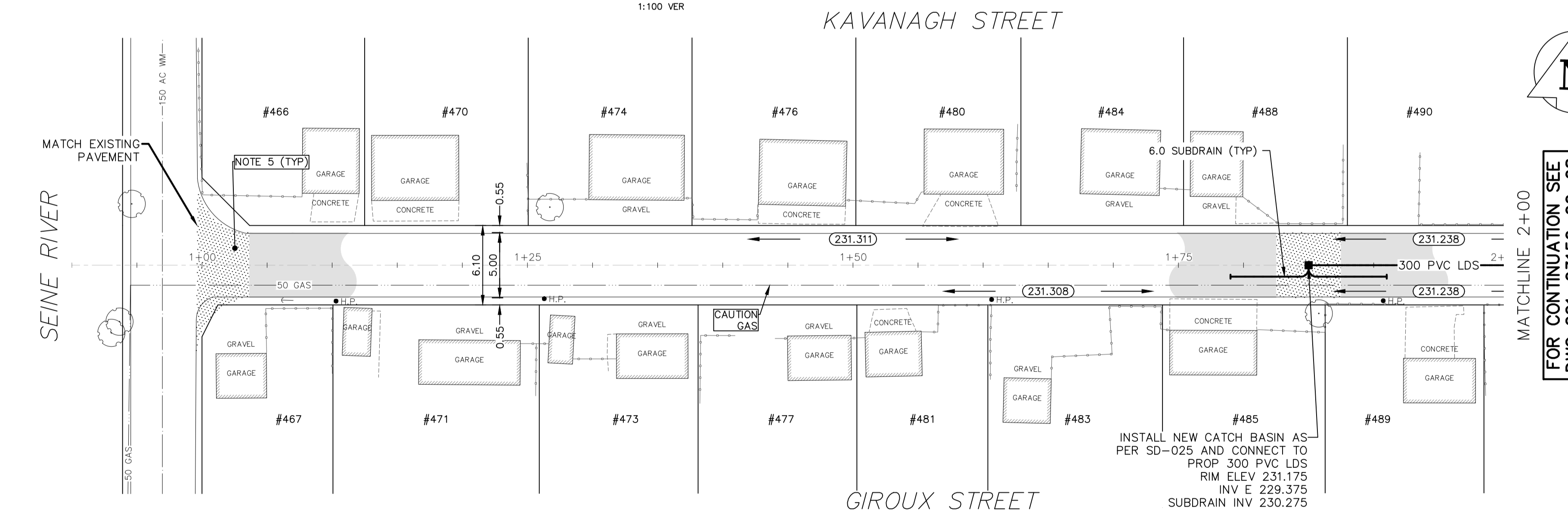

FOR CONTINUATION SEE
DWG 221-03150-00-08

NOTE: CHAINAGES SHOWN ARE ALONG
CL OF RIGHT-OF-WAY

LOCATIONS APPROVED UNDERGROUND STRUCTURES		SIGNATURES	
SIGNED BY:	DATE:	SIGNED BY:	DATE:
SUPV UG STRUCTURES			

LOCATION OF UNDERGROUND STRUCTURES AS SHOWN ARE BASED ON THE BEST INFORMATION AVAILABLE BUT NO GUARANTEE IS GIVEN THAT ALL EXISTING UTILITIES ARE SHOWN OR THAT THE GIVEN LOCATIONS ARE EXACT CONFIRMATION OF EXISTENCE AND EXACT LOCATION OF ALL SERVICES MUST BE OBTAINED FROM THE INDIVIDUAL UTILITIES BEFORE PROCEEDING

EXISTING	PROPOSED	EXISTING	PROPOSED	EXISTING	PROPOSED
WATER MAIN	IRON BAR	HYDRO POLE & LIGHT STANDARD			
LAND DRAINAGE SEWER	HYDRO POLE	LIGHT STANDARD OR TRAFFIC SIGNAL			
WASTE WATER SEWER	HYDRO POLE	HYDRO POLE			
BELL/MTS	CURB RAMP				
GAS	DETECTABLE WARNING SURFACE TILE				
SIGNALS	EDGE OF SIDEWALK				
MANHOLE	FENCE				
CATCH BASIN	PROPERTY LINE				
CURB INLET	EDGE OF ASPHALT				
UTILITIES ADJUSTED	EDGE OF CONCRETE				
PLUG	MODIFIED BARRIER CURB				
HYDRANT	BARRIER CURB				
VALVE	BARRIER CURB AND GUTTER				
CURB STOP	CONC SIDEWALK				
GROUND GRADE (231.00)	CONCRETE SLAB				
PAVEMENT GRADE (231.000)	ASPHALT				
ANCHOR	MILLED SURFACE				
CIVIC ADDRESS #111	PAVEMENT REPAIR FABRIC				
LEGEND-PLAN	LEGEND-PLAN				
LEGEND-PROFILE	LEGEND-PROFILE				

METRIC FOR TENDER PURPOSES ONLY
WHOLE NUMBERS INDICATE MILLIMETRES
DECIMAL NUMBERS INDICATE METRES

NOT FOR CONSTRUCTION

ENGINEERS GEOSCIENTISTS MANITOBA
Certificate of Authorization
WSP Canada Inc.
No. 5750

THE CITY OF WINNIPEG
PUBLIC WORKS DEPARTMENT
ENGINEERING SERVICES DIVISION

2022 TBO & LOCAL IMPROVEMENTS
KAVANAGH ST/GIROUX ST ALLEY
ASPHALT ALLEY RECONSTRUCTION
STA. 0+93.90 TO STA. 2+00

CITY DRAWING NUMBER: 221-03150-00-07
SHEET 07 OF 12
TENDER NO. 541-2022

wsp
WSP Canada Inc.
1600 Buffalo Place
Winnipeg, MB R3T 6B8
t. 204.477.6650
f. 204.474.2864
www.wsp.com

DESIGNED BY: AB
CHECKED BY: KG
DRAWN BY: AB
APPROVED BY: SM

HOR. SCALE: 1:250
VERTICAL: 1:10

ISSUED FOR TENDER: 21/07/22
DETAILED DESIGN REVIEW: 19/07/22

NO. REVISIONS: 0
DATE: JULY 2022

ENGINEER'S SEAL
S.C. MINY
CONSULTANT ACAD. DWG. NO.
221-03150-00-07

Jul 21, 2022 - 6:30pm
P:\2022\221-03150-00 - 2022 TBO & Local Improvements\14.11 Highways_Bridges\14.11.06_Dwg\03_Work_Dwg\221-03150-00_Kavanagh St_Groux St_Plan_Profile.dwg - tab:541-2022_Drawing_221-03150-00-07-RB