

| MECHANICAL LEGEND | |
|-------------------|-----------------------------------|
| | EXISTING CONSTRUCTION TO REMAIN |
| | TO BE DEMOLISHED / RELOCATED |
| | NEW CONSTRUCTION |
| | DOMESTIC COLD WATER PIPING |
| | DOMESTIC HOT WATER PIPING |
| | DOMESTIC HOT WATER RETURN PIPING |
| | SANITARY PIPING BELOW SLAB |
| | VENT PIPING |
| | FAN SWITCH |
| | THERMOSTAT |
| | MOTORIZED DAMPER |
| | BACKDRAFT DAMPER |
| | BALANCE DAMPER |
| | VALVE |
| | CLEAN OUT |
| | VENT THROUGH ROOF |
| | TRAP PRIMER |
| | SUPPLY AIR GRILLE |
| | RETURN AIR GRILLE |
| | SUPPLY AIR DUCT UP/DOWN |
| | RETURN AIR DUCT UP/DOWN |
| | PLUMBING FIXTURE DESIGNATION |
| | EQUIPMENT DESIGNATION |
| | GRILLE TYPE (SEE GRILLE SCHEDULE) |
| | SIZE |
| | CFM / R/A |

| PLUMBING FIXTURE CONNECTION SIZES | | | | | |
|-----------------------------------|-----------------|------------|------------|-------------|-------|
| TAG | SANITARY In. | DCW In. | DHW In. | TRAP In. | NOTES |
| WC | 3 | 1 | - | INTERNAL | - |
| URINAL | 2 | 0.75 | - | INTERNAL | - |
| LAVATORY | 1.5 | 0.5 | 0.5 | 1.5 | - |
| SINK | 1.5 | 0.5 | 0.5 | 1.5 | - |
| SHOWER | 3 | 0.5 | 0.5 | 3 | - |

| GRILLE AND DIFFUSER SCHEDULE | | | | |
|------------------------------|--------------------------|--------------|-------|---------------------------------------|
| TAG | DESCRIPTION | MANUFACTURER | MODEL | REMARKS |
| R-1 | EGG CRATE CEILING RETURN | E.H. PRICE | 80 | REFER TO DRAWING FOR SIZE, COLOUR B12 |

NAILOR IS AN ACCEPTABLE MANUFACTURE OF THE SPECIFIED GRILLE (R-1) 1

| FAN SCHEDULE | | | | | | | | |
|--------------|--------------|-----------|---------------|-----------------|-----------|----------|----------------|----------------------|
| TAG | MANUFACTURER | MODEL | TYPE | AIR FLOW CFM | SP In. | MOTOR | | NOTE |
| | | | | | | VIC/P | NEC FLS (amps) | |
| F-1 | GREENHECK | SP-110-VG | CEILING MOUNT | 80 | 0.4 | 115/60/1 | 0.2 | WASHROOM EXHAUST FAN |
| F-2 | GREENHECK | SP-110-VG | CEILING MOUNT | 80 | 0.4 | 115/60/1 | 0.2 | WASHROOM EXHAUST FAN |

LOREN COOK IS AN ACCEPTABLE MANUFACTURE OF THE SPECIFIED EXHAUST FAN (F-1, F-2), VENTEX / CONTINENTAL FAN IS AN ACCEPTABLE MANUFACTURE OF THE SPECIFIED BACK DRAFT DAMPER 1

| EXPANSION TANK SCHEDULE | | | | | | | | |
|-------------------------|--------------|-------|--------------------------|-------------------------------|----------------------------------|-------------------------|-------|------|
| TAG | MANUFACTURER | MODEL | TOTAL VOLUME (US GAL) | PRE-CHARGE PRESSURE (PSIG) | MAX. OPERATING PRESSURE (PSI) | MAX. TEMPERATURE (F) | FLUID | NOTE |
| ET-1 | AMTROL | ST-5C | 2.1 | 40 | 150 | 200 | WATER | |

BELL & GOSSETT IS AN ACCEPTABLE MANUFACTURE OF THE SPECIFIED EXPANSION TANK (ET-1) 1

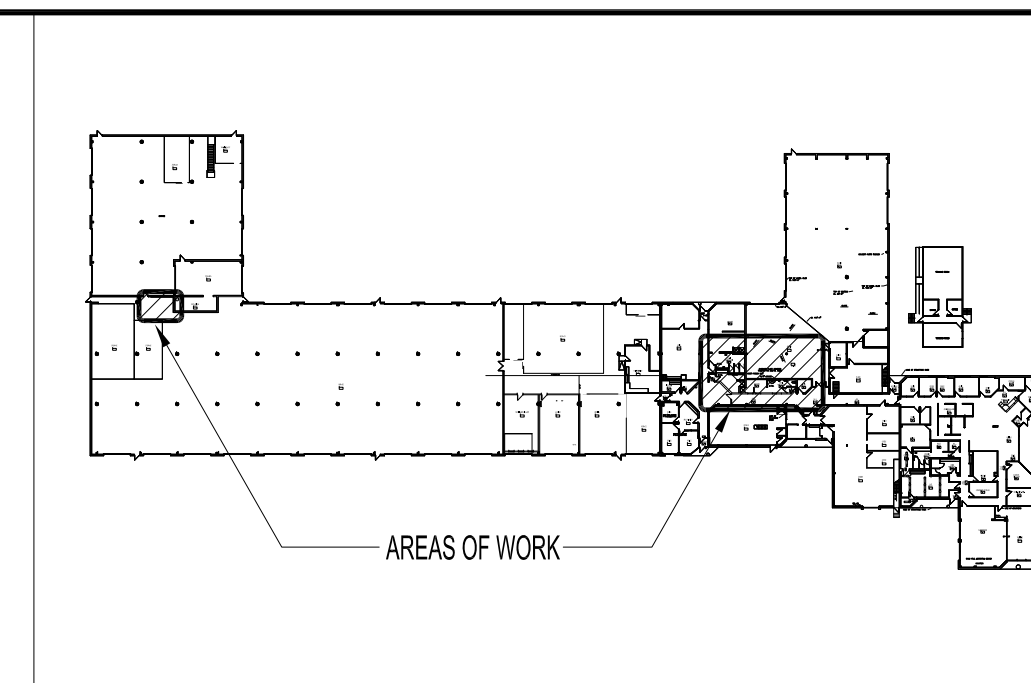

KEY PLAN
SCALE: NTS

NOTES:
THESE DRAWINGS SHALL NOT BE SCALED.
THIS DRAWING IS DIAGRAMMATIC ONLY. CONTRACTOR TO COORDINATE EXACT LOCATIONS OF AND ROUTING ON SITE WITH ALL NEW AND EXISTING SYSTEM.
THE CONTRACTOR SHALL VISIT THE SITE AND SATISFY ONESELF ALL DIMENSIONS, DATUM, AND DETAILED INFORMATION SHOWN ARE CORRECT.
THE CONTRACTOR IS TO REVIEW AND COORDINATE ALL ARCHITECTURAL, MECHANICAL AND ELECTRICAL DRAWINGS FOR ADDITIONAL OPENINGS THROUGH FLOORS, WALLS, AND CEILINGS FOR DUCT, PIPE & ELECTRICAL RISERS AND ALL OPENINGS NOT SHOWN ON DRAWINGS.

ALL OPENINGS THROUGH FIRE ASSEMBLIES ARE TO BE FIRE STOPPED AND SEALED WITH ULC APPROVED FIRE STOPPING TO MAINTAIN THE INTEGRITY OF THE FIRE SEPARATION, AND PROVIDE A SMOKE-TIGHT BARRIER.

ALL PRODUCTS AND MATERIALS TO BE USED AND INSTALLED SHALL CONFORM WITH MANUFACTURER'S SPECIFICATIONS & APPLICABLE CODES.

NEW DUCT SHALL BE CONSTRUCTED AS RECOMMENDED BY SMACNA.

THE CONTRACTOR SHALL BE RESPONSIBLE TO PATCH AND MAKE GOOD ALL EXISTING CONSTRUCTION AFFECTED BY THE REMOVAL OF ALL ITEMS FORMING THE PART OF THE RENOVATION WORK.

ELECTRICAL WIRING SHALL BE PERFORMED BY A QUALIFIED ELECTRICAL SUBTRADE.

| MECHANICAL DRAWING LIST | |
|-------------------------|---|
| SHEET No: | SHEET TITLE |
| M1 | KEY PLAN, MECHANICAL LEGEND AND SCHEDULES |
| M2 | PARTIAL MAIN FLOOR PLAN - PLUMBING DEMOLITION - PHASE 1 |
| M3 | PARTIAL MAIN FLOOR PLAN - HVAC DEMOLITION - PHASE 1 |
| M4 | PARTIAL MAIN FLOOR PLAN - PLUMBING RENOVATION - PHASE 1 |
| M5 | PARTIAL MAIN FLOOR PLAN - HVAC RENOVATION - PHASE 1 |
| M6 | PARTIAL MAIN FLOOR PLAN - MECHANICAL RENOVATION - PHASE 2 |
| M7 | MECHANICAL SPECIFICATIONS |

| | | | |
|-----|-------------------------|--------|--------------|
| 1 | ISSUED FOR ADDENDUM | JKREAG | AUG 23 2022 |
| 0 | ISSUED FOR CONSTRUCTION | EAG | JUNE 29 2022 |
| No. | REVISION/DESCRIPTION | BY | DATE |

SEAL



| DRAWN | EAG | CHECKED | DESIGNED | XTW | APPROVED |
|-------|------------|---------------|----------|-----|----------|
| DATE | 2022.04.01 | USER APPROVAL | | | |

Winnipeg THE CITY OF WINNIPEG
MUNICIPAL ACCOMMODATIONS DEPARTMENT
ASSET AND PROJECT MANAGEMENT DIVISION
3-65 GARRY STREET, R3C 4K4

PROJECT
FPS TRAINING, REPAIR AND
STORAGE FACILITY
WASHROOM RENOVATION
2546 McPHILLIPS ST.

SHEET TITLE
KEY PLAN, MECHANICAL LEGEND
AND SCHEDULES

| SCALE | PROJECT No: | SHEET No: |
|----------|-------------|-----------|
| AS SHOWN | 2021-085 | M1-R1 |