

PARTIAL MAIN FLOOR PLAN - MECHANICAL DEMOLITION
 SCALE: 3/8" = 1'-0"

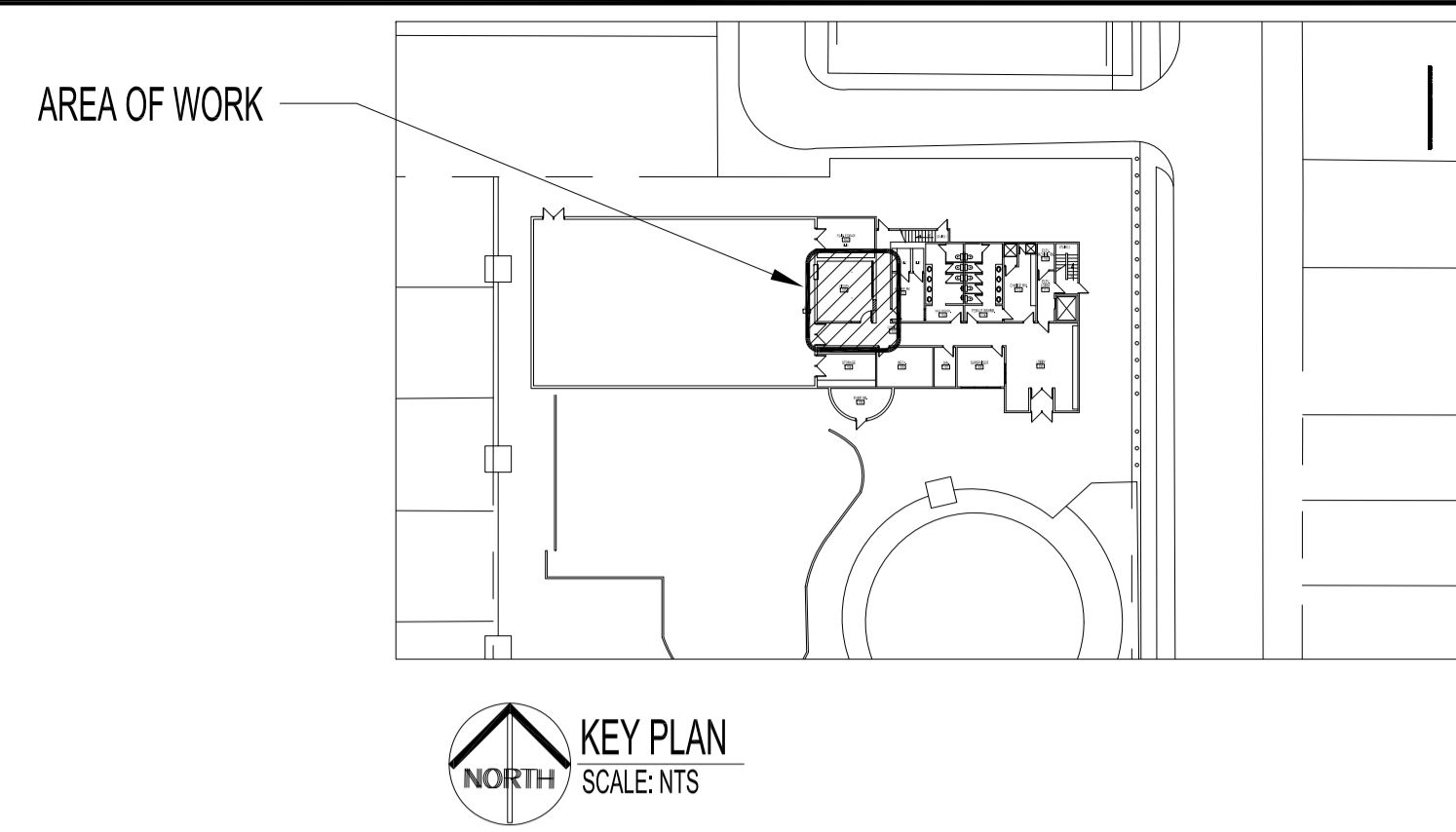

NOTES:

THESE DRAWINGS SHALL NOT BE SCALED.

THIS DRAWING IS DIAGRAMMATIC ONLY. CONTRACTOR TO COORDINATE EXACT LOCATIONS OF AND ROUTING ON SITE WITH ALL NEW AND EXISTING SYSTEM.

THE CONTRACTOR SHALL VISIT THE SITE AND SATISFY ONESELF ALL DIMENSIONS, DATUM, AND DETAILED INFORMATION SHOWN ARE CORRECT.

THE CONTRACTOR IS TO REVIEW AND COORDINATE ALL ARCHITECTURAL, MECHANICAL, ELECTRICAL AND STRUCTURAL DRAWINGS FOR ADDITIONAL OPENINGS THROUGH FLOORS, WALLS, AND CEILINGS FOR DUCT, PIPE & ELECTRICAL RISERS AND ALL OPENINGS NOT SHOWN ON DRAWINGS.

ALL OPENINGS THROUGH FIRE ASSEMBLIES ARE TO BE FIRE STOPPED AND SEALED WITH ULC APPROVED FIRE STOPPING TO MAINTAIN THE INTEGRITY OF THE FIRE SEPARATION, AND PROVIDE A SMOKE-TIGHT BARRIER.

ALL PRODUCTS AND MATERIALS TO BE USED AND INSTALLED SHALL CONFORM WITH MANUFACTURER'S SPECIFICATIONS & APPLICABLE CODES.

NEW DUCT SHALL BE CONSTRUCTED AS RECOMMENDED BY SMACNA.

THE CONTRACTOR SHALL BE RESPONSIBLE TO PATCH AND MAKE GOOD ALL EXISTING CONSTRUCTION AFFECTED BY THE REMOVAL OF ALL ITEMS FORMING THE PART OF THE RENOVATION WORK.

PLUMBING INSTALLATION SHALL CONFORM TO NATIONAL PLUMBING CODE OF CANADA.

THE CONTRACTOR IS RESPONSIBLE FOR INSTALLING RISERS, SWING JOINTS AND DEEP CUT ESCUTCHEONS AS REQUIRED.

ELECTRICAL WIRING SHALL BE PERFORMED BY A QUALIFIED ELECTRICAL SUBTRADE.

PROVIDE MILCOR ACCESS DOORS IN DRYWALL CEILINGS AND WALLS FOR ACCESS TO MECHANICAL EQUIPMENT. MINIMUM SIZE 24" X 18".

MECHANICAL DEMOLITION NOTES:

- 1 REMOVE EXISTING KITCHEN SINK AND TEMPORARILY CAP OFF THE PLUMBING LINES ON THE WALL, ON THE FLOOR OR ON THE CEILING.
- 2 REMOVE EXISTING RETURN AIR GRILLE.
- 3 REMOVE EXISTING SUPPLY AIR DIFFUSER. TEMPORARILY CAP OFF DUCT OPENING.
- 4 REMOVE EXISTING RANGE HOOD AND ASSOCIATED DUCTWORK. REPAIR ROOF OPENING.
- 5 REMOVE EXISTING DISHWASHER AND DISCONNECT THE DRAIN AND HOT WATER LINE.
- 6 EXISTING DUCTWORK TO REMAIN.
- 7 EXISTING PLUMBING VENT TO REMAIN.
- 8 EXISTING DOMESTIC HOT WATER, COLD WATER LINE IN THE CRAWLSPACE TO REMAIN.
- 9 EXISTING SANITARY LINE IN THE CRAWLSPACE TO REMAIN.
- 10 EXISTING 14" x 14" AIR TRANSFER OPENING TO REMAIN.
- 11 EXISTING SUPPLY AIR DIFFUSER TO REMAIN.

0	ISSUED FOR CONSTRUCTION	EAG	SEPT 09 2022
00	ISSUED FOR 30% CLIENT REVIEW	EAG	MAY 20 2022
No.	REVISION/DESCRIPTION	BY	DATE



DRAWN	EAG	CHECKED	DESIGNED	XWU	APPROVED
DATE	2022.05.02	USER APPROVAL			

THE CITY OF WINNIPEG
 PLANNING, PROPERTY AND
 DEVELOPMENT DEPARTMENT
 MUNICIPAL ACCOMMODATIONS DIVISION
 3-65 GARRY STREET, R3C 4K4

PROJECT
 MAGNUS ELIASON RECREATION CENTRE
 KITCHEN RENOVATION
 430 LANGSIDE ST.

SHEET TITLE
 PARTIAL MAIN FLOOR PLAN
 MECHANICAL DEMOLITION

SCALE	PROJECT No:	SHEET No:
AS SHOWN	2019-077	M2