

NOTE: CHAINAGES SHOWN ARE ALONG E. R. OF SPENCE ST

SPENCE STREET

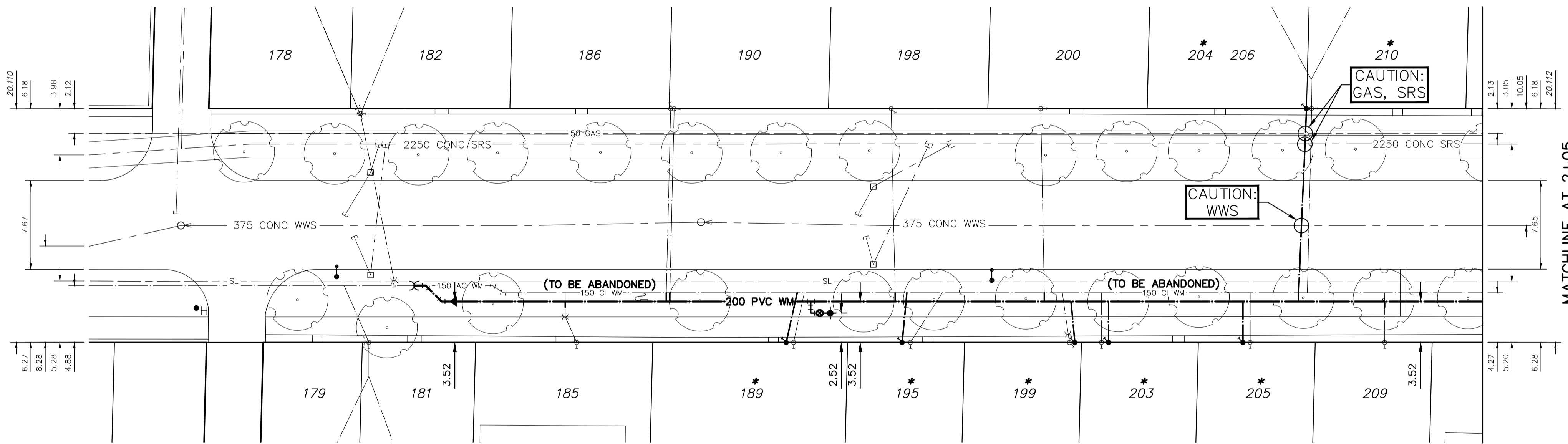

WATER SERVICE INFORMATION

ADDRESS	SIZE (mm) MATERIAL (STREET)	SIZE (mm) MATERIAL (PROP.)	SHORT & LONG MEASUREMENT	CORP. LOCATION	REMARKS
185 SPENCE ST	25	25	6.5m SNLL	1.0m S OF S/C	RECONNECT SERVICE
186 SPENCE ST	20	20	223>NNL BROADWAY		RECONNECT SERVICE
RESIDENTIAL	CU	CU	8.5 HHL HSE	OPP S/C	
189 SPENCE ST	12	20	245.5>NNL BROADWAY		RENEW SERVICE
RESIDENTIAL	CU	CU	OPP NL FRONT DOOR	3 N OF S/C	
190 SPENCE ST	20	12	282>NNL BROADWAY		RECONNECT SERVICE
RESIDENTIAL	CU	LEAD	UNKN	OPP S/C	
198 SPENCE ST	12	20	246.5>NNL BROADWAY		RECONNECT SERVICE
RESIDENTIAL	CU	LEAD	11 SNL HSE	9 N OF S/C	
198 SPENCE ST	20	20	315>NNL BROADWAY		RECONNECT SERVICE
RESIDENTIAL	CU	CU	5.3m NSLL	0.3m N OF S/C	
199 SPENCE ST	12	12	UNKN		RENEW SERVICE
RESIDENTIAL	CU	UNKN	1.0m SNLL	UNKN	
200 SPENCE ST	20	20	OPP SL HSE	1 N OF S/C	RECONNECT SERVICE
RESIDENTIAL	CU	UNKN	350>NNL BROADWAY		RECONNECT SERVICE
203 SPENCE ST	12	12	6' NSL HSE		RENEW SERVICE
RESIDENTIAL	LEAD	LEAD	369>NNL BROADWAY	OPP S/C	
204 SPENCE ST	16	12	15' NSL HSE		RENEW SERVICE
RESIDENTIAL	LEAD	LEAD	426.5>NNL BROADWAY	OPP S/C	DOUBLE SERVICE W/ 210 SPENCE
205 SPENCE ST	12	12	OPP CENTRE OF WINDOW	OPP S/C	RENEW SERVICE
RESIDENTIAL	LEAD	LEAD	411>NNL BROADWAY		
209 SPENCE ST	20	12	10.5 NSL HSE	OPP S/C	RECONNECT SERVICE
RESIDENTIAL	CU	LEAD	449>NNL BROADWAY		
210 SPENCE ST	16	XXX	15' NSL HSE	OPP S/C	RENEW SERVICE
RESIDENTIAL	LEAD	XXX	426.5>NNL BROADWAY		DOUBLE SERVICE W/ 204 SPENCE

\*SERVICES TO BE RENEWED TO R. ALL OTHERS TO BE RECONNECTED

NOTE: ALL VALVES TO BE INSTALLED COUNTERCLOCKWISE TO CLOSE

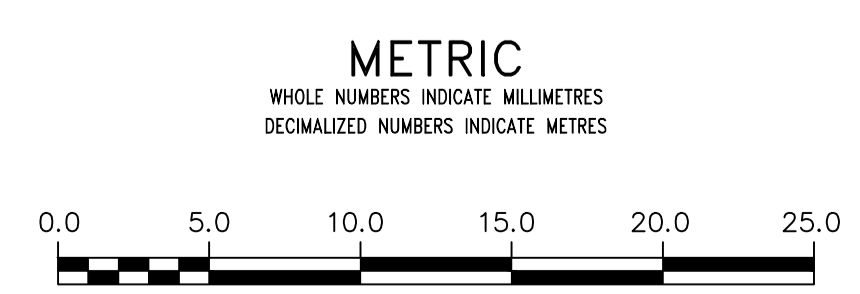

**WARNING**  
IF POWER EQUIPMENT OR EXPLOSIVES ARE TO BE USED FOR EXCAVATION ON THIS PROJECT THE CONTRACTOR MUST:  
1) NOTIFY THE GAS COMPANY OF THE PROPOSED LOCATION OF EXCAVATION.  
2) TAKE PRECAUTION TO AVOID DAMAGE TO GAS COMPANY INSTALLATIONS.  
SEE PROVINCIAL REGULATION 21072 FOR DETAILS

**LOCATION APPROVED UNDERGROUND STRUCTURES**  
SUPV. U/G STRUCTURES COMMITTEE DATE  
NOTE:  
LOCATION OF UNDERGROUND STRUCTURES AS SHOWN ARE BASED ON THE BEST INFORMATION AVAILABLE BUT NO GUARANTEE IS GIVEN THAT ALL EXISTING UTILITIES ARE SHOWN OR THAT THE GIVEN LOCATIONS ARE EXACT. CONFIRMATION OF EXISTENCE AND EXACT LOCATION OF ALL SERVICES MUST BE OBTAINED FROM THE INDIVIDUAL UTILITIES BEFORE PROCEEDING WITH CONSTRUCTION.

B.M. ELEV.	NO.	REVISIONS	DATE	BY
	C	ISSUED FOR TENDER	22/05/12	R.H.
	B	DETAILED DESIGN SUBMISSION	22/05/03	R.H.
	A	PRELIMINARY DESIGN SUBMISSION	22/04/22	R.H.

**wsp**  
1600 Buffalo Place  
Winnipeg, Manitoba  
R3T 6B8 Canada  
Phone: 204-477-6650  
Fax: 204-474-2864  
wsp.com

DESIGNED BY	K.G.	CHECKED BY	S.M.
DRAWN BY	K.G.	APPROVED BY	S.M.
DATE	2022 05 12	RELEASED FOR CONSTRUCTION	

ENGINEER'S SEAL  
CONSULTANT DRAWING NUMBER  
221-02275-00-08

**THE CITY OF WINNIPEG**  
WATER AND WASTE DEPARTMENT  
ENGINEERING DIVISION

2022 WATER MAIN RENEWALS – CONTRACT 9

SPENCE STREET  
52.2>NNL BROADWAY  
145.2>NNL BROADWAY

SHEET 08 OF 10  
CITY DRAWING NUMBER  
D-16326

**ENGINEERS GEOSCIENTISTS MANITOBA**  
Certificate of Authorization  
WSP Canada Inc.  
No. 5750