

MATCHLINE STA 3+37

MATCHLINE STA 4+60

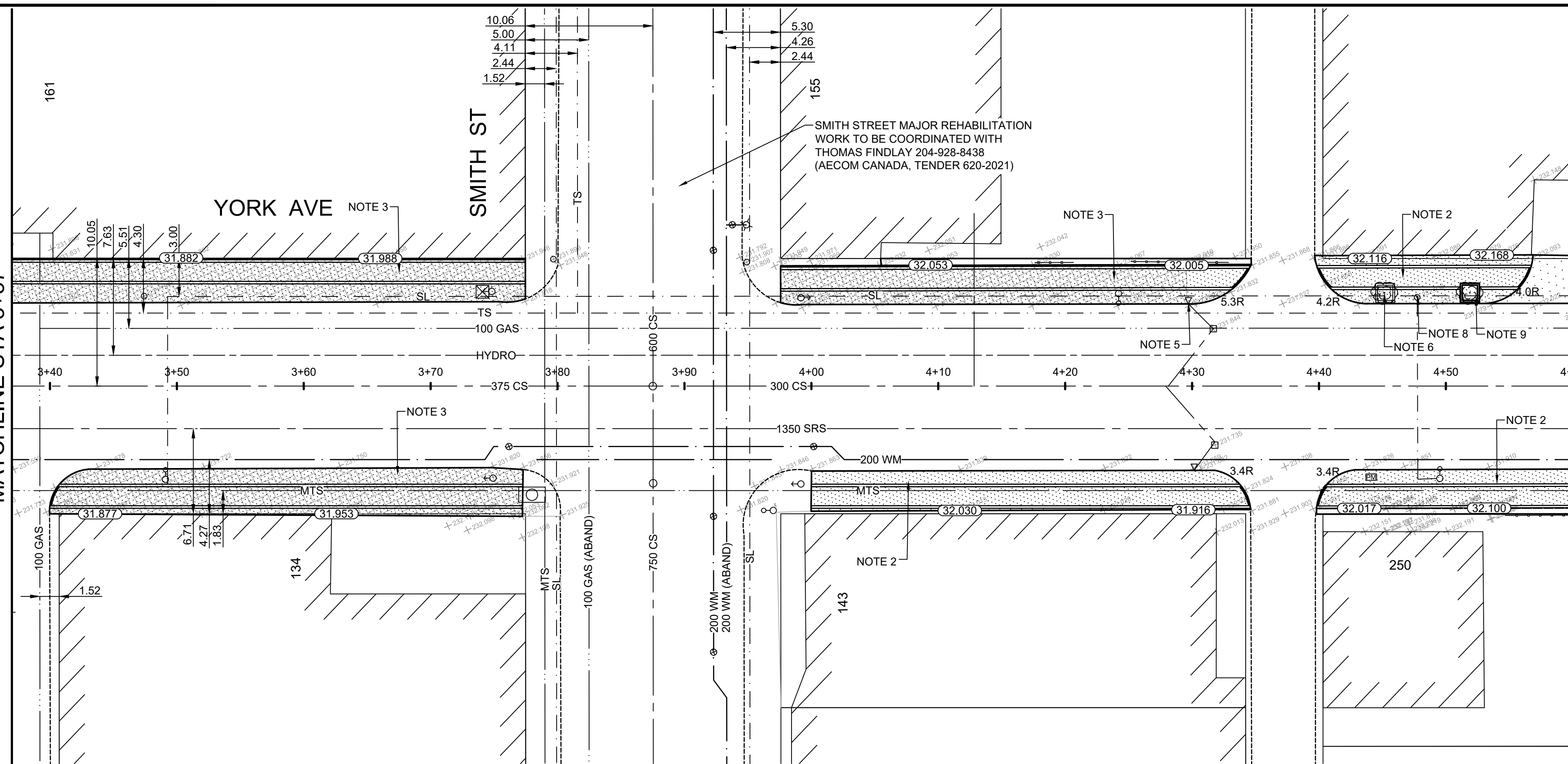

MATCHLINE STA 4+60

MATCHLINE STA 5+85

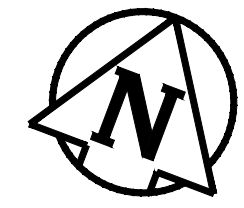
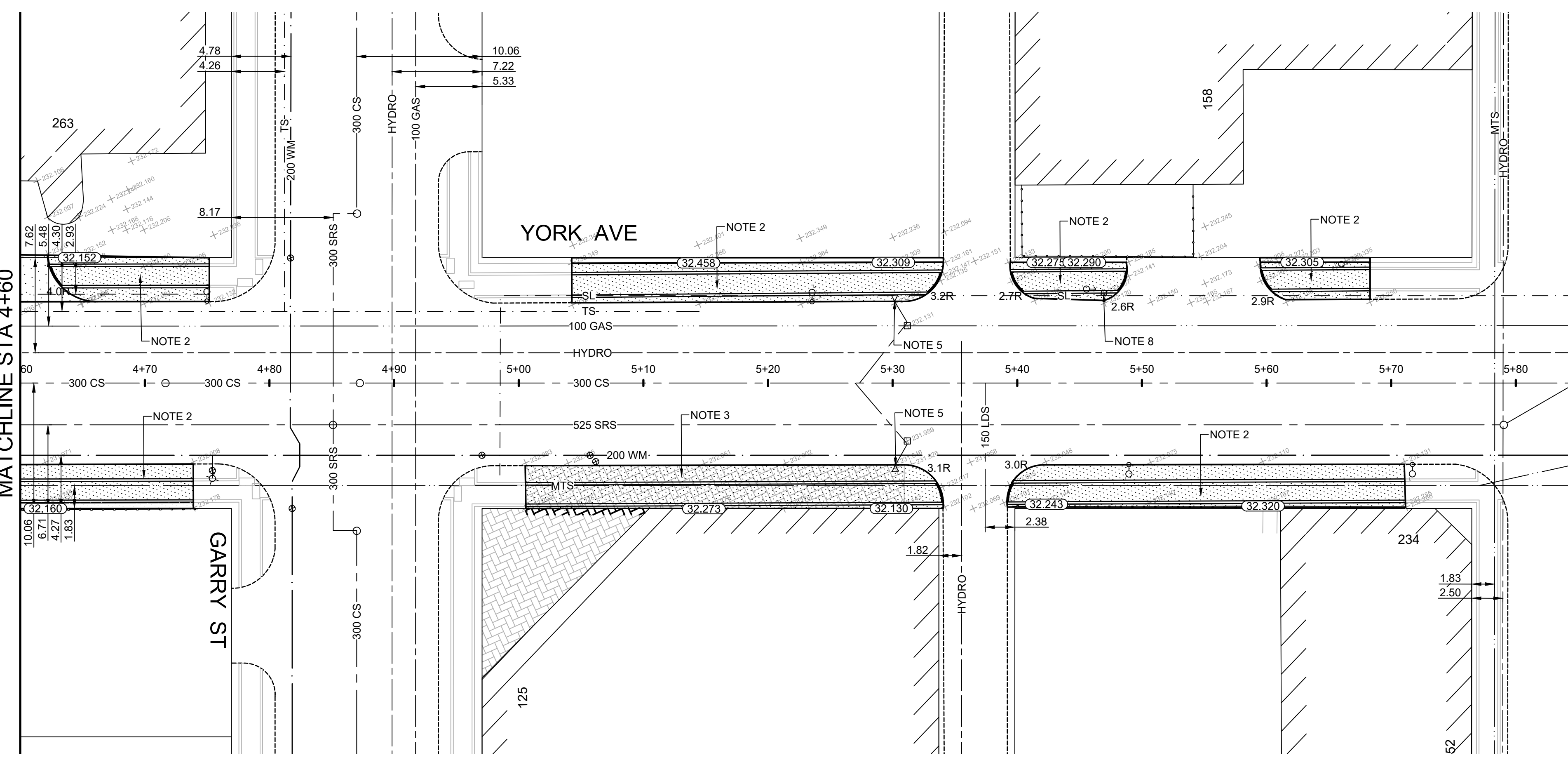

**CONSTRUCTION NOTES**

1. INSTALL DETECTABLE WARNING SURFACE TILES AS PER SD-229AA
2. REMOVE EXISTING MONOLITHIC CURB AND SIDEWALK AND CONSTRUCT NEW MONOLITHIC CURB AND SIDEWALK WITH BLOCK OUTS (SEE BLOCK OUT DETAIL)
3. REMOVE EXISTING INTERLOCKING PAVING STONE SIDEWALK AND CURB AND CONSTRUCT NEW MONOLITHIC CURB AND SIDEWALK WITH BLOCK OUTS (SEE BLOCK OUT DETAIL)
4. REMOVE EXISTING CURB, INTERLOCKING PAVING STONE AND CONCRETE SIDEWALK AND CONSTRUCT NEW MONOLITHIC CURB AND SIDEWALK WITH BLOCK OUTS (SEE BLOCK OUT DETAIL)
5. ADJUST EXISTING CURB INLET AND INSTALL NEW INLET BOX
6. REMOVE EXISTING TREE WELL AND REMOVE TREE AS PER CW 3010-R4
7. ADJUST TRAFFIC SIGNAL SERVICE BOX FRAME AS PER CW 3210-R8
8. INSTALL NEW TRAFFIC SIGNALS SERVICE BOX BY OTHERS
9. REMOVE EXISTING TREE WELL AND CONSTRUCT REINFORCED TREE WELL CURB AND INSTALL CAST IRON GRATE AS PER E11

**GENERAL NOTES**

- A. PAVEMENT DIMENSIONS ARE TO BACK OF CURB
- B. ALL CURB RADII UNDER 15.0m SHALL BE MODIFIED
- C. ADD 200.000m TO ALL DESIGN ELEVATION TO OBTAIN GEODETIC ELEVATIONS
- D. CURB REPLACEMENT AS DIRECTED BY CONTRACT ADMINISTRATOR
- E. CONTRACTOR TO CONFIRM THE LOCATION OF ALL UTILITIES/SERVICES IN THE FIELD PRIOR TO CONSTRUCTION
- F. USE EXTREME CAUTION WHEN WORKING ABOVE UTILITY VAULTS
- G. CONTRACTOR TO TAKE PRECAUTIONARY STEPS TO PROTECT EXISTING TREES WITHIN THE CONSTRUCTION LIMITS AS PER CW 1140
- H. CURB REPLACEMENT AS DIRECTED BY CONTRACT ADMINISTRATOR
- I. BLOCK OUT ALIGNMENT TO BE DIRECTED BY CONTRACT ADMINISTRATOR
- J. ADJUST ALL CURB STOPS AND WATER VALVES TO GRADE

**PRELIMINARY**  
NOT TO BE USED FOR  
CONSTRUCTION

**METRIC**  
WHOLE NUMBERS INDICATE MILLIMETERS  
DECIMALIZED NUMBERS INDICATE METERS  
TENDER NO. 333-2022

| EXISTING | LEGEND - PLAN       | PROPOSED | EXISTING | LEGEND - PLAN      | PROPOSED | EXISTING | LEGEND - PROFILE  | PROPOSED |
|----------|---------------------|----------|----------|--------------------|----------|----------|-------------------|----------|
| ⊕        | HYDRANT             | ◆        | —        | LDS/WWS            | —        | ⊕        | UTILITY MAN HOLE  | —        |
| ⊗        | VALVE               | ◆        | —        | WATERMAIN          | —        | ⊕        | WOOD FENCE        | —        |
| ⊙        | CURB STOP           | ◆        | —        | GAS                | —        | ⊕        | CONCRETE FENCE    | —        |
| ⊚        | MANHOLE             | ●        | —        | TRAFFIC SIGNALS    | —        | ⊕        | SIGNALS PIT       | —        |
| ⊛        | CATCH BASIN         | ●        | —        | HYDRO/STREET LIGHT | —        | ⊕        | BRICK             | —        |
| △        | CURB INLET          | ▲        | —        | MTS/SHAW           | —        | ⊕        | CONCRETE          | —        |
| ⊖        | HYDRO POLE          | ●        | —        | CURB RENEWAL       | —        | ⊕        | CONCRETE SIDEWALK | —        |
| ⊙        | LIGHT STANDARD      | ●        | —        | RAMP CURB          | —        | ⊕        | ASPHALT           | —        |
| ⊕        | TRAFFIC SIGNAL POLE | ●        | —        | ELEVATIONS         | (31.000) |          |                   |          |
| ⊕        | SURVEY BAR          | ◆        | —        | TREE               | —        |          |                   |          |
| ⊕        | GEODETIC BENCH MARK | ◆        | —        | UTILITY BOX        | —        |          |                   |          |

| LOCATION APPROVED  | B.M. ELEV. |
|--|------------|
| UNDERGROUND STRUCTURES   |            |
| SUPR. LIG. STRUCTURES COMMITTEE  |            |
| DATE   |            |
| NOTE:  |            |
| LOCATION OF UNDERGROUND STRUCTURES AS SHOWN ARE BASED ON THE BEST INFORMATION AVAILABLE. BUT NO GUARANTEE IS GIVEN THAT ALL EXISTING UTILITIES ARE SHOWN OR THAT THE GIVEN LOCATIONS ARE EXACT. CONFIRMATION OF EXISTENCE AND EXACT LOCATION OF ALL SERVICES MUST BE OBTAINED FROM THE INDIVIDUAL UTILITIES BEFORE PROCEEDING WITH CONSTRUCTION. |            |
| NO.  | REVISIONS  |
|  | DATE       |
|  | BY         |

| ENGINEERING DIVISION<br>TECHNOLOGY SERVICES BRANCH<br>106 - 1155 PACIFIC AVE |            |             |      |
|--|------------|-------------|------|
| DESIGNED BY  | C.W.       | CHECKED BY  | R.W. |
| DRAWN BY   | C.W.       | APPROVED BY |      |
| HOR. SCALE:  | 1 : 250    |             |      |
| VERTICAL:  | 1 : 10     |             |      |
| DATE   | 2022/06/13 |             |      |



**THE CITY OF WINNIPEG**  
PUBLIC WORKS DEPARTMENT

**YORK AVENUE**  
FROM CARLTON STREET TO MAIN STREET  
2022 DOWNTOWN SIDEWALK RENEWALS AND ASSOCIATED WORKS  
FROM STA. 3+37 TO STA. 5+85

CITY DRAWING NUMBER  
SE-22-127  
SHEET 2 OF 3  
**5**