

CONSTRUCTION NOTES:

PROJECT SCOPE

1. INSTALL CONDUIT, BASES AND PITS AS SHOWN.
2. INSTALL SERVICE AND GROUND ROD ON WOOD POLE #5 AS SHOWN. INSTALL MAST AND DISCONNECT ON XX QUADRANT. INSTALL WEATHER HEAD 150mm LOWER THAN THE LOWEST HYDRO WIRE. TOTAL LENGTH OF SERVICE CABLE: 25m.
3. INSTALL EQUIPMENT AS SHOWN.
4. CROSSING TIME FOR NORTH CROSSWALK: 15 SECONDS, SOUTH CROSSWALK: 15 SECONDS.

PROJECT COORDINATION

1. COORDINATE WORK WITH RYAN CUNNINGHAM, (204) 928-8377.
2. COORDINATE HYDRO SERVICE INSTALLATION WITH (HYDRO DESIGNER), (204) XXX-XXXX. RE: JUTA PERMIT No. BXXXXX

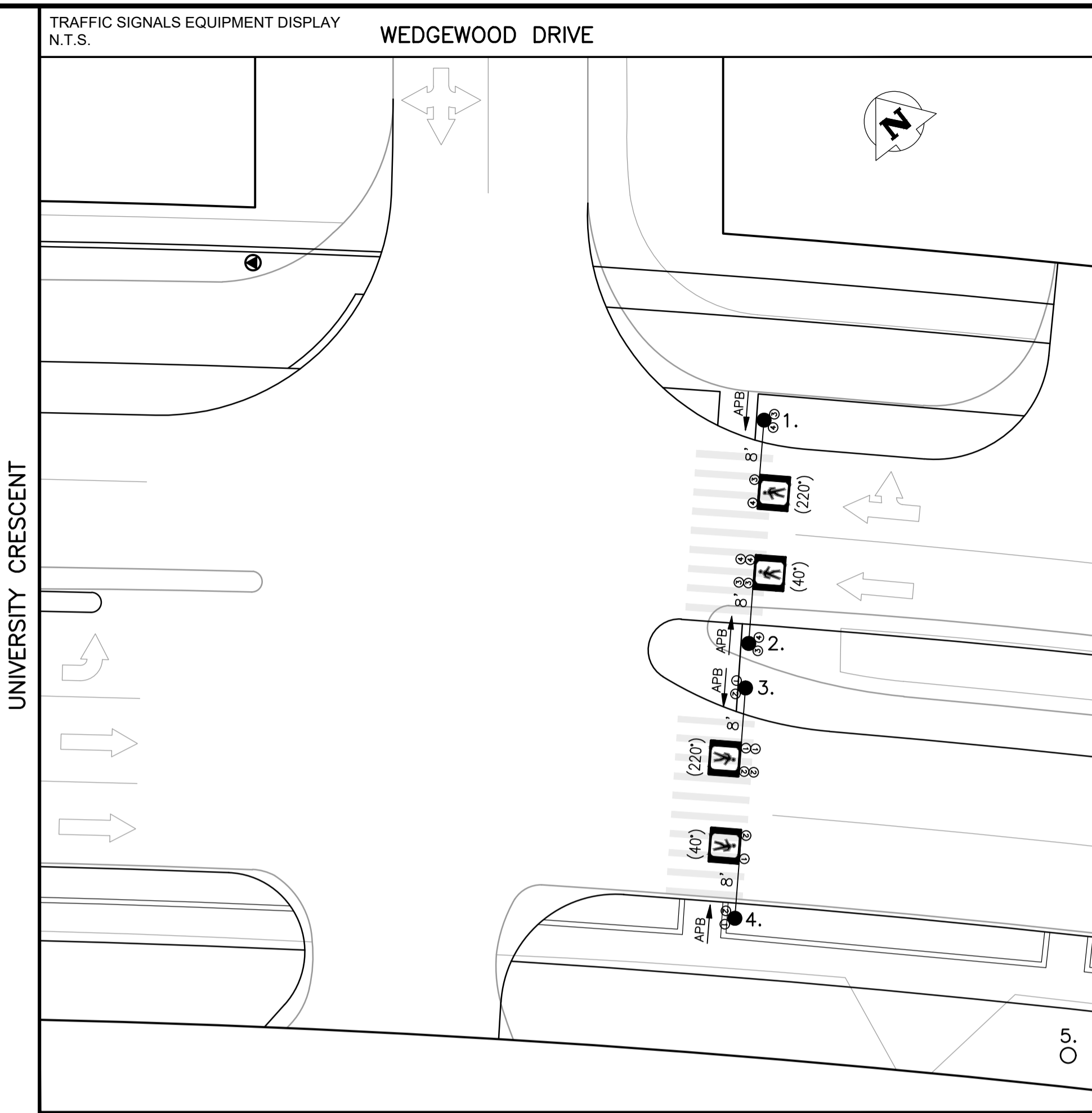
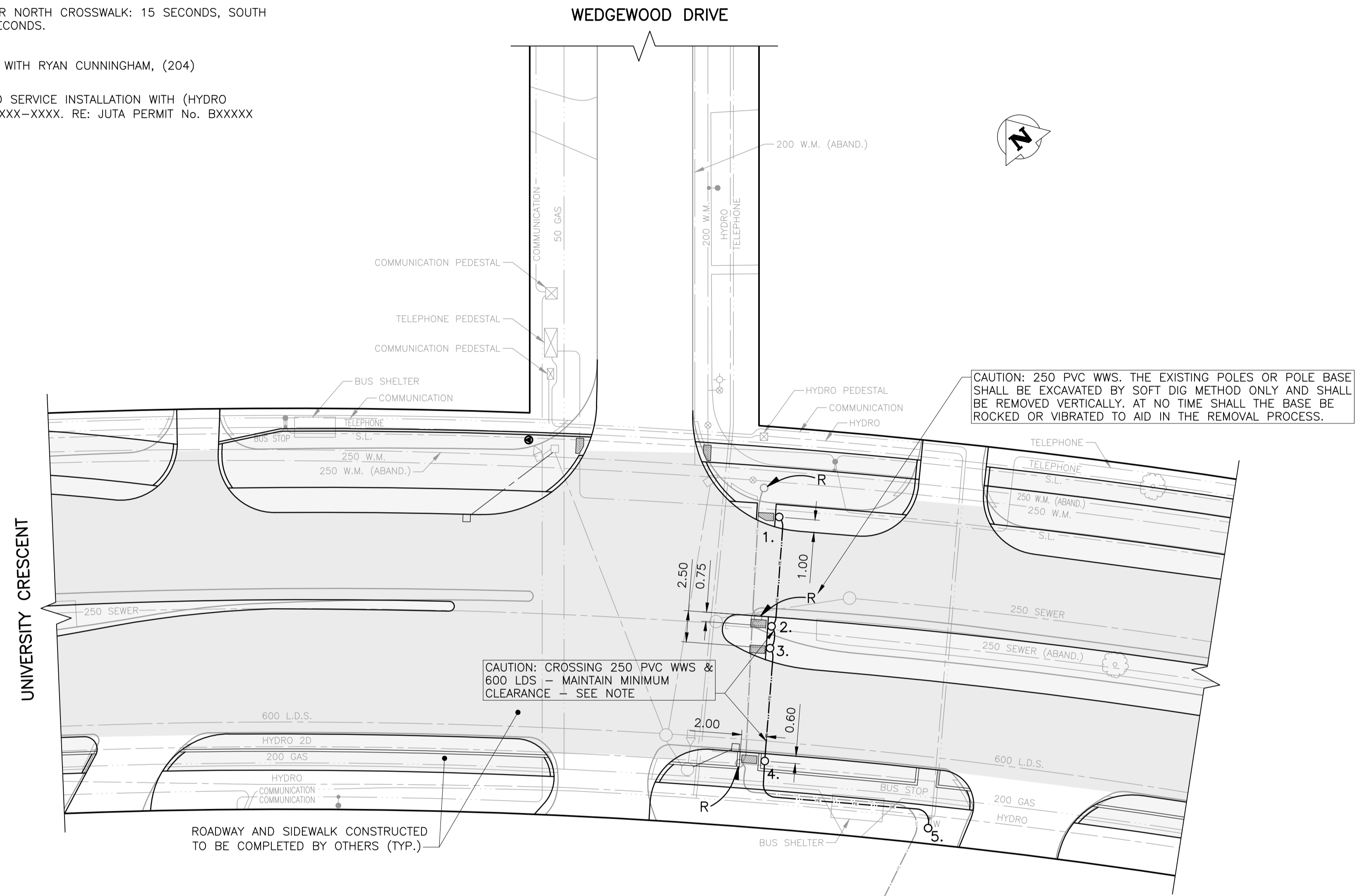

EQUIPMENT DISPLAY LEGEND

EXISTING	PROPOSED (AS SHOWN BELOW)	EXISTING	PROPOSED (AS SHOWN BELOW)
PEDESTRIAN HEAD WITH PCS	VEHICLE DETECTION AREA	TRAFFIC SIGNAL HEAD	LOW ARM (SHOWN FROM CENTRE) HIGH ARM (SHOWN FROM SIDE)
PEDESTRIAN CORRIDOR BOX (CIRCUIT 10234)	TRAFFIC SIGNAL POLE	APS SINGLE DIRECTION	PUSH BUTTON & DIRECTION (APB = ALIDABLE PB)
RRFB (PHASE 'A' OR 'B')	WOOD POST	APS DUAL DIRECTION (SEPARATE STRANDED)	ELECTRONIC DISPLAY
			RED FLASHER
			AMBER FLASHER
			CAMERA

NO.	EQUIPMENT LIST	ARM	BASE	B.B.	NO.	EQUIPMENT LIST	ARM	BASE	B.B.
1.	CANTILEVER	8'	OD	DC					
2.	CANTILEVER	8'	OD	DC					
3.	CANTILEVER	8'	OD	DC					
4.	CANTILEVER	8'	G	GC					
5.	HYDRO WOOD #XXXXXX SERVICE:								

TRAFFIC SIGNALS UNDERGROUND LEGEND

EXISTING	PROPOSED (AS SHOWN BELOW)	DISCONNECTED (LOOPS ONLY)
1 1/2" PE CONDUIT	POLE BASE	
2" PE CONDUIT	WOOD POST	
4" PVC CONDUIT	CONTROLLER BASE	
AERIAL / BURIED CABLE	PEDESTAL BASE	
CONDUIT STUB	TERMINAL BASE	
BREAK-IN	SERVICE BOX (PIT)	
SPLICE	24" PRECAST PIT	
SAW-CUT LOOPS	30" PRECAST PIT	
PERFORMED LOOPS	36" PRECAST PIT	
	REMOVAL	

SIGNAL BASE BOLT SQUARE TYPES

BOLT SQUARE (B.S.)	DIA.
TYPE "A" - 8 1/8"	
TYPE "B" - 6 3/4"	
TYPE "C" - 8 1/8" SCREW TYPE	
TYPE "D" - 12 3/4", 1 1/4" DIA. BOLTS, 24" DIA.	
TYPE "OD" - 12 3/4", 1 1/4" DIA. BOLTS, 28" DIA.	
TYPE "POD" - 12 3/4", PRECAST, 1 1/4" DIA. BOLTS, 28" DIA.	
TYPE "E" - 9 9/16" SCREW TYPE	
TYPE "F" - 9 9/16"	
TYPE "G" - 8 1/8", 1 1/4" DIA. BOLTS, 89mm PROJ.	
TYPE "GS" - 8 1/8", 1 1/4" DIA. BOLTS, 76mm PROJ.	
TYPE "PG" - 8 1/8", PRECAST, 1 1/4" DIA. BOLTS	
TYPE "H" - 9 7/8" SCREW TYPE	
TYPE "I" - 7 3/4"	
TYPE "J" - 10 5/8", 1 1/4" DIA. BOLTS	
TYPE "K" - 10 5/8", PRECAST, 1 1/4" DIA. BOLTS	
TYPE "L" - 6", 5/8" DIA. BOLTS	
TYPE "PM" - 8 1/8", PRECAST, 5/8" DIA. BOLTS	

PLAN VIEW: UNDERGROUND CONSTRUCTION
1:250

UGS REVIEW NOTES

GENERAL:

1. INSTALL NEW CONDUITS MINIMUM 1.0m BELOW EXISTING GRADE
2. EXCAVATION PERMITS REQUIRED PRIOR TO CONSTRUCTION
3. CONTACT 'CLICK' BEFORE YOU DIG MANTOBA AT ClickBeforeYouDigMB.com THREE FULL WORKING DAYS PRIOR TO CONSTRUCTION FOR LOCATION OF EXISTING WATER, WASTEWATER AND LAND DRAINAGE UTILITIES.

WATER AND WASTE DEPARTMENT:

A MINIMUM CLEARANCE OF 1.0 METER MUST BE PROVIDED BETWEEN THE UNDERSIDE OF ANY EXISTING WATERMAIN OR SEWERMAIN AND THE TOP OF THE PROPOSED WORKS. THIS INSTALLATION BY TRENCHLESS METHOD ONLY.

A MINIMUM CLEARANCE OF 0.5 METERS MUST BE PROVIDED BETWEEN THE UNDERSIDE OF THE PROPOSED WORKS AND THE TOP OF ANY EXISTING WATERMAIN OR SEWERMAIN.

A MINIMUM LATERAL CLEARANCE OF 2.0 METERS MUST BE PROVIDED BETWEEN ANY EXISTING WATERMAIN OR SEWERMAIN PIPE AND THE PROPOSED WORKS.

A SHAFT MUST BE EXCAVATED BY SOFT DIG METHODS 4.0 METERS FROM THE CENTRELINE OF THE EXISTING WATERMAIN OR SEWERMAIN PIPE TO CONFIRM THE ALIGNMENT AND ELEVATION OF THE DRILLING ROD BEFORE IT CROSSES OVER OR UNDER THE EXISTING WATERMAIN OR SEWERMAIN PIPE. THIS CONFIRMATION MUST BE WITNESSED BY A CITY REPRESENTATIVE.

EXISTING	LEGEND	PROPOSED	EXISTING	LEGEND	PROPOSED	EXISTING	LEGEND	PROPOSED
150 W.M.	WATERMAIN	150 W.M.	PROPERTY LINE	TELEPHONE	TELEPHONE	TELEPHONE	TELEPHONE	TELEPHONE
HYDRANT	HYDRANT	ROADWAY	ROADWAY	COMMUNICATION	COMMUNICATION	COMMUNICATION	COMMUNICATION	COMMUNICATION
VALVE	VALVE	SIDEWALK	SIDEWALK	WOOD POLE	WOOD POLE	WOOD POLE	WOOD POLE	WOOD POLE
300 SEWER	SEWER	CURB & CURB RAMP	CURB & CURB RAMP	STREET LIGHT	STREET LIGHT	STREET LIGHT	STREET LIGHT	STREET LIGHT
MANHOLE	MANHOLE	WARNING TILE	WARNING TILE	BANNER POLE	BANNER POLE	BANNER POLE	BANNER POLE	BANNER POLE
CATCH BASIN	CATCH BASIN	SLOPE	SLOPE	RAILWAY POLE	RAILWAY POLE	RAILWAY POLE	RAILWAY POLE	RAILWAY POLE
CURB INLET	CURB INLET	CULVERT	CULVERT	GUY-WIRE	GUY-WIRE	GUY-WIRE	GUY-WIRE	GUY-WIRE
HYDRO	HYDRO	BUILDING	BUILDING	FENCE	FENCE	FENCE	FENCE	FENCE
100 GAS	GAS	TREE	TREE	GUARDRAIL	GUARDRAIL	GUARDRAIL	GUARDRAIL	GUARDRAIL

UNDERGROUND STRUCTURES

UNDERGROUND STRUCTURES ID	DATE (YYYYMMDD)
2022383	2022/05/10
2022W0379	

WATER & WASTE REVIEW ID

NOTE: LOCATIONS OF UNDERGROUND STRUCTURES AS SHOWN ARE BASED ON THE BEST INFORMATION AVAILABLE. BUT NO GUARANTEE IS GIVEN THAT ALL EXISTING UTILITIES ARE SHOWN OR THAT THE GIVEN LOCATIONS ARE EXACT. CONFIRMATION OF EXISTENCE AND EXACT LOCATION OF ALL SERVICES MUST BE OBTAINED FROM THE INDIVIDUAL UTILITIES BEFORE PROCEEDING WITH CONSTRUCTION.

CONSTRUCTION REVISIONS

NO.	REVISION	DATE (YYYYMMDD)	BY	APPROVED BY
1	ISSUED FOR CONSTRUCTION			
0	ISSUED FOR UGS APPROVAL	2022/04/12	J.S.	

ACCOUNTS:
PENDING

DESIGNED BY: J.S.

DRAWN BY: J.S.

CHECKED BY: C.H./L.G.

LIABILITY DISCLAIMER NOTICE:
THE DIGITAL INFORMATION PROVIDED FOR YOUR CONVENIENCE HEREIN IS FOR USE AT YOUR OWN RISK. THE CITY OF WINNIPEG, PUBLIC WORKS DEPARTMENT, SHALL ASSUME NO RESPONSIBILITY FOR THE INFORMATION AND IT SHOULD NOT BE CONSTRUED AS ASSULT INFORMATION. THE INFORMATION SHOULD BE USED FOR PLANNING PURPOSES ONLY AND SHOULD BE VERIFIED BY SURVEY. THE DEPARTMENT SHALL NOT IN ANY WAY SUFFER ANY LIABILITY WHATSOEVER TO ANY PARTY FOR INJURY, LOSS OR DAMAGES SUFFERED BY SUCH PARTY ARISING FROM THEIR USE OF, OR RELIANCE UPON, THIS INFORMATION.

ENGINEER'S SEAL:

PRELIMINARY

NOT FOR CONSTRUCTION

THE CITY OF WINNIPEG
PUBLIC WORKS DEPARTMENT
TRANSPORTATION DIVISION

PEDESTRIAN CORRIDOR
UNIVERSITY CRES. & WEDGEWOOD DR.

UNITS: ALL DIMENSIONS ARE IN METERS UNLESS OTHERWISE NOTED

DRAWING NUMBER: S-1524