

TYPICAL CROSS SECTION
NTS

| CATCH BASIN TABLE | | | | | | | | | | | |
|-------------------|-----------|-------|---------|---------|---------|---------|------------|----------|-----------------|------|--------|
| ITEM | RIM ELEV. | Sta | INVERT | | | | CONNECTION | LEAD | FLOW RESTRICTOR | | |
| | | | EAST | WEST | NORTH | SOUTH | | | | | |
| CB04 | 234.340 | 1+283 | 233.340 | 233.340 | 233.290 | | CB | 9.3m | | | |
| CB05 | 234.340 | 1+283 | 233.340 | 233.340 | | 232.890 | 232.690 | 229.795± | 1200 CS | 2.1m | 150mmØ |

REFERENCE NOTES:

- PAVEMENT DIMENSIONS ARE TO BACK OF CURB
- BASELINE IS CENTRE LINE ROADWAY
- PROPERTY LINES OBTAINED FROM CITY OF WINNIPEG L.B.I.S., AND NO SCALE FACTOR WAS APPLIED
- REFER TO AECOM FIELD BOOK NO. 5111

CONSTRUCTION NOTES:

- REMOVE EXISTING PAVEMENT AND CONSTRUCT NEW 250mm PLAIN DOWELLED CONCRETE PAVEMENT
- REMOVE EXISTING PAVEMENT AND CONSTRUCT NEW 200mm REINFORCED CONCRETE PAVEMENT
- CONSTRUCT NEW ASPHALT MULTI-USE PATHWAY. REFER TO TYPICAL CROSS SECTION FOR DETAILS
- REMOVE EXISTING ASPHALT PAVEMENT AND PLACE NEW ASPHALT PAVEMENT TYPE 1A
- CONSTRUCT NEW MODIFIED BARRIER CURB (180mm HT. INTEGRAL)
- CONSTRUCT NEW BARRIER CURB (180mm HT., INTEGRAL)
- RENEW EXISTING BARRIER CURB (150mm REVEAL HT., DOWELLED)
- REMOVE EXISTING CONCRETE BARRIER CURB
- REMOVE EXISTING MODIFIED BARRIER CURB
- INSTALL NEW CURB AND GUTTER INLET c/w 1800mm CATCH BASIN (SD-024) AND CONNECT 250mm PVC LDS TO EXISTING 1200mm COMBINED SEWER, INSTALL 150mm OUTLET FLOW RESTRICTOR (SD-025B)
- INSTALL NEW CURB AND GUTTER INLET c/w 1200mm CATCH BASIN (SD-024) AND CONNECT 250mm PVC LDS TO NEW CATCH BASIN
- INSTALL NEW 150mm SUBDRAIN 6.0m ON EACH SIDE OF CATCH BASIN
- REMOVE EXISTING CATCH PIT AND ABANDON LEAD
- REMOVE EXISTING CATCH BASIN AND ABANDON LEAD
- ADJUST EXISTING MANHOLE/CATCH BASIN TO GRADE
- REMOVE EXISTING FRAME AND COVER AND PLACE NEW FRAME AND COVER (AP-006/AP-007)
- INSTALL NEW CAST IRON RISER RING
- ADJUST EXISTING WATER VALVE TO GRADE
- REMOVE EXISTING RAIL TRACKS AND TIES
- REMOVE EXISTING LIGHT STANDARD
- INSULATE EXISTING WATER SERVICE UNDER ROADWAY

MATCHLINE STATION 1+220

MATCHLINE STATION 1+340

PROPOSED
EXISTING

EXISTING
PROPOSED

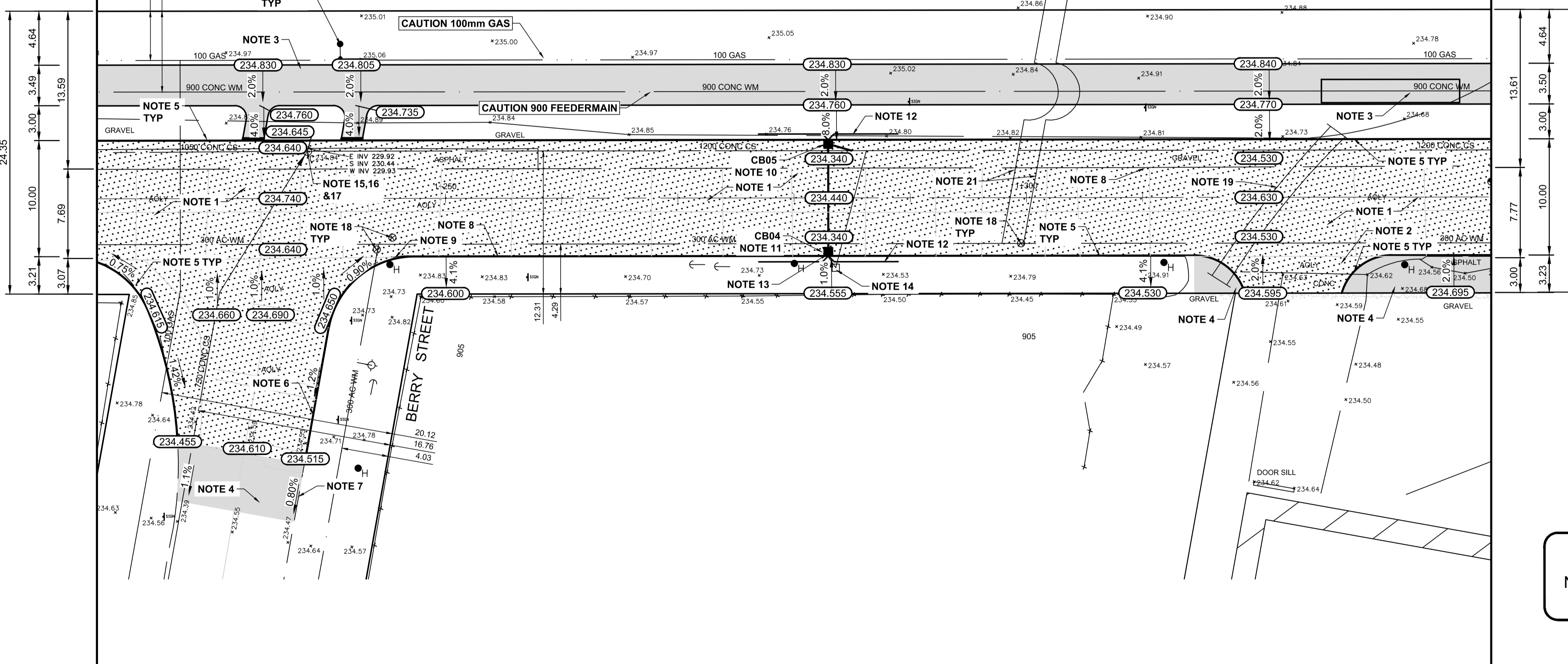

PRELIMINARY
NOT FOR CONSTRUCTION
Date: 05/06/22

**E3 ENGINEERS
GEO-SCIENTISTS
MANITOBA**
Certificate of Authorization
AECOM Canada Ltd.
No. 4671 Date: 05/06/22

METRIC
WHOLE NUMBERS INDICATE MILLIMETRES
DECIMALIZED NUMBERS INDICATE METRES

| EXISTING | LEGEND - PLAN | PROPOSED | EXISTING | LEGEND - PLAN | PROPOSED | EXISTING | LEGEND - PROFILE | PROPOSED |
|--------------|---------------------|--------------|-------------------|---------------|-----------|-----------|------------------|-----------|
| 150 mm W.M. | WATERMAIN | 150 mm W.M. | HYDRO | M.T.S. | --- x --- | --- x --- | Q PROFILE | --- x --- |
| 300mm L.D.S. | LAND DRAINAGE SEWER | 300mm L.D.S. | CONCRETE | ASPHALT | --- x --- | --- x --- | SOUTH GUTTER | --- x --- |
| 250mm W.W.S. | WASTEWATER SEWER | 250mm W.W.S. | PROPERTY LINE | SURVEY BAR | --- x --- | --- x --- | NORTH TURN LANE | --- x --- |
| | MANHOLE | | ELEVATION | (235.750) | --- x --- | --- x --- | S PROPERTY LINE | --- x --- |
| | CATCH BASIN | | TREE | | --- x --- | --- x --- | N PROPERTY LINE | --- x --- |
| | CATCH PIT | | SIDEWALK RAMP | | --- x --- | --- x --- | | |
| | JUNCTIONS | | CONCRETE SIDEWALK | | --- x --- | --- x --- | | |
| | CULVERT | | FENCE | | --- x --- | --- x --- | | |
| | GAS | | | | --- x --- | --- x --- | | |

LOCATION APPROVED UNDERGROUND STRUCTURES
SUPV. U/G STRUCTURES COMMITTEE DATE
NOTE:
LOCATION OF UNDERGROUND STRUCTURES AS SHOWN ARE BASED ON THE BEST INFORMATION AVAILABLE. BUT NO GUARANTEE IS GIVEN THAT ALL EXISTING UTILITIES ARE SHOWN OR THAT THE GIVEN LOCATIONS ARE EXACT. CONFIRMATION OF EXISTENCE AND EXACT LOCATION OF ALL SERVICES MUST BE OBTAINED FROM THE INDIVIDUAL UTILITIES BEFORE PROCEEDING WITH CONSTRUCTION.

| B.M. ELEV. | NO. | REVISIONS | DATE | BY |
|------------|-----|-------------------|----------|----|
| | 0 | ISSUED FOR TENDER | 05/06/22 | BC |
| | A | ISSUED FOR REVIEW | 04/28/22 | BC |

| | | | |
|--------------|------------|---------------------|----|
| AECOM | | ENGINEER'S SEAL | |
| DESIGNED BY | BC | CHECKED BY | BC |
| DRAWN BY | SS | APPROVED BY | RC |
| HOR. SCALE: | 1:250 | ORIGINAL SIGNED BY: | -- |
| VERTICAL: | 1:10 | DATE | - |
| | 04/28/2022 | | |

THE CITY OF WINNIPEG
PUBLIC WORKS DEPARTMENT
ENGINEERING DIVISION

2022 INDUSTRIAL STREET
RENEWAL PROGRAM

SASKATCHEWAN AVENUE - SHERWIN ROAD TO ST. JAMES STREET
CONCRETE PAVEMENT RECONSTRUCTION
STATION 1+220 TO STATION 1+340

CITY DRAWING NUMBER
SHEET 06 OF 11

CONSULTANT DRAWING NO.
CT-06