

TYPICAL CROSS SECTION
NTS

ITEM	RIM ELEV.	Sta	INVERT					CONNECTION	LEAD	FLOW RESTRICTOR
			EAST	WEST	NORTH	SOUTH	V. RISER			
CB01	234.600	1+030	233.600	233.600	232.960			1050 CS	7.6m	150mmØ

PRELIMINARY
NOT FOR CONSTRUCTION
Date: 05/06/22

- REFERENCE NOTES:
- PAVEMENT DIMENSIONS ARE TO BACK OF CURB
 - BASELINE IS CENTRE LINE ROADWAY
 - PROPERTY LINES OBTAINED FROM CITY OF WINNIPEG L.B.I.S., AND NO SCALE FACTOR WAS APPLIED
 - REFER TO AECOM FIELD BOOK NO. 5111

- CONSTRUCTION NOTES:
- REMOVE EXISTING PAVEMENT AND CONSTRUCT NEW 250mm PLAIN DOWELLED CONCRETE PAVEMENT
 - REMOVE EXISTING PAVEMENT AND CONSTRUCT NEW 200mm REINFORCED CONCRETE PAVEMENT
 - CONSTRUCT NEW ASPHALT MULTI-USE PATHWAY. REFER TO TYPICAL CROSS SECTION FOR DETAILS
 - REMOVE EXISTING ASPHALT PAVEMENT AND PLACE NEW ASPHALT PAVEMENT TYPE 1A
 - CONSTRUCT NEW MODIFIED BARRIER CURB (180mm HT. INTEGRAL)
 - CONSTRUCT NEW RAMP CURB (10-12mm HT., INTEGRAL)
 - CONSTRUCT NEW 100mm CONCRETE SIDEWALK
 - REMOVE EXISTING 100mm SIDEWALK
 - REMOVE EXISTING CONCRETE BARRIER CURB
 - REMOVE EXISTING MODIFIED BARRIER CURB
 - INSTALL NEW CURB AND GUTTER INLET c/w 1800mm CATCHBASIN (SD-024) AND CONNECT 250mm PVC LDS TO EXISTING 1050mm COMBINED SEWER, INSTALL 150mm OUTLET FLOW RESTRICTOR (SD-025B)
 - INSTALL NEW 150mm SUBDRAIN 6.0m ON EACH SIDE OF CATCH BASIN
 - REMOVE EXISTING CATCH PIT AND ABANDON LEAD
 - REMOVE EXISTING CATCH BASIN AND ABANDON LEAD
 - ADJUST EXISTING MANHOLE TO GRADE
 - REMOVE EXISTING FRAME AND COVER AND PLACE NEW FRAME AND COVER (AP-006/AP-007)
 - INSTALL NEW CAST IRON RISER RING
 - ADJUST EXISTING WATER VALVE TO GRADE
 - INSTALL NEW DETECTABLE WARNING SURFACE TILE
 - REMOVE EXISTING LIGHT STANDARD
 - RECONSTRUCT RAILWAY TRACK FROM SOUTH PROPERTY LINE TO NORTH EDGE OF MULTI-USE PATHWAY, AS DIRECTED BY CONTRACT ADMINISTRATOR
 - RENEW EXISTING MONOLITHIC MEDIAN SLAB

ENGINEERS
SCIENTISTS
MANITOBA
Certificate of Authorization
AECOM Canada Ltd.
No. 4671 Date: 05/06/22

METRIC
WHOLE NUMBERS INDICATE MILLIMETRES
DECIMALIZED NUMBERS INDICATE METRES

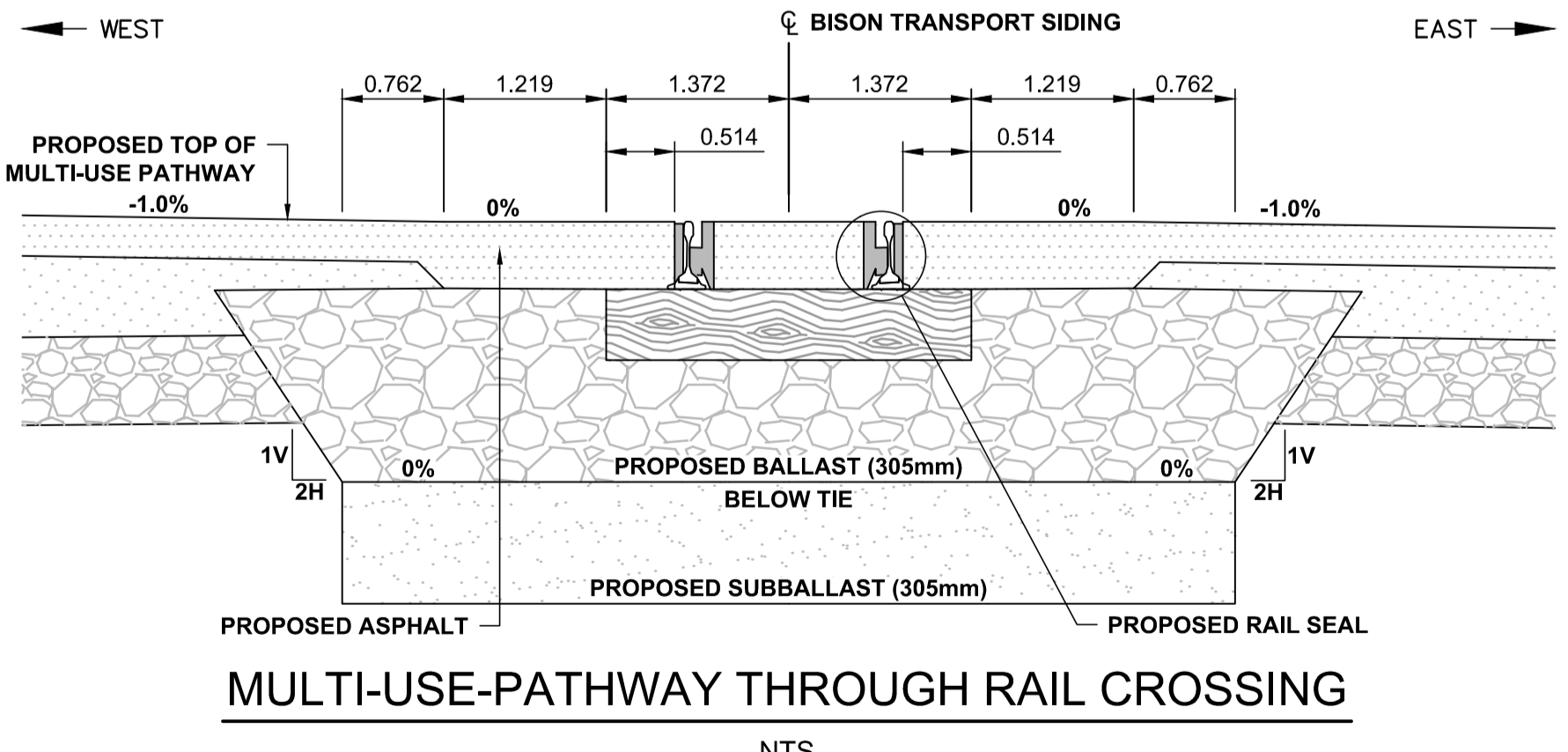
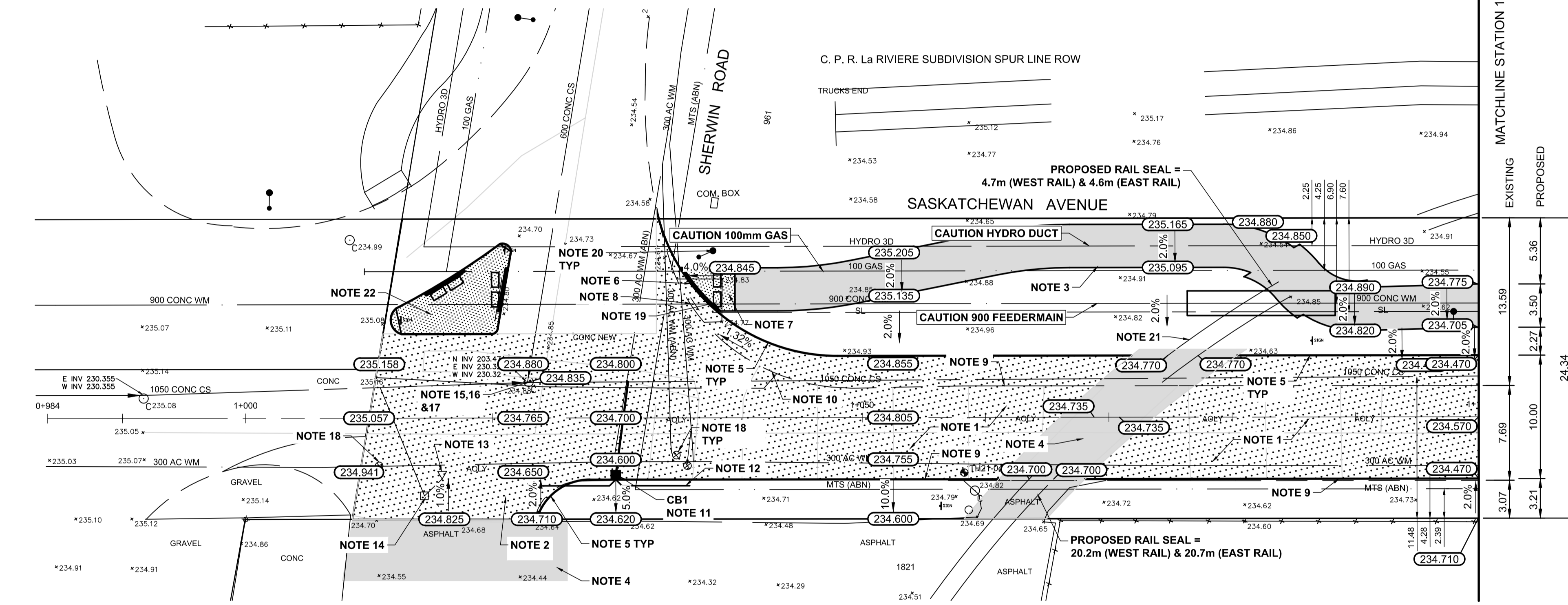

MULTI-USE-PATHWAY THROUGH RAIL CROSSING
NTS

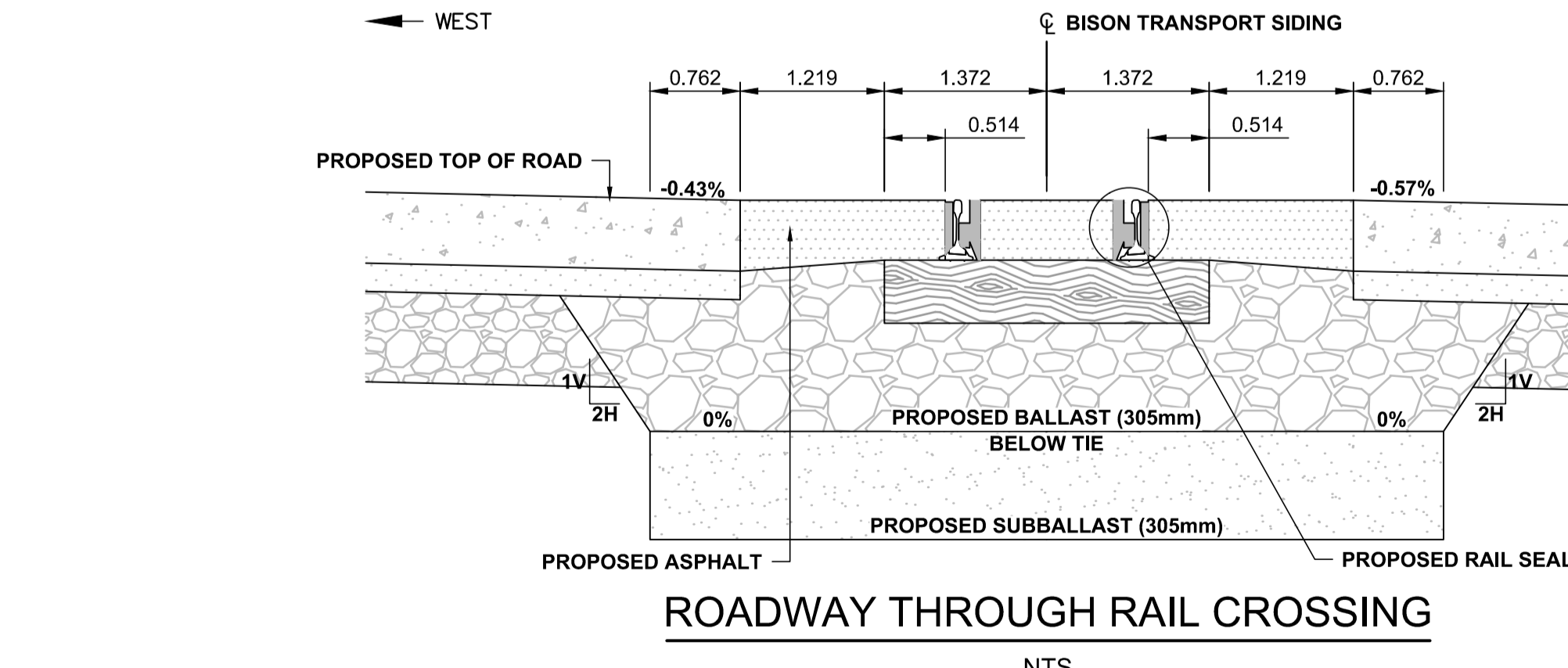

ROADWAY THROUGH RAIL CROSSING
NTS

EXISTING	LEGEND - PLAN	PROPOSED	EXISTING	LEGEND - PLAN	PROPOSED	EXISTING	LEGEND - PROFILE	PROPOSED
150 mm W.M.	WATERMAIN	150 mm W.M.	HYDRO	M.T.S.	— X —	— X —	PROFILE	— X —
Hydrant	HYDRANT	Hydrant	CONCRETE	CONCRETE	— ○ —	— ○ —	SOUTH GUTTER	— ○ —
Valve	VALVE	Valve	ASPHALT	ASPHALT	— □ —	— □ —	NORTH GUTTER	— □ —
300mm L.D.S.	LAND DRAINAGE SEWER	300mm L.D.S.	PROPERTY LINE	PROPERTY LINE	— ○ —	— ○ —	S PROPERTY LINE	— ○ —
250mm W.W.S.	WASTEWATER SEWER	250mm W.W.S.	SURVEY BAR	SURVEY BAR	— ● —	— ● —	N PROPERTY LINE	— ● —
Manhole	MANHOLE	Manhole	ELEVATION	ELEVATION	(235.750)	(235.750)		
Catch Basin	CATCH BASIN	Catch Basin	TREE	TREE	— ○ —	— ○ —		
Catch Pit	CATCH PIT	Catch Pit	SIDEWALK RAMP	SIDEWALK RAMP	— ▽ —	— ▽ —		
Junctions	JUNCTIONS	Junctions	CONCRETE SIDEWALK	CONCRETE SIDEWALK	— ▬ —	— ▬ —		
Culvert	CULVERT	Culvert	FENCE	FENCE	— ▬ —	— ▬ —		
Gas	GAS	Gas						

LOCATION APPROVED UNDERGROUND STRUCTURES
SUPV. UG STRUCTURES COMMITTEE DATE
NOTE: LOCATION OF UNDERGROUND STRUCTURES AS SHOWN ARE BASED ON THE BEST INFORMATION AVAILABLE. BUT NO GUARANTEE IS GIVEN THAT THE GIVEN LOCATIONS ARE EXACT. CONFIRMATION OF EXISTENCE AND EXACT LOCATION OF ALL SERVICES MUST BE OBTAINED FROM THE INDIVIDUAL UTILITIES BEFORE PROCEEDING WITH CONSTRUCTION.

B.M. ELEV.	NO.	REVISIONS	DATE	BY
	0	ISSUED FOR TENDER	05/06/22	BC
	A	ISSUED FOR REVIEW	04/28/22	BC

AECOM	
DESIGNED BY: BC	CHECKED BY: BC
DRAWN BY: JT	APPROVED BY: RC
HOR. SCALE: 1:250	ORIGINAL SIGNED BY: --
VERTICAL: 1:10	DATE: --

ENGINEER'S SEAL

THE CITY OF WINNIPEG
PUBLIC WORKS DEPARTMENT
ENGINEERING DIVISION

2022 INDUSTRIAL STREET
RENEWAL PROGRAM

CITY DRAWING NUMBER
SHEET 04 OF 11

SASKATCHEWAN AVENUE - SHERWIN ROAD TO ST. JAMES STREET
CONCRETE PAVEMENT RECONSTRUCTION
SHERWIN ROAD TO STATION 1+100

CONSULTANT DRAWING NO. CT-04