

- 0+72.31 CONNECT TO EXIST 150 AC WM W/ COUPLING
- 0+73.31 INSTALL 150-45° BEND
- 0+74.31 EXIST 45° BEND
- 0+75.25 INSTALL 150-45° BEND
- 0+76.71 EXIST 45° BEND
- 0+78.25 PIPE DEFLECTION & INSTALL 150 VALVE
- 0+79.11 S. MOUNTBATTEN AVENUE
- 0+80.31 REMOVE EXIST VALVE
- 0+82.23 INSTALL 150-11.25° BEND
- 0+84.00 INSTALL 300-150 REDUCER
- 0+84.72 INSTALL 300x300x300 CROSS
- 0+85.44 INSTALL 300-150 REDUCER
- 0+86.13 REMOVE EXIST VALVE
- 0+86.16 INSTALL 150-22.5° BEND

- 1+00 N. MOUNTBATTEN AVENUE
- 1+00.90 PIPE DEFLECTION
- 1+02.11 INSTALL 150 VALVE
- 1+06.89 EXIST DEFLECTION

- 1+38.86 INSTALL HYDRANT (SD-006)
- 1+50

- 1+64.48 INSTALL 150 VALVE
- 1+66.62 REMOVE EXIST HYDRANT
- 1+75.00 GRADE CHANGE
- 1+80 MATCHLINE

WATER SERVICE INFORMATION					
ADDRESS	SIZE (mm) MATERIAL (STREET)	SIZE (mm) MATERIAL (PROP.)	SHORT & LONG MEASUREMENT	CORP. LOCATION	REMARKS
111 MOUNTBATTEN AVE	20 CU	20 UNKN	4m SNLL	OPP S/C	RECONNECT SERVICE
424 BOWER BLVD	20 UNKN	20 CU	16.5' S/SHL	1034' SSL CUTHBERTSON W SIDE	RECONNECT SERVICE
425 BOWER BLVD	UNKN UNKN	UNKN UNKN	31' NSL HSE	UNKN	RECONNECT SERVICE
427 BOWER BLVD	20 UNKN	25' SNL HSE	UNKN	UNKN	RECONNECT SERVICE
428 BOWER BLVD	UNKN UNKN	UNKN UNKN	15' SNL HSE	UNKN	RECONNECT SERVICE
429 BOWER BLVD	25 CU	25 UNKN	7.5m S/NLL	122.5' NNL OF MOUNTBATTEN	UNKN
RESIDENTIAL	CU	UNKN	UNKN	0.5m S OF S/C	RECONNECT SERVICE

*SERVICES TO BE RENEWED TO R. ALL OTHERS TO BE RECONNECTED

NOTE: CHAINAGES SHOWN ARE ALONG E. R. OF BOWER BOULEVARD

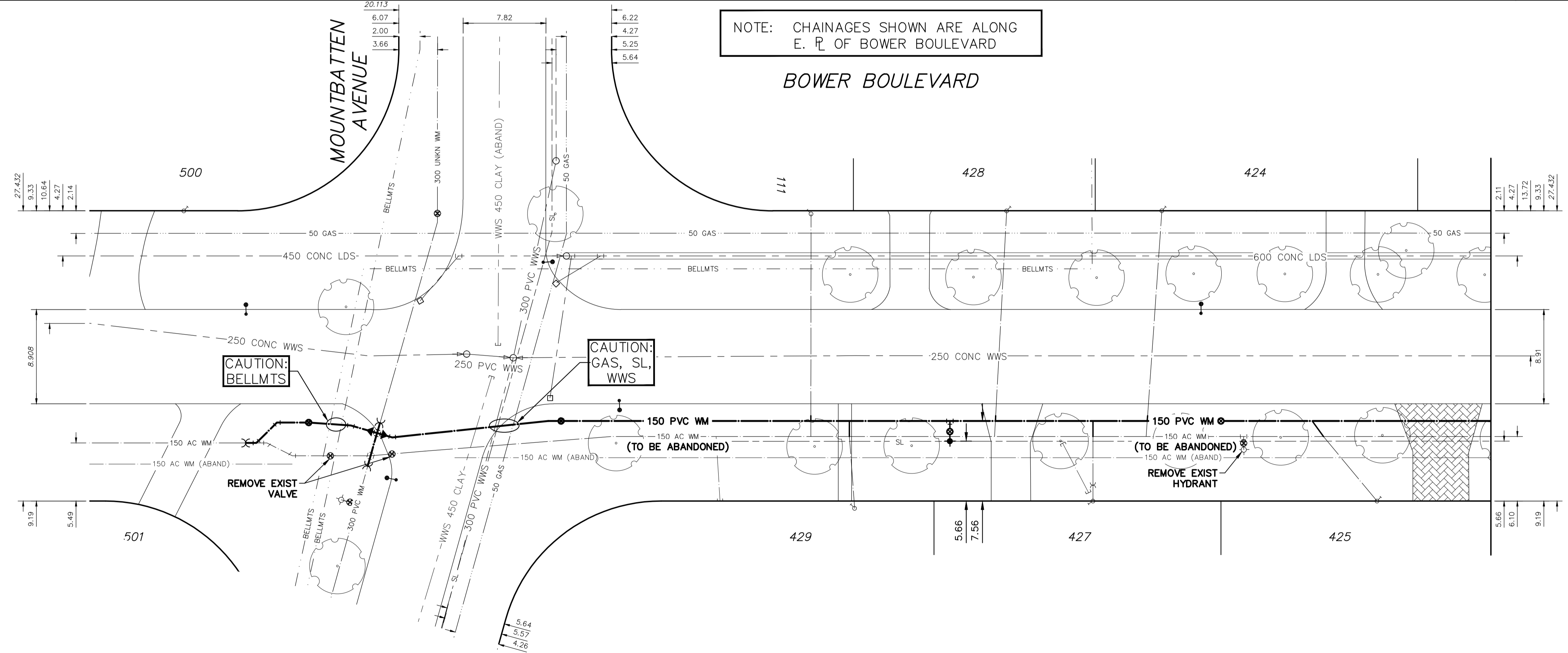

MATCHLINE AT 1+90
SEE DWG D-16302

NOTE: ALL VALVES TO BE INSTALLED CLOCKWISE TO CLOSE

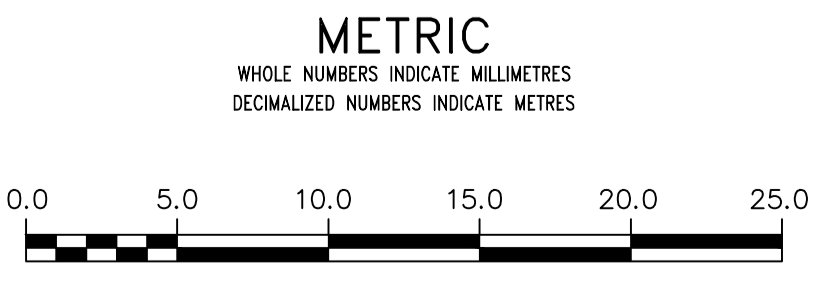

WARNING
IF POWER EQUIPMENT OR EXPLOSIVES ARE TO BE USED FOR EXCAVATION ON THIS PROJECT THE CONTRACTOR MUST:
1) NOTIFY THE GAS COMPANY OF THE PROPOSED LOCATION OF EXCAVATION.
2) TAKE PRECAUTION TO AVOID DAMAGE TO GAS COMPANY INSTALLATIONS.
SEE PROVINCIAL REGULATION 210/72 FOR DETAILS

LOCATION APPROVED
UNDERGROUND STRUCTURES
SUPV. U/G STRUCTURES COMMITTEE DATE
NOTE:
LOCATION OF UNDERGROUND STRUCTURES AS SHOWN ARE BASED ON THE BEST INFORMATION AVAILABLE BUT NO GUARANTEE IS GIVEN THAT ALL EXISTING UTILITIES ARE SHOWN OR THAT THE GIVEN LOCATIONS ARE EXACT. CONFIRMATION OF EXISTENCE AND EXACT LOCATION OF ALL SERVICES MUST BE OBTAINED FROM THE INDIVIDUAL UTILITIES BEFORE PROCEEDING WITH CONSTRUCTION.

B.M. ELEV.	NO.	REVISIONS	DATE	BY
	C	ISSUED FOR TENDER	14/04/22	K.G.
	B	DETAILED DESIGN SUBMISSION	08/04/22	K.G.
	A	PRELIMINARY DESIGN SUBMISSION	07/03/22	K.G.

wsp		1600 Buffalo Place Winnipeg, Manitoba R3T 6B8 Canada Phone: 204-477-6650 wsp.com	
DESIGNED BY	K.G.	CHECKED BY	S.M.
DRAWN BY	K.G.	APPROVED BY	S.M.
DATE	2022 04 14	RELEASED FOR CONSTRUCTION	

ENGINEER'S SEAL
CONSULTANT DRAWING NUMBER
221-01146-00-03

THE CITY OF WINNIPEG
WATER AND WASTE DEPARTMENT
ENGINEERING DIVISION

2022 WATER MAIN RENEWALS – CONTRACT 9

BOWER BOULEVARD
MOUNTBATTEN AVENUE
90.0M NNL MOUNTBATTEN AVENUE

SHEET 03 OF 11
CITY DRAWING NUMBER
D-16301

ENGINEERS
GEO-SCIENTISTS
MANITOBA
Certificate of Authorization
WSP Canada Inc.
No. 5750